

NEW MEXICO OIL CONSERVATION COMMISSION  
Well Location and Acreage Dedication Plat

Section A.

Date January 8, 1959

Operator EL PASO NATURAL GAS PRODUCTS CO. Lease HORSESHOE CANYON **SF-081226**  
Well No. 2 Unit Letter E Section 3 Township 30N Range 16 W NMPM  
Located 2310 Feet From north Line, 330 Feet From west Line  
County San Juan G. L. Elevation 5457 Dedicated Acreage 39.15 Acres  
Name of Producing Formation Lower Gallup Pool Horseshoe Gallup

1. Is the Operator the only owner\* in the dedicated acreage outlined on the plat below?  
Yes X No       .
2. If the answer to question one is "no," have the interests of all the owners been consolidated by communitization agreement or otherwise? Yes        No       . If answer is "yes," Type of Consolidation
3. If the answer to question two is "no," list all the owners and their respective interests below:

**PLAT REISSUED TO SHOW CHANGE IN DEDICATED ACREAGE.**

Owner

Land Description

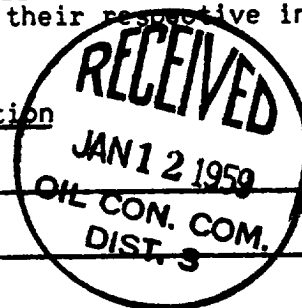

Section B

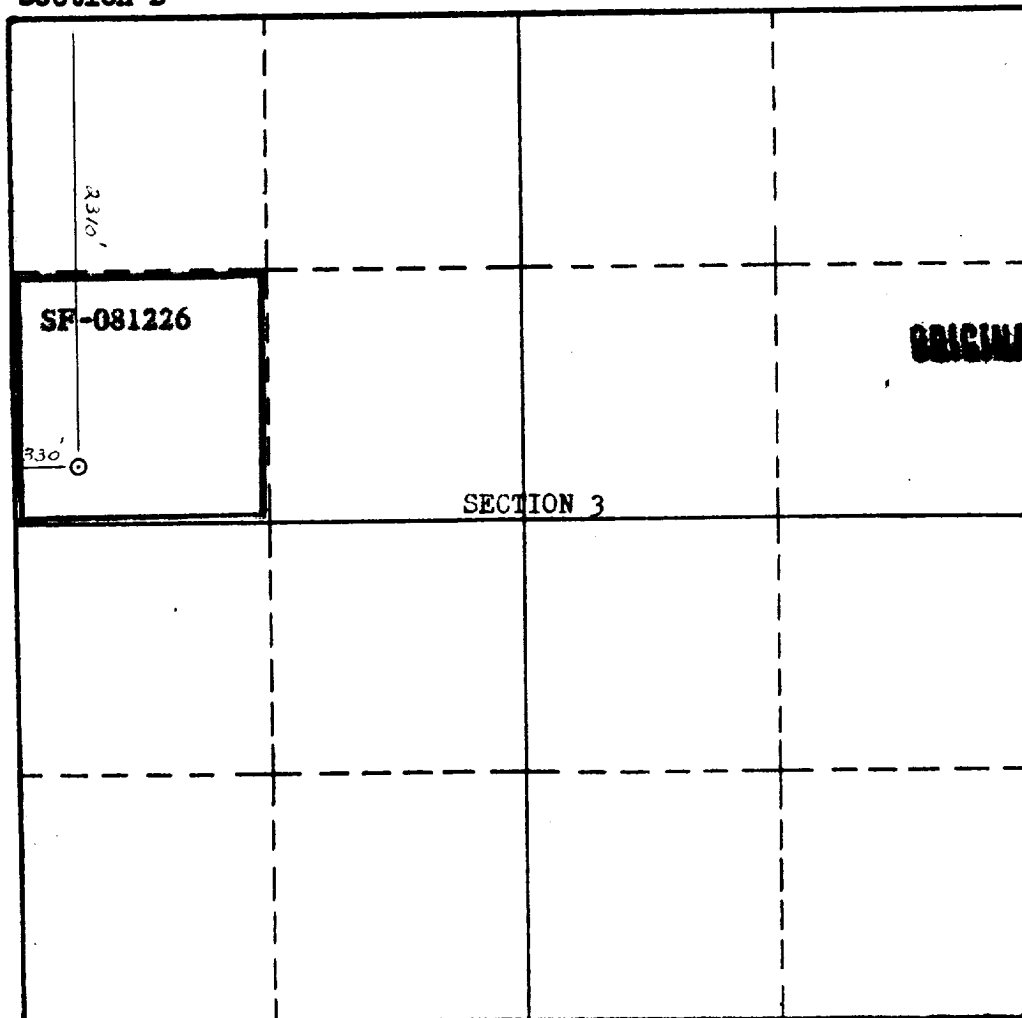

This is to certify that the information in Section A above is true and complete to the best of my knowledge and belief.

El Paso Natural Gas Products Co.  
(Operator)  
**ORIGINAL SIGNED BY: JOSEPH E. KREGER**  
(Representative)

Box 1565, Farmington, New Mexico  
Address

This is to certify that the well location shown on the plat in Section B was plotted from field notes of actual surveys made by me or under my supervision and that the same is true and correct to the best of my knowledge and belief.

Date Surveyed Jan 5, 1959  
STEPHEN H. KREGER  
Registered Professional  
Engineer and/or Land Surveyor.

0 330 660 990 1320 1650 1980 2310 2640 2970 3300 3630 3960 4290 4620 4950 5280 5610 5940 6270 6600 6930 7260 7590 7920 8250 8580 8910 9240 9570 9900 0

(See instructions for completing this form on the reverse side)

Certificate No. 803