

NEW MEXICO OIL CONSERVATION COMMISSION
Santa Fe, New Mexico

Form C-101
Revised (12/1/55)

NOTICE OF INTENTION TO DRILL

Notice must be given to the District Office of the Oil Conservation Commission and approval obtained before drilling or recompletion begins. If changes in the proposed plan are considered advisable, a copy of this notice showing such changes will be returned to the sender. Submit this notice in **QUINTUPPLICATE**. One copy will be returned following approval. See additional instructions in Rules and Regulations of the Commission. If State Land submit 6 Copies Attach Form C- 128 in triplicate to first 3 copies of form C-101

Durango, Colorado

(Place)

11/28/59

(Date)

OIL CONSERVATION COMMISSION
SANTA FE, NEW MEXICO

Gentlemen:

You are hereby notified that it is our intention to commence the Drilling of a well to be known as

EPROC Associates

(Company or Operator)

Altman-State

(Lease)

Well No. 1

F

(Unit)

The well is

located 1986 feet from the north line and 1922 feet from the west line of Section 2, T. 30 N., R. 16 W., NMPM.

(GIVE LOCATION FROM SECTION LINE) Horseshoe Canyon Pool, San Juan County

If State Land the Oil and Gas Lease is No. E - 9896

If patented land the owner is

Address

We propose to drill well with drilling equipment as follows: cable tools, surface - TD

The status of plugging bond is pending, application has been made with American Surety Company

Drilling Contractor Grossman Drilling Company

We intend to complete this well in the Gallup formation

formation at an approximate depth of 1750 feet.

CASING PROGRAM

We propose to use the following strings of Casing and to cement them as indicated:

| Size of Hole | Size of Casing | Weight per Foot | New or Second Hand | Depth | Sacks Cement |
|--------------|----------------|-----------------|--------------------|-------|--------------|
| 12 3/4 | 10 3/4 | 32.75 | second-hand | 80' | 60 |
| 7 7/8 | 5 1/2 | 15.50 | new | 1750' | 100 |
| | | | | | |
| | | | | | |

If changes in the above plans become advisable we will notify you immediately.

ADDITIONAL INFORMATION (If recompletion give full details of proposed plan of work.) Plan to run production casing through pay section, perforate approximately 35 feet (1520-1555 +), fracture w/ approximately 40,000 gals crude & 40,000 # 20-40 or 40-60 sand unless natural completion is indicated. Completion equipment will then be installed, conforming with field practices.

Approved 12-3, 1959
Except as follows:

Sincerely yours,

EPROC Associates
(Company or Operator)

By W. E. Carr

Position Partner

Send Communications regarding well to

Name EPROC Associates

Address P.O. Box 1710, Durango, Colorado

OIL CONSERVATION COMMISSION

By

NEW MEXICO OIL CONSERVATION COMMISSION
WELL LOCATION AND ACREAGE DEDICATION PLAT

FORM C-128
Revised 5/1/57

SEE INSTRUCTIONS FOR COMPLETING THIS FORM ON THE REVERSE SIDE

SECTION A

| | | | | |
|--------------------------------------------------------------------------------------------------------------------------------|--------------------------------------|------------------------------|---------------------------------------|---------------------------|
| Operator EPROC Associates | | Lease Altman-State | | Well No. 1 |
| Unit Letter F | Section 2 | Township 30N | Range 16W | County San Juan |
| Actual Footage Location of Well: 1986 feet from the north line and 1922 feet from the west line | | | | |
| Ground Level Elev. 5641' | Producing Formation Gallup | Pool H orseshow | Dedicated Acreage: 40 Acres | |

1. Is the Operator the only owner in the dedicated acreage outlined on the plat below? YES ☒ NO ____ ("Owner" means the person who has the right to drill into and to produce from any pool and to appropriate the production either for himself or for himself and another. (65-3-29 NMSA 1935 Comp.)
2. If the answer to question one is "no," have the interests of all the owners been consolidated by community agreement or otherwise? YES ____ NO ____ If answer is "yes," Type of Consolidation ____
3. If the answer to question two is "no," list all the owners and their respective interests below:

| Owner | Land Description |
|-------|------------------|
| | |
| | |

SECTION B

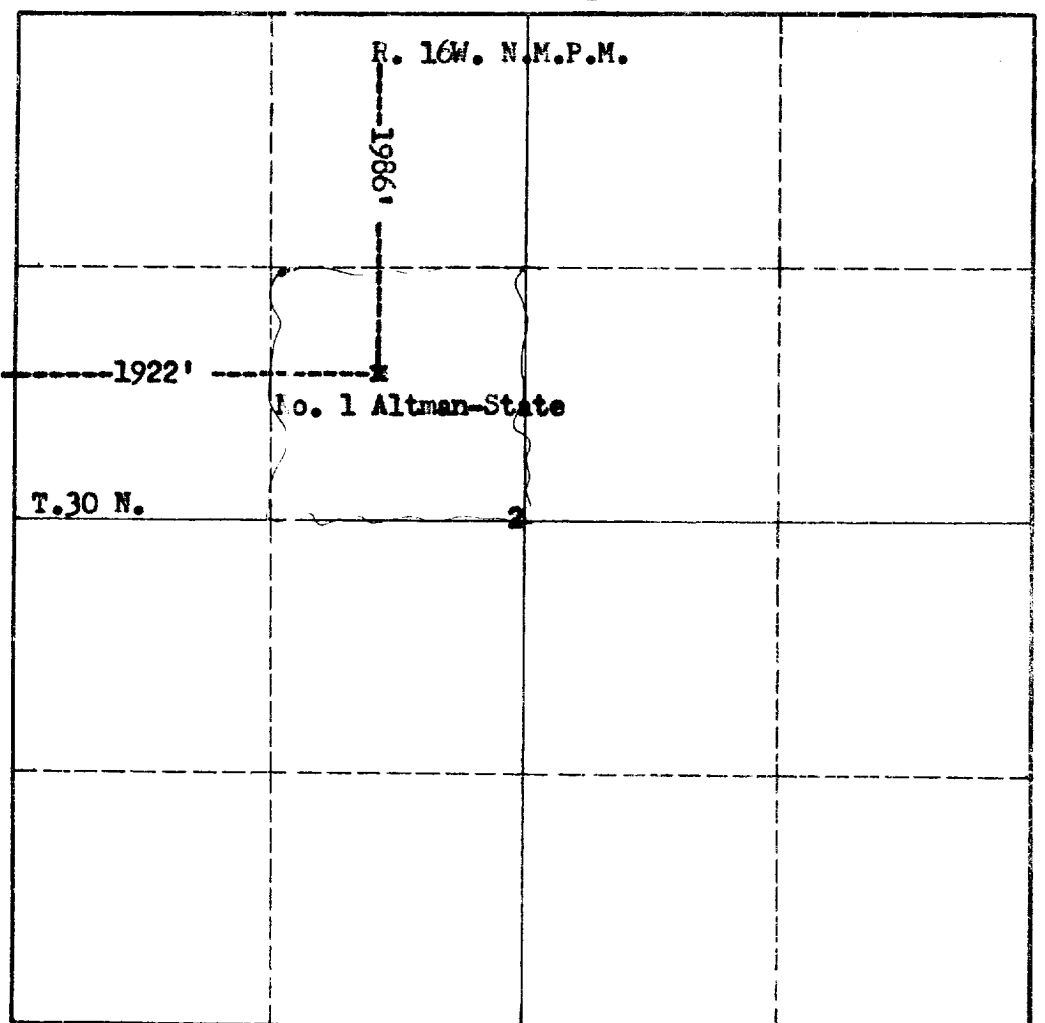

CERTIFICATION

I hereby certify that the information in SECTION A above is true and complete to the best of my knowledge and belief.

| | |
|----------|-------------------------|
| Name | W. E. Carr |
| Position | Partner |
| Company | EPROC Associates |
| Date | 11/30/59 |

I hereby certify that the well location shown on the plat in SECTION B was plotted from field notes of actual surveys made by me or under my supervision, and that the same is true and correct to the best of my knowledge and belief.

| | |
|-------------------------------------------------------|--------------------------|
| Date Surveyed | November 25, 1959 |
| Registered Professional Engineer and/or Land Surveyor | [Signature] |
| Certificate No. | New Mexico 3119 |