

(SUBMIT IN TRIPLICATE)

UNITED STATES
DEPARTMENT OF THE INTERIOR
GEOLOGICAL SURVEY

Land Office **Santa Fe**
Lease No. **97-071230**
Unit _____

SUNDRY NOTICES AND REPORTS ON WELLS

NOTICE OF INTENTION TO DRILL	<input checked="" type="checkbox"/>	SUBSEQUENT REPORT OF WATER SHUT-OFF	
NOTICE OF INTENTION TO CHANGE PLANS		SUBSEQUENT REPORT OF SHOOTING OR ACIDIZING	
NOTICE OF INTENTION TO TEST WATER SHUT-OFF		SUBSEQUENT REPORT OF ALTERING CASING	
NOTICE OF INTENTION TO RE-DRILL OR REPAIR WELL		SUBSEQUENT REPORT OF RE-DRILLING OR REPAIR	
NOTICE OF INTENTION TO SHOOT OR ACIDIZE		SUBSEQUENT REPORT OF ABANDONMENT	
NOTICE OF INTENTION TO PULL OR ALTER CASING		SUPPLEMENTARY WELL HISTORY	
NOTICE OF INTENTION TO ABANDON WELL			

(INDICATE ABOVE BY CHECK MARK NATURE OF REPORT, NOTICE, OR OTHER DATA)

September 17, 1955

Well No. **Blanco 39-13**
1-1 is located **1000** ft. from **[N]** line and **1/2** ft. from **[E]** line of sec. **4**

N2/4 NE/4 4 **30S** **12W** **NE/4**
(1/4 Sec. and Sec. No.) (Twp.) (Range) (Meridian)
Blanco Mountains Area **San Juan** **New Mexico**
(County or Subdivision) (State or Territory)

The elevation of the derrick floor above sea level is **3529.6** ft.

DETAILS OF WORK

(State names of and expected depths to objective sands; show sizes, weights, and lengths of proposed casings; indicate mudding jobs, cementing points, and all other important proposed work)

Propose to drill 15" hole to approx 175', set 10-3/4" OD casing & cement to surface w/150 gm reg. Then drill 8-7/8" hole to 2455', set 7-5/8" OD casing & cement w/150 gm 8 1/2 gal & 40 gm cement. Then drill 6-3/4" hole to approx 4540', set 5 1/2" OD liner and cement w/150 gm reg. Bradenhead square top of the liner w/25 gm reg. Perforate the 5 1/2" liner & fracture the Cliff House, Manos & Point Lobos areas separately, each w/approx 40,000 gals wtr. Perforate the 7-5/8" casing & fracture the Pictured Cliffs formation w/approx 20,000 gals wtr. Set production packer @ approx 2740'. Run tubing with side-door choke set @ approx. 2800' & complete well to produce the Manos formation thru the tubing and the Pictured Cliffs formation thru the tubing-casing annulus. It is planned to drill stem test the Pictured Cliffs formation fr approx 2815-2825. The 1/2 of Section 4 containing 200 acres, is dedicated to the Manos formation; the NE/4 of Section 4, containing 100 acres, is dedicated to the Pictured Cliffs formation.

I understand that this plan of work must receive approval in writing by the Geological Survey before operations may be commenced.

Company **Northwest Production Corporation**

Address **220 Sims Building**
Albuquerque, New Mexico

RAY PHILLIPS

By **Ray Phillips**
Title **Asst Mgr, Production Operations**

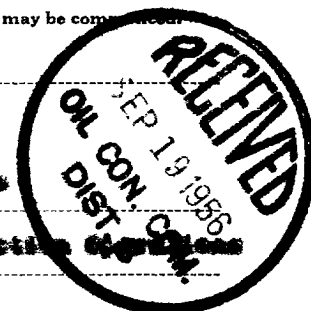



NEW MEXICO
OIL CONSERVATION COMMISSION

Form C-128

Well Location and/or Gas Proration Plat

Date September 5, 1956

Operator NORTHWEST PRODUCTION CORPORATION Lease Blanco 30-12

Well No. 1-4 Section 4 Township 30 NORTH Range 12 WEST, NMPM

Located 1095 Feet From the NORTH Line, 875 Feet From the EAST Line,

SAN JUAN County, New Mexico. G. L. Elevation 5929.6 UNGRADED.

Name of Producing Formation Messavada & Pictured Cliffs Pool Blanco Messavada Mts & Wilcox (N) Dedicated Acreage 380 NW 160 PG

(Note: All distances must be from outer boundaries of Section)

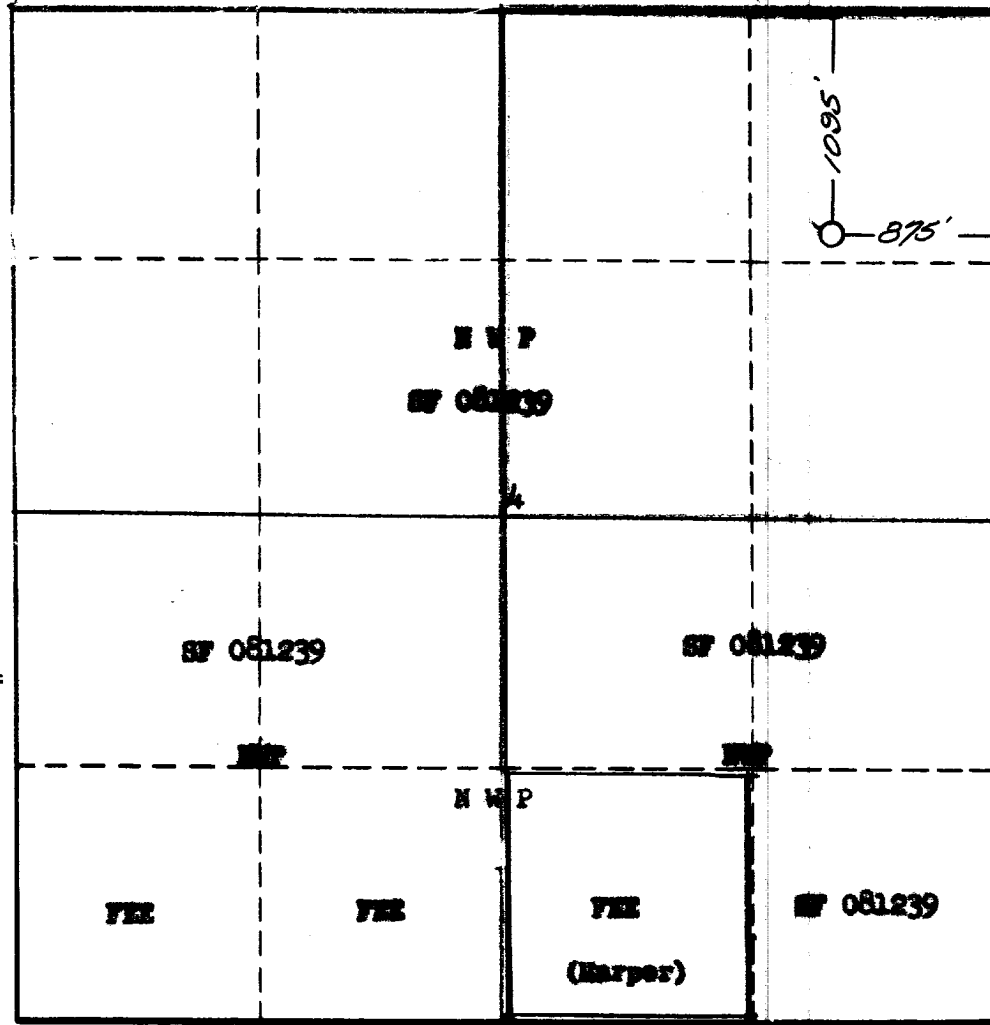

NOTE

This section of form is to be used for gas wells only.

1. Is this Well a Dual Comp.? Yes X No .
2. If the answer to Question 1 is yes, are there any other dually completed wells within the dedicated acreage? Yes No X.

Name RAY PHILLIPS
Position Northwest Production Corporation
Representing Blanco Building, Albuquerque, N.M.
Address

This is to certify that the above plat was prepared from field notes of actual surveys made by me or under my supervision and that the same are true and correct to the best of my knowledge and belief.

Date Surveyed 25 AUGUST 1956
James P. Leese
Registered Professional Engineer and/or
Land Surveyor James P. Leese
N. Mex. Reg. No. 1463