



IN REPLY REFER TO:

UNITED STATES
DEPARTMENT OF THE INTERIOR
GEOLOGICAL SURVEY
P. O. Box 965
Farmington, New Mexico

August 21, 1956

The New Drilling Company, Inc.
359 Korber Bldg.
Albuquerque, New Mexico

Re: Santa Fe 077924

Gentlemen:

Receipt is acknowledged of your "Notice of Intention to Drill" dated August 17, 1956 covering your well No. 1 McCord in NE $\frac{1}{4}$ sec. 3, T. 30 N., R. 13 W., N. M. P. M., San Juan County, New Mexico, Wildcat pool.

Your proposed work is hereby approved subject to compliance with the provisions of the "Oil and Gas Operating Regulations" revised May 25, 1942, a copy of which will be sent to you on request, and subject to the following conditions:

1. Drilling operations so authorized are subject to the attached sheet for general conditions of approval.
2. Furnish copies of all logs.

Very truly yours,

(Orig. Sgd. F. T. McGrath)

P. T. McGrath
District Engineer

PTMcGrath:al



COPY TO O. C. C.

UNITED STATES
DEPARTMENT OF THE INTERIOR
GEOLOGICAL SURVEY



Washington, D. C.

February 1, 1900
Mr. J. H. ...
...

Dear Sir:

...

...

...

...

...

...

...

...

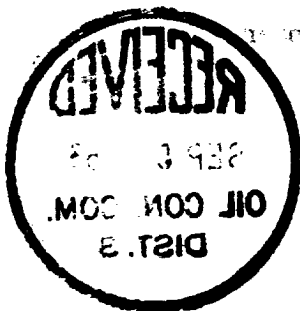

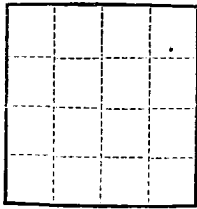

(SUBMIT IN TRIPLICATE)

UNITED STATES
DEPARTMENT OF THE INTERIOR
GEOLOGICAL SURVEY

Land Office Santa Fe

Lease No. 077924

Unit _____

SUNDRY NOTICES AND REPORTS ON WELLS

NOTICE OF INTENTION TO DRILL _____	<input checked="" type="checkbox"/> SUBSEQUENT REPORT OF WATER SHUT-OFF _____
NOTICE OF INTENTION TO CHANGE PLANS _____	SUBSEQUENT REPORT OF SHOOTING OR ACIDIZING _____
NOTICE OF INTENTION TO TEST WATER SHUT-OFF _____	SUBSEQUENT REPORT OF ALTERING CASING _____
NOTICE OF INTENTION TO RE-DRILL OR REPAIR WELL _____	SUBSEQUENT REPORT OF RE-DRILLING OR REPAIR _____
NOTICE OF INTENTION TO SHOOT OR ACIDIZE _____	SUBSEQUENT REPORT OF ABANDONMENT _____
NOTICE OF INTENTION TO PULL OR ALTER CASING _____	SUPPLEMENTARY WELL HISTORY _____
NOTICE OF INTENTION TO ABANDON WELL _____	

(INDICATE ABOVE BY CHECK MARK NATURE OF REPORT, NOTICE, OR OTHER DATA)

August 17, 1956

McCord
Well No. 1 is located 1190 ft. from N line and 985 ft. from E line of sec. 3
N 1/4 Sec. 3 30N 13W N.M.
(1/4 Sec. and Sec. No.) (Twp.) (Range) (Meridian)
Wild Cat San Juan New Mexico
(Field) (County or Subdivision) (State or Territory)

The elevation of the derrick floor above sea level is _____ ft.

DETAILS OF WORK

(State names of and expected depths to objective sands; show sizes, weights, and lengths of proposed casings; indicate mudding jobs, cementing points, and all other important proposed work)

175' of 10 3/4" Surface Pipe - 50 Sacks cement
4471' of 7" 20 Lb. Pipe - 200 sacks cement
16 Joints 5 1/2" 15 lb. to be set as 4850 TD
with 50 sacks cement

To test the Mesa Verde formation



I understand that this plan of work must receive approval in writing by the Geological Survey before operations may be commenced.

Company THE NEW DRILLING CO. INC.

Address 1018 Patterson Bldg. - Denver, Colorado

359 Korber Bldg. By Carl E. Everett

Albuquerque, New Mexico Title Land Man

NEW MEXICO
OIL CONSERVATION COMMISSION

Form C-128

Well Location and/or Gas Proration Plat

Date _____

Operator SOUTHERN UNION GAS COMPANY Lease _____

Well No. _____ Section 3 Township 30 NORTH Range 13 WEST, NMPM

Located 1190 Feet From the NORTH Line, 985 Feet From the EAST Line,

SAN JUAN County, New Mexico. G. L. Elevation _____

Name of Producing Formation _____ Pool _____ Dedicated Acreage 3196

(Note: All distances must be from outer boundaries of Section)

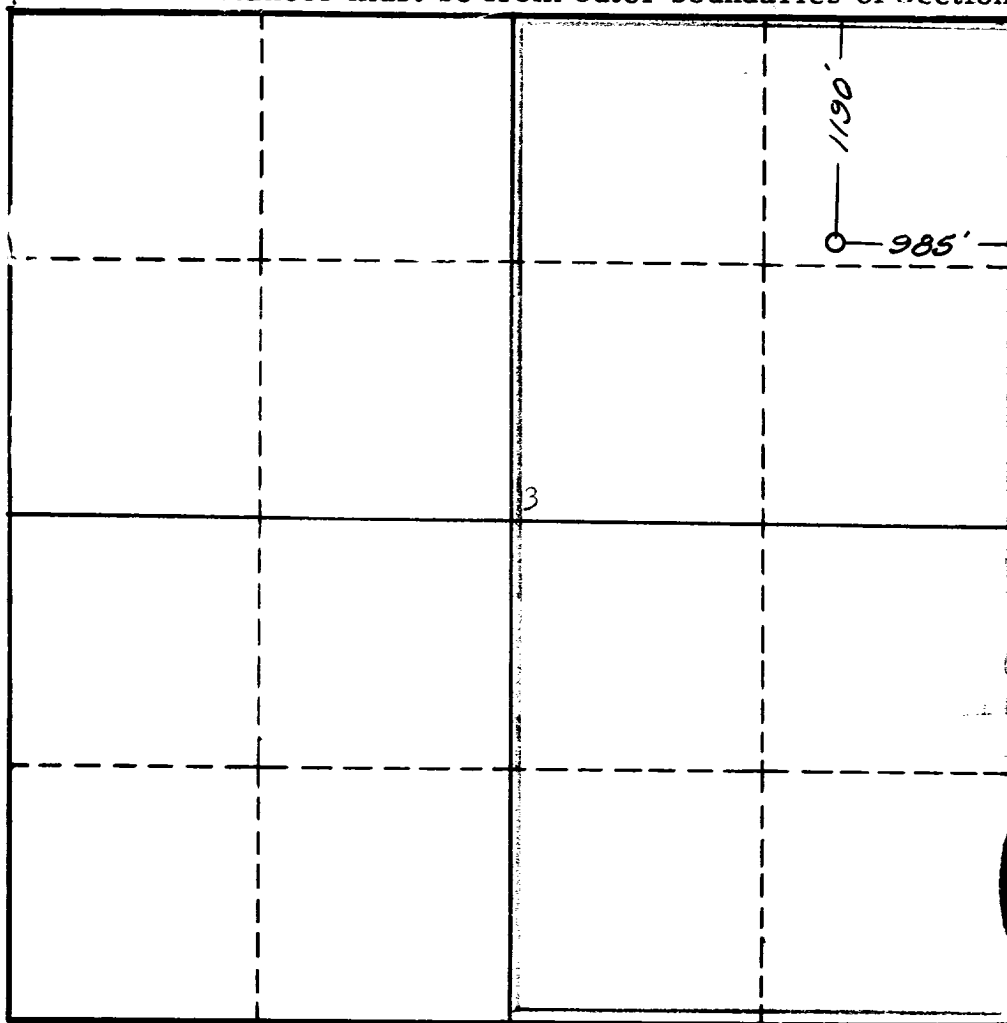

NOTE

This section of form is to be used for gas wells only.



SCALE: 1"=1000'

1. Is this Well a Dual Comp. ? Yes No ✓
2. If the answer to Question 1 is yes, are there any other dually completed wells within the dedicated acreage ? Yes No ✓

Name James P. Lease
Position Land Manager
Representing New Drilling Co.
Address 354 Karber Alley
Albuquerque, N.M.

This is to certify that the above plat was prepared from field notes of actual surveys made by me or under my supervision and that the same are true and correct to the best of my knowledge and belief.

Date Surveyed 8 AUGUST 1956
James P. Lease
Registered Professional Engineer and/or
Land Surveyor James P. Lease
N. Mex. Reg. No. 1463

