

(SUBMIT IN TRIPLICATE)

Indian Agency \_\_\_\_\_

UNITED STATES  
DEPARTMENT OF THE INTERIOR  
GEOLOGICAL SURVEY

Allottee \_\_\_\_\_  
NavaJo  
Lease No. **14-20-603-2021**

SUNDRY NOTICES AND REPORTS ON WELLS

NOTICE OF INTENTION TO DRILL	<input checked="" type="checkbox"/>	SUBSEQUENT REPORT OF WATER SHUT-OFF	<div style="text-align: right;"> <b>RECEIVED</b>  <b>OCT 5 1962</b>  <b>U. S. GEOLOGICAL SURVEY</b>  <b>FARMINGTON, NEW MEXICO</b> </div>
NOTICE OF INTENTION TO CHANGE PLANS		SUBSEQUENT REPORT OF SHOOTING OR ACIDIZING	
NOTICE OF INTENTION TO TEST WATER SHUT-OFF		SUBSEQUENT REPORT OF ALTERING CASING	
NOTICE OF INTENTION TO REDRILL OR REPAIR WELL		SUBSEQUENT REPORT OF REDRILLING OR REPAIR	
NOTICE OF INTENTION TO SHOOT OR ACIDIZE		SUBSEQUENT REPORT OF ABANDONMENT	
NOTICE OF INTENTION TO PULL OR ALTER CASING		SUPPLEMENTARY WELL HISTORY	
NOTICE OF INTENTION TO ABANDON WELL			

(INDICATE ABOVE BY CHECK MARK NATURE OF REPORT, NOTICE, OR OTHER DATA)

Oct. 5, 1962

Well No. **Joella 1X** is located **1650** ft. from **N** line and **990** ft. from **E** line of sec. **5**

**SE 1/4 NE 1/4 5**      **30N**      **17 W**      **MT**  
(1/4 Sec. and Sec. No.)      (Twp.)      (Range)      (Meridian)

**Wildcat**      **San Juan**      **New Mexico**  
(Field)      (County or Subdivision)      (State or Territory)

The elevation of the derrick floor above sea level is **5083** ft.

DETAILS OF WORK

(State names of and expected depths to objective sands; show sizes, weights, and lengths of proposed casings; indicate mudding jobs, cementing points, and all other important proposed work)

Drill a test to the Gallup formation approximately **440** feet deep. Set **5 1/2** inch casing. Cement surface. Test formation in open hole.

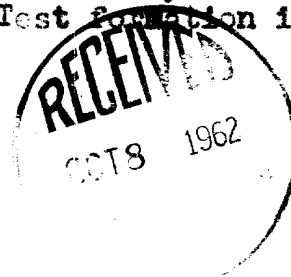
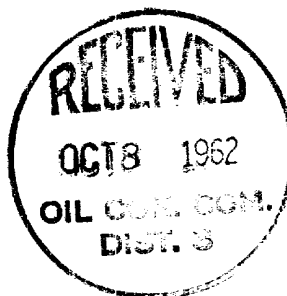

I understand that this plan of work must receive approval in writing by the Geological Survey before operations may be commenced.

Company **King Oil Co.**

Address **Suite 735 Petroleum Club Bldg**  
**Denver 2, Colorado**

By **Frank G. J. [Signature]**  
 Title \_\_\_\_\_

Well Location and Acreage Dedication Plat

Section A.

Date \_\_\_\_\_

Operator KING OIL COMPANY OF COLORADO Lease \_\_\_\_\_  
 Well No. X 1 Unit Letter H Section 5 Township 30 NORTH Range 17 WEST NMPM  
 Located 1650 Feet From the NORTH Line, 990 Feet From the EAST Line  
 County SAN JUAN G. L. Elevation 5083.35 Dedicated Acreage 110 Acres  
 Name of Producing Formation X Pool \_\_\_\_\_

1. Is the Operator the only owner in the dedicated acreage outlined on the plat below?

Yes X No \_\_\_\_\_

2. If the answer to question one is "no", have the interests of all the owners been consolidated by communitization agreement or otherwise? Yes \_\_\_\_\_ No \_\_\_\_\_. If answer is "yes", Type of Consolidation.

3. If the answer to question two is "no", list all the owners and their respective interests below:

OwnerLand Description

<u>Owner</u>	<u>Land Description</u>

Section B.

Note: All distances must be from outer boundary of Section.

This is to certify that the information  
 in Section A above is true and complete  
 to the best of my knowledge and belief.

(Operator)  
James P. Leese  
 (Representative)

(Address)  
Agent  
 \_\_\_\_\_  
 \_\_\_\_\_

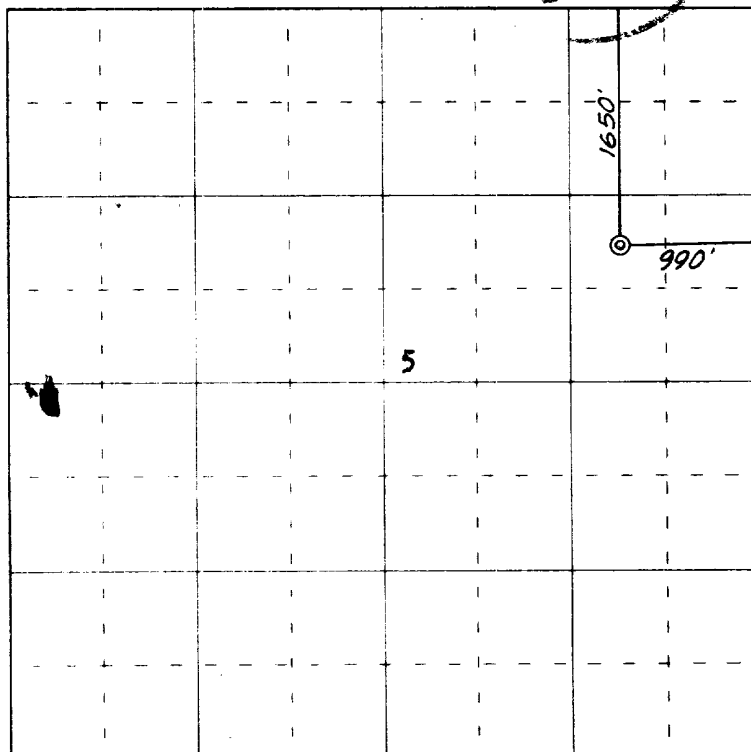

0 330 660 990 1320 1650 1980 2310 2640 2000 1500 1000 500 0

Scale 4 inches equal 1 mile

This is to certify that the above plat was prepared from field notes of actual surveys made by me or under my supervision and that the same are true and correct to the best of my knowledge and belief.

Date Surveyed 7 September 1962

James P. Leese  
 Registered Professional Engineer and/or Land Surveyor  
 James P. Leese N. Mex. Reg. No. 1463  
 San Juan Engineering Company

Farmington, New Mexico