

(SUBMIT IN TRIPLICATE)

UNITED STATES
DEPARTMENT OF THE INTERIOR
GEOLOGICAL SURVEY

Land Office **Santa Fe**
Lease No. **NM 09867**

RECEIVED
JUL 7 1961

SUNDRY NOTICES AND REPORTS ON WELLS

U. S. GEOLOGICAL SURVEY
FARMINGTON, NEW MEXICO

NOTICE OF INTENTION TO DRILL	<input checked="" type="checkbox"/>	SUBSEQUENT REPORT OF WATER SHUT-OFF
NOTICE OF INTENTION TO CHANGE PLANS	<input type="checkbox"/>	SUBSEQUENT REPORT OF SHOOTING OR ACIDIZING
NOTICE OF INTENTION TO TEST WATER SHUT-OFF	<input type="checkbox"/>	SUBSEQUENT REPORT OF ALTERING CASING
NOTICE OF INTENTION TO RE-DRILL OR REPAIR WELL	<input type="checkbox"/>	SUBSEQUENT REPORT OF RE-DRILLING OR REPAIR
NOTICE OF INTENTION TO SHOOT OR ACIDIZE	<input type="checkbox"/>	SUBSEQUENT REPORT OF ABANDONMENT
NOTICE OF INTENTION TO PULL OR ALTER CASING	<input type="checkbox"/>	SUPPLEMENTARY WELL HISTORY
NOTICE OF INTENTION TO ABANDON WELL	<input type="checkbox"/>	

(INDICATE ABOVE BY CHECK MARK NATURE OF REPORT, NOTICE, OR OTHER DATA)

July 6, 1961

Well No. **61** is located **1120** ft. from **N** line and **890** ft. from **E** line of sec. **6**

NE 1/4 Sec. 6 (1/4 Sec. and Sec. No.) **30 N** (Twp.) **12** (Range) **NMPM** (Meridian)
Wildcat (Field) **San Juan** (County or Subdivision) **New Mexico** (State or Territory)

The elevation of the derrick floor above sea level is **5640** ft.

DETAILS OF WORK

(State names of and expected depths to objective sands; show sizes, weights, and lengths of proposed casings; indicate mudding jobs, cementing points, and all other important proposed work)

Plan to drill 12 3/4" hole - set 250' x 9 5/8" x 36# surface casing with 200 sacks cement - 8 3/4" hole with mud to TD of 6200' thru Dakota 4 1/2" x 11.60# casing to TD with 200 sacks cement. Perforate Dakota Formation and sand-water frac.

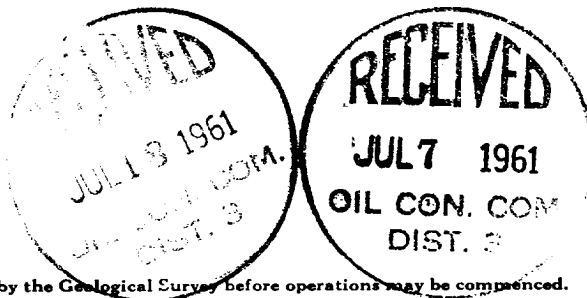

I understand that this plan of work must receive approval in writing by the Geological Survey before operations may be commenced.

Company **R & G Drilling Company, Inc.**
Address **P. O. Box 327**
Farmington, New Mexico

By
Title **William C. Russell**
President

NUMBER OF COPIES RECEIVED	
DISTRIBUTION	
SANTA FE	
FILE	
U.S.G.S.	
LAND OFFICE	
TRANSPORTER	OIL
	GAS
PRODUCTION OFFICE	
OPERATOR	

NEW MEXICO OIL CONSERVATION COMMISSION
WELL LOCATION AND ACREAGE DEDICATION PLAT
 SEE INSTRUCTIONS FOR COMPLETING THIS FORM ON THE REVERSE SIDE

FORM C-128
 Revised 5/1/57

SECTION A

Operator R AND G DRILLING COMPANY		Lease <i>Leant</i>		Well No. <i>41</i>
Unit Letter A	Section 6	Township 30 NORTH	Range 13 WEST	County SAN JUAN
Actual Footage Location of Well: 1120 feet from the NORTH line and 890 feet from the EAST line				
Ground Level Elev. 5629.0	Producing Formation <i>Del Norte</i>	Pool <i>Wildcat</i>	Dedicated Acreage: E 320.4 Acres	

Ref: GLO plat dated 12 May 1955

- Is the Operator the only owner in the dedicated acreage outlined on the plat below? YES ☒ NO ☐ . ("Owner" means the person who has the right to drill into and to produce from any pool and to appropriate the production either for himself or for himself and another. (65-3-29 (e) NMSA 1935 Comp.)
- If the answer to question one is "no," have the interests of all the owners been consolidated by communitization agreement or otherwise? YES ☐ NO ☐ . If answer is "yes," Type of Consolidation _____
- If the answer to question two is "no," list all the owners and their respective interests below:

Owner	Land Description



SECTION B

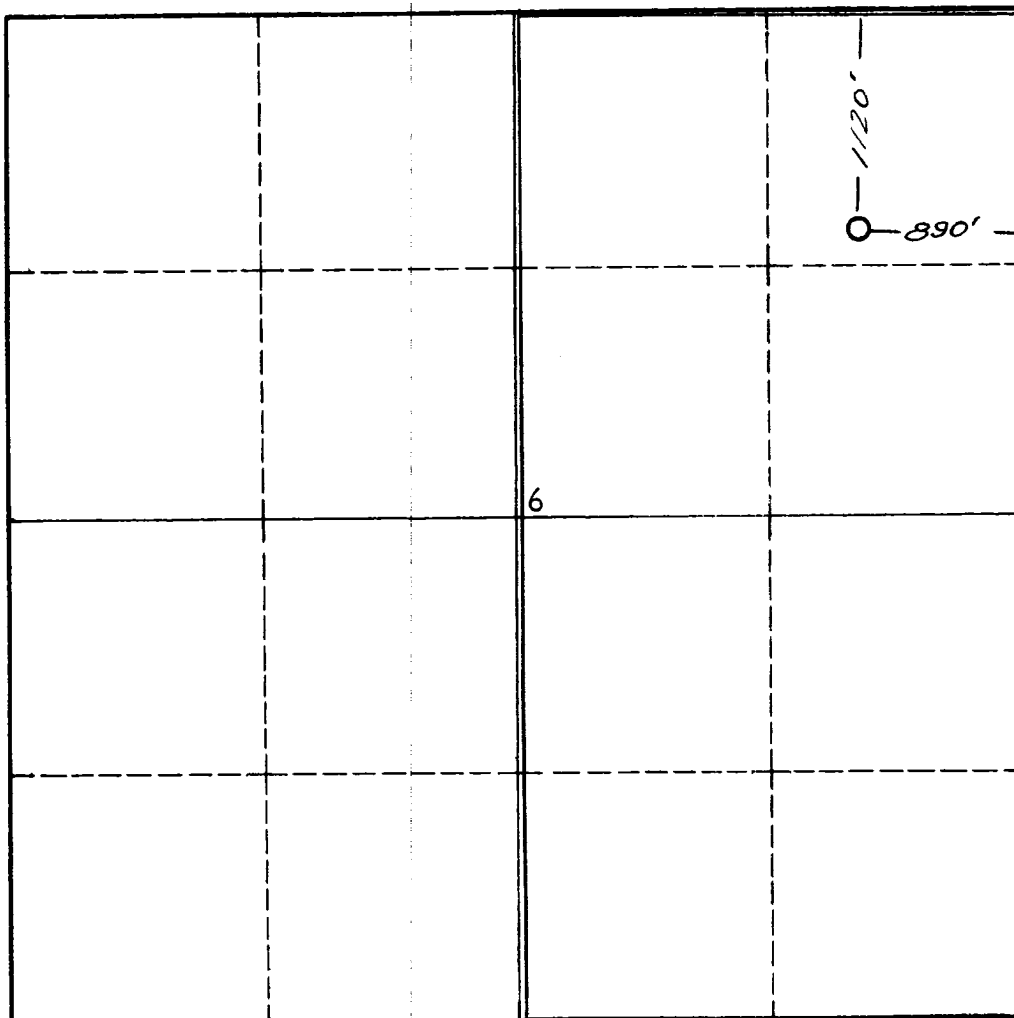

I hereby certify that the information in SECTION A above is true and complete to the best of my knowledge and belief.

Name *William C. Russell*

Position *Pres.*

Company *R & G Drilling Company, Inc.*

Date *7-6-61*

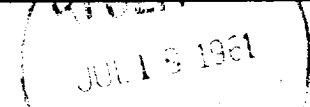

I hereby certify that the well location shown on the plat in SECTION B was plotted from field notes of actual surveys made by me or under my supervision, and that the same is true and correct to the best of my knowledge and belief.

Date Surveyed
3 July 1961

Registered Professional Engineer and/or Land Surveyor

James P. Leese

Certificate No. **1463**
San Juan Engineering Company

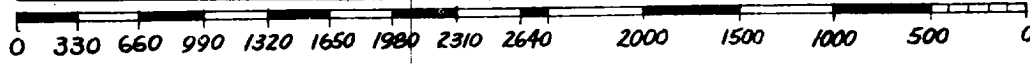

INSTRUCTIONS FOR COMPLETION OF FORM C-128

1. Operator shall furnish and certify to the information called for in Section A.
2. Operator shall outline the dedicated acreage for *both* oil and gas wells on the plat in Section B.
3. A registered professional engineer or land surveyor registered in the State of New Mexico or approved by the Commission shall show on the plat the location of the well and certify this information in the space provided.
4. All distances shown on the plat must be from the outer boundaries of the Section.
5. If additional space is needed for listing owners and their respective interests as required in question 3 of Section A, please use space below.