

Farmington, New Mexico

February 21, 1961

El Paso Natural Gas Products Company
Burroughs State

2

C

660

North

1980

West

2

30N

16W

Horseshoe Gallup

San Juan

E-3150-4

X

Rotary Tools thru

gallup formation

Statewide

Banner Drilling Company

Gallup
1690

Elel 5663 GL; 5670 DF

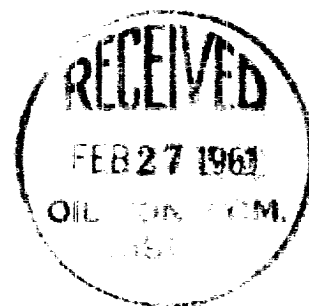

12-1/4"	9-5/8"	36.00#	Used	100	100
7-7/8"	5-1/2"	15.50#	New	1690	100

It is proposed to drill through the Gallup formation using rotary tools and mud circulation. After setting 5-1/2" casing, productive intervals will be perforated and sand-oil fractured. The NE/4 NW/4 of Sec 2 is dedicated to this well.

NE/4 NW/4 E-3150-4

Verbal approval obtained 2-21-61

El Paso Natural Gas Products Company

[Signature]
Engineer

Mr. E. N. Walsh
Box 1560 Farmington, New Mexico

NEW MEXICO OIL CONSERVATION COMMISSION

Well Location and Acreage Dedication Plat

SECTION A.

Date **February 21, 1961**

Operator **EL PASO NATURAL GAS PRODUCTS CO.** Lease **Barrengs** State **E-3150-4**

Well No. **2** Unit Letter **C** Section **2** Township **30N** Range **16W** NMPM

Located **660** Feet From **North** Line, **1980** Feet From **West** Line

County **San Juan** G. L. Elevation **5663'** Dedicated Acreage **40.00** Acres

Name of Producing Formation **Gallup** Pool **Horseshoe-Gallup**

1. Is the Operator the only owner* in the dedicated acreage outlined on the plat below? Yes **X** No
2. If the answer to question One is "No," have the interests of all the owners been consolidated by communitization agreement or otherwise? Yes No If answer is "Yes," Type of Consolidation
3. If the answer to question Two is "No," list all the owners and their respective interests below:

OWNER

LAND DESCRIPTION

SECTION B.

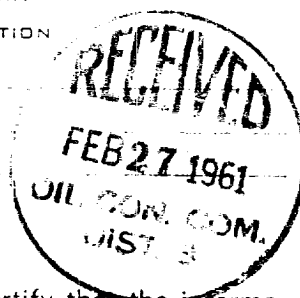
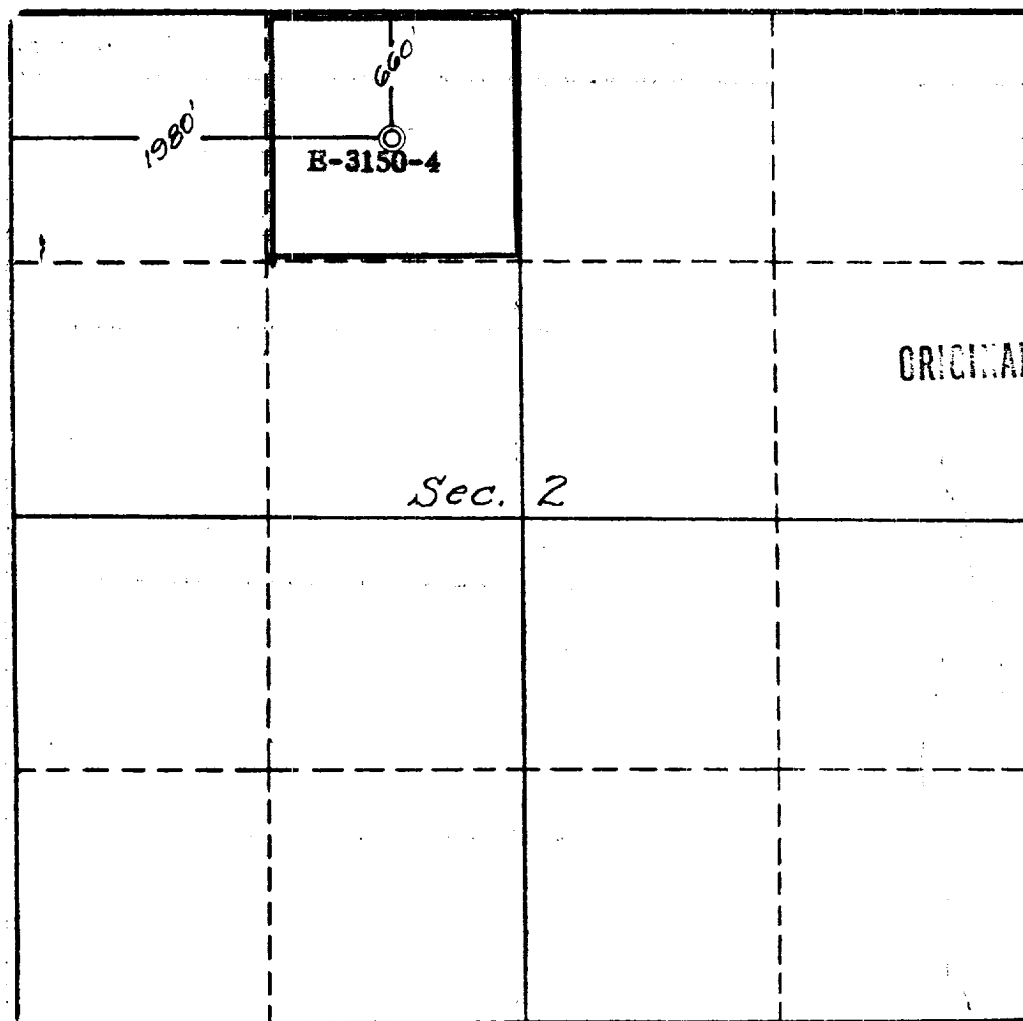

This is to certify that the information in Section A above is true and complete to the best of my knowledge and belief.

El Paso Nat Gas Prod. Co.
(OPERATOR)

ORIGINAL SIGNED BY: **JOSEPH E. KREGER**
REPRESENTATIVE

Box 1560, Farmington, Nmx.
(ADDRESS)

This is to certify that the well location shown on the plat in Section B was plotted from field notes of actual survey made by me or under my supervision and that the same is true and correct to the best of my knowledge and belief.

Date Surveyed **2-18-61**

Four States Engineering Co.
FARMINGTON, NEW MEXICO

E. J. Felt
REGISTERED ENGINEER OR
LAND SURVEYOR

Certificate No. **3084**