

STATE OF NEW MEXICO
OIL CONSERVATION
COMMISSION
DISTRICT NO. 3
Phone 99 P. O. Box 697
AZTEC, NEW MEXICO

(SUBMIT IN TRIPLICATE)
UNITED STATES
DEPARTMENT OF THE INTERIOR
GEOLOGICAL SURVEY

Land Office Santa Fe
Lease No. 070906
Unit W Sec. 26, T-21-N.,
R-10-E, 10-2

SUNDRY NOTICES AND REPORTS ON WELLS

NOTICE OF INTENTION TO DRILL	<input checked="" type="checkbox"/>	SUBSEQUENT REPORT OF WATER SHUT-OFF	
NOTICE OF INTENTION TO CHANGE PLANS		SUBSEQUENT REPORT OF SHOOTING OR ACIDIZING	
NOTICE OF INTENTION TO TEST WATER SHUT-OFF		SUBSEQUENT REPORT OF ALTERING CASING	
NOTICE OF INTENTION TO RE-DRILL OR REPAIR WELL		SUBSEQUENT REPORT OF REDRILLING OR REPAIR	
NOTICE OF INTENTION TO SHOOT OR ACIDIZE		SUBSEQUENT REPORT OF ABANDONMENT	
NOTICE OF INTENTION TO PULL OR ALTER CASING		SUPPLEMENTARY WELL HISTORY	
NOTICE OF INTENTION TO ABANDON WELL			

(INDICATE ABOVE BY CHECK MARK NATURE OF REPORT, NOTICE, OR OTHER DATA)

September 25, 1952, 1952

Well No. 1 Blanco is located 990 ft. from N line and 1650 ft. from E line of sec. 26
31 SW Section 26 31 North 9 West N.M.P.M.
(1/4 Sec. and Sec. No.) (Twp.) (Range) (Meridian)
Blanco San Juan County New Mexico
(Field) (County or Subdivision) (State or Territory)

The elevation of the derrick floor above sea level is _____ ft. - To be furnished

DETAILS OF WORK

(State names of and expected depths to objective sands; show sizes, weights, and lengths of proposed casings; indicate mudding jobs, cementing points, and all other important proposed work)

The objective sands are the Cliff House and the Point Lookout, expected at 4750' and 5350' respectively. The proposed casing program is as follows:
175' of 9-5/8" O.D. casing cemented to top
4750' of 5 1/2" O.D. casing cemented with 200 sacks.

Well will be drilled with rotary tools to top of the Cliff House and the pay sands will be drilled with rotary tools using natural gas method to a total depth of about 5550'.

Well will then be shot with about 1800 quarts of nitro from 4800' to 5550'.

Understand that this plan of work must receive approval in writing by the Geological Survey before operations may be commenced.

Company 882 SOUTHERN UNION GAS COMPANY
Address COM. 1204 East 11th St., Dallas, Texas
DIST. 3

By J. M. Wiederkehr
J. M. Wiederkehr
Title Reservoir Engineer

DEPARTMENT OF THE INTERIOR
GEOLOGICAL SURVEY
UNITED STATES
(REPRINT IN TRIPLICATE)

ALL INFORMATION CONTAINED HEREIN IS UNCLASSIFIED
DATE 08-22-2011 BY 60322 UCBAW

1	ORDER OF INTENTION TO DRILL	SUBSEQUENT REPORT OF WATER SHUT-OFF
2	ORDER OF INTENTION TO CHANGE A VALVE	SUBSEQUENT REPORT OF SHOOTING OR ACIDIZING
3	ORDER OF INTENTION TO TEST WATER SHUT-OFF	SUBSEQUENT REPORT OF ALTERING CASING
4	ORDER OF INTENTION TO REDRILL OR REPAIR WELL	SUBSEQUENT REPORT OF REDRILLING OR REPAIR
5	ORDER OF INTENTION TO SHOOT OR ACIDIZE	SUBSEQUENT REPORT OF ABANDONMENT
6	ORDER OF INTENTION TO PULL OR WATER CASING	SUPPLEMENTARY WELL HISTORY
7	ORDER OF INTENTION TO ABANDON WELL	

01

_____ is located _____ from _____ line and _____ from _____ line of _____.

CHARTER No.

1997

(vi)

...to state;

© 2011 Pearson Education, Inc. All rights reserved.

2003

The elevation of the derrick floor above the _____ ft.

HOW TO ORDER

1. The first of the two main reasons for the failure of the first two attempts at a coup was the lack of a clear and consistent objective. The first attempt was aimed at the removal of the President, while the second was aimed at the removal of the Prime Minister. This lack of a clear objective led to a lack of coordination and a lack of a unified front.

3. Универсальность

Address

۷۸

141

Company Southern Union Gas Company

Lease Ramsaker Well No. 1

Sec. 26 T. 31 N. R. 9 W. N.M.P.M.

Location 990' from the South line and 1650' from the West line.

San Juan County

New Mexico

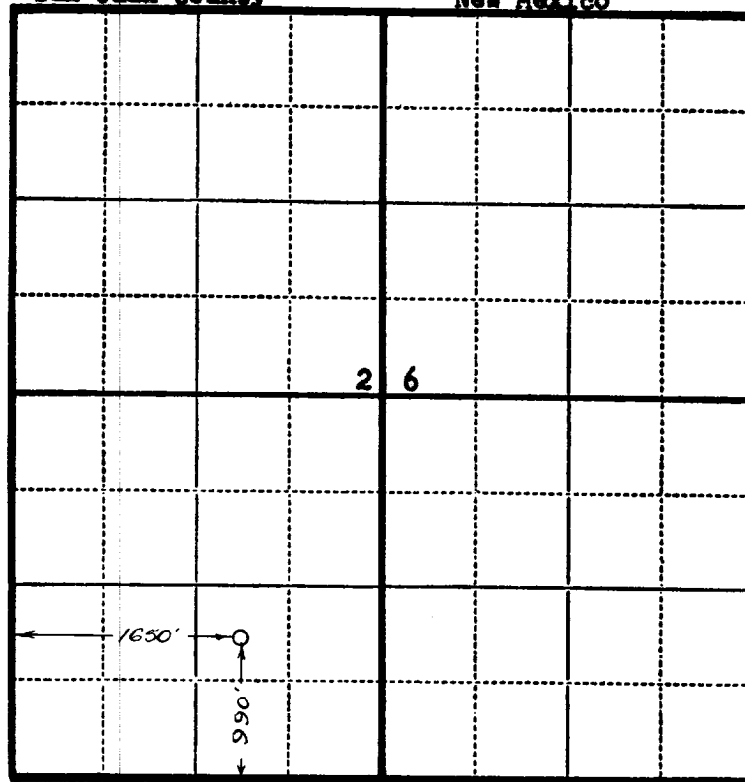

Scale—4 inches equals 1 mile.

This is to certify that the above plat was prepared from field notes of actual surveys made by me or under my supervision and that the same are true and correct to the best of my knowledge and belief.

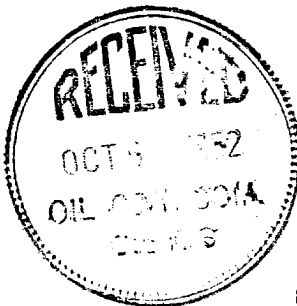

Seal:

Charles J. Finklea

Registered Professional
Engineer and Land Surveyor.

Charles J. Finklea
N. Mex. Reg. No. 1302

Surveyed September 12, 19 52