

NEW MEXICO OIL CONSERVATION COMMISSION

SANTA FE, NEW MEXICO

ok

7-3-58

APPLICATION FOR DUAL COMPLETION

Field Name Undesignated		County San Juan		Date October 21, 1958
Operator Blackwood & Nichols Company		Lease Northeast Blanco Unit		Well No. 55-22
Location of Well B	Unit 22	Section 22	Township 11N	Range 7W

1. Has the New Mexico Oil Conservation Commission heretofore authorized the dual completion of a well in these same pools or in the same zones within one mile of the subject well? YES ☒ NO ☐
2. If answer is yes, identify one such instance: Order No. **DC 516** ; Operator, Lease, and Well No.:

KPNO, Allison Unit #12

3. The following facts are submitted:	Upper Zone	Lower Zone
a. Name of reservoir	Mesa Verde	Dakota
b. Top and Bottom of Pay Section (Perforations)	5341-5792'	7897-8016
c. Type of production (Oil or Gas)	Gas	Gas
d. Method of Production (Flowing or Artificial Lift)	Flow	Flow

4. The following are attached. (Please mark YES or NO)

- ☒ a. Diagrammatic Sketch of the Dual Completion, showing all casing strings, including size and setting, top of cement, perforated intervals, tubing strings, including diameters and setting depth, location and type of packers and side door chokes, and such other information as may be pertinent.
- ☒ b. Plat showing the location of all wells on applicant's lease, all offset wells on offset leases, and the names and addresses of operators of all leases offsetting applicant's lease.
- ☐ c. Waivers consenting to such dual completion from each offset operator, or in lieu thereof, evidence that said offset operators have been furnished copies of the application.*
- ☒ d. Electrical log of the well or other acceptable log with tops and bottoms of producing zones and intervals of perforation indicated thereon. (If such log is not available at the time application is filed, it shall be submitted as provided by Rule 112-A.)

5. List all offset operators to the lease on which this well is located together with their correct mailing address.

* **Offset acreage committed to Northeast Blanco Unit on which Blackwood & Nichols Co. is**

Unit Operator.

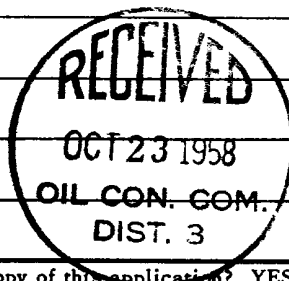

6. Were all operators listed in Item 5 above notified and furnished a copy of this application? YES ☐ NO ☐ . If answer is yes, give date of such notification _____ .

CERTIFICATE: I, the undersigned, state that I am the **Field Superintendent** of the **Blackwood & Nichols Company** (company), and that I am authorized by said company to make this report; and that this report was prepared under my supervision and direction and that the facts stated therein are true, correct and complete to the best of my knowledge.

Original Signed

by DeLasso Loos

DeLasso Loos

Signature

- * Should waivers from all offset operators not accompany an application for administrative approval, the New Mexico Oil Conservation Commission will hold the application for a period of twenty (20) days from date of receipt by the Commission's Santa Fe office. If, after said twenty-day period, no protest nor request for hearing is received by the Santa Fe office, the application will then be processed.
- NOTE: If the proposed dual completion will result in an unorthodox well location and/or a non-standard proration unit in either or both of the producing zones, then separate application for approval of the same should be filed simultaneously with this application.

NEW MEXICO OIL CONSERVATION COMMISSION

SANTA FE, NEW MEXICO

7-3-58

APPLICATION FOR DUAL COMPLETION

Field Name Undesignated		County San Juan		Date October 21, 1958
Operator Blackwood & Nichols Company		Lease Northeast Blanco Unit		Well No. 55-22
Location of Well B	Unit 22	Section 31N	Township 7N	Range 7W

1. Has the New Mexico Oil Conservation Commission heretofore authorized the dual completion of a well in these same pools or in the same zones within one mile of the subject well? YES ☒ NO ☐
2. If answer is yes, identify one such instance: Order No. **DC 516** ; Operator, Lease, and Well No.:

EPNG, Allison Unit #12

3. The following facts are submitted:	Upper Zone	Lower Zone
a. Name of reservoir	Mesa Verde	Dakota
b. Top and Bottom of Pay Section (Perforations)	5341-5792 1/2	7897-8016
c. Type of production (Oil or Gas)	Gas	Gas
d. Method of Production (Flowing or Artificial Lift)	Flow	Flow

4. The following are attached. (Please mark YES or NO)

- ☒ a. Diagrammatic Sketch of the Dual Completion, showing all casing strings, including size and setting, top of cement, perforated intervals, tubing strings, including diameters and setting depth, location and type of packers and side door chokes, and such other information as may be pertinent.
- ☒ b. Plat showing the location of all wells on applicant's lease, all offset wells on offset leases, and the names and addresses of operators of all leases offsetting applicant's lease.
- * c. Waivers consenting to such dual completion from each offset operator, or in lieu thereof, evidence that said offset operators have been furnished copies of the application.*
- ☒ d. Electrical log of the well or other acceptable log with tops and bottoms of producing zones and intervals of perforation indicated thereon. (If such log is not available at the time application is filed, it shall be submitted as provided by Rule 112-A.)

5. List all offset operators to the lease on which this well is located together with their correct mailing address.

* **Offset acreage committed to Northeast Blanco Unit on which Blackwood & Nichols Co. is**

Unit Operator.

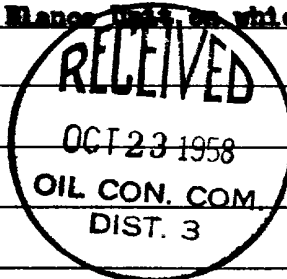

6. Were all operators listed in Item 5 above notified and furnished a copy of this application? YES ☐ NO ☐ . If answer is yes, give date of such notification _____.

CERTIFICATE: I, the undersigned, state that I am the **Field Superintendent** of the **Blackwood & Nichols Company** (company), and that I am authorized by said company to make this report; and that this report was prepared under my supervision and direction and that the facts stated therein are true, correct and complete to the best of my knowledge.

Original Signed
by Delasso Loos

Delasso Loos

Signature

- * Should waivers from all offset operators not accompany an application for administrative approval, the New Mexico Oil Conservation Commission will hold the application for a period of twenty (20) days from date of receipt by the Commission's Santa Fe office. If, after said twenty-day period, no protest nor request for hearing is received by the Santa Fe office, the application will then be processed.
- NOTE: If the proposed dual completion will result in an unorthodox well location and/or a non-standard proration unit in either or both of the producing zones, then separate application for approval of the same should be filed simultaneously with this application.

SCHEMATIC DIAGRAM

BLACKWOOD & NICHOLS NEBU #55-22 DUAL COMPLETION (DAKOTA - MESAVEPDE)

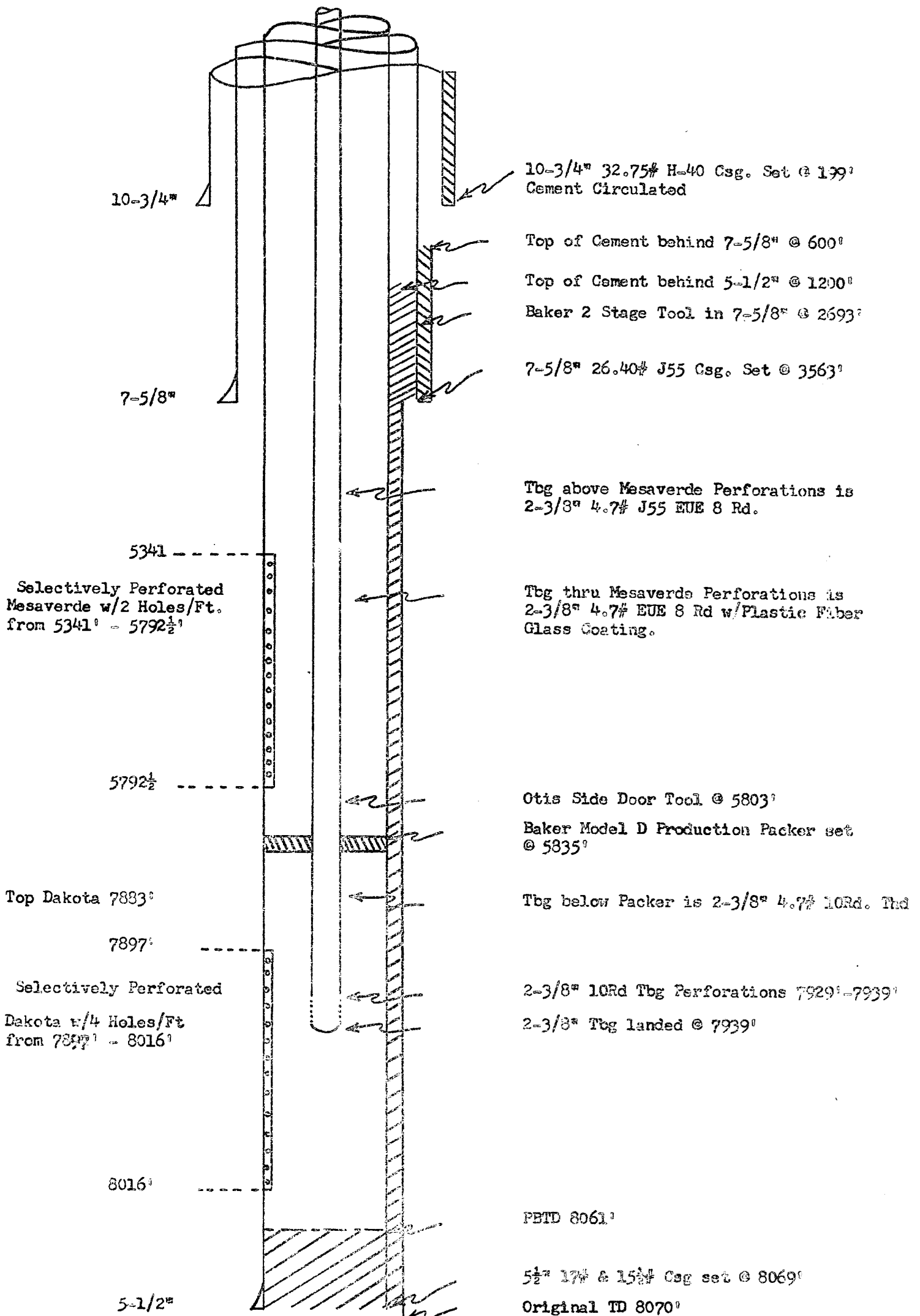

SCHEMATIC DIAGRAM

BLACKWOOD & NICHOLS NEBU #55-22 DUAL COMPLETION (DAKOTA - MESAVEPDE)

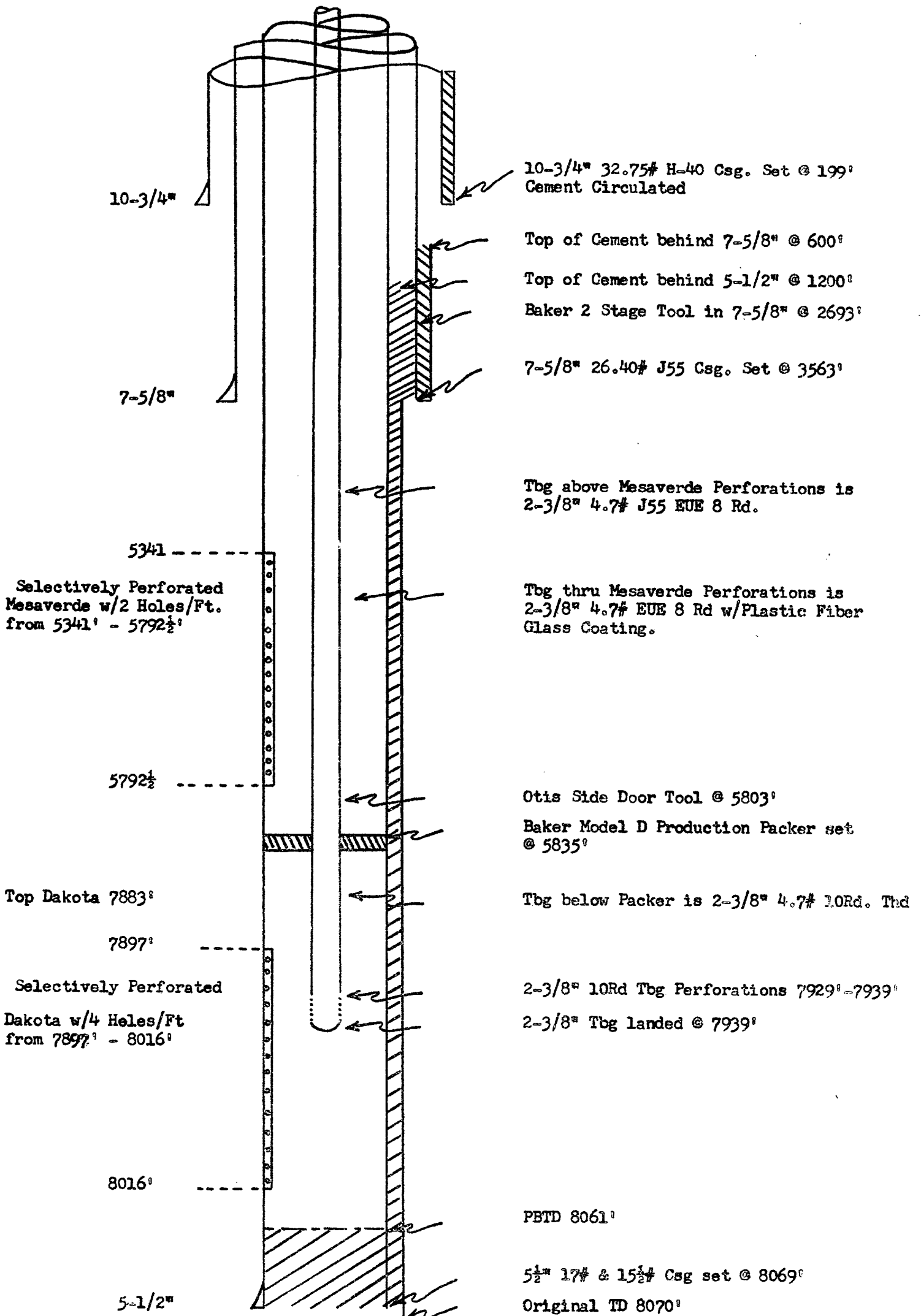



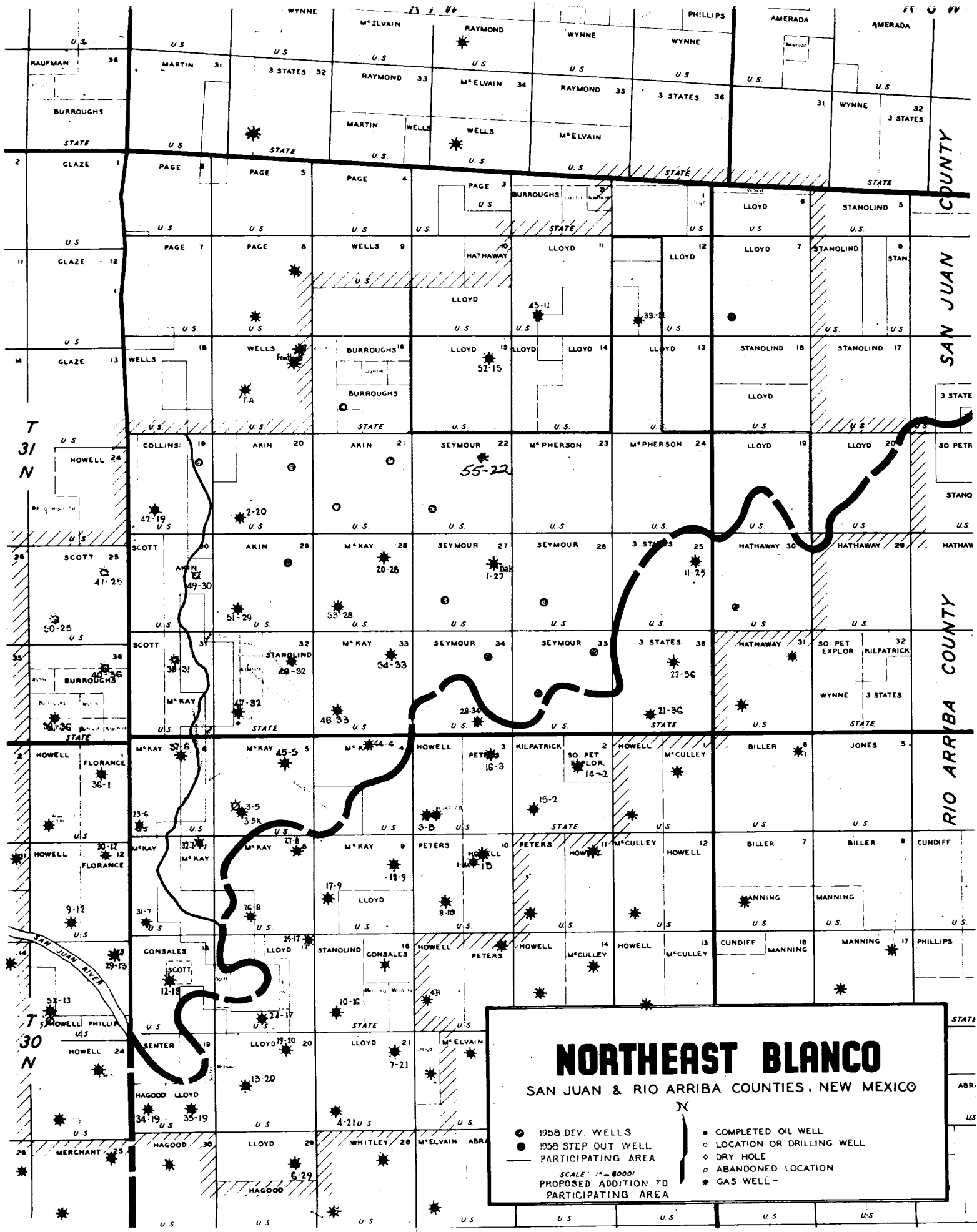

NORTHEAST BLANCO

SAN JUAN & RIO ARRIBA COUNTIES, NEW MEXICO

- 1958 DEV. WELLS
- 1958 STEP OUT WELL
- PARTICIPATING AREA
- SCALE 1" = 6000'
- PROPOSED ADDITION TO PARTICIPATING AREA
- COMPLETED OIL WELL
- LOCATION OR DRILLING WELL
- DRY HOLE
- ABANDONED LOCATION
- * GAS WELL

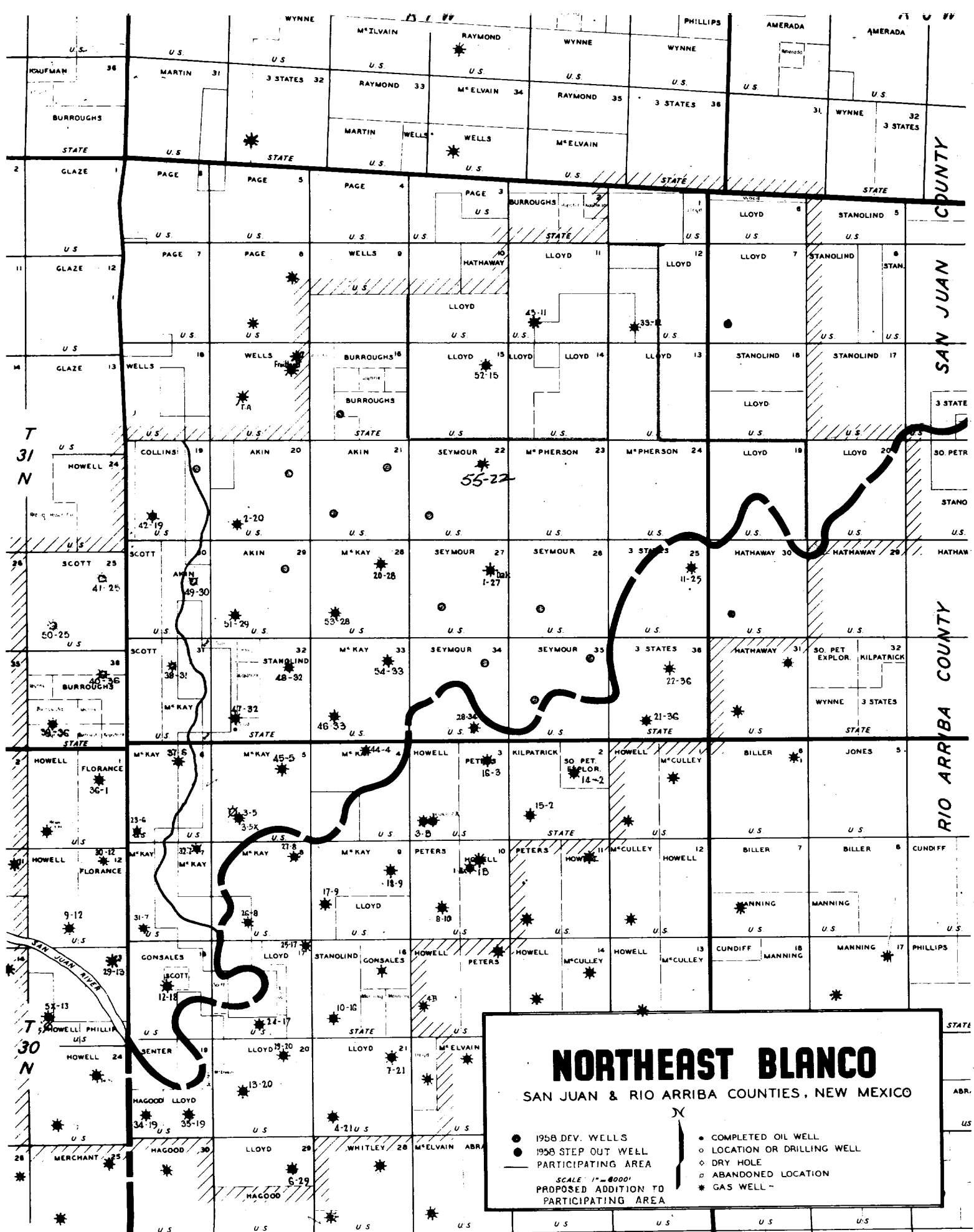

NEW MEXICO OIL CONSERVATION COMMISSION
SANTA FE, NEW MEXICO

6-1-56

PACKER-SETTING AFFIDAVIT
(Dual Completions)

STATE OF New Mexico)
County of San Juan) ss

W.J. Linton, being first duly sworn according to law, upon his oath deposes and says:

That he is of lawful age and has full knowledge of the facts herein below set out.

That he is employed by Blackwood & Nichols Company in the capacity of Petroleum Engineer and as such is its authorized agent.

That on September 24, 1958, he personally supervised the setting of a Paker Model A15-D in Blackwood & Nichol Company's
(Make and Type of Packer) (Operator)
Northeast Blance Unit Well No. 55-22, located in Unit
(lease)
Letter B, Section 22, Township 30N, Range 7W, NMPM,
San Juan County, New Mexico.

That said packer was set at a subsurface depth of 5835 feet,
said depth measurement having been furnished by Schlumberger.

That the purpose of setting this packer was to effect a seal in the annular space between the two strings of pipe where the packer was set so as to prevent the commingling, within the well-bore, of fluids produced from a stratum below the packer with fluids produced from a stratum above the packer. That this packer was properly set and that it did, when set, effectively and absolutely seal off the annular space between the two strings of pipe where it was set in such manner as that it prevented any movement of fluids across the packer.

Blackwood & Nichols Company
(Company)

De Lasso Loos
(its Agent)

Subscribed and sworn to before me this the 22nd day of Oct., AD,
1958.

Mildred J. Fisher
Notary Public in and for the County
of La Plata, Colorado.

My Commission Expires March 27, 1960.

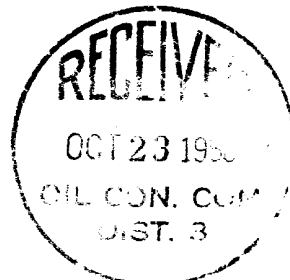

NEW MEXICO OIL CONSERVATION COMMISSION
SANTA FE, NEW MEXICO

6-1-56

PACKER-SETTING AFFIDAVIT
(Dual Completions)

STATE OF New Mexico)
County of San Juan) ss

W.J. Linton, being first duly sworn according to law, upon his oath deposes and says:

That he is of lawful age and has full knowledge of the facts herein below set out.

That he is employed by Blackwood & Nichols Company in the capacity of Petroleum Engineer and as such is its authorized agent.

That on September 24, 1958, he personally supervised the setting of a Baker Model 415-B in Blackwood & Nichol Company's
(Make and Type of Packer) (Operator)

Northeast Blanco Unit Well No. 55-22, located in Unit
(lease)
Letter B, Section 22, Township 31N, Range 7W, NMPM,
San Juan County, New Mexico.

That said packer was set at a subsurface depth of 5835 feet,
said depth measurement having been furnished by Schlumberger.

That the purpose of setting this packer was to effect a seal in the annular space between the two strings of pipe where the packer was set so as to prevent the commingling, within the well-bore, of fluids produced from a stratum below the packer with fluids produced from a stratum above the packer. That this packer was properly set and that it did, when set, effectively and absolutely seal off the annular space between the two strings of pipe where it was set in such manner as that it prevented any movement of fluids across the packer.

Blackwood & Nichols Company
(Company)

De Lasso Loos DeLasso Loos
(its Agent)

Subscribed and sworn to before me this the 22nd day of Oct., AD,
1958.

Mildred L. Fisher
Notary Public in and for the County
of La Plata, Colorado.

My Commission Expires March 27, 1960.

