

**EL PASO FIELD SERVICES
PRODUCTION PIT CLOSURE**

Outside

RISK-bedrock

RTX

TPH

**Wayne Moore Gas Unit #1
Meter/Line ID – 97334**

SITE DETAILS

Legals - Twn: 31N
NMOCD Hazard Ranking: 0
Operator: Texaco E & P

Rng: 9W

Sec: 16

Unit: N

Land Type: State

Pit Closure Date: 9/30/94

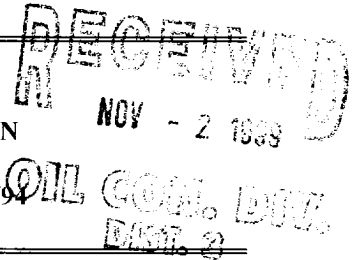

RATIONALE FOR RISK-BASED CLOSURE:

The pit noted above was assessed and ranked according to the criteria in the New Mexico Oil Conservation Division's (NMOCD) Unlined Surface Impoundment Closure Guidelines.

Sandstone was encountered in the test pit at a depth of four feet. The boring was terminated and a soil sample was collected for field headspace analysis and laboratory analysis for TPH. Groundwater was not encountered in the test pit. The test pit was then backfilled and the pit area graded in a manner to divert precipitation away from the pit area. Headspace analysis indicated an organic vapor content of 279 ppm; laboratory analysis indicated a TPH concentration of 45,900 mg/kg.

418.1

El Paso Field Services Company (EPFS) requests closure of the above mentioned production pit location for the following reasons:

- The primary source, discharge to the pit, has been removed for over four years.
- Bedrock was encountered in the test excavation at four feet below ground surface making remediation impractical.
- The test pit was backfilled with clean soil and the area graded to direct surface runoff away from the former pit.
- Source material has been removed from the ground surface, eliminating potential direct contact with livestock and the public.
- Groundwater was not encountered in the test excavation. In addition, the estimated depth to groundwater is greater than 100 feet; therefore, impact to groundwater is unlikely.
- There are no potential receptors located within 1,000 feet of the site.
- Residual hydrocarbons in the soil at the bottom of the excavation will degrade by natural attenuation with minimal risk to the environment.

ATTACHMENT

Revised Field Pit Assessment Form
Field Pit Remediation/Closure Form

Field Pit Assessment Form
Laboratory Analytical Results

REVISED

FIELD PIT SITE ASSESSMENT FORM

GENERAL

Meter: 97334 Location: Wayne Moore Gas Unit #1
Operator #: _____ Operator Name: _____ P/L District: _____
Coordinates: Letter: N Section 16 Township: 31 Range: 9
Or Latitude _____ Longitude _____
Pit Type: Dehydrator _____ Location Drip: _____ Line Drip: _____ Other: _____
Site Assessment Date: 4/14/98 Area: _____ Run: _____

NMOCD Zone:
(From NMOCD
Maps)

Land Type:

Inside ☐ (1)
Outside ☒ (2)

BLM ☐ (1)
State ☒ (2)
Fee ☐ (3)
Indian ☐

Depth to Groundwater

Less Than 50 Feet (20 points) ☐ (1)
50 Ft to 99 Ft (10 points) ☐ (2)
Greater Than 100 Ft (0 points) ☒ (3)

Wellhead Protection Area

Is it less than 1000 ft from wells, springs or other sources of fresh water extraction?, or; Is it less than 200 ft from a private domestic water source?

☐ (1) YES (20 points) ☒ (2) NO (0 points)

Horizontal Distance to Surface Water Body

Less Than 200 Ft (20 points) ☐ (1)
200 Ft to 1000 Ft (10 points) ☐ (2)
Greater Than 1000 Ft (0 points) ☒ (3)

Name of Surface Water Body _____

(Surface Water Body: Perennial Rivers, Streams, Creeks, Irrigation Canals, Ditches, Lakes, Ponds)

Distance to Nearest Ephemeral Stream ☐ (1) < 100' (Navajo Pits Only)
☐ (2) > 100'

TOTAL HAZARD RANKING SCORE: 0 **POINTS**

REMARKS

Remarks : Site has been re-assessed, due to initial assessment including washes as a Surface Water Body. Site is $>100'$ vertical from center of Kirk Canyon.

FIELD PIT SITE ASSESSMENT FORM

GENERAL	<p>Meter: <u>97-334</u> Location: <u>Wayne Moore Gas Unit, Well No. 1</u> Operator #: <u>0263</u> Operator Name: <u>Texaco E&P</u> P/L District: <u>Aztec</u> Coordinates: Letter: <u>N</u> Section <u>16</u> Township: <u>31</u> Range: <u>9</u> Or Latitude _____ Longitude _____ Pit Type: Dehydrator _____ Location Drip: <u>X</u> Line Drip: _____ Other: _____ Site Assessment Date: <u>8/29/94</u> Area: <u>04</u> Run: <u>83</u></p>
SITE ASSESSMENT	<p>NMOCD Zone: (From NMOCD Maps) Inside <input type="checkbox"/> (1) Outside <input checked="" type="checkbox"/> (2)</p> <p>Land Type: BLM <input type="checkbox"/> (1) State <input checked="" type="checkbox"/> (2) Fee <input type="checkbox"/> (3) Indian _____</p> <p>Depth to Groundwater Less Than 50 Feet (20 points) <input type="checkbox"/> (1) 50 Ft to 99 Ft (10 points) <input checked="" type="checkbox"/> (2) Greater Than 100 Ft (0 points) <input type="checkbox"/> (3)</p> <p>Wellhead Protection Area : Is it less than 1000 ft from wells, springs, or other sources of fresh water extraction? , or ; Is it less than 200 ft from a private domestic water source? <input type="checkbox"/> (1) YES (20 points) <input checked="" type="checkbox"/> (2) NO (0 points)</p> <p>Horizontal Distance to Surface Water Body Less Than 200 Ft (20 points) <input checked="" type="checkbox"/> (1) 200 Ft to 1000 Ft (10 points) <input type="checkbox"/> (2) Greater Than 1000 Ft (0 points) <input type="checkbox"/> (3)</p> <p>Name of Surface Water Body <u>Kirk Canyon</u> (Surface Water Body : Perennial Rivers, Major Wash, Streams, Creeks, Irrigation Canals, Ditches, Lakes, Ponds) Distance to Nearest Ephemeral Stream <input type="checkbox"/> (1) < 100' (Navajo Pits Only) <input type="checkbox"/> (2) > 100'</p> <p>TOTAL HAZARD RANKING SCORE: <u>30</u> POINTS</p>
REMARKS	<p>Remarks : <u>Redline Book - Inside</u> <u>Vulnerable Zone - Outside</u> <u>Six pits, location drip pit is dry, will close one</u> <u>pit.</u></p> <p style="text-align: right;"><u>PUSH IN</u></p>

ORIGINAL PIT LOCATION

Original Pit : a) Degrees from North 180° Footage from Wellhead 88'
 b) Length : 28' Width : 17' Depth : 3'

ORIGINAL PIT LOCATION

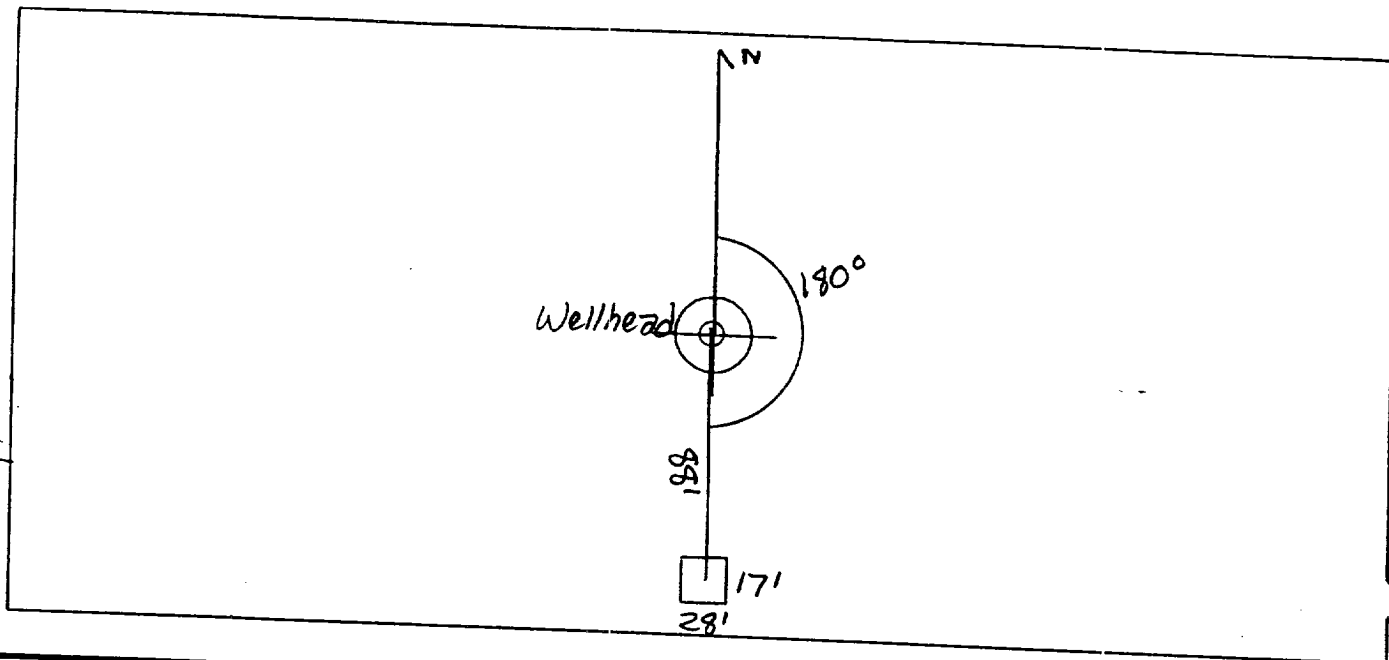

REMARKS

Remarks :

Pictures @ 1438 (21-24, R0111)

Dump Truck

Location on front of sheet is from the topo map.

Sign indicates letter K, meter is not shown in the redline book.

Completed By:

Sarah Kelly

Signature

8/29/94

Date

FIELD PIT REMEDIATION/CLOSURE FORM

GENERAL	<p>Meter: <u>97334</u> Location: <u>Wayne Moore GAS Unit Well #1</u></p> <p>Coordinates: Letter: <u>N</u> Section <u>16</u> Township: <u>31</u> Range: <u>9</u></p> <p>Or Latitude _____ Longitude _____</p> <p>Date Started : <u>9/30/94</u> Run: <u>04</u> <u>83</u></p>
FIELD OBSERVATIONS	<p>Sample Number(s): <u>KD 299</u></p> <p>Sample Depth: <u>4'</u> Feet</p> <p>Final PID Reading <u>279 ppm</u> PID Reading Depth <u>4'</u> Feet</p> <p style="text-align: center;">Yes No</p> <p>Groundwater Encountered <input type="checkbox"/> <input checked="" type="checkbox"/> Approximate Depth _____ Feet</p>
CLOSURE	<p>Remediation Method :</p> <p>Excavation <input type="checkbox"/> Approx. Cubic Yards _____</p> <p>Onsite Bioremediation <input type="checkbox"/></p> <p>Backfill Pit Without Excavation <input checked="" type="checkbox"/></p> <p>Soil Disposition:</p> <p>Envirotech <input type="checkbox"/> Tierra <input type="checkbox"/></p> <p>Other Facility <input type="checkbox"/> Name: _____</p> <p>Pit Closure Date: <u>9/30/94</u> Pit Closed By: <u>ISEI</u></p>
REMARKS	<p>Remarks : <u>Excavated test hole to 4', hit Sand Stone, took pid sample, closed pit.</u></p>
	<p>Signature of Specialist: <u>[Signature]</u></p>



CHAIN OF CUSTODY RECORD

[illegible]



FIELD SERVICES LABORATORY

ANALYTICAL REPORT

PIT CLOSURE PROJECT - Soil Samples Outside the GWV Zone

SAMPLE IDENTIFICATION

	Field ID	Lab ID
SAMPLE NUMBER:	KD 299	946289
MTR CODE SITE NAME:	97334	N/A
SAMPLE DATE TIME (Hrs):	9-30-94	1315
SAMPLED BY:	N/A	
DATE OF TPH EXT. ANAL.:	10-3-94	
DATE OF BTEX EXT. ANAL.:	N/A	N/A
TYPE DESCRIPTION:	VG	Black sand & clay

REMARKS:

RESULTS

PARAMETER	RESULT	UNITS	QUALIFIERS			
			DF	Q	M(g)	V(ml)
TPH (418.1)	45900	MG/KG			0.20	28
HEADSPACE PID	279	PPM				
PERCENT SOLIDS	88.3	%				

-- TPH is by EPA Method 418.1 --

Narrative:

DF = Dilution Factor Used

Approved By: 

Date: 10/6/94