

STATE OF NEW MEXICO
OIL CONSERVATION
COMMISSION

DISTRICT NO. 3
Phone 99 P. O. Box 697
AZTEC, NEW MEXICO

(SUBMIT IN TRIPLICATE)

UNITED STATES
DEPARTMENT OF THE INTERIOR
GEOLOGICAL SURVEY

Land Office Santa Fe 078508

Lease No. 078508

Unit W¹ Sec. 13, T-31-N.,
R-9-W., N.M.P.M.

SUNDRY NOTICES AND REPORTS ON WELLS

NOTICE OF INTENTION TO DRILL.....	<input checked="" type="checkbox"/>	SUBSEQUENT REPORT OF WATER SHUT-OFF.....	
NOTICE OF INTENTION TO CHANGE PLANS.....		SUBSEQUENT REPORT OF SHOOTING OR ACIDIZING.....	
NOTICE OF INTENTION TO TEST WATER SHUT-OFF.....		SUBSEQUENT REPORT OF ALTERING CASING.....	
NOTICE OF INTENTION TO RE-DRILL OR REPAIR WELL.....		SUBSEQUENT REPORT OF REDRILLING OR REPAIR.....	
NOTICE OF INTENTION TO SHOOT OR ACIDIZE.....		SUBSEQUENT REPORT OF ABANDONMENT.....	
NOTICE OF INTENTION TO PULL OR ALTER CASING.....		SUPPLEMENTARY WELL HISTORY.....	
NOTICE OF INTENTION TO ABANDON WELL.....			

(INDICATE ABOVE BY CHECK MARK NATURE OF REPORT, NOTICE, OR OTHER DATA)

September 19, 1952

Well No. 1 Nordhaus is located 990 ft. from N line and 1650 ft. from W line of sec. 13

SE¹ SW¹ Sec. 13
(1/4 Sec. and Sec. No.)
Blanco

31 North 9 West
(Twp.) (Range)
San Juan County

T.M.P.M.
(Meridian)

New Mexico
(State or Territory)

The elevation of the derrick floor above sea level is _____ ft. to be furnished

DETAILS OF WORK

(State names of and expected depths to objective sands; show sizes, weights, and lengths of proposed casings; indicate mudlogging jobs, cementing points, and all other important proposed work)

The objective sands are the Cliff House and the Point Lookout and their respective tops are expected at about 5075' and 5675'. The casing program is as follows:
175' of 2-5/8" O.D. casing cemented to top
5075' of 5 1/2" O.D. casing cemented with 200 sacks

Well will be drilled with rotary tools to the top of the Cliff House at about 5075', and the pay sands will be drilled with rotary tools using natural gas method to a total depth of approximately 5950'.

Well will then be shot with approximately 1800 quarts of nitro from 5125' to total depth.

It is recommended that this plan of work must receive approval in writing by the Geological Survey before operations may be commenced.

Company SOUTHERN UNION GAS COMPANY

Address 3521 104th St. E.

OIL CON. COM.
DIST. 3
Dallas 1, Texas

By Van Thompson
Title Manager, Exploration Department

Land Office
Lease No.
Unit

DEPARTMENT OF THE INTERIOR
GEOLOGICAL SURVEY
UNITED STATES
BUREAU OF LAND MANAGEMENT

COOPERATION
COMMISSION
UNITED STATES
GEOLOGICAL SURVEY
BUREAU OF LAND MANAGEMENT
LAND OFFICE
LEASE NO.
UNIT

SUNDRY NOTES AND REPORTS ON WELLS

1. NAME OF WELL	2. LOCATION	3. DATE	4. NAME OF OPERATOR
5. DEPTH	6. DIAMETER	7. TYPE OF WELL	8. PURPOSE
9. WATER LEVEL	10. FLOW RATE	11. TEMPERATURE	12. COMMENTS

1. NAME OF WELL
2. LOCATION
3. DATE
4. NAME OF OPERATOR
5. DEPTH
6. DIAMETER
7. TYPE OF WELL
8. PURPOSE
9. WATER LEVEL
10. FLOW RATE
11. TEMPERATURE
12. COMMENTS

1. NAME OF WELL
2. LOCATION
3. DATE
4. NAME OF OPERATOR
5. DEPTH
6. DIAMETER
7. TYPE OF WELL
8. PURPOSE
9. WATER LEVEL
10. FLOW RATE
11. TEMPERATURE
12. COMMENTS

1. NAME OF WELL
2. LOCATION
3. DATE
4. NAME OF OPERATOR
5. DEPTH
6. DIAMETER
7. TYPE OF WELL
8. PURPOSE
9. WATER LEVEL
10. FLOW RATE
11. TEMPERATURE
12. COMMENTS

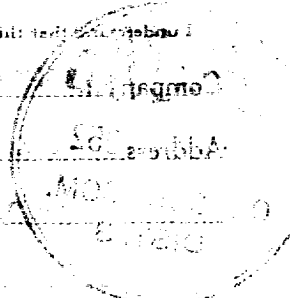

Company Southern Union Gas Company
Lease Nordhaus Well No. 1
Sec. 13 T. 31 N. R. 9 W., N.M.P.M.
Location 990' from the South line and 1650' from
the West line.

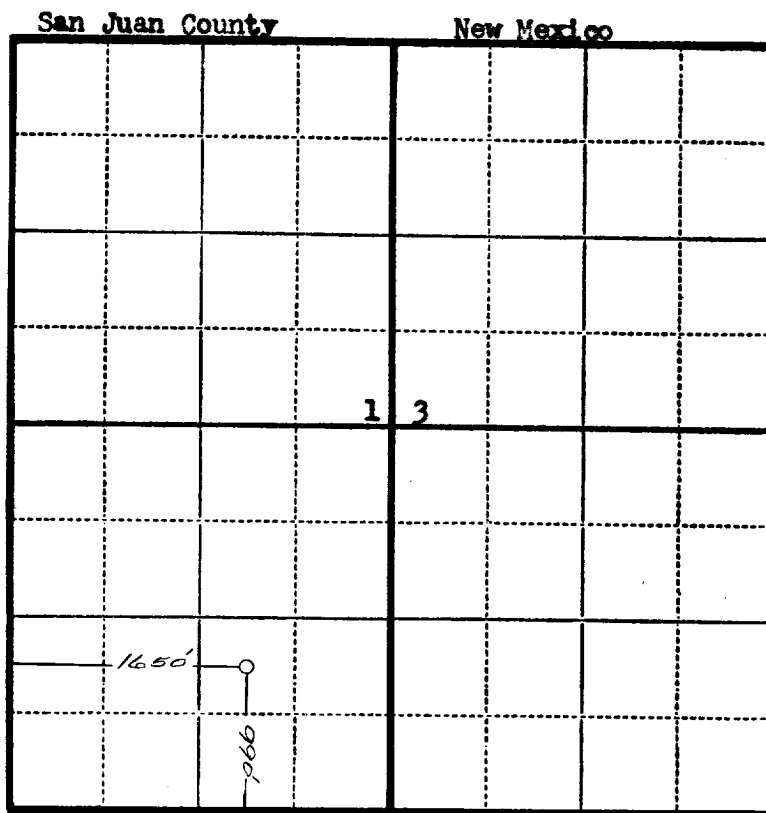

Scale—4 inches equals 1 mile.

This is to certify that the above plat was prepared from field notes of actual surveys made by me or under my supervision and that the same are true and correct to the best of my knowledge and belief.

Charles J. Pinklea

Seal:

Registered Professional
Engineer and Land Surveyor.

Charles J. Pinklea
N. Mex. Reg. No. 1302

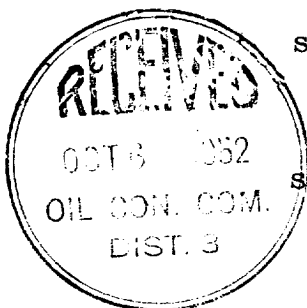

Surveyed September 13, 19 52