

(SUBMIT IN TRIPLICATE)

UNITED STATES
DEPARTMENT OF THE INTERIOR
GEOLOGICAL SURVEY

Land Office San Juan Co.

Lense No. 070508

Unit 1/2 Sec. 12, T-11N, R-9W,
N.M.P.M., San Juan Co.,
New Mexico

SUNDRY NOTICES AND REPORTS ON WELLS

NOTICE OF INTENTION TO DRILL.....	<input checked="" type="checkbox"/>	SUBSEQUENT REPORT OF WATER SHUT-OFF.....	
NOTICE OF INTENTION TO CHANGE PLANS.....		SUBSEQUENT REPORT OF SHOOTING OR ACIDIZING.....	
NOTICE OF INTENTION TO TEST WATER SHUT-OFF.....		SUBSEQUENT REPORT OF ALTERING CASING.....	
NOTICE OF INTENTION TO RE-DRILL OR REPAIR WELL.....		SUBSEQUENT REPORT OF RE-DRILLING OR REPAIR.....	
NOTICE OF INTENTION TO SHOOT OR ACIDIZE.....		SUBSEQUENT REPORT OF ABANDONMENT.....	
NOTICE OF INTENTION TO PULL OR ALTER CASING.....		SUPPLEMENTARY WELL HISTORY.....	
NOTICE OF INTENTION TO ABANDON WELL.....			

(INDICATE ABOVE BY CHECK MARK NATURE OF REPORT, NOTICE, OR OTHER DATA)

April 24, 1957

Well No. 5 ~~is~~ located 850 ft. from N line and 850 ft. from E line of sec. 12

3/4 3/4 Section 12 11E 24 N.M.P.M.
(1/4 Sec. and Sec. No.) (Twp.) (Range) (Meridian)

Blanco Mesa San Juan County New Mexico
(Field) (County or Subdivision) (State or Territory)

The elevation of the derrick floor above sea level is _____ ft. To be determined.

DETAILS OF WORK

(State names of and expected depths to objective sands; show sizes, weights, and lengths of proposed casings; indicate mudding jobs, cementing points, and all other important proposed work)

The objective sands are the Cliff House and Point Lookout anticipated at approximately 5800' and 5585' respectively.

Proposed Casing Program: 200' 10-3/4" cemented to the surface
3300' 7-5/8" cemented with 150 sacks
5800' 5-1/2" cemented with 300 sacks

We propose to drill with Rotary Tools employing mud through the Pictorial and gas drill to an estimated total depth of 5800'.

The well will be perforated and sand freed to stimulate production.

I understand that this plan of work must receive approval in writing by the Geological Survey before operations may be commenced.

Company STANLEY UNION GAS COMPANY

Address 1001 WEST BUILDING

DALLAS, TEXAS

By L. S. Munnink
L. S. Munnink
Title Exploration Engineer

NEW MEXICO
OIL CONSERVATION COMMISSION

Form C-128

Well Location and/or Gas Proration Plat

Date April 24, 1957

Operator SOUTHERN UNION GAS CO. Lease Nordhaus

Well No. 5 Section 12 Township 31 NORTH Range 9 WEST NMPM

Located 850 Feet From the SOUTH Line, 810 Feet From the WEST Line,

SAN JUAN County, New Mexico. G. L. Elevation To be determined

Name of Producing Formation Mesaverde Pool Blanco Dedicated Acreage 320

(Note: All distances must be from outer boundaries of Section)

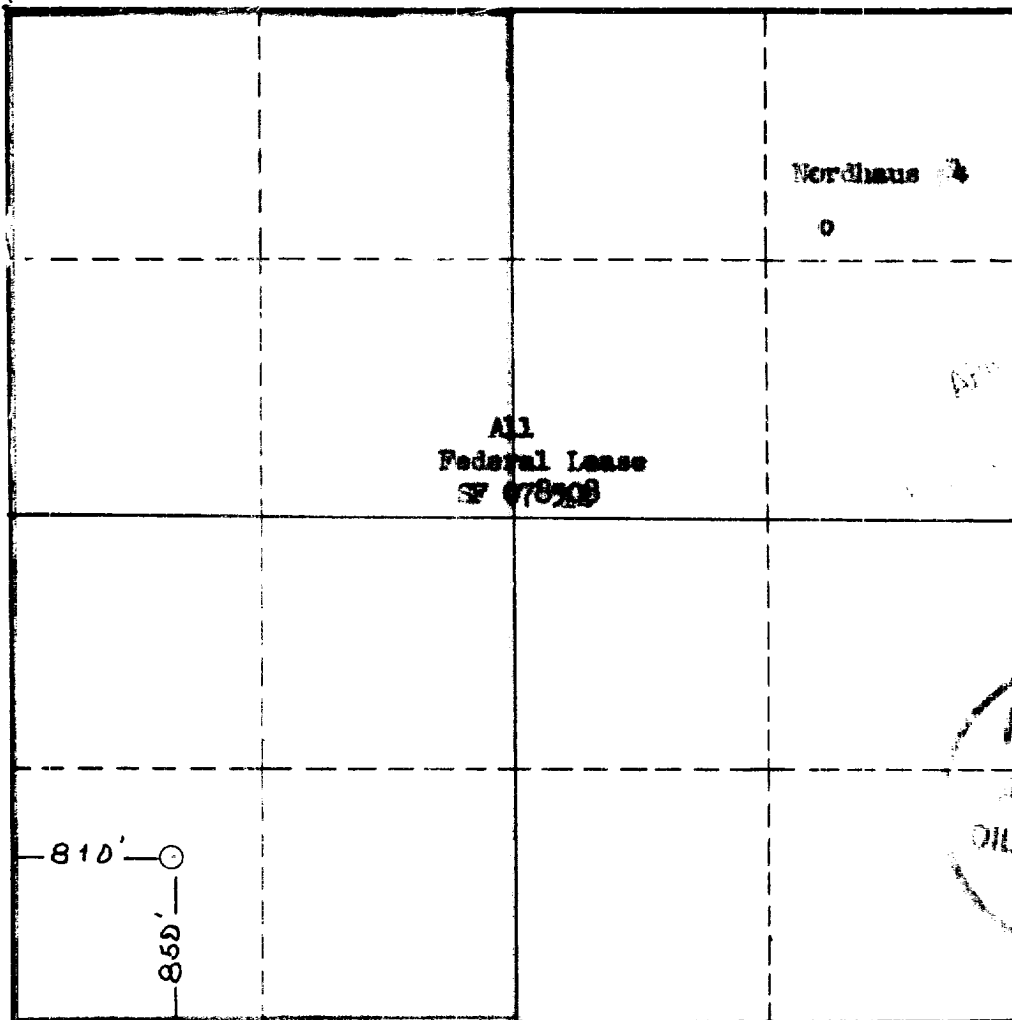

NOTE

This section of form is to be used for gas wells only.

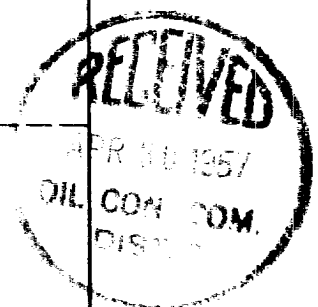

1. Is this Well a Dual Comp. ? Yes No x

2. If the answer to Question 1 is yes, are there any other dually completed wells within the dedicated acreage ? Yes No

Name J. A. Muenich, L. S. Muenich
Position Exploration Engineer
Representing Southern Union Gas Company
Address 1001 Bart Bldg., Dallas, Texas

This is to certify that the above plat was prepared from field notes of actual surveys made by me or under my supervision and that the same are true and correct to the best of my knowledge and belief.

Date Surveyed 31 MARCH 1957
James P. Lease
Registered Professional Engineer and/or Land Surveyor
James P. Lease
N. Mex. Reg. No. 1463