

P. O. Box 965  
Farmington, New Mexico

August 3, 1956

Southern Union Gas Company  
1001 Hurt Building  
Dallas, Texas

RE: Santa Fe 078508

Gentlemen:

Receipt is acknowledged of your "Notice of Intention to Drill" dated July 31, 1956 covering your well No. 2 Nordhaus in NW $\frac{1}{4}$  SW $\frac{1}{4}$  sec. 11, T. 31 N., R. 9 W., N. M. P. M., San Juan County, New Mexico, Blanco pool.

Your proposed work is hereby approved subject to compliance with the provisions of the "Oil and Gas Operating Regulations" revised May 25, 1942, a copy of which will be sent to you on request, and subject to the following conditions:

1. Drilling operations so authorized are subject to the attached sheet for general conditions of approval.
2. Furnish copies of all logs.

Very truly yours,

P. T. McGrath  
District Engineer

PTMcGrath:al

COPY TO O. C. C.



CONFIDENTIAL

Page 1 of 1

CONFIDENTIAL

Page 1 of 1

CONFIDENTIAL

CONFIDENTIAL

CONFIDENTIAL

CONFIDENTIAL

CONFIDENTIAL

CONFIDENTIAL

CONFIDENTIAL

CONFIDENTIAL



COPY TO O.C.

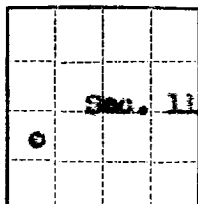

(SUBMIT IN TRIPLICATE)

UNITED STATES  
DEPARTMENT OF THE INTERIOR  
GEOLOGICAL SURVEY

Land Office Santa Fe  
Lease No. SP 078908  
Unit W/2 Sec. 11, T-31N,  
R-1E, San Juan Co.,  
New Mexico

SUNDRY NOTICES AND REPORTS ON WELLS

NOTICE OF INTENTION TO DRILL.....	<input checked="" type="checkbox"/>	SUBSEQUENT REPORT OF WATER SHUT-OFF.....	
NOTICE OF INTENTION TO CHANGE PLANS.....		SUBSEQUENT REPORT OF SHOOTING OR ACIDIZING.....	
NOTICE OF INTENTION TO TEST WATER SHUT-OFF.....		SUBSEQUENT REPORT OF ALTERING CASING.....	
NOTICE OF INTENTION TO RE-DRILL OR REPAIR WELL.....		SUBSEQUENT REPORT OF RE-DRILLING OR REPAIR.....	
NOTICE OF INTENTION TO SHOOT OR ACIDIZE.....		SUBSEQUENT REPORT OF ABANDONMENT.....	
NOTICE OF INTENTION TO PULL OR ALTER CASING.....		SUPPLEMENTARY WELL HISTORY.....	
NOTICE OF INTENTION TO ABANDON WELL.....			

(INDICATE ABOVE BY CHECK MARK NATURE OF REPORT, NOTICE, OR OTHER DATA)

July 31, 1956

Well No. 2 Nordhaus is located 1605 ft. from N line and 600 ft. from W line of sec. 11  
SW/4 NW/4 Section 11 31-N 7-W N.M.P.M.  
(1/4 Sec. and Sec. No.) (Twp.) (Range) (Meridian)  
Blanco San Juan New Mexico  
(Field) (County or Subdivision) (State or Territory)

The elevation of the derrick floor above sea level is \_\_\_\_\_ ft. To be determined.

DETAILS OF WORK

(State names of and expected depths to objective sands; show sizes, weights, and lengths of proposed casings; indicate mudding jobs, cementing points, and all other important proposed work)

The objective sands are the Cliff House and Point Lookout anticipated at approximately 3135' and 3600' respectively.

Proposed Casing Program: 200' 10-3/4" Cemented to surface  
3300' 7-5/8" Cemented with 150 sacks  
6200' 5-1/2" Cemented with 300 sacks

We propose to drill with Rotary Tools employing mud through the Pictured Cliffs and gas drill to total depth. Well will be perforated and sand fraced to stimulate production.

W/2 of Section 11 is to be dedicated to this well.

I understand that this plan of work must receive approval in writing by the Geological Survey before operations may be commenced.

Company Southern Union Gas Company

Address 1001 Burt Building

Dallas, Texas

By

A. E. Victor

Title Manager, Exploration Dept.

NEW MEXICO  
OIL CONSERVATION COMMISSION

Form C-128

Well Location and/or Gas Proration Plat

Date July 31, 1956

Operator Southern Union Gas Company Lease Nordhaus

Well No. 2 Section 11 Township 31 North Range 9 West NMPM

Located 1605 Feet From South Line, 800 Feet From West Line,

San Juan County, New Mexico. G. L. Elevation To be determined

Name of Producing Formation Mesa Verde Pool Blanco Dedicated Acreage 320

(Note: All distances must be from outer boundaries of Section)

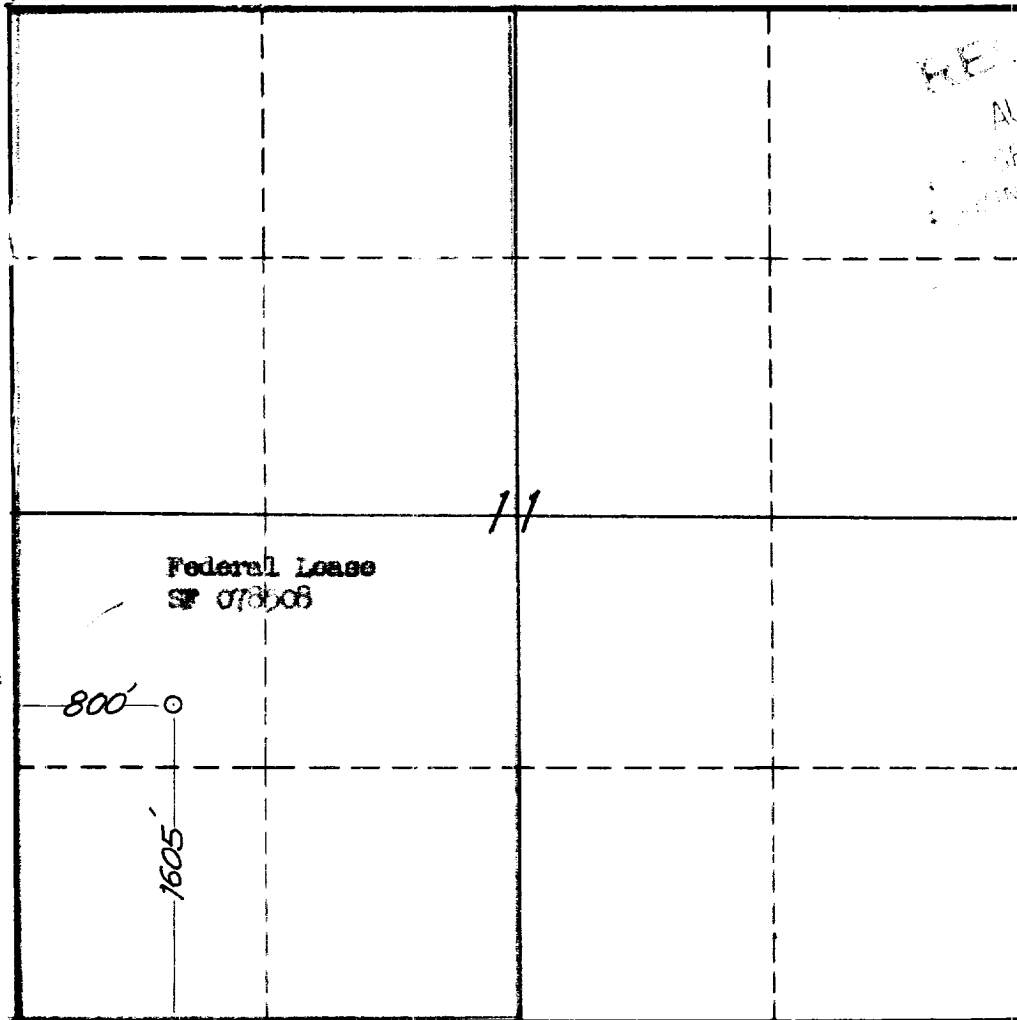

NOTE

This section of form is to be used for gas wells only.



SCALE: 1"=1000'

1. Is this Well a Dual Comp. ? Yes    No X.
2. If the answer to Question 1 is yes, are there any other dually completed wells within the dedicated acreage? Yes    No   .

Name A.M. Wiederkehr  
Position Manager, Exploration Dept.  
Representing Southern Union Gas Company  
Address 1001 Hurt Bldg., Dallas, Texas

This is to certify that the above plat was prepared from field notes of actual surveys made by me or under my supervision and that the same are true and correct to the best of my knowledge and belief.

Date Surveyed July 16, 1956  
James P. Reese  
Registered Professional Engineer and/or Land Surveyor