

Land Office San Juan

Lease No. SP 070310

Unit 2 1/2 Sec. 7, T31N, R9W,
S.M.P.M., San Juan Co.,
New Mexico

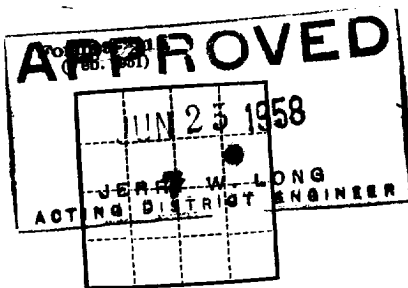

(SUBMIT IN TRIPLICATE)

UNITED STATES
DEPARTMENT OF THE INTERIOR
GEOLOGICAL SURVEY

SUNDRY NOTICES AND REPORTS ON WELLS RECEIVED
JUN 25 1958

U. S. GEOLOGICAL SURVEY FARMINGTON, NEW MEXICO	
NOTICE OF INTENTION TO DRILL	<input checked="" type="checkbox"/>
NOTICE OF INTENTION TO CHANGE PLANS	
NOTICE OF INTENTION TO TEST WATER SHUT-OFF	
NOTICE OF INTENTION TO RE-DRILL OR REPAIR WELL	
NOTICE OF INTENTION TO SHOOT OR ACIDIZE	
NOTICE OF INTENTION TO PULL OR ALTER CASING	
NOTICE OF INTENTION TO ABANDON WELL	
SUBSEQUENT REPORT OF WATER SHUT-OFF	
SUBSEQUENT REPORT OF SHOOTING OR ACIDIZING	
SUBSEQUENT REPORT OF ALTERING CASING	
SUBSEQUENT REPORT OF RE-DRILLING OR REPAIR	
SUBSEQUENT REPORT OF ABANDONMENT	
SUPPLEMENTARY WELL HISTORY	

(INDICATE ABOVE BY CHECK MARK NATURE OF REPORT, NOTICE, OR OTHER DATA)

Well No. 2 General is located 1765 ft. from N line and 1140 ft. from E line of sec. 7

2 1/2 Sec. 7
(1/4 Sec. and Sec. No.)

31N
(Twp.)

9W
(Range)

S.M.P.M.
(Meridian)

San Juan
(Field)

San Juan
(County or Subdivision)

New Mexico
(State or Territory)

The elevation of the derrick floor above sea level is 5440 ft. G.L.

DETAILS OF WORK

(State names of and expected depths to objective sands; show sizes, weights, and lengths of proposed casings; indicate mudding jobs, cementing points, and all other important proposed work)

The objective sands are the Cliff Sand and Point Locket anticipated at approximately 5440' and 5425' respectively.

Proposed casing program: 500' 10-3/4" cemented to surface
345' 7-5/8" cemented with 150 sacks
345' 5-1/2" cemented with 200 sacks

We propose to drill with rotary tools employing mud through the Pictured Cliffs and gas drill to total depth. Estimated total depth 995'.

The well will be perforated and sand treated to stimulate production.

I understand that this plan of work must receive approval in writing by the Geological Survey before operations may be commenced.

Company SOUTHERN UNION GAS COMPANY

Address 1001 WEST BUILDING

DALLAS, TEXAS

By J. L. Marshall
L. E. Marshall
Title Exploration Engineer

NEW MEXICO OIL CONSERVATION COMMISSION
Well Location and Acreage Dedication Plat

Section A.

Date June 23, 1958

Operator SOUTHERN UNION GAS COMPANY Lease OWARD #2
Well No. _____ Unit Letter H Section 7 Township 31 NORTH Range 8 WEST NMPM
Located 1765 Feet From THE NORTH Line, 1140 Feet From THE EAST Line
County SAN JUAN G. L. Elevation 6440.0 Dedicated Acreage 320 Acres
Name of Producing Formation Messabi Pool Elm

1. Is the Operator the only owner* in the dedicated acreage outlined on the plat below?
Yes xx No _____.
2. If the answer to question one is "no," have the interests of all the owners been consolidated by communitization agreement or otherwise? Yes _____ No _____. If answer is "yes," Type of Consolidation _____
3. If the answer to question two is "no," list all the owners and their respective interests below:
REF. GLO Plat dated: 1953

Owner

Land Description U. S. GEOLOGICAL SURVEY
FARMINGTON, NEW MEX.

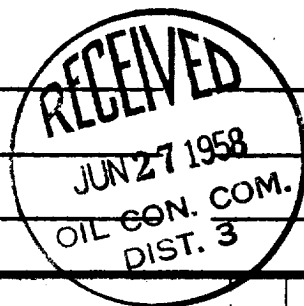

Section B

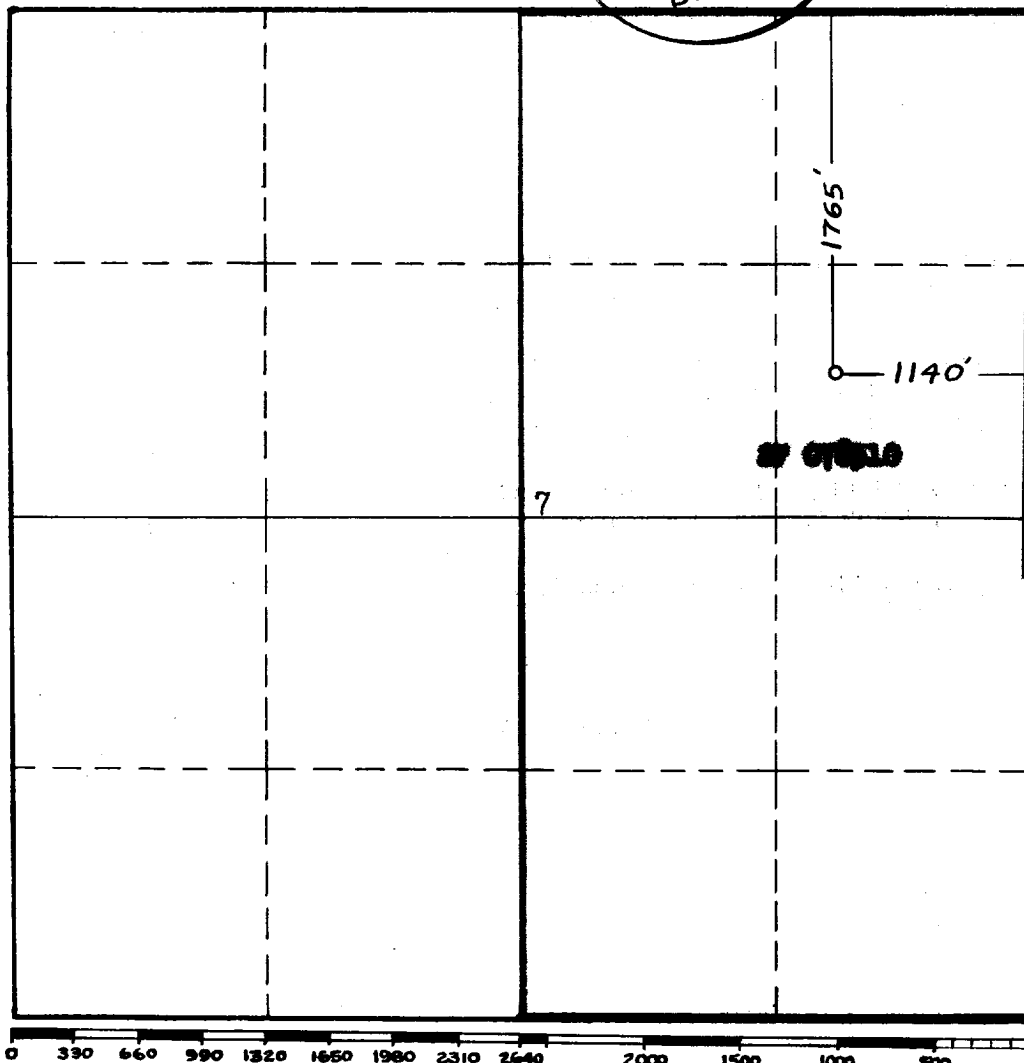

This is to certify that the information in Section A above is true and complete to the best of my knowledge and belief.

SOUTHERN UNION GAS COMPANY
(Operator)
El Muenich
(Representative)
Engineer
East 1140', Dallas, Texas
Address

This is to certify that the well location shown on the plat in Section B was plotted from field notes of actual surveys made by me or under my supervision and that the same is true and correct to the best of my knowledge and belief.

Date Surveyed 30 MARCH 1958

James P. Leese
(Registered Professional
Engineer and/or Land Surveyor.)

JAMES P. LEESE

Certificate No. 1463

(See instructions for completing this form on the reverse side)

INSTRUCTIONS FOR COMPLETION:

1. Operator shall furnish and certify to the information called for in Section A.
2. Operator shall outline the dedicated acreage for both oil and gas wells on the plat in Section B.
3. A registered professional engineer or land surveyor registered in the State of New Mexico or approved by the Commission shall show on the plat the location of the well and certify this information in the space provided.
4. All distances shown on the plat must be from the outer boundaries of Section.
5. If additional space is needed for listing owners and their respective interests as required in question 3, Section A, please use space below

* "Owner" means the person who has the right to drill into and to produce from any pool and to appropriate the production either for himself or for himself and another. (65-3-29 (e) NMSA 1953 Comp.)