

NEW MEXICO OIL CONSERVATION COMMISSION  
Well Location and Acreage Dedication Plat

Form C-128  
Revised 5/1/57

Section A.

Date March 20, 1961

Operator BLACKWOOD & NICHOLS CO. Lease NORTHEAST BLANCO UNIT  
Well No. 60-7 Unit Letter A Section 7 Township 31 N. Range 6 W. NMPM  
Located 1090 Feet From north Line, 1250 Feet From east Line  
County San Juan G. L. Elevation 6369 Dedicated Acreage 320 Acres  
Name of Producing Formation Mesa Verde Pool Blanco Mesa Verde

1. Is the Operator the only owner\* in the dedicated acreage outlined on the plat below?  
Yes \_\_\_\_\_ No X
2. If the answer to question one is "no", have the interests of all the owners been consolidated by communitization agreement or otherwise? Yes X No \_\_\_\_\_. If answer is "yes", Type of Consolidation Unitization
3. If the answer to question two is "no", list all the owners and their respective interests below:

Owner

Land Description



RECEIVED

U. S. GEOLOGICAL SURVEY  
FARMINGTON, NEW MEXICO

Section B

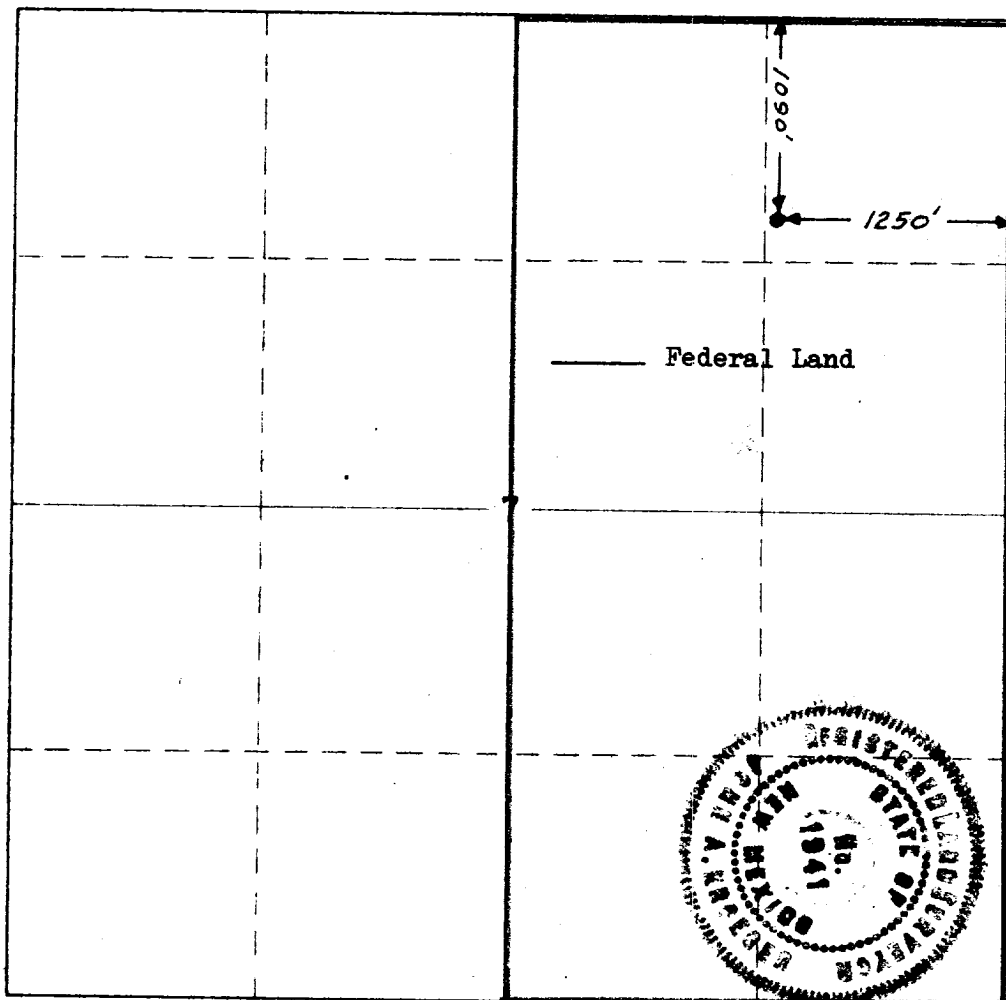

This is to certify that the information in Section A above is true and complete to the best of my knowledge and belief.

Blackwood & Nichols Company  
(Operator)

Original Signed  
by DeLasso Loos DeLasso Loos  
(Representative)  
Field Superintendent

P.O. Box 1237, Durango, Colo.  
Address

This is to certify that the well location shown on the plat in Section B was plotted from field notes of actual surveys made by me or under my supervision and that the same are true and correct to the best of my knowledge and belief.

Date Surveyed Mar. 18, 1961

John A. Kroeger  
Registered Land Surveyor  
Durango, Colorado  
Certificate No. 1941

0 330 660 990 1320 1650 1980 2310 2640 2000 1500 1000 500 0