

**EL PASO FIELD SERVICES
PRODUCTION PIT CLOSURE**

Drp
**Florance #59
Meter/Line ID - 75851**

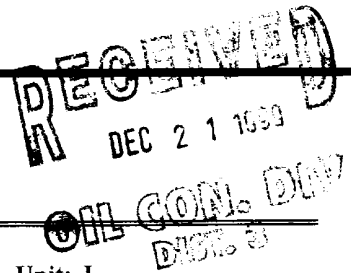

SITE DETAILS

**Legals - Twn: 30N
NMOCD Hazard Ranking: 0
Operator: Amoco**

Rng: 9W

**Sec: 23 Unit: J
Land Type: BLM
Pit Closure Date: 5/19/94**

RATIONALE FOR RISK-BASED CLOSURE

The pit noted above was assessed and ranked according to the criteria in the New Mexico Oil Conservation Division's (NMOCD) Unlined Surface Impoundment Closure Guidelines.

A test pit was excavated to 7' where bedrock was encountered. The excavation was terminated at 7' and a soil sample was collected for field headspace analysis and laboratory analysis for TPH. Groundwater was not encountered in the test pit. The pit was backfilled and graded in a manner to direct surface runoff away from the pit area. Headspace analysis indicated an organic vapor content of 204 ppm; laboratory analysis indicated a TPH concentration of 1190 mg/kg.

El Paso Field Services Company (EPFS) requests closure of the above mentioned production pit location for the following reasons:

- The primary source, discharge to the pit, has been removed for over five years.
- Bedrock was encountered in the test excavation at seven feet below ground surface making remediation impractical.
- The test pit was backfilled with clean soil and the former pit area graded to direct surface runoff away from the former pit.
- Source material has been removed from the ground surface, eliminating potential direct contact with livestock and the public.
- Groundwater was not encountered in the test excavation. In addition, the estimated depth to groundwater is greater than 100 feet; therefore, impact to groundwater is unlikely.
- There are no water supply wells or potential surface water receptors within 1,000 feet of the site.
- Residual hydrocarbons in the soil will degrade by natural attenuation with minimal risk to the environment.

ATTACHMENT

Revised Field Pit Assessment Form
Field Pit Remediation/Closure Form

Field Pit Assessment Form
Laboratory Analytical Results

REVISED
FIELD PIT SITE ASSESSMENT FORM

GENERAL	<p>Meter: <u>75851</u> Location: <u>Florance #59</u></p> <p>Operator #: _____ Operator Name: _____ P/L District: _____</p> <p>Coordinates: Letter: <u>J</u> Section <u>23</u> Township: <u>30</u> Range: <u>9</u></p> <p>Or Latitude _____ Longitude _____</p> <p>Pit Type: Dehydrator _____ Location Drip: _____ Line Drip: _____ Other: _____</p> <p>Site Assessment Date: <u>2/26/98</u> Area: _____ Run: _____</p>
SITE ASSESSMENT	<p>NMOCD Zone: (From NMOCD Maps)</p> <p style="margin-left: 150px;">Inside <input type="checkbox"/> (1)</p> <p style="margin-left: 150px;">Outside <input checked="" type="checkbox"/> (2)</p> <p style="margin-left: 150px;">Land Type: BLM <input checked="" type="checkbox"/> (1)</p> <p style="margin-left: 150px;">State <input type="checkbox"/> (2)</p> <p style="margin-left: 150px;">Fee <input type="checkbox"/> (3)</p> <p style="margin-left: 150px;">Indian _____</p> <p>Depth to Groundwater</p> <p>Less Than 50 Feet (20 points) <input type="checkbox"/> (1)</p> <p>50 Ft to 99 Ft (10 points) <input type="checkbox"/> (2)</p> <p>Greater Than 100 Ft (0 points) <input checked="" type="checkbox"/> (3)</p> <p>Wellhead Protection Area</p> <p>Is it less than 1000 ft from wells, springs or other sources of fresh water extraction?, or; Is it less than 200 ft from a private domestic water source?</p> <p style="text-align: center;">(1) YES (20 points) <input checked="" type="checkbox"/> (2) NO (0 points)</p> <p>Horizontal Distance to Surface Water Body</p> <p>Less Than 200 Ft (20 points) <input type="checkbox"/> (1)</p> <p>200 Ft to 1000 Ft (10 points) <input type="checkbox"/> (2)</p> <p>Greater Than 1000 Ft (0 points) <input checked="" type="checkbox"/> (3)</p> <p>Name of Surface Water Body _____</p> <p>(Surface Water Body: Perennial Rivers, Streams, Creeks, Irrigation Canals, Ditches, Lakes, Ponds)</p> <p>Distance to Nearest Ephemeral Stream <input type="checkbox"/> (1) < 100' (Navajo Pits Only)</p> <p style="margin-left: 150px;"><input type="checkbox"/> (2) > 100'</p> <p>TOTAL HAZARD RANKING SCORE: <u>0</u> POINTS</p>
REMARKS	<p>Remarks : <u>Site has been re-assessed, due to initial assessment including washes as a Surface Water Body. Site is > 100 vertical feet from center of Pump Canyon.</u></p>

FIELD PIT SITE ASSESSMENT FORM

GENERAL	<p>Meter: <u>75851</u> Location: <u>FLORANCE #59</u></p> <p>Operator #: <u>0203</u> Operator Name: <u>AMOCO</u> P/L District: <u>BLOOMFIELD</u></p> <p>Coordinates: Letter: <u>J</u> Section <u>23</u> Township: <u>30</u> Range: <u>9</u></p> <p>Or Latitude _____ Longitude _____</p> <p>Pit Type: Dehydrator _____ Location Drip: <u>X</u> Line Drip: _____ Other: _____</p> <p>Site Assessment Date: <u>4.26.94</u> Area: <u>10</u> Run: <u>33</u></p>
SITE ASSESSMENT	<p>NMOCD Zone: (From NMOCD Maps)</p> <p>Inside <input type="checkbox"/> (1)</p> <p>Outside <input checked="" type="checkbox"/> (2)</p> <p>Land Type: BLM <input checked="" type="checkbox"/> (1)</p> <p>State <input type="checkbox"/> (2)</p> <p>Fee <input type="checkbox"/> (3)</p> <p>Indian _____</p> <p>Depth to Groundwater</p> <p>Less Than 50 Feet (20 points) <input type="checkbox"/> (1)</p> <p>50 Ft to 99 Ft (10 points) <input type="checkbox"/> (2)</p> <p>Greater Than 100 Ft (0 points) <input checked="" type="checkbox"/> (3)</p> <p>Wellhead Protection Area :</p> <p>Is it less than 1000 ft from wells, springs, or other sources of fresh water extraction? , or ; Is it less than 200 ft from a private domestic water source? <input type="checkbox"/> (1) YES (20 points) <input checked="" type="checkbox"/> (2) NO (0 points)</p> <p>Horizontal Distance to Surface Water Body</p> <p>Less Than 200 Ft (20 points) <input type="checkbox"/> (1)</p> <p>200 Ft to 1000 Ft (10 points) <input checked="" type="checkbox"/> (2)</p> <p>Greater Than 1000 Ft (0 points) <input type="checkbox"/> (3)</p> <p>Name of Surface Water Body <u>UNNAMED DRAINAGE OFF OF PUMP CANYON</u></p> <p>(Surface Water Body : Perennial Rivers, Major Wash, Streams, Creeks, Irrigation Canals, Ditches, Lakes, Ponds)</p> <p>Distance to Nearest Ephemeral Stream <input type="checkbox"/> (1) < 100' (Navajo Pits Only)</p> <p><input type="checkbox"/> (2) > 100'</p> <p>TOTAL HAZARD RANKING SCORE: <u>10</u> POINTS</p>
REMARKS	<p>Remarks : <u>TWO PITS ON LOCATION. WILL CLOSE ONLY ONE. PIT IS DRY.</u></p> <p><u>LOCATION IS UP ON TOP OF MESA OVERLOOKING UNNAMED DRAINAGE OFF OF PUMP CANYON. REDLINE AND TOPO CONFIRMED LOCATION OUTSIDE V.Z.</u></p> <p><u>PUSH !!!</u></p>

ORIGINAL PIT LOCATION

Original Pit : a) Degrees from North 293° Footage from Wellhead 74'
b) Length : 16' Width : 16' Depth : 3'

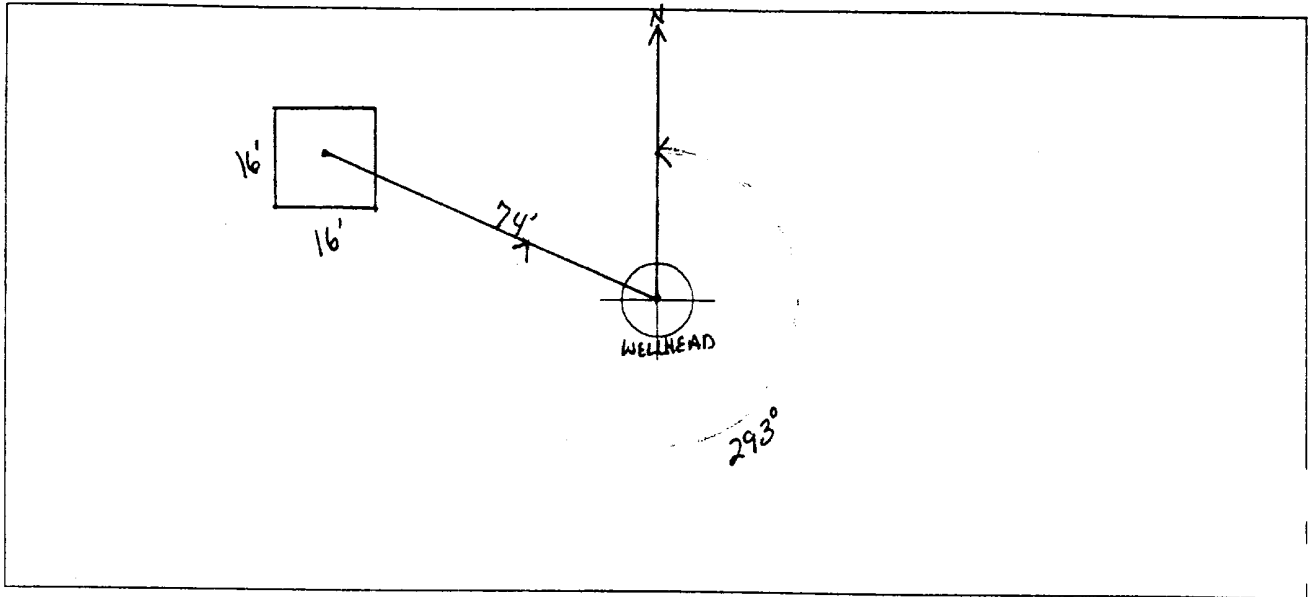

Remarks :

TOOK PICTURES AT 1:04 P.M.

END DUMP

Completed By:

Robert Thompson
Signature

4.26.94
Date

GENERAL	Meter: <u>75851</u> Location: <u>Florence #59</u>
	Coordinates: Letter: <u>J</u> Section <u>23</u> Township: <u>30</u> Range: <u>9</u>
Or Latitude _____ Longitude _____	
Date Started : <u>5-19-94</u> Area: <u>10</u> Run: <u>33</u>	
FIELD OBSERVATIONS	Sample Number(s): <u>1W113</u>
	Sample Depth: <u>20 7'</u> Feet
	Final PID Reading <u>204</u> PID Reading Depth <u>7'</u> Feet
	<p style="text-align: center;">Yes No</p> Groundwater Encountered <input type="checkbox"/> (1) <input checked="" type="checkbox"/> (2) Approximate Depth _____ Feet
CLOSURE	Remediation Method :
	Excavation <input type="checkbox"/> (1) Approx. Cubic Yards _____
	Onsite Bioremediation <input type="checkbox"/> (2)
	Backfill Pit Without Excavation <input checked="" type="checkbox"/> (3)
Soil Disposition:	
Envirotech <input type="checkbox"/> (1) <input type="checkbox"/> (3) Tierra	
Other Facility <input type="checkbox"/> (2) Name: _____	
Pit Closure Date: <u>5-19-94</u> Pit Closed By: <u>BEJ</u>	
REMARKS	Remarks : <u>L.W. markers . 7' h.t rock</u>
Signature of Specialist: <u>Vale Wilson</u>	



FIELD SERVICES LABORATORY
ANALYTICAL REPORT
PIT CLOSURE PROJECT - Soil

SAMPLE IDENTIFICATION

	Field ID	Lab ID
SAMPLE NUMBER:	VW 113	945240
MTR CODE SITE NAME:	75851	N/A
SAMPLE DATE TIME (Hrs):	5-19-94	1035
SAMPLED BY:	N/A	
DATE OF TPH EXT. ANAL.:	5/20/94	5-20-94
DATE OF BTEX EXT. ANAL.:	N/A	N/A
TYPE DESCRIPTION:	VS	Brown Sand & clay

REMARKS:

RESULTS

PARAMETER	RESULT	UNITS	QUALIFIERS			
			DF	Q	M(g)	V(ml)
BENZENE		MG/KG				
TOLUENE		MG/KG				
ETHYL BENZENE		MG/KG				
TOTAL XYLENES		MG/KG				
TOTAL BTEX		MG/KG				
TPH (418.1)	1190	MG/KG			2.20	28
HEADSPACE PID	204	PPM				
PERCENT SOLIDS	86.0	%				

-- TPH is by EPA Method 418.1 and BTEX is by EPA Method 8020 --

The Surrogate Recovery was at N/A % for this sample All QA/QC was acceptable.
Narrative:

DF = Dilution Factor Used

Approved By:

John Larch

Date:

6/15/94