

Denny E. Faust
DEPUTY OIL & GAS INSPECTOR

DEC 22 1997

Approved

Meter Number:75801
Location Name:MANSFIELD #3
Location:TN-30 RG-09
SC-19 UL-P
2 - Federal
NMOCD Zone:OUTSIDE
Hazard Ranking Score:00

RECEIVED
APR 14 1997
OIL CON. DIV.
DIST. 3

**RATIONALE FOR RISK-BASED CLOSURE OF PRODUCTION PITS
LOCATED OUTSIDE OF THE VULNERABLE ZONE
IN THE SAN JUAN BASIN**

This production pit location was ranked according to the criteria in the New Mexico Oil Conservation Division's Unlined Surface Impoundment Closure Guidelines and received a ranking score of zero. The estimated depth to groundwater is greater than 100-feet beneath ground surface (bgs), the pit is not in a well head protection area, and there are no surface water bodies within 1,000 horizontal feet of the pit location.

The primary source, discharge to the pit has been removed. There has been no discharge to the pits for at least 4 years and the pits have been closed for at least one year.

Each pit was backfilled with clean soil and graded in a manner to divert precipitation away from the excavated area. Minimal infiltration of rainfall is expected. Any rainfall that does infiltrate the ground surface must migrate through clean backfill before reaching the residual hydrocarbons.

There is no source material at the ground surface, so direct contact of hydrocarbons with livestock and the populous is not likely.

In general, outside of the vulnerable area and alluvial valleys, bedrock material is generally encountered within 20 feet of the ground surface. Bedrock material in the San Juan Basin consists of interbedded sandstones, shales and clays. According to Freeze and Cherry, 1979, the hydraulic conductivity of the bedrock material are as follows:

Sandstone	10^{-9} to 10^{-13} cm/sec
Shale	10^{-12} to 10^{-16} cm/sec
Clay	10^{-12} to 10^{-15} cm/sec

Based on this information, the residual hydrocarbons should not migrate to groundwater.

Natural process (bioremediation) are degrading the residual hydrocarbon to carbon dioxide and water and will continue until the source is gone, therefore minimizing any impact to the environment.

Based on the above information, it is highly unlikely that any source material will impact groundwater or ever find an exposure pathway to affect human health and therefore El Paso Field Services Company (EPFS) requests closure of this pit location.

FIELD PIT SITE ASSESSMENT FORM

GENERAL	Meter: <u>75801</u> Location: <u>MANSFIELD #3</u> Operator #: _____ Operator Name: _____ P/L District: _____ Coordinates: Letter: _____ Section _____ Township: _____ Range: _____ Or Latitude _____ Longitude _____ Pit Type: Dehydrator _____ Location Drip: _____ Line Drip: _____ Other: _____ Site Assessment Date: _____ Area: <u>10</u> Run: <u>43</u>		
SITE ASSESSMENT	NMOCD Zone: (From NMOCD Maps)		
	Land Type:		
	Inside <input type="checkbox"/> (1) Outside <input checked="" type="checkbox"/> (2)	BLM <input type="checkbox"/> (1) State <input type="checkbox"/> (2) Fee <input type="checkbox"/> (3) Indian _____	
	Depth to Groundwater Less Than 50 Feet (20 points) <input type="checkbox"/> (1) 50 Ft to 99 Ft (10 points) <input type="checkbox"/> (2) Greater Than 100 Ft (0 points) <input type="checkbox"/> (3)		
REMARKS	Wellhead Protection Area : Is it less than 1000 ft from wells, springs, or other sources of fresh water extraction? , or ; Is it less than 200 ft from a private domestic water source? <input type="checkbox"/> (1) YES (20 points) <input type="checkbox"/> (2) NO (0 points)		
	Horizontal Distance to Surface Water Body Less Than 200 Ft (20 points) <input type="checkbox"/> (1) 200 Ft to 1000 Ft (10 points) <input type="checkbox"/> (2) Greater Than 1000 Ft (0 points) <input type="checkbox"/> (3) Name of Surface Water Body _____ (Surface Water Body : Perennial Rivers, Major Wash, Streams, Creeks, Irrigation Canals, Ditches, Lakes, Ponds) Distance to Nearest Ephemeral Stream <input type="checkbox"/> (1) < 100' (Navajo Pits Only) <input type="checkbox"/> (2) > 100' TOTAL HAZARD RANKING SCORE: _____ POINTS		
Remarks : _____ _____ _____			

ORIGINAL PIT LOCATION

Original Pit : a) Degrees from North 276° Footage from Wellhead 108'
 b) Length : 14' Width : 13' Depth : 1'

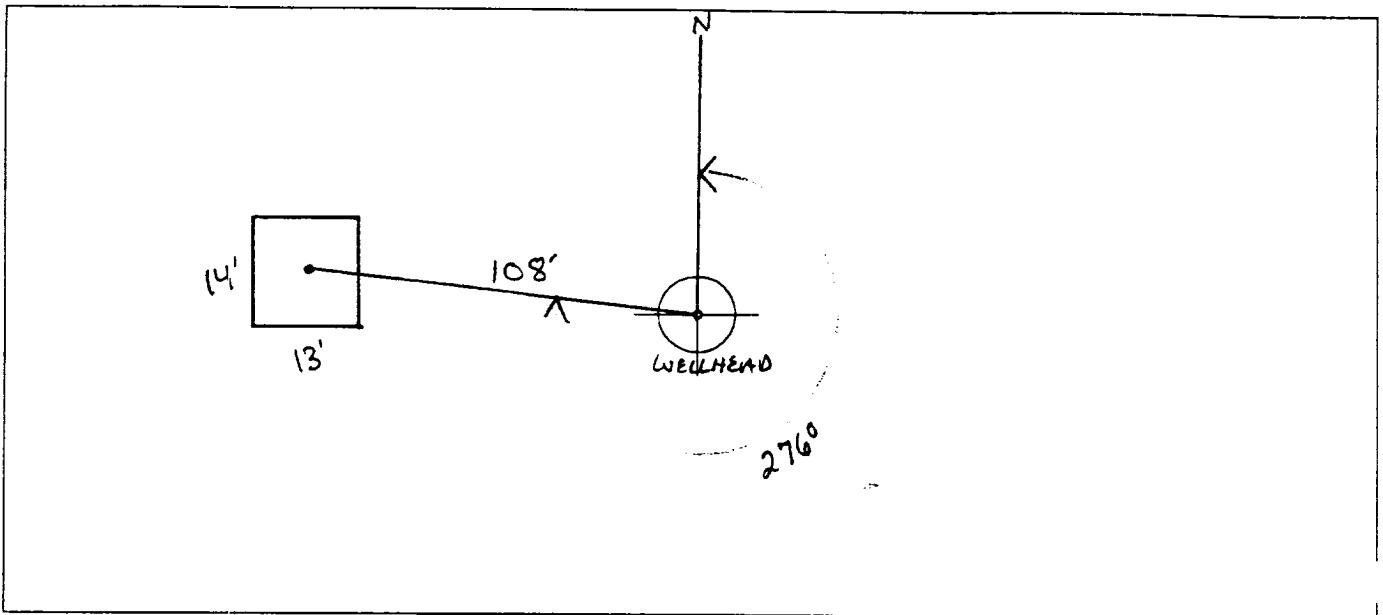

ORIGINAL PIT LOCATION

Remarks :

STARTED TAKING PICTURES AT 11:30 A.M.
END DUMP

REMARKS

Completed By:

Robert Thompson
 Signature

4.19.94
 Date

FIELD PIT REMEDIATION/CLOSURE FORM

GENERAL

Meter: 75801 Location: Manstfield #3
 Coordinates: Letter: P Section 19 Township: 30 Range: 9
 Or Latitude _____ Longitude _____
 Date Started : 5-17-94 Area: 10 Run: 33

FIELD OBSERVATIONS

Sample Number(s): VW86
 Sample Depth: 11' Feet
 Final PID Reading 0 PID Reading Depth 11' Feet
 Yes No
 Groundwater Encountered ☐ (1) ☒ (2) Approximate Depth _____ Feet

CLOSURE

Remediation Method :
 Excavation ☐ (1) Approx. Cubic Yards _____
 Onsite Bioremediation ☐ (2)
 Backfill Pit Without Excavation ☒ (3)
 Soil Disposition:
 Envirotech ☐ (1) ☐ (3) Tierra
 Other Facility ☐ (2) Name: _____
 Pit Closure Date: 5-17-94 Pit Closed By: BEI

REMARKS

Remarks : Long Markers - pit sandstone 11'

Signature of Specialist: Vale Wilson



FIELD SERVICES LABORATORY

ANALYTICAL REPORT

PIT CLOSURE PROJECT - Soil

SAMPLE IDENTIFICATION

SAMPLE NUMBER:

VW86

Lab ID

945203

MTR CODE | SITE NAME:

75801

N/A

SAMPLE DATE | TIME (Hrs):

5-17-94

0930

SAMPLED BY:

N/A

DATE OF TPH EXT. | ANAL.:

5/18/94

5/18/94

DATE OF BTEX EXT. | ANAL.:

N/A

N/A

TYPE | DESCRIPTION:

VG

Brown fine sand

REMARKS:

RESULTS

PARAMETER	RESULT	UNITS	QUALIFIERS			
			DF	Q	M(g)	V(ml)
BENZENE		MG/KG				
TOLUENE		MG/KG				
ETHYL BENZENE		MG/KG				
TOTAL XYLENES		MG/KG				
TOTAL BTEX		MG/KG				
TPH (418.1)	<10	MG/KG			2.15	2E
HEADSPACE PID	0	PPM				
PERCENT SOLIDS	96.7	%				

-- TPH is by EPA Method 418.1 and BTEX is by EPA Method 8020 --

The Surrogate Recovery was at _____ % for this sample All QA/QC was acceptable.

Narrative:

DF = Dilution Factor Used

Approved By:

John F. Ladd

Date:

5/21/94

 Test Method for
 Oil and Grease and Petroleum Hydrocarbons
 in Water and Soil

Perkin-Elmer Model 1600 FT-IR
 Analysis Report

74/05/18 13:57

Sample identification
 745103

Initial mass of sample, g
 0.150

Volume of sample after extraction, ml
 15.000

Petroleum hydrocarbons, ppm
 15.165
 Ref absorbance of hydrocarbons (2930 cm⁻¹)
 1.001

1. Petroleum hydrocarbons spectrum

13:57

