

NO. OF COPIES RECEIVED	5
DISTRIBUTION	
SANTA FE	1
FILE	1 ✓
U.S.G.S.	2
LAND OFFICE	
OPERATOR	1

NEW MEXICO OIL CONSERVATION COMMISSION

Form C-101  
Revised 1-1-65

5A. Indicate Type of Lease  
STATE  FEE

5. State Oil & Gas Lease No.

APPLICATION FOR PERMIT TO DRILL, DEEPEN, OR PLUG BACK

1a. Type of Work DRILL <input type="checkbox"/> DEEPEN <input type="checkbox"/> PLUG BACK <input checked="" type="checkbox"/>			7. Unit Agreement Name		
b. Type of Well OIL WELL <input type="checkbox"/> GAS WELL <input type="checkbox"/> OTHER <input type="checkbox"/> SINGLE ZONE <input checked="" type="checkbox"/> MULTIPLE ZONE <input type="checkbox"/>			8. Farm or Lease Name <b>Lillywhite Gas Com</b>		
2. Name of Operator <b>AMOCO PRODUCTION COMPANY</b>			9. Well No. <b>1</b>		
3. Address of Operator <b>501 Airport Drive, Farmington, New Mexico 87401</b>			10. Field and Pool, or Wildcat <b>Basin Dakota</b>		
4. Location of Well UNIT LETTER <b>C</b> LOCATED <b>1111</b> FEET FROM THE <b>North</b> LINE AND <b>1850</b> FEET FROM THE <b>West</b> LINE OF SEC. <b>13</b> TWP. <b>30N</b> RGE. <b>12W</b> NMPM			12. County <b>San Juan</b>		
19. Proposed Depth <b>4500' PBD</b>		19A. Formation <b>Mesaverde</b>		20. Rotary or C.T.	
21. Elevations (Show whether DF, RT, etc.) <b>5589' GL</b>		21A. Kind & Status Plug. Bond <b>Statewide</b>		21B. Drilling Contractor	
			22. Approx. Date Work will start <b>March 1, 1972</b>		

PROPOSED CASING AND CEMENT PROGRAM

SIZE OF HOLE	SIZE OF CASING	WEIGHT PER FOOT	SETTING DEPTH	SACKS OF CEMENT	EST. TOP
12-1/4"	8-5/8"	24#	380'	230	Surface
7-7/8"	4-1/2"	10.5#	6594'	1500	320' (survey)
				2 Stage DV tool at 4638'	

Upon approval of unorthodox location for a Blanco Mesaverde well, it is intended to plug and abandon the depleted Dakota and recomplete in the Mesaverde. The procedure will be as follows:

1. Run a cement retainer and set it below the Mesaverde, then displace cement into the Dakota perforations.
2. Run logs and perforate indicated producing zones.
3. Sand-water frac the Mesaverde.
4. Swab if necessary and test Mesaverde productivity.

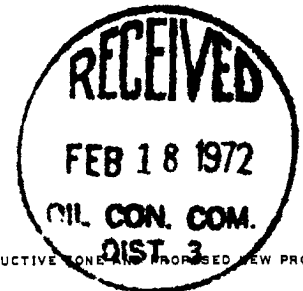

IN ABOVE SPACE DESCRIBE PROPOSED PROGRAM; IF PROPOSAL IS TO DEEPEN OR PLUG BACK, GIVE DATA ON PRESENT PRODUCTIVE ZONE AND PROPOSED NEW PRODUCTIVE ZONE. GIVE BLOWOUT PREVENTER PROGRAM, IF ANY.

I hereby certify that the information above is true and complete to the best of my knowledge and belief.

Signed Area Engineer Title Area Engineer Date February 17, 1972

(This space for State Use)

APPROVED BY [Signature] TITLE Sup. Dist. III DATE 2-18-72

CONDITIONS OF APPROVAL, IF ANY:

Subject to approval of Non-standard location



NEW MEXICO OIL CONSERVATION COMMISSION  
WELL LOCATION AND ACREAGE DEDICATION PLAT

Form C-102  
Supersedes C-128  
Effective 1-1-65

All distances must be from the outer boundaries of the Section.

Operator <b>AMOCO PRODUCTION COMPANY</b>			Lease <b>Lillywhite Gas Com</b>			Well No. <b>1</b>
Unit Letter <b>C</b>	Section <b>13</b>	Township <b>30-N</b>	Range <b>12-W</b>	County <b>San Juan</b>		
Actual Footage Location of Well: <b>1111</b> feet from the <b>North</b> line and <b>1850</b> feet from the <b>West</b> line						
Ground Level Elev. <b>5589'</b>	Producing Formation <b>Mesaverde</b>		Pool <b>Blanco Mesaverde</b>	Dedicated Acreage: <b>320</b> Acres		

1. Outline the acreage dedicated to the subject well by colored pencil or hachure marks on the plat below.
2. If more than one lease is dedicated to the well, outline each and identify the ownership thereof (both as working interest and royalty).
3. If more than one lease of different ownership is dedicated to the well, have the interests of all owners been consolidated by communitization, unitization, force-pooling, etc?

Yes  No If answer is "yes," type of consolidation communitization

If answer is "no," list the owners and tract descriptions which have actually been consolidated. (Use reverse side of this form if necessary.) \_\_\_\_\_

No allowable will be assigned to the well until all interests have been consolidated (by communitization, unitization, forced-pooling, or otherwise) or until a non-standard unit, eliminating such interests, has been approved by the Commission.

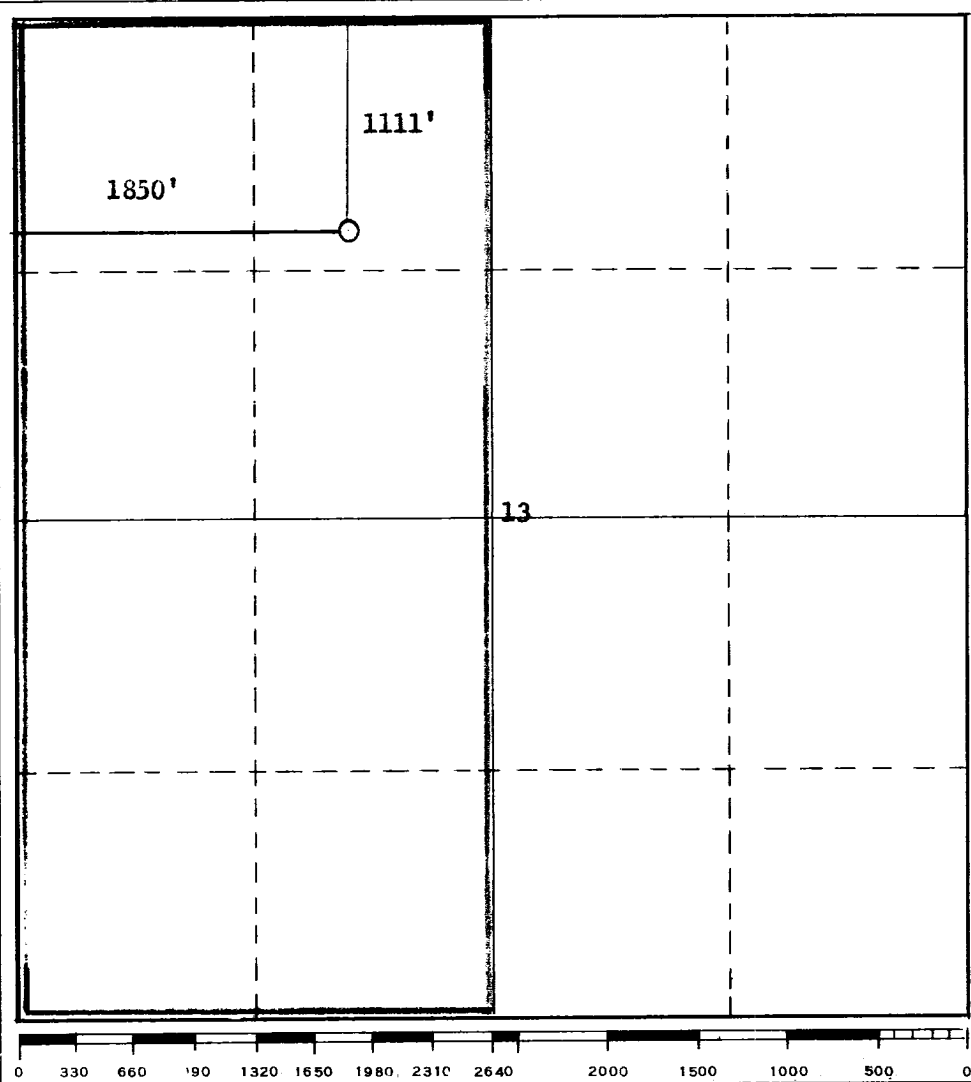
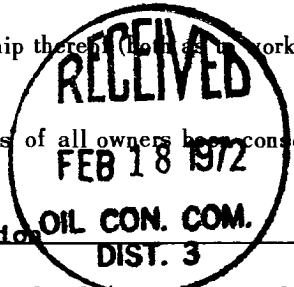

**CERTIFICATION**

*I hereby certify that the information contained herein is true and complete to the best of my knowledge and belief.*

*D. A. Wayhan*

Name  
**D. A. Wayhan**

Position  
**Area Engineer**

Company  
**AMOCO PRODUCTION COMPANY**

Date  
**February 17, 1972**

*I hereby certify that the well location shown on this plat was plotted from field notes of actual surveys made by me or under my supervision, and that the same is true and correct to the best of my knowledge and belief.*

**December 19, 1963**

Date Surveyed  
**Original signed by James P. Leese**

Registered Professional Engineer and/or Land Surveyor

Certificate No.  
**1463**

