

NUMBER OF COPIES RECEIVED	
DISTRIBUTION	
SANTA FE	
FILE	
U.S.G.S.	
LAND OFFICE	
TRANSPORTER	OIL GAS
PROBATION OFFICE	
OPERATOR	

NEW MEXICO OIL CONSERVATION COMMISSION
Santa Fe, New Mexico

Form C-101
Revised (12/1/55)

NOTICE OF INTENTION TO DRILL

Notice must be given to the District Office of the Oil Conservation Commission and approval obtained before drilling or recompletion begins. If changes in the proposed plan are considered advisable, a copy of this notice showing such changes will be returned to the sender. Submit this notice in QUINTUPLICATE. One copy will be returned following approval. See additional instructions in Rules and Regulations of the Commission. If State Land submit 6 Copies Attach Form C-128 in triplicate to first 3 copies of form C-101

Farmington, New Mexico
(Place)

9-19-62
(Date)

OIL CONSERVATION COMMISSION
SANTA FE, NEW MEXICO

Gentlemen:

You are hereby notified that it is our intention to commence the Drilling of a well to be known as
Sunray DX Oil Company

Frank W. Pyle Estate
(Lease)

(Company, or Operator)

Well No. **1**, in **L** (Unit). The well is located **1980'** feet from the **South** line and **620'** feet from the **West** line of Section **34**, T. **30N**, R. **15W**, NMPM.

(GIVE LOCATION FROM SECTION LINE) **Undesignated** Pool, **San Juan** County

If State Land the Oil and Gas Lease is No.

If patented land the owner is **Warren Pyle 1/3 of 1/8; Byron Pyle 1/3 of 1/8**
Address **Cortez, Colorado** **Pearl N. Pyle 1/3 of 1/8**

We propose to drill well with drilling equipment as follows: **Rotary rig from surface to T.D.**

The status of plugging bond is **Statewide - on file**

Drilling Contractor **Brinkerhoff Drilling Company**

We intend to complete this well in the **Gallup Sand** formation at an approximate depth of **4550**

CASING PROGRAM

We propose to use the following strings of Casing and to cement them as indicated:

Size of Hole	Size of Casing	Weight per Foot	New or Second Hand	Depth	Sacks Cement
12-1/4"	8-5/8"	24#	New	150'	100
7-7/8"	4-1/2"	11.6#	New		250

If changes in the above plans become advisable we will notify you immediately.

ADDITIONAL INFORMATION (If recompletion give full details of proposed plan of work.)

Approved.....
Except as follows:

9-20, 19 **62**

Sincerely yours,

Sunray DX Oil Company
(Company or Operator)

By **Charles W. Rogers**

Position **Engineer**

Send Communications regarding well to

Name **Sunray DX Oil Company**

Address **200 Pet. Club Plaza, Farmington, N.M.**

OIL CONSERVATION COMMISSION

By **Emery**

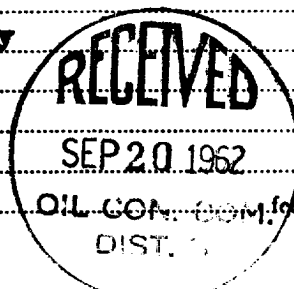

NEW MEXICO OIL CONSERVATION COMMISSION

Well Location and Acreage Dedication Plat

Section A.

Date 9-19-62

Operator SUNRAY MID-CONTINENT OIL COMPANY Lease Frank W. Pyle Estate
 Well No. 1 Unit Letter L Section 34 Township 30 NORTH Range 15 WEST, NMPM
 Located 1980 Feet From the SOUTH Line, 620 Feet From the WEST Line
 County SAN JUAN G. L. Elevation 5247.0 Dedicated Acreage 80 Acres
 Name of Producing Formation Gallop Pool Undesignated

1. Is the Operator the only owner in the dedicated acreage outlined on the plat below?
 Yes X No _____
2. If the answer to question one is "no", have the interests of all the owners been consolidated by communitization agreement or otherwise? Yes _____ No _____. If answer is "yes", Type of Consolidation.
3. If the answer to question two is "no", list all the owners and their respective interests below:

Owner

Land Description

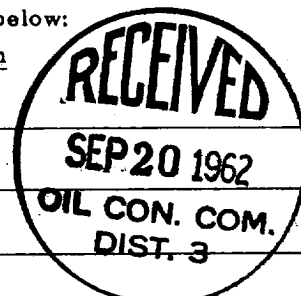

Section B.

Note: All distances must be from outer boundaries of section.

This is to certify that the information in Section A above is true and complete to the best of my knowledge and belief.

Sunray Oil Company

(Operator)

Charles W. Rogers

(Representative)

200 Pot. Club Plaza Building

(Address)

Farmington, New Mexico

Ref: GLO plat dated 25 June 1910

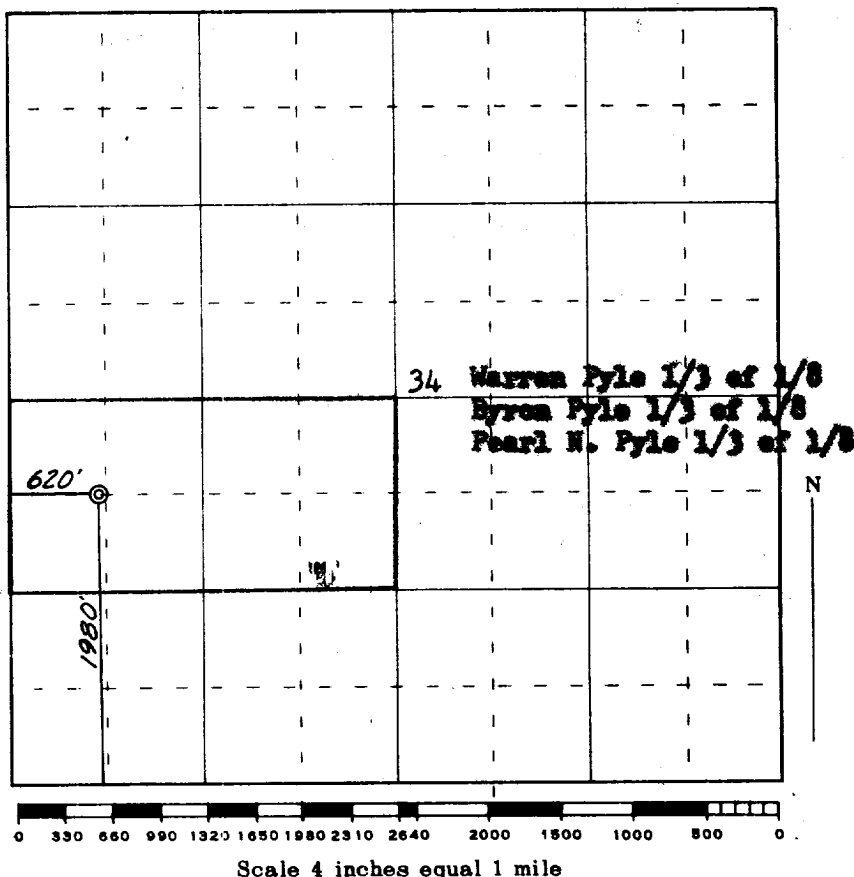

This is to certify that the above plat was prepared from field notes of actual surveys made by me or under my supervision and that the same are true and correct to the best of my knowledge and belief.

Date Surveyed 14 September 1962

James P. Leese
 Registered Professional Engineer and/or Land Surveyor
 James P. Leese N. Mex. Reg. No. 1463
 San Juan Engineering Company

Farmington, New Mexico