

(SUBMIT IN TRIPLICATE)

UNITED STATES
DEPARTMENT OF THE INTERIOR
GEOLOGICAL SURVEYLand Office New MexicoLease No. RM 0443Unit San Juan Hoover #2

SUNDRY NOTICES AND REPORTS ON WELLS

NOTICE OF INTENTION TO DRILL	<input checked="" type="checkbox"/>	SUBSEQUENT REPORT OF WATER SHUT-OFF	
NOTICE OF INTENTION TO CHANGE PLANS		SUBSEQUENT REPORT OF SHOOTING OR ACIDIZING	
NOTICE OF INTENTION TO TEST WATER SHUT-OFF		SUBSEQUENT REPORT OF ALTERING CASING	
NOTICE OF INTENTION TO RE-DRILL OR REPAIR WELL		SUBSEQUENT REPORT OF RE-DRILLING OR REPAIR	
NOTICE OF INTENTION TO SHOOT OR ACIDIZE		SUBSEQUENT REPORT OF ABANDONMENT	
NOTICE OF INTENTION TO PULL OR ALTER CASING		SUPPLEMENTARY WELL HISTORY	
NOTICE OF INTENTION TO ABANDON WELL			

RECEIVED
MAY 1 1960
U.S. GEOLOGICAL SURVEY
FARMINGTON, NEW MEXICO

(INDICATE ABOVE BY CHECK MARK NATURE OF REPORT, NOTICE, OR OTHER DATA)

C. J. Hoover #2

Farmington, New Mexico, May 16, 1960

Well No. 2 is located 1900 ft. from N line and 1900 ft. from W line of sec. 1534 1/4 34 1/4 Section 15
(1/4 Sec. and Sec. No.)7-30-M
(Twp.)R-16-M
(Range)S.R.T.M.
(Meridian)Horseshoe Gallup
(Field)San Juan
(County or Subdivision)New Mexico
(State or Territory)

The elevation of the derrick floor above sea level is _____ ft. (To be reported later)

DETAILS OF WORK

(State names of and expected depths to objective sands; show sizes, weights, and lengths of proposed casings; indicate mudding jobs, cementing points, and all other important proposed work)

We propose to drill the above well to approximately 1900' to test and develop productive Gallup zones. Stimulation will be as indicated upon penetration of Gallup pay. Rotary tools will be used to total depth. Casing program as follows:

SIZE	DEPTH
8-5/8"	100'
5-1/2"	1900'

CEMENT	REMARKS
100 sacks	Heat circulate
80 sacks 6 percent gel cement with 1-1/2 pounds tuf plug per sack, followed by 50 sacks neat cement.	Sufficient volume cement to bring top cement 300-500' above top of Gallup.

Copies of location plate attached. A copy of any survey taken will be submitted upon completion of well.

I understand that this plan of work must receive approval in writing by the Geological Survey before operations may be commenced.

Company Pan American Petroleum CorporationAddress P. O. Box 487Farmington, New MexicoAttn: R. M. Bauer, Jr.

By _____

Title Area Engineer

RECEIVED
MAY 18 1960
ORIGINAL SIGNED BY
R. M. Bauer, Jr. CH. CON. COM.
DIST. 3

RECEIVED
OCT 2 1941

NEW MEXICO OIL CONSERVATION COMMISSION

Well Location and Acreage Dedication Plat

Section A.

Date MAY 12, 1960

Operator PAN AMERICAN PETROLEUM CORPORATION Lease O. J. HOOVER "E"
Well No. 5 Unit Letter F Section 15 Township 30 NORTH Range 16 WEST NMPM
Located 1980 Feet From NORTH Line, 1980 Feet From WEST Line
County SAN JUAN G. L. Elevation * Dedicated Acreage 40 Acres
Name of Producing Formation GALLUP Pool HORSESHOE GALLUP

1. Is the Operator the only owner* in the dedicated acreage outlined on the plat below?
Yes X No *To be reported later.
2. If the answer to question one is "no," have the interests of all the owners been consolidated by communitization agreement or otherwise? Yes No . If answer is "yes,"
Type of Consolidation
3. If the answer to question two is "no," list all the owners and their respective interests below:

Owner

Land Description

Section. B

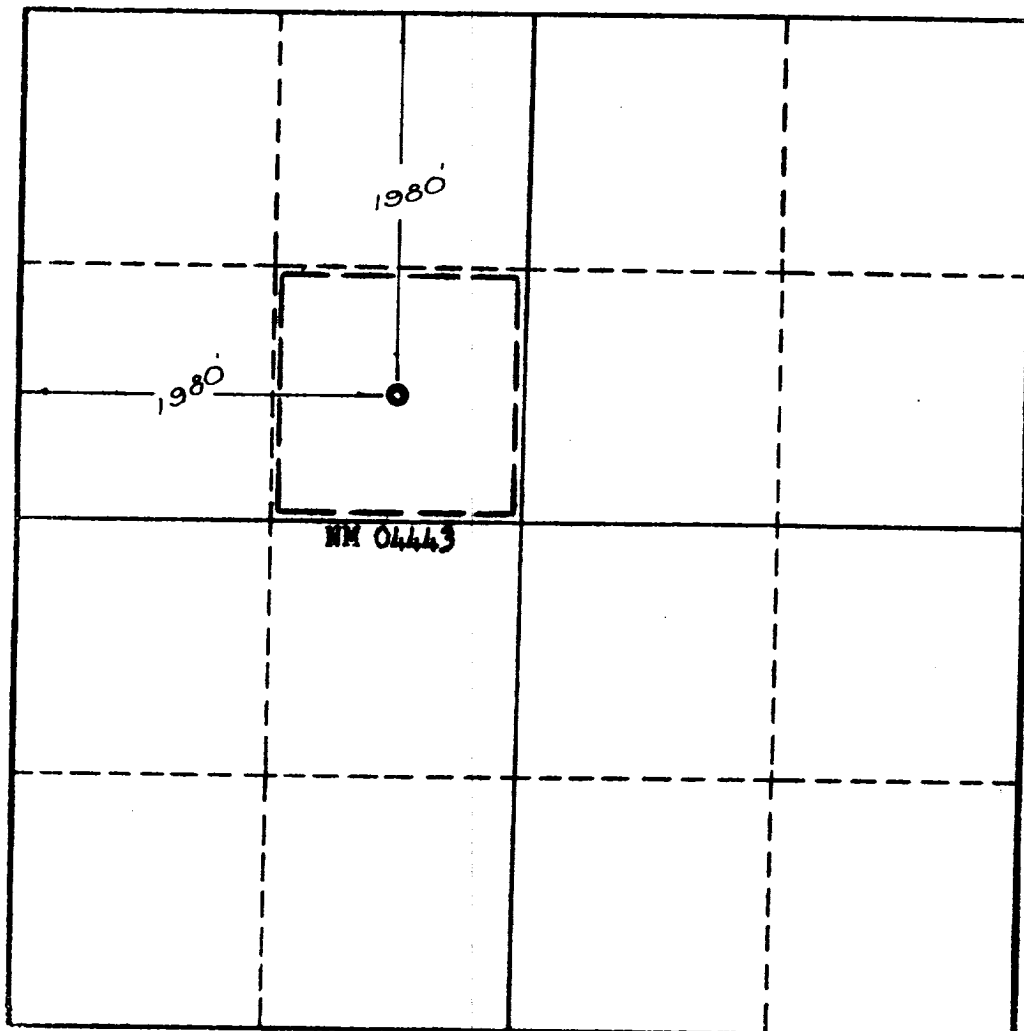

This is to certify that the information in Section A above is true and complete to the best of my knowledge and belief.

PAN AMERICAN PETROLEUM CORP.
(Operator)

R. M. BAUER, JR. RMB
(Representative)

BOX 487, FARMINGTON, NEW MEXICO
Address

This is to certify that the well location shown on this plat in Section B is correct from field notes of actual surveys made by me or under my supervision and that the same is true to the best of my knowledge and belief.

Date Surveyed May 12, 1960

Ernest V. Echohawk
Registered Land Surveyor.

Certificate No. 1545