



UNITED STATES
DEPARTMENT OF THE INTERIOR
GEOLOGICAL SURVEY
P. O. Box 965
Farmington, New Mexico

September 14, 1955

Pacific Northwest Pipeline Corporation
413 1/2 West Main Street
Farmington, New Mexico

Re: Santa Fe 079004
14-08-001-446

Gentlemen:

Receipt is acknowledged of your "Notice of Intention to Drill" dated September 13, 1955 covering your well No. 13-9 San Juan 32-8 Unit in SE 1/4 SW 1/4 sec. 9, T. 31 N., R. 8 W., N. M. P.M., San Juan County, New Mexico, Blanco pool.

Your proposed work is hereby approved subject to compliance with the provisions of the "Oil and Gas Operating Regulations" revised May 25, 1942, a copy of which will be sent to you on request, and subject to the following conditions:

1. Drilling operations so authorized are subject to the attached sheet for general conditions of approval.
2. Furnish copies of all logs.

Very truly yours,

Jerry W. Long
Acting District Engineer

JWLong:ac

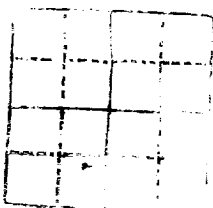

UNITED STATES
DEPARTMENT OF THE INTERIOR
GEOLOGICAL SURVEY



Very truly yours,
[Signature]
[Name]
[Title]
[Address]
[City]
[State]
[Zip]

[Faint, mostly illegible text follows, appearing to be a letter or report.]



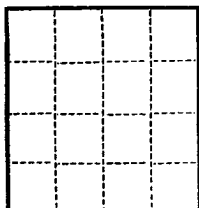

(SUBMIT IN TRIPLICATE)

UNITED STATES
DEPARTMENT OF THE INTERIOR
GEOLOGICAL SURVEY

Land Office San Jose
Lease No. 200415-2 079004
Unit San Jose 13-8
114-00-002-146

1- U.S.G.S.
1- U.S. Johnston
1- San Jose

SUNDRY NOTICES AND REPORTS ON WELLS

NOTICE OF INTENTION TO DRILL		SUBSEQUENT REPORT OF WATER SHUT-OFF	
NOTICE OF INTENTION TO CHANGE PLANS	<input checked="" type="checkbox"/>	SUBSEQUENT REPORT OF SHOOTING OR ACIDIZING	
NOTICE OF INTENTION TO TEST WATER SHUT-OFF		SUBSEQUENT REPORT OF ALTERING CASING	
NOTICE OF INTENTION TO RE-DRILL OR REPAIR WELL		SUBSEQUENT REPORT OF RE-DRILLING OR REPAIR	
NOTICE OF INTENTION TO SHOOT OR ACIDIZE		SUBSEQUENT REPORT OF ABANDONMENT	
NOTICE OF INTENTION TO PULL OR ALTER CASING		SUPPLEMENTARY WELL HISTORY	
NOTICE OF INTENTION TO ABANDON WELL			

(INDICATE ABOVE BY CHECK MARK NATURE OF REPORT, NOTICE, OR OTHER DATA)

Well No. 13-9 is located 1075 ft. from S line and 1400 ft. from W line of sec. 9
SE 1/4 SW 1/4 9
1075 (R. San Jose)
San Jose (County or Subdivision) San Jose

The elevation of the drill floor above sea level is 6420.4 ft.

DETAILS OF WORK

(State names of and expected depths to objective sands; show sizes, weights, and lengths of proposed casings; indicate mudding jobs, cementing points, and all other important proposed work)

Propose to drill 19" hole to 175', set 10-3/4" OD casing cemented with 150 on 45 gal. Drill with water or minimum mud to 3077', set 7-5/8" OD casing cemented with 175 on 25 gal. Drill with gas to total depth of 6000'; set 6000' of 5-1/2" OD casing cemented with 125 on 25 gal. Perforate GIAT House 5470-5505, and sand free with 20,000 gal free fluid, w/avg. of 1-1/4 to 1-1/2 # sand/gal. Perforate House 5530-5545' and free with 10,000 gal free fluid with avg. 1-1/4 to 1-1/2 # sand/gal. Perforate Point Lookout 5550-5580 and free with 20,000 gals free fluid with avg. of 1-1/4 to 1-1/2 # sand/gal. Run out to total depth, set tubing and complete well.

I understand that this plan of work must receive approval in writing by the Geological Survey before operations may be commenced.

Company PACIFIC NORTHWEST PETROLEUM CORPORATIONAddress 411 1/2 West Main StreetFarmington, New MexicoBy J. H. DuganTitle District Engineer

100-100000-1

100-100000-1

100-100000-1

100-100000-1

100-100000-1

100-100000-1

100-100000-1

100-100000-1

100-100000-1

100-100000-1

100-100000-1

100-100000-1

100-100000-1

100-100000-1

100-100000-1

100-100000-1

100-100000-1

100-100000-1

100-100000-1

100-100000-1

100-100000-1

Company..... **PACIFIC NORTHWEST PIPELINE CORPORATION**

Lease..... Well No.....

Sec. **9**....., T. **31 N.**....., R. **8 W.** **N.M.P.M.**

Location..... **1075 FEET FROM THE SOUTH LINE AND 1650**
FEET FROM THE WEST LINE

Elevation..... **6649.4 UNGRADED GROUND**

SAN JUAN COUNTY

NEW MEXICO

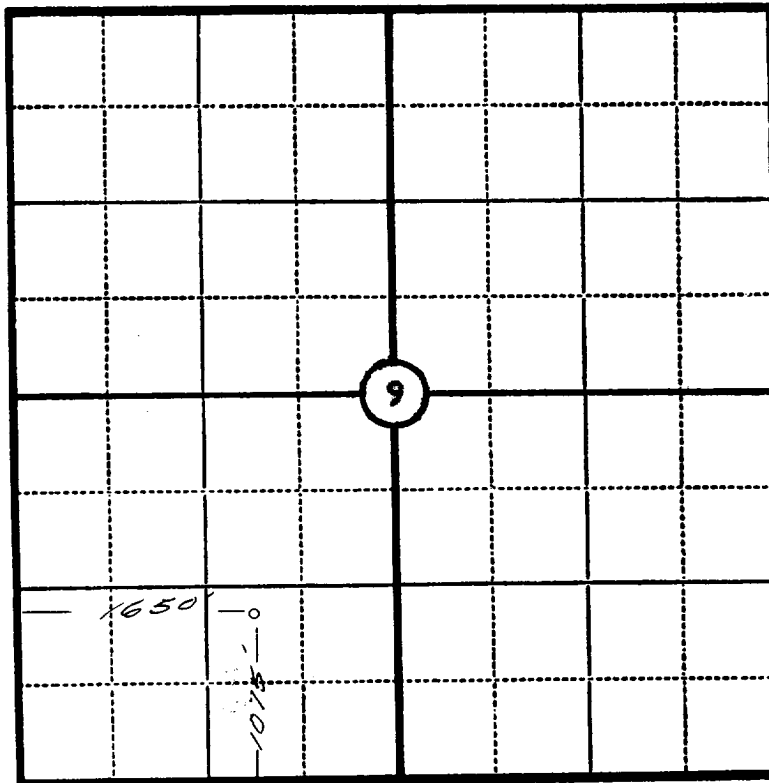

Scale—4 inches equal 1 mile.

This is to certify that the above plat was prepared from field notes of actual surveys made by me or under my supervision and that the same are true and correct to the best of my knowledge and belief.

Seal:

James P. Leese

Registered Land Surveyor.

JAMES P. LEESE

N.M. REG. NO 1463

Surveyed **AUGUST 31**, 19.. **55**.

SAN JUAN ENGINEERING COMPANY, FARMINGTON, N. M.