

UNITED STATES  
DEPARTMENT OF THE INTERIOR  
BUREAU OF LAND MANAGEMENT

5. LEASE DESIGNATION AND SERIAL NO.

SF-078212

6. IF INDIAN, ALLOTTEE OR TRIBE NAME

7. UNIT AGREEMENT NAME

8. FARM OR LEASE NAME

GAS CON  
Farnsworth "B"

9. WELL NO.

1-E

10. FIELD AND POOL, OR WILDCAT

Basin Dakota

11. SEC. T., R., M., OR BLK.  
AND SURVEY OR AREA

A  
Sec. 8-T30N-R13W

12. COUNTY OR PARISH

San Juan

13. STATE

NM

APPLICATION FOR PERMIT TO DRILL, DEEPEN, OR PLUG BACK

1a. TYPE OF WORK

DRILL ☒

DEEPEN ☐

PLUG BACK ☐

b. TYPE OF WELL

OIL  
WELL ☐

GAS  
WELL ☒

OTHER

SINGLE  
ZONE ☒

MULTIPLE  
ZONE ☐

2. NAME OF OPERATOR

BHP Petroleum (Americas) Inc.

3. ADDRESS OF OPERATOR

5613 DTC Parkway, Suite 600, Englewood, CO 80111

4. LOCATION OF WELL (Report location clearly and in accordance with any State requirements.\*)  
At surface

1040' FNL & 980' FEL (NE NE)

At proposed prod. zone

14. DISTANCE IN MILES AND DIRECTION FROM NEAREST TOWN OR POST OFFICE\*

Approximately 5.5 miles NW of Farmington, NM

15. DISTANCE FROM PROPOSED\*

LOCATION TO NEAREST  
PROPERTY OR LEASE LINE, FT.  
(Also to nearest drlg. unit line, if any)

980'

16. NO. OF ACRES IN LEASE

320

17. NO. OF ACRES ASSIGNED  
TO THIS WELL

E 320

18. DISTANCE FROM PROPOSED LOCATION\*  
TO NEAREST WELL, DRILLING, COMPLETED,  
OR APPLIED FOR, ON THIS LEASE, FT.

Approx. 2700'

19. PROPOSED DEPTH

6,350'

20. ROTARY OR CABLE TOOLS

Rotary

21. ELEVATIONS (Show whether DE, RT, GR, etc.)

DEVELOPING OPERATIONS AUTHORIZED ARE  
SUBJECT TO COMPLIANCE WITH ATTACHED

5462' (Ungraded)

22. APPROX. DATE WORK WILL START\*

February 20, 1988

23. "GENERAL REQUIREMENTS". PROPOSED CASING AND CEMENTING PROGRAM

This action is subject to technical and  
procedural review pursuant to 43 CFR 3165.3  
and appeal pursuant to 43 CFR 3165.4.

SIZE OF HOLE	SIZE OF CASING	WEIGHT PER FOOT	SETTING DEPTH	QUANTITY OF CEMENT
12-1/4"	8-5/8"	24#	±300'	210 sx
7-7/8"	4-1/2"	10.5#	±6,350'	Two stage, 850 total sx

RECEIVED  
PLANNING ROOM

88 FEB 13 PM 3:09

FARMINGTON RESOURCE AREA  
FARMINGTON, NEW MEXICO

RECEIVED  
MAR 2 1988  
OIL CON. DIV.  
(DIST. 3)

FARMINGTON RESOURCE AREA  
FARMINGTON, NEW MEXICO

88 FEB 13 PM 2:33

RECEIVED  
PLANNING ROOM

IN ABOVE SPACE DESCRIBE PROPOSED PROGRAM: If proposal is to deepen or plug back, give data on present productive zone and proposed new productive zone. If proposal is to drill or deepen directionally, give pertinent data on subsurface locations and measured and true vertical depths. Give blowout preventer program, if any.

24.

SIGNED

*Chuck Williams*  
Chuck Williams

TITLE Administrator, Field Services DATE 02/16/88

(This space for Federal or State office use)

PERMIT NO.

APPROVAL DATE

"Approval of this action does

not constitute a representation

holds legal or equitable interest

or title to this lease."

\*See Instructions On Reverse Side

APPROVED  
AS AMENDED

DATE

MAR 3 1988

*Robert Moore*  
AREA MANAGER

**NEW MEXICO OIL CONSERVATION COMMISSION  
WELL LOCATION AND ACREAGE DEDICATION PLAT**

Form C-102  
Supersedes C-128  
Effective 1-1-65

All distances must be from the outer boundaries of the Section.

Operator <b>BHP PETROLEUM (AMERICAS) INC.</b>		Lease <b>FARNSWORTH <del>GAS UNITS</del> (B)</b>		Well No. <b>1-E</b>	
Unit Letter <b>A</b>	Section <b>8</b>	Township <b>30 N</b>	Range <b>13 W</b>	County <b>San Juan</b>	
Actual Footage Location of Well: <b>1040</b> feet from the <b>North</b> line and <b>980</b> feet from the <b>East</b> line					
Ground Level Elev. <b>5462</b>	Producing Formation <b>Dakota</b>		Pool <b>Basin Dakota</b>	Dedicated Acreage: <b>320</b> Acres	

1. Outline the acreage dedicated to the subject well by colored pencil or hachure marks on the plat below.
2. If more than one lease is dedicated to the well, outline each and identify the ownership thereof (both as to working interest and royalty).
3. If more than one lease of different ownership is dedicated to the well, have the interests of all owners been consolidated by communitization, unitization, force-pooling, etc?

☒ Yes    ☐ No    If answer is "yes," type of consolidation Communitization SW 248

If answer is "no," list the owners and tract descriptions which have actually been consolidated. (Use reverse side of this form if necessary.) \_\_\_\_\_

No allowable will be assigned to the well until all interests have been consolidated (by communitization, unitization, forced-pooling, or otherwise) or until a non-standard unit, eliminating such interests, has been approved by the Commission.

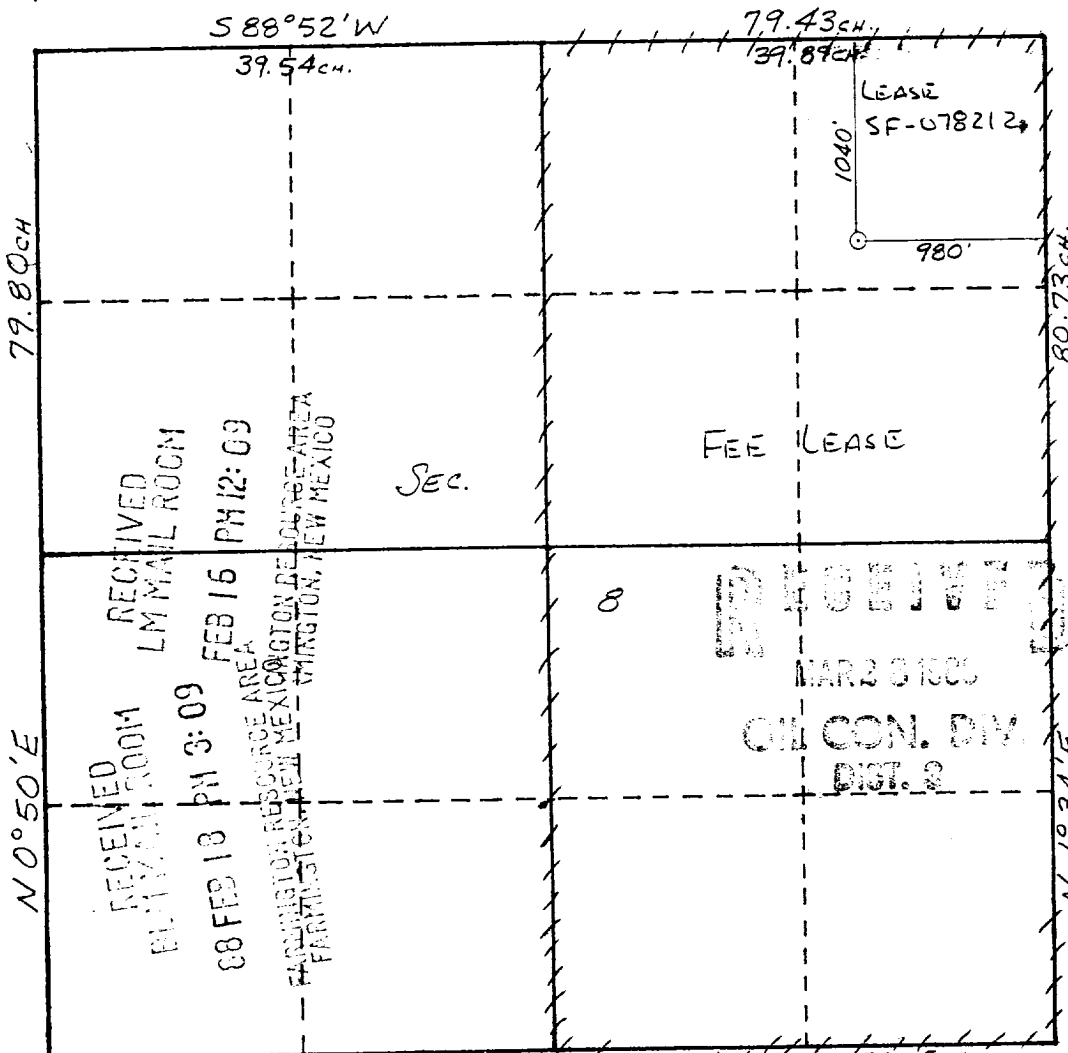

**CERTIFICATION**

hereby certify that the information contained herein is true and complete to the best of my knowledge and belief.

Name Chuck Williams  
Position Field Services  
Company BHP Petroleum (Americas) Inc.  
Date 2/10/88

hereby certify that the well location shown on this plat was plotted from field notes of actual surveys made by me or under my supervision, and that the same is true and correct to the best of my knowledge and belief.

Issued 2-11-88  
Date Surveyed 2-11-88  
Registered Professional Engineer and Land Surveyor William H. Melnick II  
Certificate No. 8468