

UNITED STATES
DEPARTMENT OF THE INTERIOR
GEOLOGICAL SURVEY

APPLICATION FOR PERMIT TO DRILL, DEEPEN, OR PLUG BACK

1a. TYPE OF WORK DRILL <input checked="" type="checkbox"/> DEEPEN <input type="checkbox"/> PLUG BACK <input type="checkbox"/>		5. LEASE DESIGNATION AND SERIAL NO. 30- 845 -21023 14-20-603-2027
b. TYPE OF WELL OIL WELL <input checked="" type="checkbox"/> GAS WELL <input type="checkbox"/> OTHER <input type="checkbox"/> SINGLE ZONE <input type="checkbox"/> MULTIPLE ZONE <input type="checkbox"/>		6. IF INDIAN, ALLOTTEE OR TRIBE NAME Navajo Tribal
2. NAME OF OPERATOR Claude C. Kennedy		7. UNIT AGREEMENT NAME
3. ADDRESS OF OPERATOR 1249 Chaco Ave., Farmington, New Mexico 87401		8. FARM OR LEASE NAME Job
4. LOCATION OF WELL (Report location clearly and in accordance with any State requirements.) At surface 2310ftl, 330ftl At proposed prod. zone None		9. WELL NO. 2
14. DISTANCE IN MILES AND DIRECTION FROM NEAREST TOWN OR POST OFFICE* 6 miles east Shiprock, New Mexico		10. FIELD AND POOL, OR WILDCAT Black Rock
15. DISTANCE FROM PROPOSED LOCATION TO NEAREST PROPERTY OR LEASE LINE, FT. (Also to nearest drlg. unit line, if any) 330'	16. NO. OF ACRES IN LEASE 2560	11. SEC., T., R., M., OR BLK. AND SURVEY OR AREA 36, T30N, R17E
18. DISTANCE FROM PROPOSED LOCATION* TO NEAREST WELL, DRILLING, COMPLETED, OR APPLIED FOR, ON THIS LEASE, FT. 3320'	19. PROPOSED DEPTH 250' Dakota	12. COUNTY OR PARISH San Juan
21. ELEVATIONS (Show whether DF, RT, GR, etc.) 5000 GR		13. STATE New Mex.
23. PROPOSED CASING AND CEMENTING PROGRAM		17. NO. OF ACRES ASSIGNED TO THIS WELL 40
		20. ROTARY OR CABLE TOOLS Both
		22. APPROX. DATE WORK WILL START* March 1, 1967

SIZE OF HOLE	SIZE OF CASING	WEIGHT PER FOOT	SETTING DEPTH	QUANTITY OF CEMENT
8 1/4	7 1/2	29	45	25
		5.40	250	100

Propose to drill surface hole with cable tools, set 2 joints,
7" surface casing through surface boulders, cement to surface.

Drill out below surface with rotary.
Cement 4" production casing on top Dakota with 100 sk.
Drill pay with air - Complete open hole.

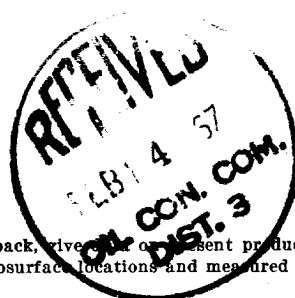

IN ABOVE SPACE DESCRIBE PROPOSED PROGRAM: If proposal is to deepen or plug back, give location of present productive zone and proposed new productive zone. If proposal is to drill or deepen directionally, give pertinent data on subsurface locations and measured and true vertical depths. Give blowout preventer program, if any.

24. Original Signed By
SIGNED CLAUDE C. KENNEDY TITLE Operator DATE 2-13-67

(This space for Federal or State office use)

PERMIT NO. APPROVAL DATE

APPROVED BY TITLE
CONDITIONS OF APPROVAL, IF ANY:

RECEIVED

FEB 13 1967

*See Instructions On Reverse Side

U. S. GEOLOGICAL SURVEY
FARMINGTON, N. M.

Instructions

General: This form is designed for submitting proposals to perform certain well operations, as indicated, on all types of lands and leases for appropriate action by either a Federal or a State agency, or both, pursuant to applicable Federal and/or State laws and regulations. Any necessary special instructions concerning the use of this form and the number of copies to be submitted, particularly with regard to local, area, or regional procedures and practices, either are shown below or will be issued by, or may be obtained from, the local Federal and/or State office.

Item 1: If the proposal is to redrill to the same reservoir at a different subsurface location or to a new reservoir, use this form with appropriate notations. Consult applicable State or Federal regulations concerning subsequent work proposals or reports on the well.

Item 4: If there are no applicable State requirements, locations on Federal or Indian land should be described in accordance with Federal requirements. Consult local State or Federal office for specific instructions.

Item 14: Needed only when location of well cannot readily be found by road from the land or lease description. A plat, or plats, separate or on this reverse side, showing the roads to, and the surveyed location of, the well, and any other required information, should be furnished when required by Federal or State agency offices.

Items 15 and 18: If well is to be, or has been directionally drilled, give distances for subsurface location of hole in any present or objective production zone.

Item 22: Consult applicable Federal or State regulations, or appropriate officials, concerning approval of the proposal before operations are started.

NEW MEXICO OIL CONSERVATION COMMISSION
WELL LOCATION AND ACREAGE DEDICATION PLAT

Form C-102
Supersedes C-128
Effective 1-1-65

All distances must be from the outer boundaries of the Section

Operator Claude C. Kennedy		Lease Deb		Well No. 222 # 7
Unit Letter H	Section 36	Township 30 North	Range 17 West	County San Juan
Actual Footage Location of Well: 2310 feet from the North line and 330 feet from the East line				
Ground Level Elev. 5089	Producing Formation Dakota	Pool Glick Rock	Dedicated Acreage: 40 Acres	

1. Outline the acreage dedicated to the subject well by colored pencil or hachure marks on the plat below.
2. If more than one lease is dedicated to the well, outline each and identify the ownership thereof (both as to working interest and royalty).
3. If more than one lease of different ownership is dedicated to the well, have the interests of all owners been consolidated by communitization, unitization, force-pooling, etc?

☐ Yes ☐ No If answer is "yes," type of consolidation _____

If answer is "no," list the owners and tract descriptions which have actually been consolidated. (Use reverse side of this form if necessary.) _____

No allowable will be assigned to the well until all interests have been consolidated (by communitization, unitization, forced-pooling, or otherwise) or until a non-standard unit, eliminating such interests, has been approved by the Commission.

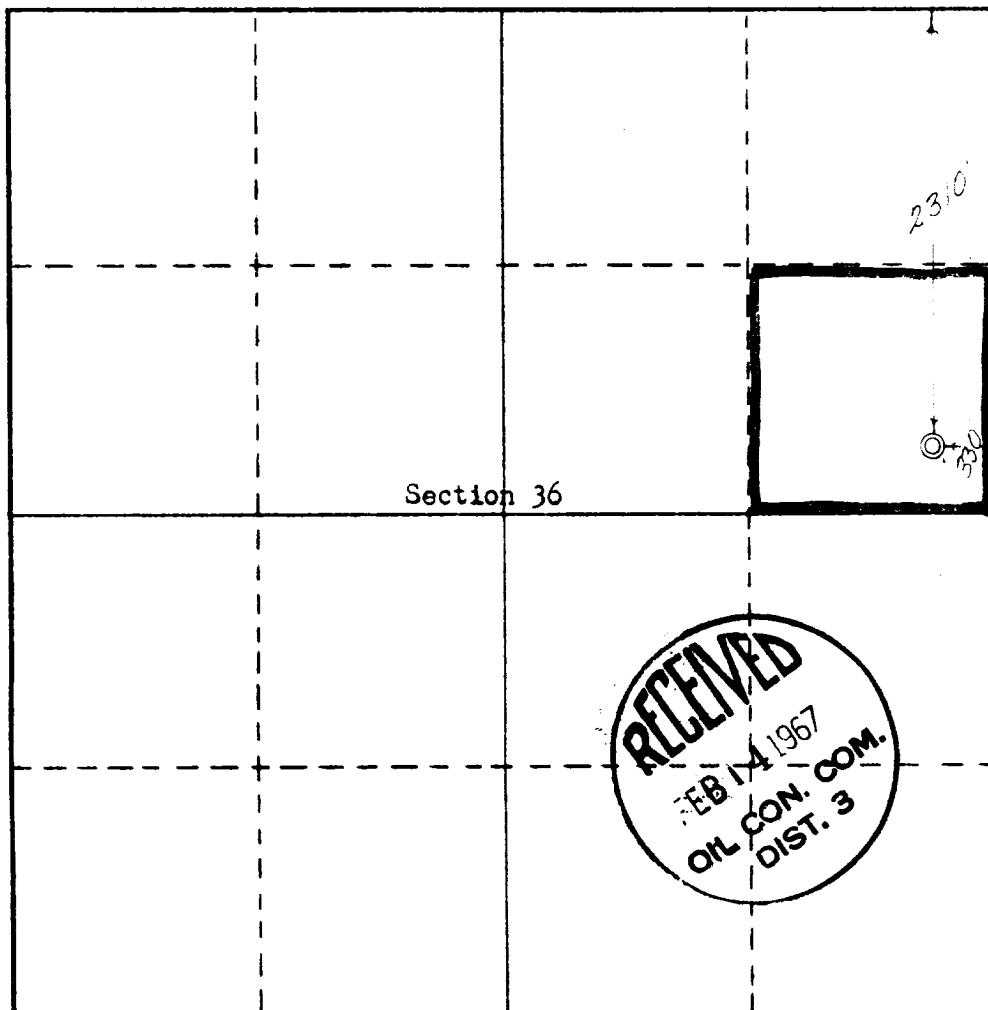

CERTIFICATION

I hereby certify that the information contained herein is true and complete to the best of my knowledge and belief.

Original Signed By:

Name **CLAUDE C. KENNEDY**
Operator

Position

Company
2-13-67

Date

I hereby certify that the well location shown on this plat was plotted from field notes of actual surveys made by me or under my supervision, and that the same is true and correct to the best of my knowledge and belief.

Date Surveyed

February 6, 1967

Registered Professional Engineer
and/or Land Surveyor
[Signature]

Certificate No.

3084