

NO. OF COPIES RECEIVED	5
DISTRIBUTION	
SANTA FE	
FILE	
U.S.G.S.	
LAND OFFICE	
OPERATOR	

NEW MEXICO OIL CONSERVATION COMMISSION

Form C-101
Revised 1-1-65 ⁶⁴⁵ 30-447-30204

5A. Indicate Type of Lease	
STATE <input type="checkbox"/>	FEE <input checked="" type="checkbox"/>

5. State Oil & Gas Lease No.

APPLICATION FOR PERMIT TO DRILL, DEEPEN, OR PLUG BACK

1a. Type of Work		7. Unit Agreement Name	
b. Type of Well: DRILL <input checked="" type="checkbox"/> DEEPEN <input type="checkbox"/> PLUG BACK <input type="checkbox"/>		8. Farm or Lease Name	
OIL WELL <input type="checkbox"/> GAS WELL <input checked="" type="checkbox"/> OTHER <input type="checkbox"/>		Likins Gas Com "A"	
2. Name of Operator		9. Well No.	
PAN AMERICAN PETROLEUM CORPORATION		4	
3. Address of Operator		10. Field and Pool, or Wildcat	
501 Airport Drive, Farmington, New Mexico 87401		Blanco Pictured Cliffs	
4. Location of Well		12. County	
UNIT LETTER L LOCATED 1820 FEET FROM THE South LINE		San Juan	
AND 1095 FEET FROM THE West LINE OF SEC. 34 TWP. 30N RGE. 9W NMPM			
19. Proposed Depth		19A. Formation	
2500'		Pictured Cliffs	
20. Rotary or C.T.		Rotary	
21. Elevations (Show whether DF, RT, etc.)		22. Approx. Date Work will start	
Will report later		December 11, 1967	
21A. Kind & Status Plug. Bond		21B. Drilling Contractor	
Statewide		Carmack Drl. Co.	

PROPOSED CASING AND CEMENT PROGRAM

SIZE OF HOLE	SIZE OF CASING	WEIGHT PER FOOT	SETTING DEPTH	SACKS OF CEMENT	EST. TOP
12-1/4'	8-5/8"	24#	200'	200 sx.	Surface
7-7/8"	4-1/2"	10.5#	2500'	600 sx.	Surface

Copy of Location Plat attached.

Copies of all logs will be furnished upon reaching total depth.

Completion procedure will be designed as indicated by logs and other data obtained during drilling operations.

APPROVAL VALID
FOR 90 DAYS UNLESS
DRILLING COMMENCED.
EXPIRED March 11, 1967

CORRECTED COPY



IN ABOVE SPACE DESCRIBE PROPOSED PROGRAM: IF PROPOSAL IS TO DEEPEN OR PLUG BACK, GIVE DATA ON PRESENT PRODUCTIVE ZONE AND PROPOSED NEW PRODUCTIVE ZONE. GIVE BLOWOUT PREVENTER PROGRAM, IF ANY.

I hereby certify that the information above is true and complete to the best of my knowledge and belief.

G. W. Eaton, Jr.

Signed _____ Title **Area Engineer** Date **December 14, 1967**

(This space for State Use)

APPROVED BY Emory Cleland TITLE Asst. Dir. III DATE 12-15-67

CONDITIONS OF APPROVAL, IF ANY:

**NEW MEXICO OIL CONSERVATION COMMISSION
WELL LOCATION AND ACERAGE DEDICATION PLAT**

All distances must be from the outer boundaries of the Section

Operator PAN AMERICAN PETROLEUM CORPORATION			Lease LIKINS GAS COM "A"		Well No. 4
Unit Letter L	Section 34	Township 30 NORTH	Range 9 WEST	County SAN JUAN	
Actual Footage Location of Well: <div style="display: flex; justify-content: space-between;"> 1820 feet from the SOUTH line and 1095 feet from the WEST line </div>					
Ground Level Elev. Report later	Producing Formation Pictured Cliffs	Pool Blanco	Dedicated Acreage: 160 Acres		

1. Outline the acreage dedicated to the subject well by colored pencil or hachure marks on the plat below.
2. If more than one lease is dedicated to the well, outline each and identify the ownership thereof (both as to working interest and royalty).
3. If more than one lease of different ownership is dedicated to the well, have the interests of all owners been consolidated by communitization, unitization, force-pooling, etc?

(☒) Yes () No If answer is "yes," type of consolidation Communitization

If answer is "no," list the owners and tract descriptions which have actually consolidated. (Use reverse side of this form if necessary.)

No allowable will be assigned to the well until all interests have been consolidated (by communitization, unitization, forced-pooling, or otherwise) or until a non standard unit, eliminating such interests, has been approved by the Commission.

CERTIFICATION

I hereby certify that the information contained herein is true and complete to the best of my knowledge and belief.

G. W. Eaton, Jr.
 Name
G. W. Eaton, Jr.
 Position
Area Engineer
 Company
PAN AMERICAN PETROLEUM CORP.
 Date
December 8, 1967

I hereby certify that the well location shown on this plat was plotted from field notes of actual surveys made by me or under my supervision, and that the same is true and correct to the best of my knowledge and belief.

1163 December 1967
 Date Surveyed
James P. Leese
 Registered Professional Engineer
 and/or Land Surveyor
James P. Leese
1163
 Certificate No.

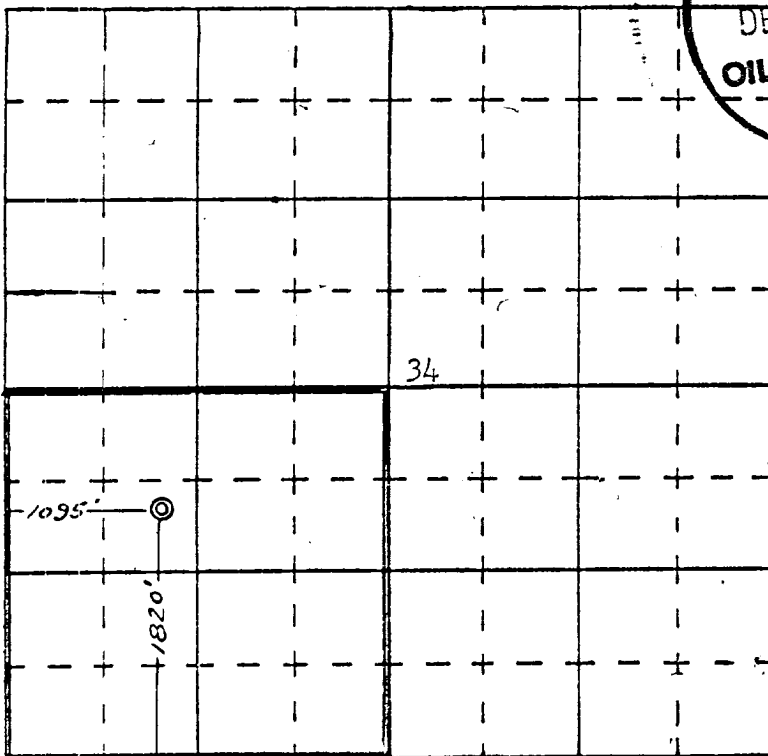

SCALE—4 INCHES EQUALS 1 MILE

SAN JUAN ENGINEERING COMPANY, FARMINGTON, N. M.