

NO. OF COPIES RECEIVED	6
DISTRIBUTION	
SANTA FE	1
FILE	1
U.S.G.S.	2
LAND OFFICE	1
OPERATOR	1

NEW MEXICO OIL CONSERVATION COMMISSION

Form C-101
Revised 1-1-65 30-~~445~~-20293

5A. Indicate Type of Lease STATE <input checked="" type="checkbox"/> FEE <input type="checkbox"/>
5. State Oil & Gas Lease No. E-3439

APPLICATION FOR PERMIT TO DRILL, DEEPEN, OR PLUG BACK

1a. Type of Work DRILL <input checked="" type="checkbox"/> DEEPEN <input type="checkbox"/> PLUG BACK <input type="checkbox"/>		7. Unit Agreement Name
b. Type of Well OIL WELL <input type="checkbox"/> GAS WELL <input checked="" type="checkbox"/> OTHER <input type="checkbox"/> SINGLE ZONE <input checked="" type="checkbox"/> MULTIPLE ZONE <input type="checkbox"/>		8. Farm or Lease Name State Gas Com "SM"
2. Name of Operator PAN AMERICAN PETROLEUM CORPORATION		9. Well No. 1
3. Address of Operator 501 Airport Drive, Farmington, New Mexico 87401		10. Field and Pool, or Wildcat Blanco Pictured Cliffs
4. Location of Well UNIT LETTER B LOCATED 1190 FEET FROM THE North LINE AND 1500 FEET FROM THE East LINE OF SEC. 36 TWP. 30N RGE. 9W NMPM		12. County San Juan
19. Proposed Depth 2560'		19A. Formation Pictured Cliffs
20. Rotary or C.T. Rotary		
21. Elevations (Show whether DF, RT, etc.) Will report later	21A. Kind & Status Plug. Bond Statewide	22. Approx. Date Work will start June 19, 1968

23.

PROPOSED CASING AND CEMENT PROGRAM

SIZE OF HOLE	SIZE OF CASING	WEIGHT PER FOOT	SETTING DEPTH	SACKS OF CEMENT	EST. TOP
12-1/4"	8-5/8"	24#	200'	200 sacks	Surface
7-7/8"	4-1/2"	9.5#	2560'	600 sacks	Surface

Copy of Location Plat attached.

Copies of all logs run will be furnished upon reaching total depth.

Completion procedure will be designed as indicated by logs and data obtained during drilling operations.

APPROVAL VALID
FOR 90 DAYS UNLESS
DRILLING COMMENCED,

EXPIRES Sept 9, 1968

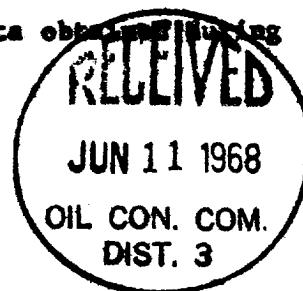

IN ABOVE SPACE DESCRIBE PROPOSED PROGRAM: IF PROPOSAL IS TO DEEPEN OR PLUG BACK, GIVE DATA ON PRESENT PRODUCTIVE ZONE AND PROPOSED NEW PRODUCTIVE ZONE. GIVE BLOWOUT PREVENTER PROGRAM, IF ANY.

I hereby certify that the information above is true and complete to the best of my knowledge and belief.

G. W. Esten, Jr.

Signed G. W. Esten, Jr. Title Area Engineer Date June 7, 1968

(This space for State Use)

APPROVED BY *Robert Henderson* TITLE PETROLEUM ENGINEER DIST. NO. 3 DATE JUN 11 1968
CONDITIONS OF APPROVAL, IF ANY:

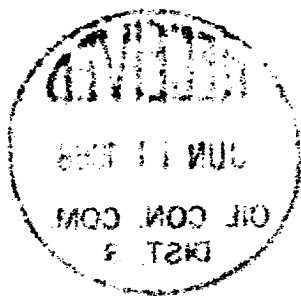

**NEW MEXICO OIL CONSERVATION COMMISSION
WELL LOCATION AND ACERAGE DEDICATION PLAT**

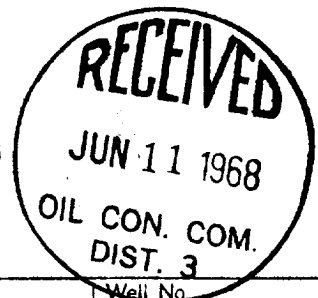

All distances must be from the outer boundaries of the Section

Operator PAN AMERICAN PETROLEUM CORPORATION			Lease STATE GAS COM "BN"			Well No. 1		
Unit Letter B	Section 36	Township 30 NORTH	Range 9 WEST	County SAN JUAN				
Actual Footage Location of Well: 1190 feet from the NORTH line and 1500 feet from the EAST line								
Ground Level Elev. REPORT LATER	Producing Formation PICTURED CLIFFS		Pool BLANCO PICTURED CLIFFS		Dedicated Acreage: 160 ✓		Acres	

1. Outline the acreage dedicated to the subject well by colored pencil or hachure marks on the plat below.
2. If more than one lease is dedicated to the well, outline each and identify the ownership thereof (both as to working interest and royalty),
3. If more than one lease of different ownership is dedicated to the well, have the interests of all owners been consolidated by communitization, unitization, force-pooling, etc?
☒ Yes ☐ No If answer is "yes," type of consolidation Communitization
 If answer is "no," list the owners and tract descriptions which have actually consolidated. (Use reverse side of this form if necessary.) _____
 No allowable will be assigned to the well until all interests have been consolidated (by communitization, unitization, forced-pooling, or otherwise) or until a non standard unit, eliminating such interests, has been approved by the Commission.

CERTIFICATION

I hereby certify that the information contained herein is true and complete to the best of my knowledge and belief.

G. W. Eaton, Jr.
 Name
G. W. Eaton, Jr.
 Position
Area Engineer
 Company
PAN AMERICAN PETROLEUM CORP.
 Date
April 17, 1968

I hereby certify that the well location shown on this plat was plotted from field notes of actual surveys made by me or under my supervision, and that the same is true and correct to the best of my knowledge and belief.

April 8, 1968
 Date Surveyed
James P. Leese
 Registered Professional Engineer
 and/or Land Surveyor
JAMES P. LEESE
1463
 Certificate No.

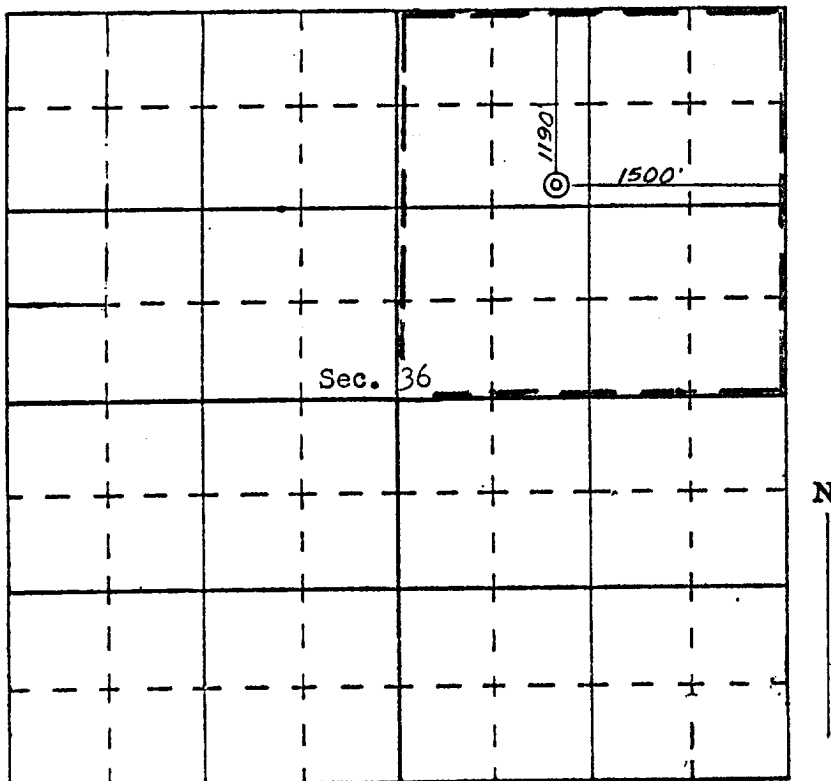

SCALE—4 INCHES EQUALS 1 MILE

SAN JUAN ENGINEERING COMPANY, FARMINGTON, N. M.