

UNITED STATES  
DEPARTMENT OF THE INTERIOR  
GEOLOGICAL SURVEY

30-645-20297  
5. LEASE DESIGNATION AND SERIAL NO.  
**SF-078139**

APPLICATION FOR PERMIT TO DRILL, DEEPEN, OR PLUG BACK

1a. TYPE OF WORK

DRILL ☒ DEEPEN ☐ PLUG BACK ☐

6. IF INDIAN, ALLOTTEE OR TRIBE NAME

7. UNIT AGREEMENT NAME

8. FARM OR LEASE NAME

**Elliott Gas Com. Tr.**

9. WELL NO.

**1**

10. FIELD AND POOL, OR WILDCAT

**Blanco Pictured Cliffs**

11. SEC., T., R., M., OR BLK.  
AND SURVEY OR AREA

**Section 26,  
T-30-N, R-9-W**

12. COUNTY OR PARISH

**San Juan**

13. STATE

**New Mexico**

b. TYPE OF WELL

OIL WELL ☐ GAS WELL ☒ OTHER ☐ SINGLE ZONE ☒ MULTIPLE ZONE ☐

2. NAME OF OPERATOR

**PAN AMERICAN PETROLEUM CORPORATION**

3. ADDRESS OF OPERATOR

**501 Airport Drive, Farmington, New Mexico 87401**

4. LOCATION OF WELL (Report location clearly and in accordance with any State requirements.)  
At surface

**790' FNL & 1615' FNL**

At proposed prod. zone

**Same**

14. DISTANCE IN MILES AND DIRECTION FROM NEAREST TOWN OR POST OFFICE\*

15. DISTANCE FROM PROPOSED\*

LOCATION TO NEAREST  
PROPERTY OR LEASE LINE, FT.  
(Also to nearest drlg. unit line, if any)

**790'**

16. NO. OF ACRES IN LEASE

**160**

17. NO. OF ACRES ASSIGNED  
TO THIS WELL

**160**

18. DISTANCE FROM PROPOSED LOCATION\*

TO NEAREST WELL, DRILLING, COMPLETED,  
OR APPLIED FOR, ON THIS LEASE, FT.

**208'**

19. PROPOSED DEPTH

**2660'**

20. ROTARY OR CABLE TOOLS

**Rotary**

21. ELEVATIONS (Show whether DF, RT, GR, etc.)

**Will report later**

22. APPROX. DATE WORK WILL START\*

**June 19, 1968**

23.

PROPOSED CASING AND CEMENTING PROGRAM

SIZE OF HOLE	SIZE OF CASING	WEIGHT PER FOOT	SETTING DEPTH	QUANTITY OF CEMENT
<b>12-1/4"</b>	<b>8-5/8"</b>	<b>24#</b>	<b>200'</b>	<b>200 sacks</b>
<b>7-7/8"</b>	<b>4-1/2"</b>	<b>9.5#</b>	<b>2660'</b>	<b>600 sacks</b>

Copy of Location Plat attached.

Copies of all logs run will be furnished upon reaching total depth.

Completion procedure will be designed as indicated by logs and data obtained during drilling operations.

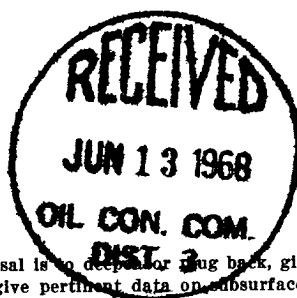

RECEIVED

JUN 12 1968

U. S. GEOLOGICAL SURVEY  
FARMINGTON, N. M.

IN ABOVE SPACE DESCRIBE PROPOSED PROGRAM: If proposal is to deepen or plug back, give data on present productive zone and proposed new productive zone. If proposal is to drill or deepen directionally, give pertinent data on subsurface locations and measured and true vertical depths. Give blowout preventer program, if any.

24.

ORIGINAL SIGNATURE

**G. W. Eaton, Jr.**

SIGNED

**G. W. Eaton, Jr.**

TITLE

**Area Engineer**

DATE

**June 7, 1968**

(This space for Federal or State office use)

PERMIT NO.

APPROVAL DATE

APPROVED BY

TITLE

DATE

CONDITIONS OF APPROVAL, IF ANY:

\*See Instructions On Reverse Side

## Instructions

**General:** This form is designed for submitting proposals to perform certain well operations, as indicated, on all types of lands and leases for appropriate action by either a Federal or a State agency, or both, pursuant to applicable Federal and/or State laws and regulations. Any necessary special instructions concerning the use of this form and the number of copies to be submitted, particularly with regard to local, area, or regional procedures and practices, either are shown below or will be issued by, or may be obtained from, the local Federal and/or State office.

**Item 1:** If the proposal is to redrill to the same reservoir at a different subsurface location or to a new reservoir, use this form with appropriate notations. Consult applicable State or Federal regulations concerning subsequent work proposals or reports on the well.

**Item 4:** If there are no applicable State requirements, locations on Federal or Indian land should be described in accordance with Federal requirements. Consult local State or Federal office for specific instructions.

**Item 14:** Needed only when location of well cannot readily be found by road from the land or lease description. A plat, or plats, separate or on this reverse side, showing the roads to, and the surveyed location of, the well, and any other required information, should be furnished when required by Federal or State agency offices.

**Items 15 and 18:** If well is to be, or has been directionally drilled, give distances for subsurface location of hole in any present or objective production zone.

**Item 22:** Consult applicable Federal or State regulations, or appropriate officials, concerning approval of the proposal before operations are started.



**NEW MEXICO OIL CONSERVATION COMMISSION  
WELL LOCATION AND ACERAGE DEDICATION PLAT**

All distances must be from the outer boundaries of the Section

Operator <b>PAN AMERICAN PETROLEUM CORPORATION</b>			Lease <b>ELLIOTT GAS COM "T"</b>		Well No. <b>1</b>
Unit Letter <b>B</b>	Section <b>26</b>	Township <b>30 NORTH</b>	Range <b>9 WEST</b>	County <b>SAN JUAN</b>	
Actual Footage Location of Well: <div style="display: flex; justify-content: space-between;"> <span>790 feet from the NORTH line and</span> <span>1615 feet from the EAST line</span> </div>					
Ground Level Elev. <b>REPORT LATER</b>	Producing Formation <b>PICTURED CLIFFS</b>	Pool <b>BLANCO PICTURED CLIFFS</b>	Dedicated Acreage: <b>160</b> Acres		

1. Outline the acreage dedicated to the subject well by colored pencil or hachure marks on the plat below.
2. If more than one lease is dedicated to the well, outline each and identify the ownership thereof (both as to working interest and royalty),
3. If more than one lease of different ownership is dedicated to the well, have the interests of all owners been consolidated by communitization, unitization, force-pooling, etc?

( ) Yes ( ) No If answer is "yes," type of consolidation .....

If answer is "no," list the owners and tract descriptions which have actually consolidated. (Use reverse side of this form if necessary.) .....

No allowable will be assigned to the well until all interests have been consolidated (by communitization, unitization, forced-pooling, or otherwise) or until a non standard unit, eliminating such interests, has been approved by the Commission.

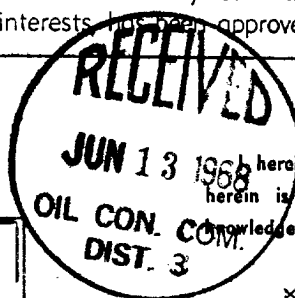

**CERTIFICATION**

I hereby certify that the information contained herein is true and complete to the best of my knowledge and belief.

G. W. Eaton, Jr.  
 Name  
G. W. Eaton, Jr.  
 Position  
Area Engineer  
 Company  
PAN AMERICAN PETROLEUM CORP.  
 Date  
April 17, 1968

I hereby certify that the well location shown on this plat was plotted from field notes of actual surveys made by me or under my supervision, and that the same is true and correct to the best of my knowledge and belief.

April 6, 1968  
 Date Surveyed  
James P. Leese  
 Registered Professional Engineer  
 and/or Land Surveyor  
JAMES P. LEESE  
1463  
 Certificate No.

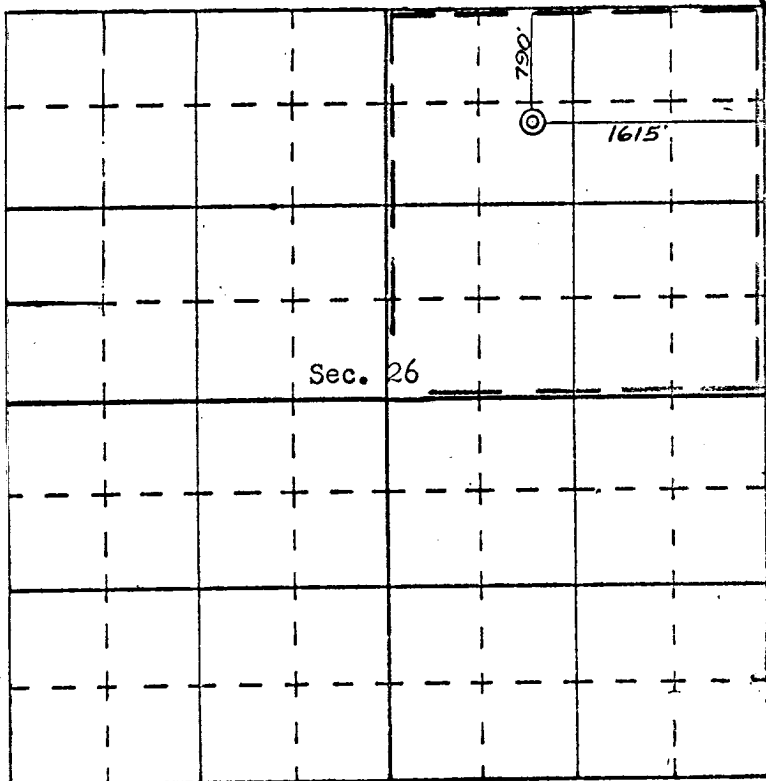

SCALE—4 INCHES EQUALS 1 MILE

SAN JUAN ENGINEERING COMPANY, FARMINGTON, N. M.