

UNITED STATES  
DEPARTMENT OF THE INTERIOR  
GEOLOGICAL SURVEY

## APPLICATION FOR PERMIT TO DRILL, DEEPEN, OR PLUG BACK

## 1a. TYPE OF WORK

DRILL ☒DEEPEN ☐PLUG BACK ☐

## b. TYPE OF WELL

OIL  
WELL ☐GAS  
WELL ☒

OTHER

SINGLE  
ZONE ☒MULTIPLE  
ZONE ☐

## 2. NAME OF OPERATOR

El Paso Natural Gas Company

## 3. ADDRESS OF OPERATOR

Box 990, Farmington, New Mexico - 87401

## 4. LOCATION OF WELL (Report location clearly and in accordance with any State requirements.)\*

At surface

1750'N, 790'E

At proposed prod. zone

## 14. DISTANCE IN MILES AND DIRECTION FROM NEAREST TOWN OR POST OFFICE\*

## 15. DISTANCE FROM PROPOSED\*

LOCATION TO NEAREST  
PROPERTY OR LEASE LINE, FT.  
(Also to nearest drlg. unit line, if any)

## 16. NO. OF ACRES IN LEASE

18. DISTANCE FROM PROPOSED LOCATION\*  
TO NEAREST WELL, DRILLING, COMPLETED,  
OR APPLIED FOR, ON THIS LEASE, FT.

## 19. PROPOSED DEPTH

3105'

## 21. ELEVATIONS (Show whether DF, RT, GR, etc.)

6264' GL

## 23.

## PROPOSED CASING AND CEMENTING PROGRAM

SIZE OF HOLE	SIZE OF CASING	WEIGHT PER FOOT	SETTING DEPTH	QUANTITY OF CEMENT
12 1/4"	8 5/8"	24#	120'	65 Sks. to circulate
6 3/4"	2 7/8"	6.4#	3105'	250 Sks. to cover the Ujo Alamo

Selectively perforate and sand water fracture the Pictured Cliffs formation.

The NE/4 of Section 5 is dedicated to this well.

IN ABOVE SPACE DESCRIBE PROPOSED PROGRAM: If proposal is to deepen or plug back, give data on present productive zone and proposed new productive zone. If proposal is to drill or deepen directionally, give pertinent data on subsurface locations and measured and true vertical depths. Give blowout preventer program, if any.

## 24.

ORIGINAL SIGNED BY

SIGNED

LARRY A. AIMES

TITLE

Petroleum Engineer

DATE

11-21-69

(This space for Federal or State office use)

PERMIT NO.

APPROVAL DATE

APPROVED BY

TITLE

CONDITIONS OF APPROVAL, IF ANY:

OK

\*See Instructions On Reverse Side

30-045-20529

## 5. LEASE DESIGNATION AND SERIAL NO.

SF 080917

## 6. IF INDIAN, ALLOTTEE OR TRIBE NAME

## 7. UNIT AGREEMENT NAME

## 8. FARM OR LEASE NAME

Atlantic B

## 9. WELL NO.

10

## 10. FIELD AND POOL, OR WILDCAT

Undesignated P. C.

11. SEC., T., R., M., OR BLK.  
AND SURVEY OR AREASec. 5, T-30-N, R-10-W  
N.M.F.M.

## 12. COUNTY OR PARISH

San Juan

## 13. STATE

New Mexico

## 15. DISTANCE FROM PROPOSED\*

LOCATION TO NEAREST  
PROPERTY OR LEASE LINE, FT.  
(Also to nearest drlg. unit line, if any)

## 16. NO. OF ACRES IN LEASE

18. DISTANCE FROM PROPOSED LOCATION\*  
TO NEAREST WELL, DRILLING, COMPLETED,  
OR APPLIED FOR, ON THIS LEASE, FT.

## 19. PROPOSED DEPTH

3105'

## 21. ELEVATIONS (Show whether DF, RT, GR, etc.)

6264' GL

## 23.

## PROPOSED CASING AND CEMENTING PROGRAM

SIZE OF HOLE	SIZE OF CASING	WEIGHT PER FOOT	SETTING DEPTH	QUANTITY OF CEMENT
12 1/4"	8 5/8"	24#	120'	65 Sks. to circulate
6 3/4"	2 7/8"	6.4#	3105'	250 Sks. to cover the Ujo Alamo

Selectively perforate and sand water fracture the Pictured Cliffs formation.

The NE/4 of Section 5 is dedicated to this well.

IN ABOVE SPACE DESCRIBE PROPOSED PROGRAM: If proposal is to deepen or plug back, give data on present productive zone and proposed new productive zone. If proposal is to drill or deepen directionally, give pertinent data on subsurface locations and measured and true vertical depths. Give blowout preventer program, if any.

## 24.

ORIGINAL SIGNED BY

SIGNED

LARRY A. AIMES

TITLE

Petroleum Engineer

DATE

11-21-69

(This space for Federal or State office use)

PERMIT NO.

APPROVAL DATE

APPROVED BY

TITLE

CONDITIONS OF APPROVAL, IF ANY:

OK

\*See Instructions On Reverse Side

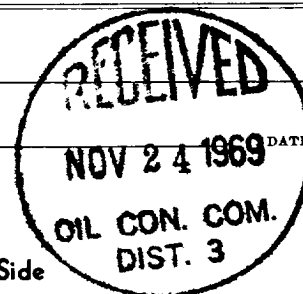

NEW MEXICO OIL CONSERVATION COMMISSION  
WELL LOCATION AND ACREAGE DEDICATION PLAT

Form C-107  
Supersedes C-128  
Effective 1-1-67

All distances must be from the outer boundaries of the Section.

EL PASO NATURAL GAS COMPANY			Lease <b>ATLANTIC B (SF-080917)</b>		Well No. <b>10</b>
Section <b>H</b>	Section <b>5</b>	Township <b>30-N</b>	Range <b>10-W</b>	County <b>SAN JUAN</b>	
Acres of the top 1/4 corner of Well: <b>1750</b> feet from the <b>NORTH</b> line and <b>790</b> feet from the <b>EAST</b> line.					
Bound. by Well Elev. <b>6264</b>	Producing Formation <b>PICTURED CLIFFS</b>		Pool <b>UNDESIGNATED PICTURED CLIFFS</b>		Estimated Area, Acres <b>160.11</b>

1. Outline the acreage dedicated to the subject well by colored pencil or hachure marks on the plat below.
2. If more than one lease is dedicated to the well, outline each and identify the ownership thereof (as to working interest and royalty).
3. If more than one lease of different ownership is dedicated to the well, have the interests of all owners been consolidated by communitization, unitization, force-pooling, etc?

☐ Yes ☐ No If answer is "yes," type of consolidation \_\_\_\_\_

If answer is "no," list the owners and tract descriptions which have actually been consolidated (Use reverse side of this form if necessary.) \_\_\_\_\_

No allowable will be assigned to the well until all interests have been consolidated (by communitization, unitization, forced-pooling, or otherwise) or until a non-standard unit, eliminating such interests, has been approved by the Commission.

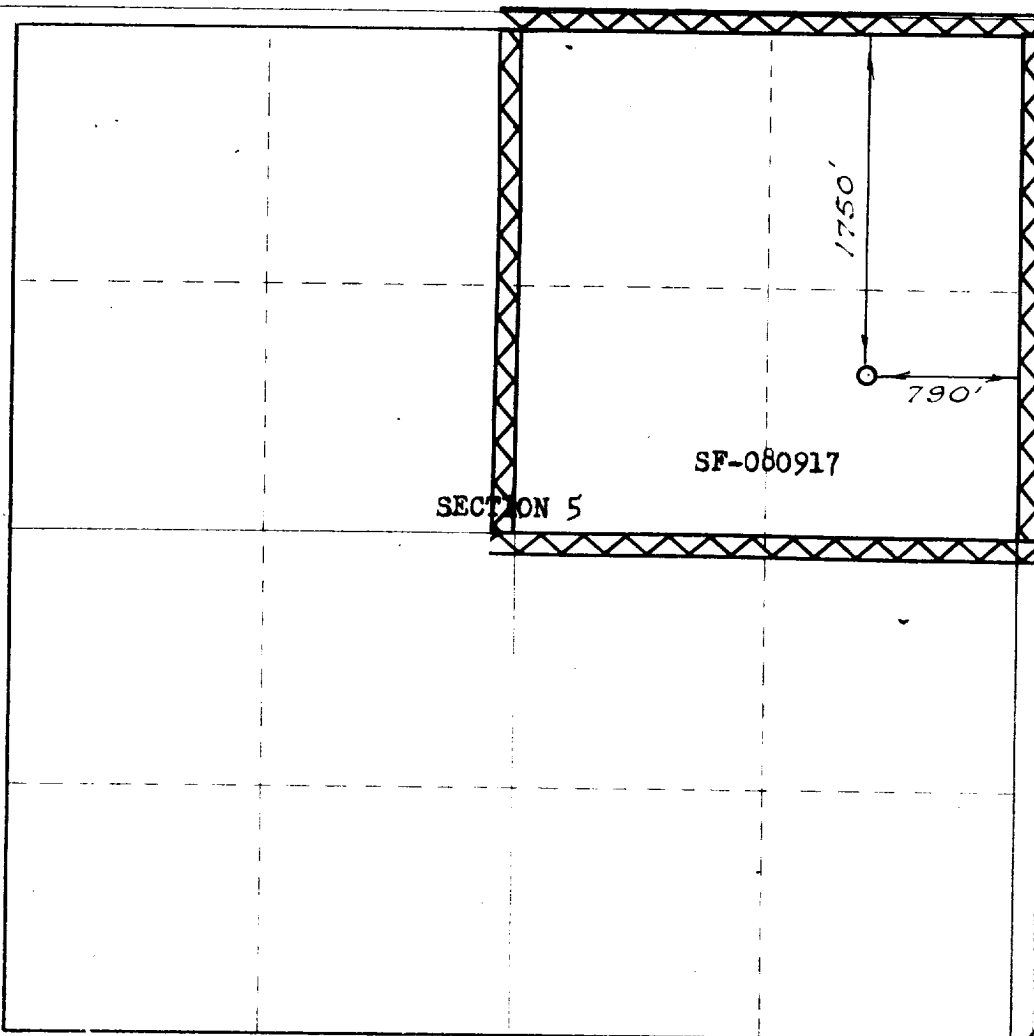

CERTIFICATION

I hereby certify that the information contained herein is true and complete to the best of my knowledge and belief.

SIGNED BY  
**LARRY A. AIMES**

**Petroleum Engineer**

**El Paso Natural Gas Co.**

**November 21, 1969**

I hereby certify that the well location shown on this plat was plotted from field notes of actual surveys made by me or under my supervision, and that the same is true and correct to the best of my knowledge and belief.

**SEPTEMBER 2, 1969**

*Paul Wilson*  
**1760**

