

NO. OF COPIES RECEIVED	6
DISTRIBUTION	
SANTA FE	1
FILE	1
U.S.G.S.	2
LAND OFFICE	1
OPERATOR	1

NEW MEXICO OIL CONSERVATION COMMISSION

30-045-21096

Form C-101
Revised 1-1-65

5A. Indicate Type of Lease	
STATE <input checked="" type="checkbox"/>	FEE <input type="checkbox"/>
5. State Oil & Gas Lease No.	
E-453-4	

APPLICATION FOR PERMIT TO DRILL, DEEPEN, OR PLUG BACK

1a. Type of Work		7. Unit Agreement Name	
b. Type of Well OIL WELL <input type="checkbox"/> GAS WELL <input checked="" type="checkbox"/> OTHER <input type="checkbox"/>		8. Farm or Lease Name	
DRILL <input checked="" type="checkbox"/> DEEPEN <input type="checkbox"/> PLUG BACK <input type="checkbox"/>		Atlantic D Com F	
2. Name of Operator		9. Well No.	
El Paso Natural Gas Company		7	
3. Address of Operator		10. Field and Pool, or Wildcat	
PO Box 990, Farmington, NM 87401		Blanco P. C. Ext.	
4. Location of Well		12. County	
UNIT LETTER H LOCATED 1460 FEET FROM THE North LINE		San Juan	
AND 800' E FEET FROM THE East LINE OF SEC. 2 TWP. 30 N 31 E RGE. 10 W NMPM			
19. Proposed Depth		19A. Formation	
3390'		Pictured Cliffs	
20. Rotary or C.T.		Rotary	
21. Elevations (Show whether DE, RT, etc.)		22. Approx. Date Work will start	
6552' GL			

23.

PROPOSED CASING AND CEMENT PROGRAM

SIZE OF HOLE	SIZE OF CASING	WEIGHT PER FOOT	SETTING DEPTH	SACKS OF CEMENT	EST. TOP
12 1/4"	8 5/8"	24.0#	120'	107 cu. ft.	to circulate
6 3/4"	2 7/8"	6.4#	3390	450 cu. ft.	to cover Ojo Alamo

Selectively perforate and sandwater fracture the Pictured Cliffs formation.

The NE/4 of Section 2 is dedicated to this well.

APPROVAL VALID
FOR 90 DAYS UNLESS
DRILLING COMMENCED,
EXPIRES 1-24-73



IN ABOVE SPACE DESCRIBE PROPOSED PROGRAM: IF PROPOSAL IS TO DEEPEN OR PLUG BACK, GIVE DATA ON PRESENT PRODUCTIVE ZONE AND PROPOSED NEW PRODUCTIVE ZONE. GIVE BLOWOUT PREVENTER PROGRAM, IF ANY.

I hereby certify that the information above is true and complete to the best of my knowledge and belief.

Signed J. H. Wood Title Petroleum Engineer Date October 25, 1972

(This space for State Use)

APPROVED BY Ernest Chavez TITLE SUPERVISOR DIST. #3 DATE OCT 26 1972
CONDITIONS OF APPROVAL, IF ANY:

NEW MEXICO OIL CONSERVATION COMMISSION
WELL LOCATION AND ACREAGE DEDICATION PLAT

Form O-171
Supersedes O-128
Effective 1-1-65

All distances must be from the outer boundaries of the section.

EL PASO NATURAL GAS COMPANY		Location ATLANTIC D COM. F (E-453-4)		Section 7
Tract Number H	Section 2	Township 30-N	Range 10-W	County SAN JUAN
Acres 1460	Direction NORTH		Distance 800	Direction EAST
Section Number 6552	Section Name PICTURED CLIFFS		Section Name BLANCO PICTURED CLIFFS EXT. 160.84	

1. Outline the acreage dedicated to the subject well by colored pencil or hatchure marks on the plat below.
2. If more than one lease is dedicated to the well, outline each and identify the ownership thereof (both as to working interest and royalty).
3. If more than one lease of different ownership is dedicated to the well, have the interests of all owners been consolidated by communitization, unitization, force-pooling, etc?

☐ Yes ☐ No If answer is "yes," type of consolidation _____

If answer is "no," list the owners and tract descriptions which have actually been consolidated (reverse side of this form if necessary.) _____

No allowable will be assigned to the well until all interests have been consolidated (by communitization, unitization, forced-pooling, or otherwise) or until a non-standard unit, eliminating such interests, has been approved by the Commission.

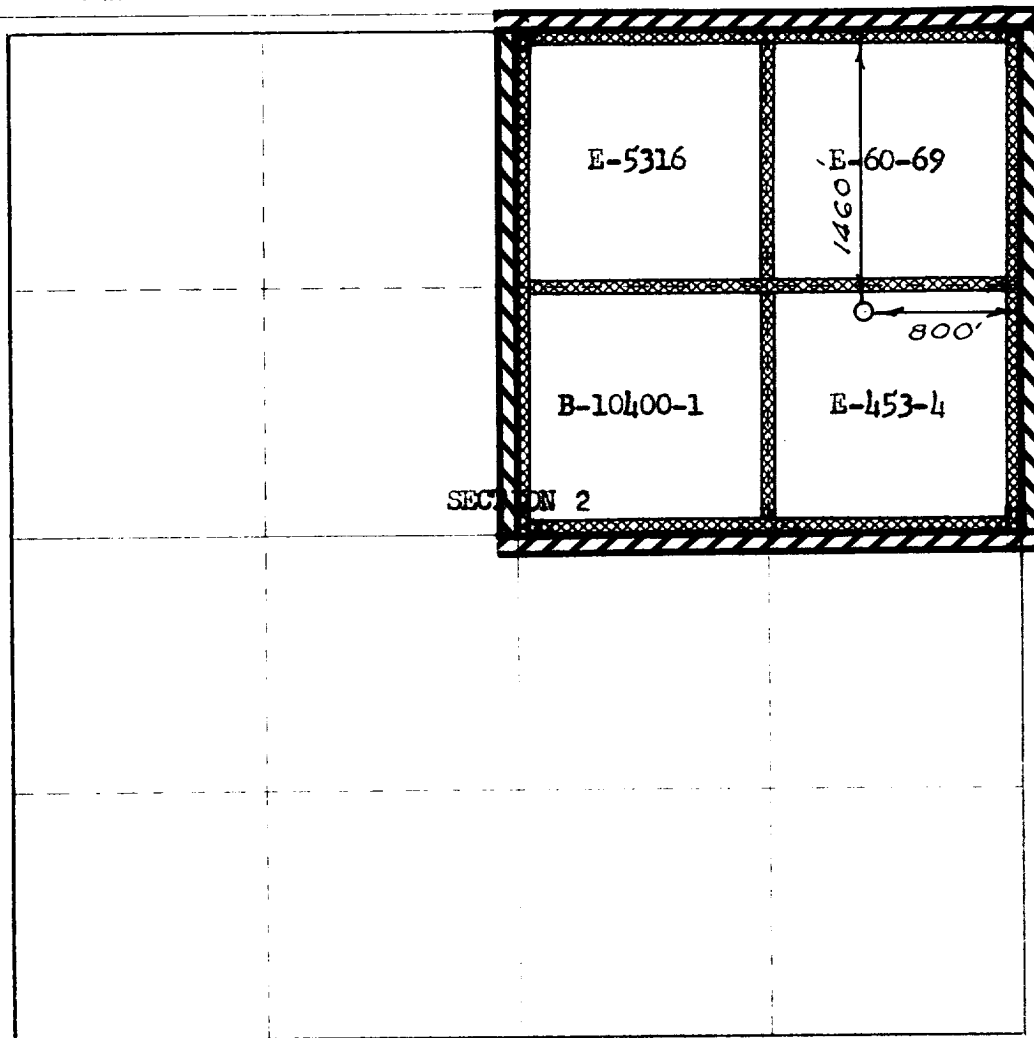
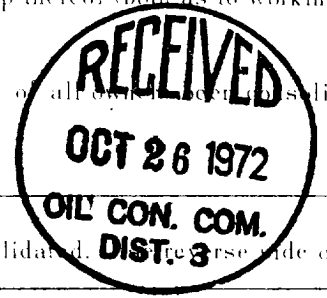

CERTIFICATION

I hereby certify that the information contained herein is true and complete to the best of my knowledge and belief.

Original Signed E. H. WOOD

Petroleum Engineer

El Paso Natural Gas Company

October 25, 1972

I hereby certify that the well location shown on this plat was plotted from field notes of actual surveys made by me or under my supervision, and that the same is true and correct to the best of my knowledge and belief.

DECEMBER 15, 1971

Paul Olsen

1760