

UNITED STATES
DEPARTMENT OF THE INTERIOR
GEOLOGICAL SURVEY

30-045-21108

APPLICATION FOR PERMIT TO DRILL, DEEPEN, OR PLUG BACK

1a. TYPE OF WORK

DRILL ☒DEEPEN ☐PLUG BACK ☐

b. TYPE OF WELL

OIL
WELL ☐GAS
WELL ☒

OTHER

SINGLE
ZONE ☐MULTIPLE
ZONE ☐

2. NAME OF OPERATOR

Lively Exploration Company

3. ADDRESS OF OPERATOR

Box 234, Farmington, New Mexico 87401

4. LOCATION OF WELL (Report location clearly and in accordance with any State requirements.)

At surface

840' FSL - 1100' FWL

At proposed prod. zone

14. DISTANCE IN MILES AND DIRECTION FROM NEAREST TOWN OR POST OFFICE*

14 miles east Blanco, New Mexico

15. DISTANCE FROM PROPOSED*

LOCATION TO NEAREST

PROPERTY OR LEASE LINE, FT.

(Also to nearest drlg. unit line, if any)

840'

18. DISTANCE FROM PROPOSED LOCATION*

TO NEAREST WELL, DRILLING, COMPLETED,
OR APPLIED FOR, ON THIS LEASE, FT.

600' approx

16. NO. OF ACRES IN LEASE

19. PROPOSED DEPTH

7400'

17. NO. OF ACRES ASSIGNED

TO THIS WELL

320

20. ROTARY OR CABLE TOOLS

Rotary

21. ELEVATIONS (Show whether DF, RT, GR, etc.)

5993' GR

22. APPROX. DATE WORK WILL START*

12-15-72

23.

PROPOSED CASING AND CEMENTING PROGRAM

SIZE OF HOLE	SIZE OF CASING	WEIGHT PER FOOT	SETTING DEPTH	QUANTITY OF CEMENT
13 3/4	9 5/8	32.30	300	200 cu. ft.
8 3/4	7	20	3200	600 cu. ft.
6 1/4	4 1/2	10.5	7400	600 cu. ft.

Plan to drill with water or minimum mud to 3200', set 7" intermediate csg and cement with 600 cu. ft. cement. Drill 6 1/4" hole with gas to T.D. to test Dakota formation. Run 4 1/2" production csg thru Dakota, selective perforate and sand water frac, clean out, run 1 1/4" tbg and complete well.



IN ABOVE SPACE DESCRIBE PROPOSED PROGRAM: If proposal is to deepen or plug back, give data on present productive zone and proposed new productive zone. If proposal is to drill or deepen directionally, give pertinent data on subsurface locations and measured and true vertical depths. Give blowout preventer program, if any.

24.

SIGNED Original signed by T. A. Dugan TITLE Engineer DATE 10-31-72

(This space for Federal or State office use)

PERMIT NO. APPROVAL DATE

APPROVED BY DATE

CONDITIONS OF APPROVAL, IF ANY:

**NEW MEXICO OIL CONSERVATION COMMISSION
WELL LOCATION AND ACERAGE DEDICATION PLAT**

All distances must be from the outer boundaries of the Section

Operator LIVELY EXPLORATION COMPANY			Lease Lively		Well No. 7
Unit Letter M	Section 35	Township 30 North	Range 8 West	County San Juan	
Actual Footage Location of Well: 840 feet from the South line and 1100 feet from the West line					
Ground Level Elev. 5993	Producing Formation Dakota		Pool Basin	Dedicated Acreage: 320 Acres	

1. Outline the acreage dedicated to the subject well by colored pencil or hatchure marks on the plat below.
2. If more than one lease is dedicated to the well, outline each and identify the ownership thereof (both as to ownership interest and royalty),
3. If more than one lease of different ownership is dedicated to the well, have the interests of all owners been consolidated by communitization, unitization, force-pooling, etc?
 () Yes () No If answer is "yes," type of consolidation

If answer is "no," list the owners and tract descriptions which have actually consolidated. (Use reverse side of this form if necessary.)

No allowable will be assigned to the well until all interests have been consolidated (by communitization, unitization, forced-pooling, or otherwise) or until a non standard unit, eliminating such interests, has been approved by the Commission.

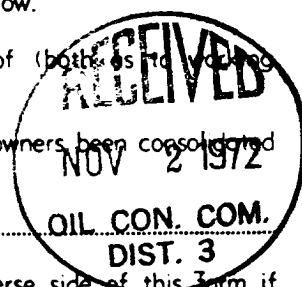

CERTIFICATION

I hereby certify that the information contained herein is true and complete to the best of my knowledge and belief.

Original signed by T. A. Dugan

Name
Thomas A. Dugan
 Position
Engineer
 Company
Lively Exploration Company
 Date
10-31-72

I hereby certify that the well location shown on this plat was plotted from field notes of actual surveys made by ESQ. M. Under supervision, and that the same is true and correct to the best of my knowledge and belief.

STATE OF NEW MEXICO
REGISTERED LAND SURVEYOR
 Date Surveyed
October 12, 1972
 Registered Professional Engineer
and/or Land Surveyor

E. V. Echhawk
 Certificate No. 3602
E. V. Echhawk LS

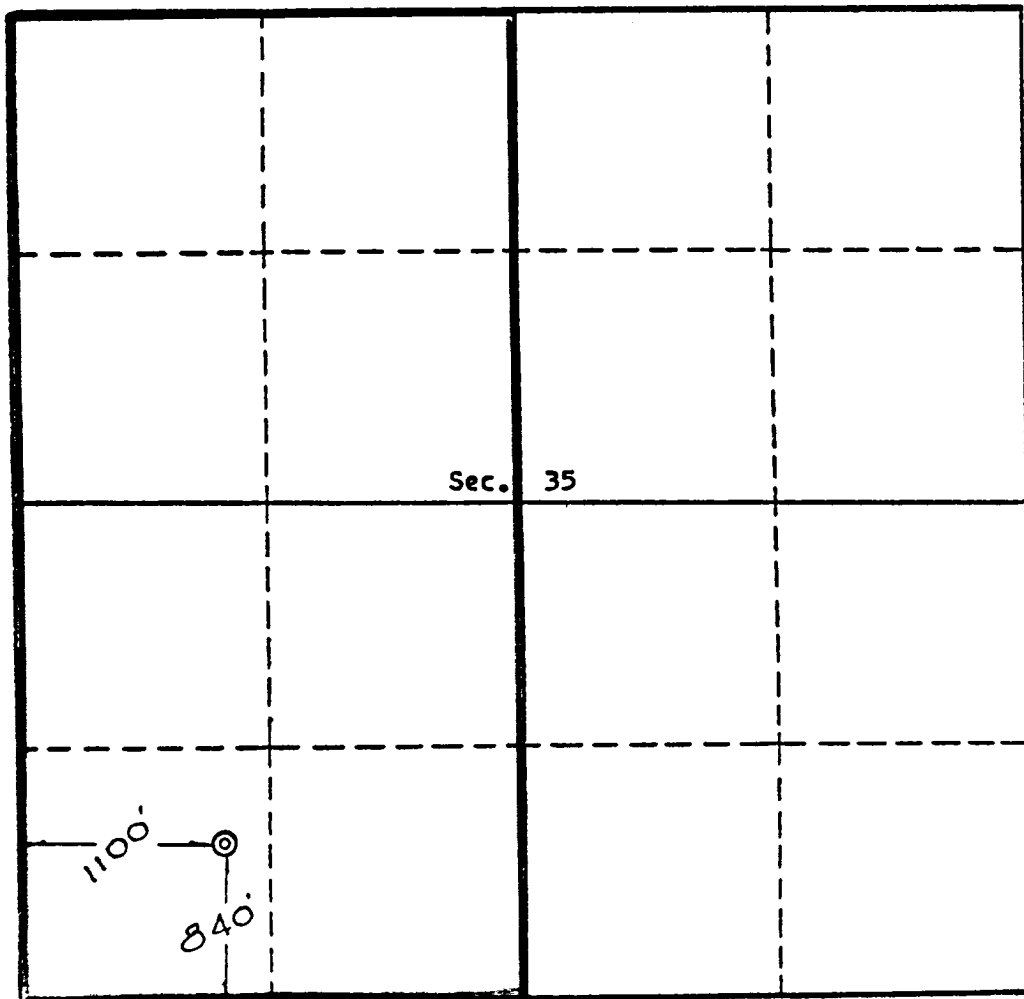

Scale, 1 inch = 1,000 feet