

**NEW MEXICO OIL CONSERVATION COMMISSION
WELL LOCATION AND ACERAGE DEDICATION PLAT**

All distances must be from the outer boundaries of the Section

Operator LIVELY EXPLORATION COMPANY			Lease Lively		Well No. 7
Unit Letter N	Section 35	Township 30 North	Range 8 West	County San Juan	
Actual Footage Location of Well: 1050 feet from the South line and 1700 feet from the West line					
Ground Level Elev. 5981	Producing Formation Dakota		Pool Basin	Dedicated Acreage: 320 Acres	

1. Outline the acreage dedicated to the subject well by colored pencil or hachure marks on the plat below.
2. If more than one lease is dedicated to the well, outline each and identify the ownership thereof (both as to working interest and royalty),
3. If more than one lease of different ownership is dedicated to the well, have the interests of all owners been consolidated by communitization, unitization, force-pooling, etc?

Yes No If answer is "yes," type of consolidation

If answer is "no," list the owners and tract descriptions which have actually consolidated. (Use reverse side of this form if necessary.)

No allowable will be assigned to the well until all interests have been consolidated (by communitization, unitization, forced-pooling, or otherwise) or until a non standard unit, eliminating such interests, has been approved by the Commission.

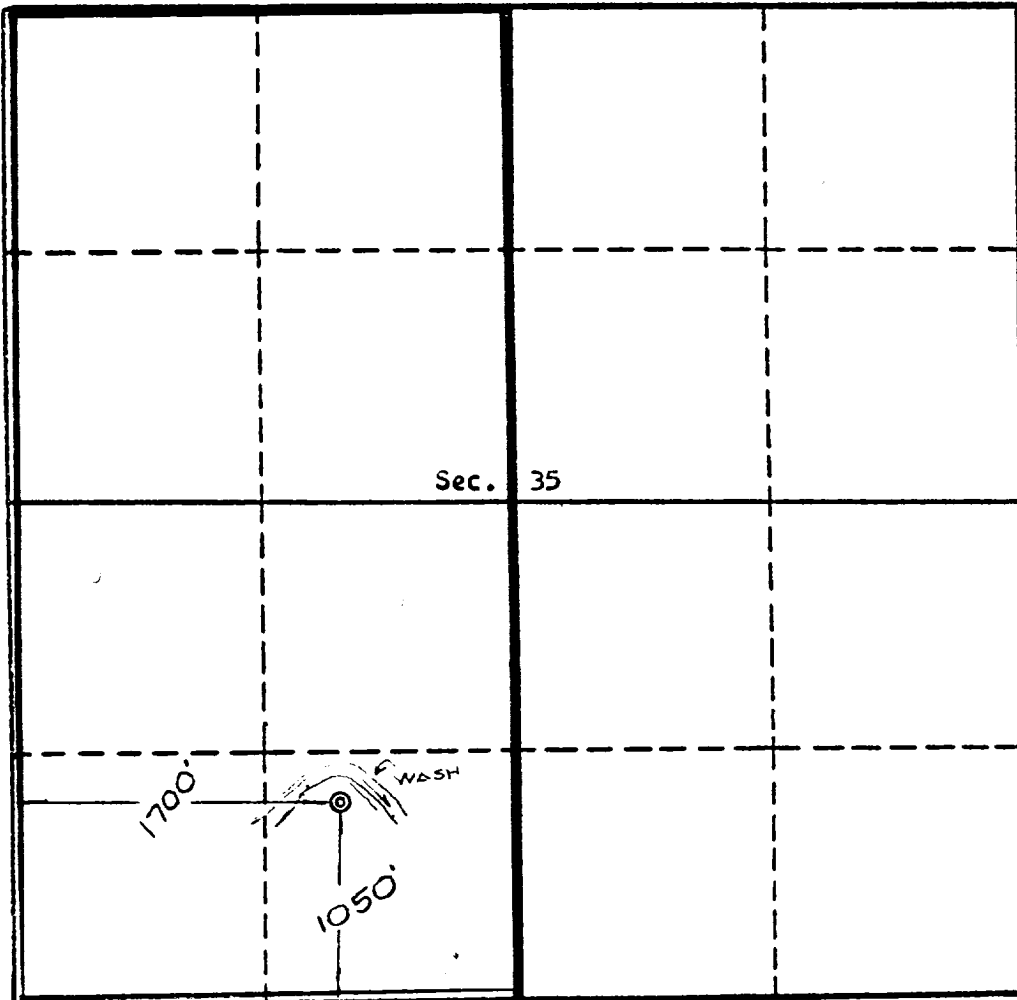
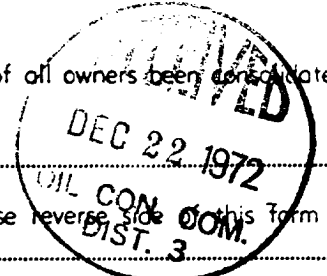

Scale, 1 inch = 1,000 feet

CERTIFICATION

I hereby certify that the information contained herein is true and complete to the best of my knowledge and belief.

Original signed by T. A. Dugan
 Name
Thomas A. Dugan
 Position
Engineer
 Company
Lively Exploration Company
 Date
12-20-72

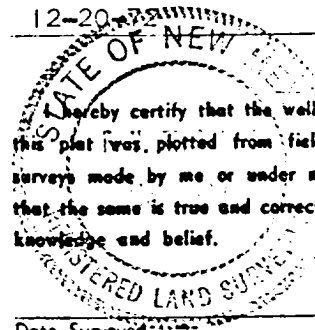

I hereby certify that the well location shown on this plat was plotted from field notes of actual surveys made by me or under my supervision, and that the same is true and correct to the best of my knowledge and belief.

Date Surveyed
December 6, 1972
 Registered Professional Engineer
 and/or Land Surveyor

E. V. Echhawk
 Certificate No. 3602
E. V. Echhawk LS