

UNITED STATES  
DEPARTMENT OF THE INTERIOR  
GEOLOGICAL SURVEY

30-045-21120

## APPLICATION FOR PERMIT TO DRILL, DEEPEN, OR PLUG BACK

1a. TYPE OF WORK DRILL <input checked="" type="checkbox"/> DEEPEN <input type="checkbox"/> PLUG BACK <input type="checkbox"/>		5. LEASE DESIGNATION AND SERIAL NO. SF 078200-A		
b. TYPE OF WELL OIL WELL <input type="checkbox"/> GAS WELL <input checked="" type="checkbox"/> OTHER <input type="checkbox"/>		6. IF INDIAN, ALLOTTEE OR TRIBE NAME		
2. NAME OF OPERATOR El Paso Natural Gas Company		7. UNIT AGREEMENT NAME		
3. ADDRESS OF OPERATOR PO Box 990, Farmington, NM 87401		8. FARM OR LEASE NAME Grambling C		
4. LOCATION OF WELL (Report location clearly and in accordance with any State requirements.)* At surface 925'S, 810'W At proposed prod. zone		9. WELL NO. 10		
14. DISTANCE IN MILES AND DIRECTION FROM NEAREST TOWN OR POST OFFICE*		10. FIELD AND POOL, OR WILDCAT Blanco Pictured Cliffs Ext.		
15. DISTANCE FROM PROPOSED* LOCATION TO NEAREST PROPERTY OR LEASE LINE, FT. (Also to nearest drlg. unit line, if any)		11. SEC., T., R., M., OR BLK. AND SURVEY OR AREA Sec. 12, T-30-N, R-10-W NMPM		
16. NO. OF ACRES IN LEASE		12. COUNTY OR PARISH 13. STATE San Juan New Mexico		
17. NO. OF ACRES ASSIGNED TO THIS WELL 152.96		18. DISTANCE FROM PROPOSED LOCATION* TO NEAREST WELL, DRILLING, COMPLETED, OR APPLIED FOR, ON THIS LEASE, FT.		
19. PROPOSED DEPTH 3405'		20. ROTARY OR CABLE TOOLS Rotary		
21. ELEVATIONS (Show whether DF, RT, GR, etc.) 6601'GL		22. APPROX. DATE WORK WILL START*		
23. PROPOSED CASING AND CEMENTING PROGRAM				
SIZE OF HOLE	SIZE OF CASING	WEIGHT PER FOOT	SETTING DEPTH	QUANTITY OF CEMENT
12 1/4"	8 5/8"	24.0#	120'	107 cu. ft. to circulate
6 3/4"	2 7/8"	6.4#	3405'	440 cu. ft. to cover Ojo Alamo

Selectively perforate and sandwater fracture the Pictured Cliffs formation.

The SW/4 of Section 12 is dedicated to this well.

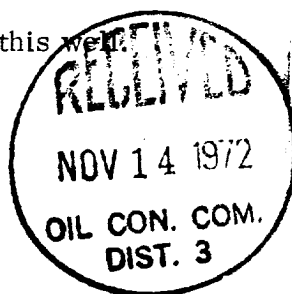

NOV 13 1972

U. S. GEOLOGICAL

IN ABOVE SPACE DESCRIBE PROPOSED PROGRAM: If proposal is to deepen or plug back, give data on present productive zone and proposed new productive zone. If proposal is to drill or deepen directionally, give pertinent data on subsurface locations and measured and true vertical depths. Give blowout preventer program, if any.

24. SIGNED JH Wood TITLE Petroleum Engineer DATE November 13, 1972

(This space for Federal or State office use)

PERMIT NO. \_\_\_\_\_ APPROVAL DATE \_\_\_\_\_

APPROVED BY \_\_\_\_\_ TITLE \_\_\_\_\_ DATE \_\_\_\_\_

CONDITIONS OF APPROVAL, IF ANY:

JH Wood

\*See Instructions On Reverse Side

NEW MEXICO OIL CONSERVATION COMMISSION  
WELL LOCATION AND ACREAGE DEDICATION PLAT

Form 1-132  
Supersedes C-128  
Effective 1-1-65

All distances must be from the outer boundaries of the Section.

EL PASO NATURAL GAS COMPANY		Lease <b>GRANBLING C (SF-078200-A)</b>		Well No. <b>10</b>
Section <b>12</b>	Township <b>30-N</b>	Range <b>10-W</b>	County <b>SAN JUAN</b>	
Actual Well Location of Well <b>925</b> feet from the <b>SOUTH</b> line and <b>810</b> feet from the <b>WEST</b> line				
Ground Level Elevation <b>6601</b>	Section 33 Number <b>PICTURED CLIFFS</b>	Pool <b>BLANCO PICTURED CLIFFS EXT.</b>	Section 33 Acres <b>152.96</b> Acres	

1. Outline the acreage dedicated to the subject well by colored pencil or hatchure marks on the plat below.
2. If more than one lease is dedicated to the well, outline each and identify the ownership thereof (both as to working interest and royalty)
3. If more than one lease of different ownership is dedicated to the well, have the interests of all owners been consolidated by communitization, unitization, force-pooling, etc?

☐ Yes ☐ No If answer is "yes," type of consolidation \_\_\_\_\_

If answer is "no," list the owners and tract descriptions which have actually been consolidated. (Use reverse side of this form if necessary.) \_\_\_\_\_

No allowable will be assigned to the well until all interests have been consolidated (by communitization, unitization, forced-pooling, or otherwise) or until a non-standard unit, eliminating such interests, has been approved by the Commission.

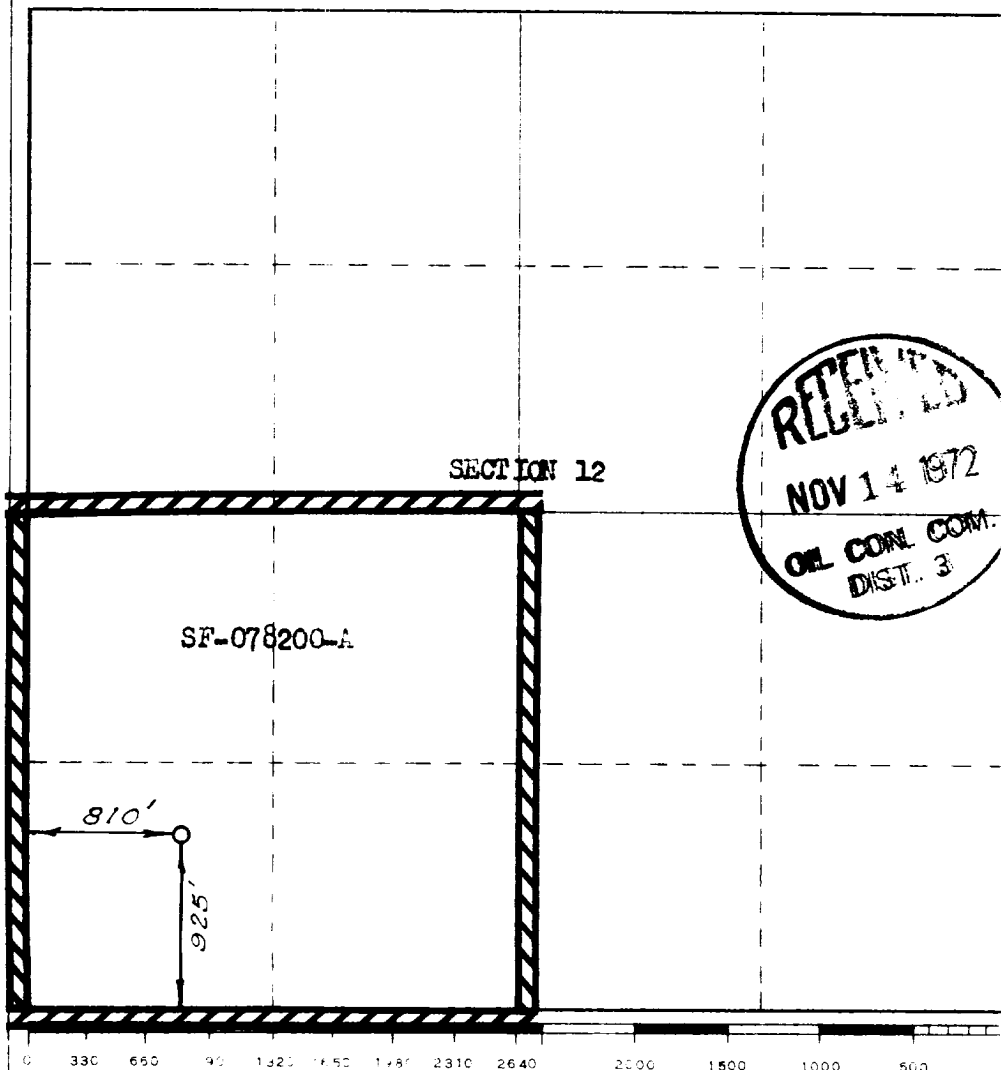

CERTIFICATION

I hereby certify that the information contained herein is true and complete to the best of my knowledge and belief.

Original Signed E. H. Wood

Name  
**Petroleum Engineer**  
Position  
**El Paso Natural Gas Company**  
Company  
**November 13, 1972**  
Date

I hereby certify that the well location shown on this plat was plotted from field notes of actual surveys made by me or under my supervision, and that the same is true and correct to the best of my knowledge and belief.

Date Surveyed  
**SEPTEMBER 28, 1972**  
Registered Professional Engineer and Land Surveyor  
*David O'Brien*  
Certificate No. **1760**