

NO. OF COPIES RECEIVED	5
DISTRIBUTION	
SANTA FE	1
FILE	1
U.S.G.S.	2
LAND OFFICE	
OPERATOR	1

# NEW MEXICO OIL CONSERVATION COMMISSION

Form C-101  
Revised 1-1-65

30-045-21289

5A. Indicate Type of Lease STATE <input type="checkbox"/> FEE <input checked="" type="checkbox"/>
5. State Oil & Gas Lease No.
7. Unit Agreement Name
8. Farm or Lease Name Micheal
9. Well No. #1
10. Field and Pool, or Wildcat North Aztec under Fruitland EXT
12. County San Juan
19. Proposed Depth 2300'
19A. Formation Fruitland
20. Rotary or C.T. Rotary
21. Elevations (Show whether DF, RT, etc.) 5968' GR
21A. Kind & Status Plug. Bond State
21B. Drilling Contractor Aztec Well Service
22. Approx. Date Work will start 15 days

## APPLICATION FOR PERMIT TO DRILL, DEEPEN, OR PLUG BACK

1a. Type of Work b. Type of Well OIL WELL <input type="checkbox"/> GAS WELL <input checked="" type="checkbox"/> OTHER <input type="checkbox"/> DRILL <input checked="" type="checkbox"/> DEEPEN <input type="checkbox"/> PLUG BACK <input type="checkbox"/> SINGLE ZONE <input checked="" type="checkbox"/> MULTIPLE ZONE <input type="checkbox"/>	2. Name of Operator Fairplay Oil & Gas Corporation	3. Address of Operator P. O. Box B, Aztec, New Mexico	4. Location of Well UNIT LETTER D LOCATED 795 FEET FROM THE North LINE AND 1010 FEET FROM THE West LINE OF SEC. 13 TWP. 30N RGE. 11W NMPM
23.			

## PROPOSED CASING AND CEMENT PROGRAM

SIZE OF HOLE	SIZE OF CASING	WEIGHT PER FOOT	SETTING DEPTH	SACKS OF CEMENT	EST. TOP
10-3/4"	7-7/8"	26.40#	90'	90	Circulate
6-3/4"	3-1/2"	7.70	2300'	300	Circulate

## PROPOSE TO:

Set 7-7/8" surface casing at approximately 90', cement to surface.  
Drill 6-3/4" hole to approximately 2300'.  
Run 3-1/2" casing to total depth, cement with 300 sxs.  
Perforate and sand/water frac Fruitland formation.  
Run 1" tubing, install well head.

APPROVAL VALID  
FOR 90 DAYS UNLESS  
DRILLING COMMENCED,

EXPIRES 9-4-73

Dedicated acres 160, NW/4 of Section 13-30N-11W

IN ABOVE SPACE DESCRIBE PROPOSED PROGRAM: IF PROPOSAL IS TO DEEPEN OR PLUG BACK, GIVE DATA ON PRESENT PRODUCTIVE ZONE AND PROPOSED NEW PRODUCTIVE ZONE. GIVE BLOWOUT PREVENTER PROGRAM, IF ANY.

I hereby certify that the information above is true and complete to the best of my knowledge and belief.

Signed [Signature] Title President Date June 1, 1973

(This space for State Use)

APPROVED BY [Signature] TITLE PETROLEUM ENGINEER DIST. NO. 3 DATE JUN 4 1973

CONDITIONS OF APPROVAL, IF ANY:

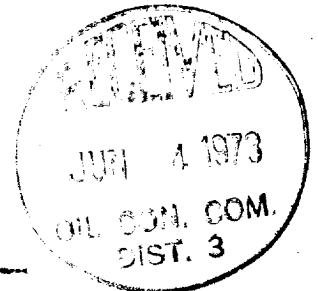

**NEW MEXICO OIL CONSERVATION COMMISSION  
WELL LOCATION AND ACREAGE DEDICATION PLAT**

Form C-102  
Supersedes C-128  
Effective 1-4-65

All distances must be from the outer boundaries of the Section.

Operator <b>Fairplay Oil &amp; Gas Co.</b>			Lease <b>Micheal</b>		Well No. <b>1</b>
Unit Letter <b>D</b>	Section <b>13</b>	Township <b>30N</b>	Range <b>11W</b>	County <b>San Juan</b>	
Actual Footage Location of Well: <b>795</b> feet from the <b>North</b> line and <b>1010'</b> feet from the <b>West</b> line					
Ground Level Elev. <b>5968</b>	Producing Formation <b>Fruitland</b>		Pool <b>North Aztec EXT</b>	Dedicated Acreage: <b>160</b> Acres	

1. Outline the acreage dedicated to the subject well by colored pencil or hachure marks on the plat below.
2. If more than one lease is dedicated to the well, outline each and identify the ownership thereof (both as to working interest and royalty).
3. If more than one lease of different ownership is dedicated to the well, have the interests of all owners been consolidated by communitization, unitization, force-pooling, etc?

☐ Yes ☐ No If answer is "yes," type of consolidation \_\_\_\_\_

If answer is "no," list the owners and tract descriptions which have actually been consolidated. (DIST. reverse side of this form if necessary.) \_\_\_\_\_

No allowable will be assigned to the well until all interests have been consolidated (by communitization, unitization, forced-pooling, or otherwise) or until a non-standard unit, eliminating such interests, has been approved by the Commission.

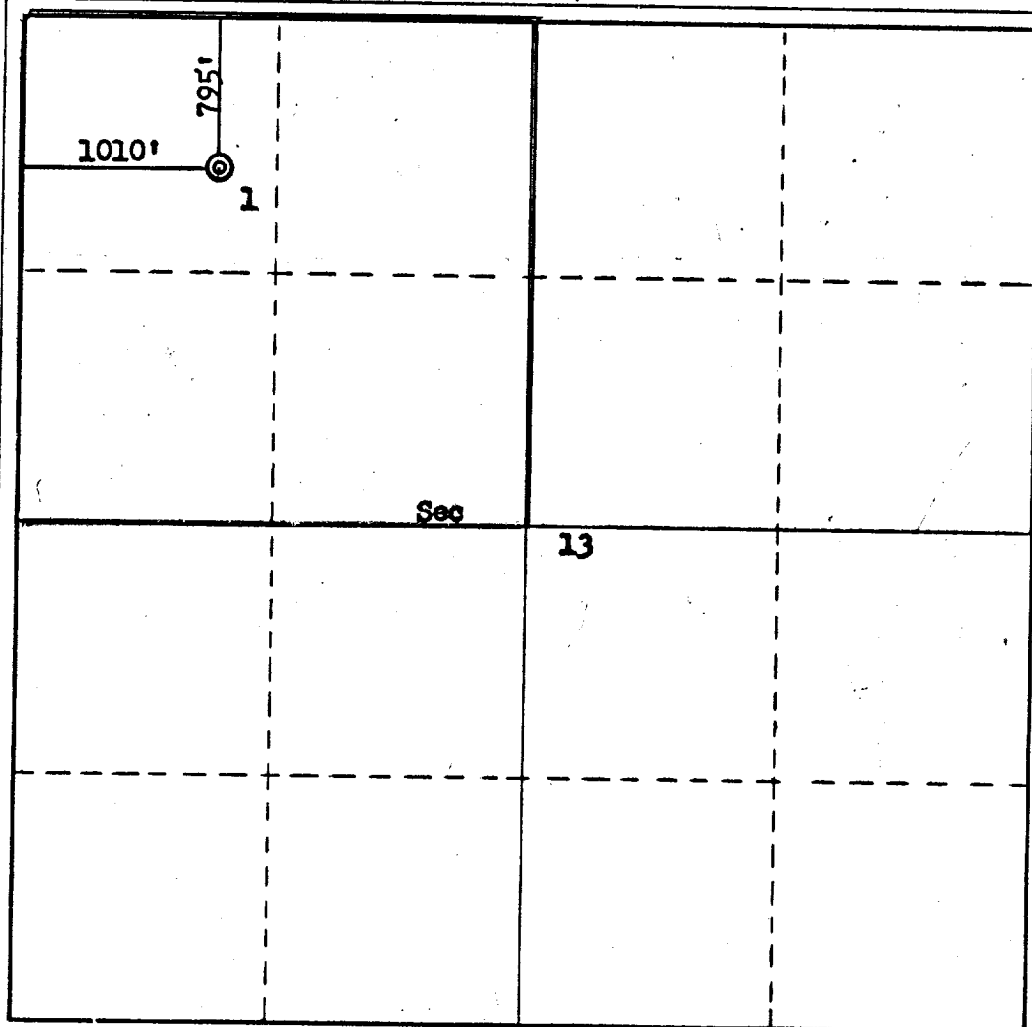
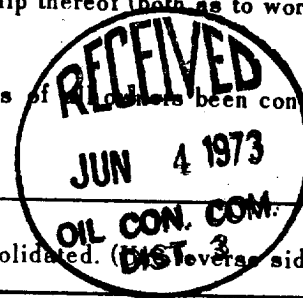

**CERTIFICATION**

I hereby certify that the information contained herein is true and complete to the best of my knowledge and belief.

Name Wayne Sandoz  
Position President  
Company Fair Play Oil & Gas Co.  
Date June 1, 1973

I hereby certify that the well location shown on this plat was plotted from field notes of actual surveys made by me or under my supervision, and that the same is true and correct to the best of my knowledge and belief.

Date Surveyed June 1, 1973  
Registered Professional Engineer and/or Land Surveyor  
Fred H. Kerr Jr.  
Certificate No. 3950

