

LOCATION AND EQUIPMENT LAY-OUT

FORECAST #3

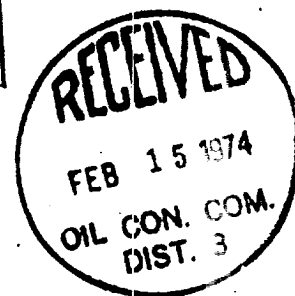

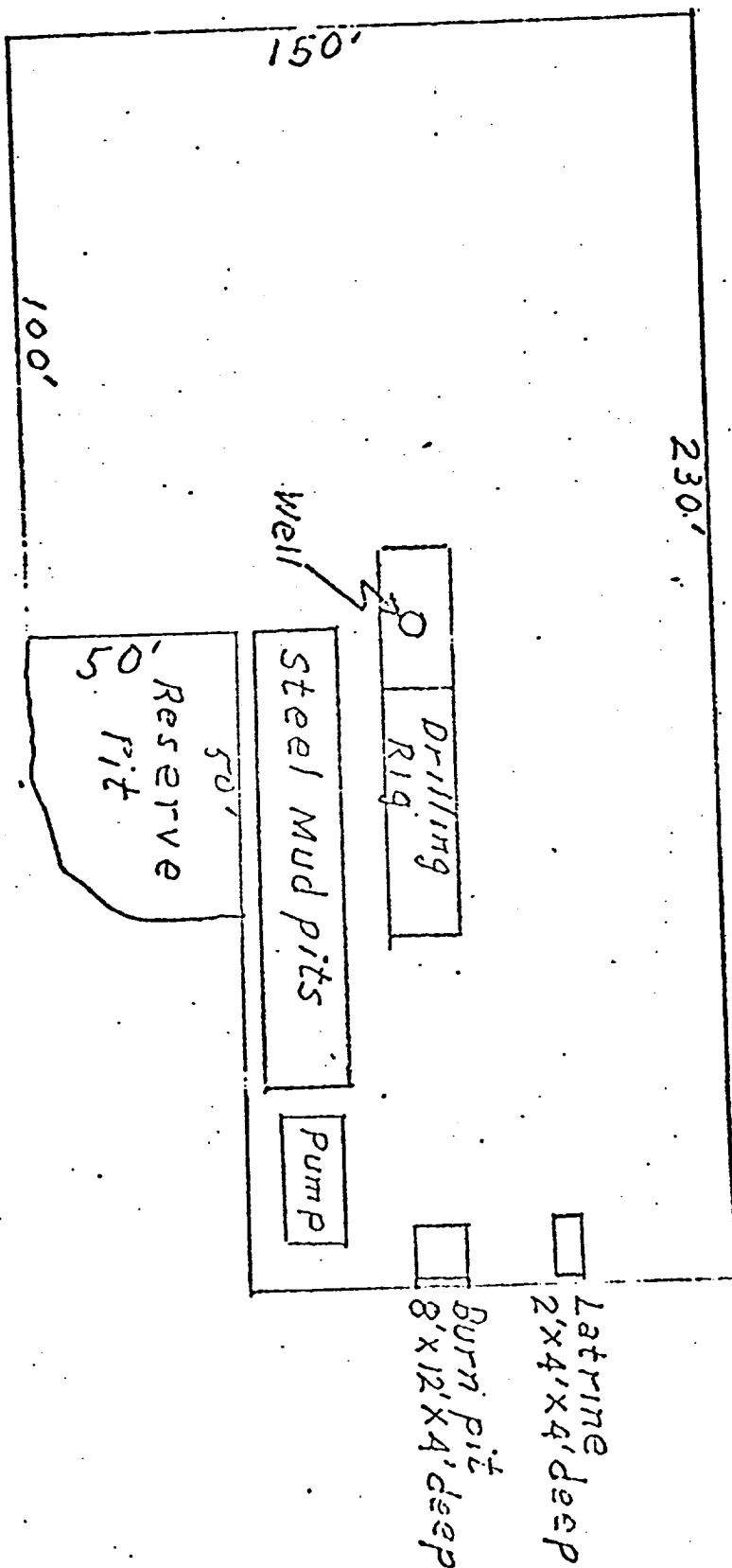

Garret #3
 SE 27/4, Sec 26, T 34 N, R 11 W

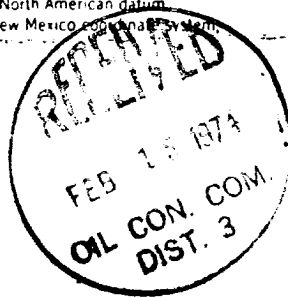
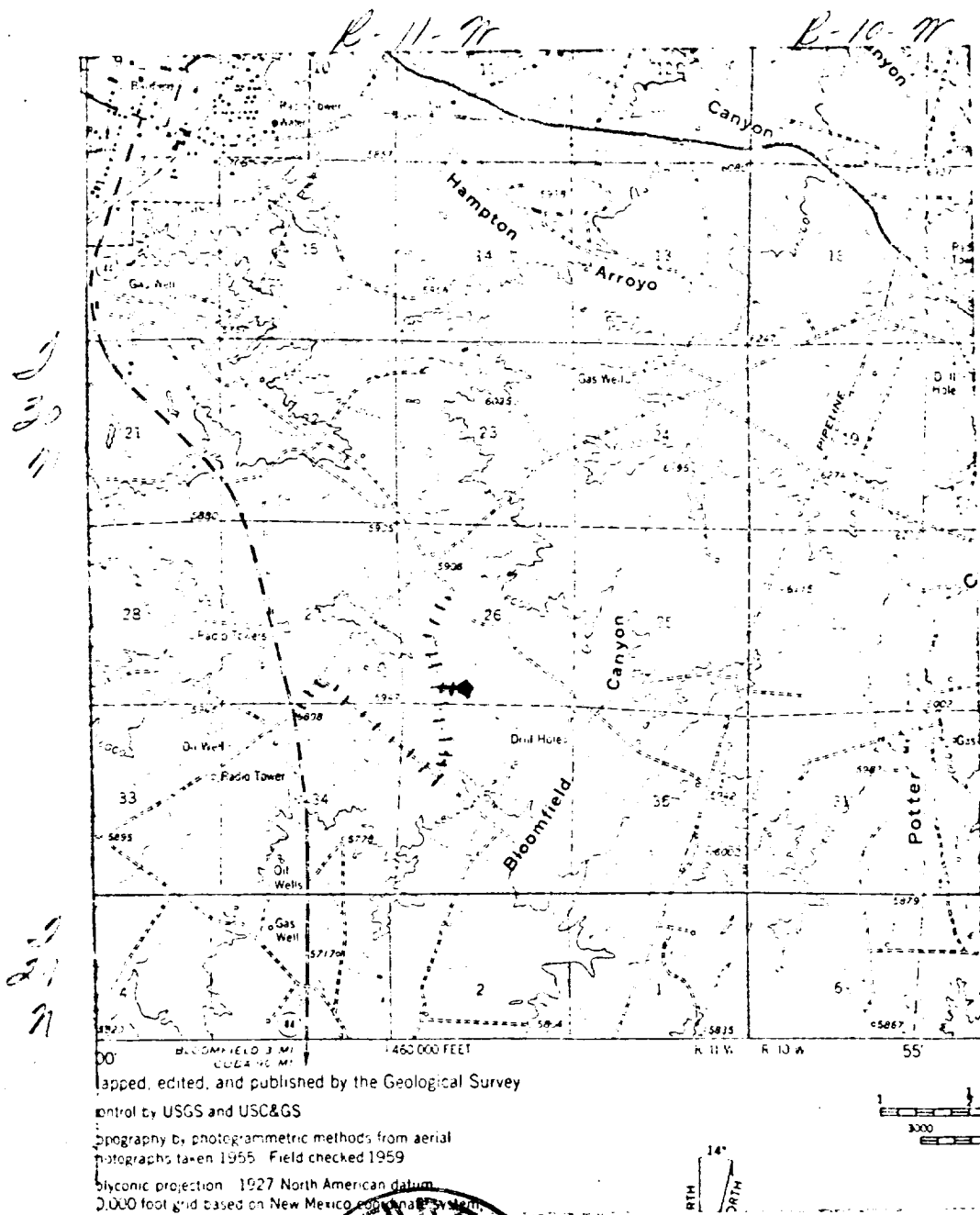

LEGEND OF RIGHT-OF-WAYS

- EXISTING ROADS ————
- EXISTING PIPELINES — + — + —
- EXISTING ROAD & PIPELINE — + + — +
- PROPOSED ROADS ————
- PROPOSED PIPELINES — + — + —
- PROPOSED ROAD & PIPELINE — + + — +

El Paso Natural Gas Company

El Paso, Texas 79978

February 14, 1974

ADDRESS REPLY TO
POST OFFICE BOX 959
FARMINGTON NEW MEXICO 87401

Mr. P. T. McGrath
U. S. Geological Survey
Post Office Box 959
Farmington, New Mexico 87401

FEB 14 1974

U.S.

Re: Application for Permit to Drill
Forrest #3
SW/4 Section 26, T-30-N, R-11-W
Aztec Pictured Cliffs

Dear Mr. McGrath:

Details regarding existing roads, pipelines, wells, etc. relative to the above well location are included on the previously submitted base maps, "Field Road Map" and "Composite Map No. 1".

The proposed new well location, new roads and new pipeline are shown on the attached plat along with connecting existing roads and pipelines in the vicinity of the proposed new well.

Water for drilling and completion operations will be obtained from the following location: Bloomfield Irrigation District Ditch located in the South half of Section 15, T-29-N, R-11-W.
Waste material will be disposed of by burial in the burn pit, latrine, or reserve pit as applicable. There will be no camp nor air strip associated with drilling this well. Upon completion or abandonment of this well, the location will be cleaned and leveled and a dry hole marker placed, if applicable.

Yours very truly,

D. G. Brisco

D. G. Brisco
Drilling Clerk

pb



