

UNITED STATES  
DEPARTMENT OF THE INTERIOR  
GEOLOGICAL SURVEY

30-045-21433

5. LEASE DESIGNATION AND SERIAL NO.

SF 080776-A

6. IF INDIAN, ALLOTTEE OR TRIBE NAME

7. UNIT AGREEMENT NAME

8. FARM OR LEASE NAME

Florance A

9. WELL NO.

3

10. FIELD AND POOL, OR WILDCAT

Blanco Pictured Cliffs

11. SEC., T., R., M., OR BLK.  
AND SURVEY OR AREASec. 25, T-30-N, R-10-W  
NMPM

12. COUNTY OR PARISH

San Juan

13. STATE

NM

17. NO. OF ACRES ASSIGNED  
TO THIS WELL

157.38 ✓

20. ROTARY OR CABLE TOOLS

Rotary

22. APPROX. DATE WORK WILL START\*

## 1a. TYPE OF WORK

DRILL ☒DEEPEN ☐PLUG BACK ☐

## b. TYPE OF WELL

OIL  
WELL ☐GAS  
WELL ☒

OTHER

SINGLE  
ZONE ☒MULTIPLE  
ZONE ☐

## 2. NAME OF OPERATOR

El Paso Natural Gas Company

## 3. ADDRESS OF OPERATOR

PO Box 990, Farmington, NM 87401

## 4. LOCATION OF WELL (Report location clearly and in accordance with any State requirements.)\*

At surface

1840'N, 1500'E

At proposed prod. zone

## 14. DISTANCE IN MILES AND DIRECTION FROM NEAREST TOWN OR POST OFFICE\*

## 15. DISTANCE FROM PROPOSED\*

LOCATION TO NEAREST  
PROPERTY OR LEASE LINE, FT.  
(Also to nearest drlg. unit line, if any)

## 16. NO. OF ACRES IN LEASE

18. DISTANCE FROM PROPOSED LOCATION\*  
TO NEAREST WELL, DRILLING, COMPLETED,  
OR APPLIED FOR, ON THIS LEASE, FT.

## 19. PROPOSED DEPTH

2873'

## 21. ELEVATIONS (Show whether DF, RT, GR, etc.)

6118'GL

## 23.

## PROPOSED CASING AND CEMENTING PROGRAM

| SIZE OF HOLE | SIZE OF CASING | WEIGHT PER FOOT | SETTING DEPTH | QUANTITY OF CEMENT             |
|--------------|----------------|-----------------|---------------|--------------------------------|
| 12 1/4"      | 8 5/8"         | 24.0#           | 120'          | 106 cu. ft. to circulate       |
| 7 7/8"       | ---            | ---             | 2658'         | ---                            |
| 6 3/4"       | 2 7/8"         | 6.4#            | 2873'         | 585 cu. ft. to cover Ojo Alamo |

Selectively perforate and sandwater fracture the Pictured Cliffs formation.

The NE/4 of Section 25 is dedicated to this well.

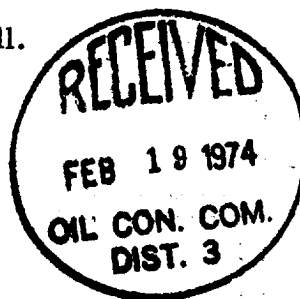

FEB 14 1974

U. S. GEOLOGICAL

IN ABOVE SPACE DESCRIBE PROPOSED PROGRAM: If proposal is to deepen or plug back, give data on present productive zone and proposed new productive zone. If proposal is to drill or deepen directionally, give pertinent data on subsurface locations and measured and true vertical depths. Give blowout preventer program, if any.

24.

SIGNED

*A. H. Sisco*

TITLE

Drilling Clerk

DATE

February 14, 1974

(This space for Federal or State office use)

PERMIT NO.

APPROVAL DATE

APPROVED BY

TITLE

DATE

CONDITIONS OF APPROVAL, IF ANY:

*Okal*

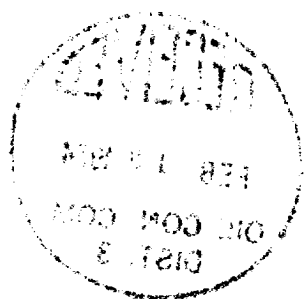

**NEW MEXICO OIL CONSERVATION COMMISSION  
WELL LOCATION AND ACREAGE DEDICATION PLAT**

Form C-102  
Supersedes C-128  
Effective 1-1-65

All distances must be from the outer boundaries of the Section.

|  |                      |                         |  |                           |                      |
|--|----------------------|-------------------------|--|---------------------------|----------------------|
| Operator<br><b>EL PASO NATURAL GAS COMPANY</b> |                      |                         | Lease<br><b>FLORANCE A (SF-080776-A)</b> |                           | Well No.<br><b>3</b> |
| Unit Letter<br><b>G</b>                        | Section<br><b>25</b> | Township<br><b>30-N</b> | Range<br><b>10-W</b>                     | County<br><b>SAN JUAN</b> |                      |

|  |   |                                       |   |  |  |
|--|---|---------------------------------------|---|--|--|
| Actual Footage Location of Well:<br><b>1840</b> feet from the <b>NORTH</b> line and <b>1500</b> feet from the <b>EAST</b> line |   |                                       |   |  |  |
| Ground Level Elev.<br><b>6118</b>  | Producing Formation<br><b>PICTURED CLIFFS</b> | Pool<br><b>BLANCO PICTURED CLIFFS</b> | Dedicated Acreage:<br><b>157.38</b> Acres |  |  |

1. Outline the acreage dedicated to the subject well by colored pencil or hachure marks on the plat below.
2. If more than one lease is dedicated to the well, outline each and identify the ownership thereof (both as to working interest and royalty).
3. If more than one lease of different ownership is dedicated to the well, have the interests of all owners been consolidated by communitization, unitization, force-pooling, etc?

☐ Yes    ☐ No    If answer is "yes," type of consolidation \_\_\_\_\_

If answer is "no," list the owners and tract descriptions which have actually been consolidated. (Use reverse side of this form if necessary.) \_\_\_\_\_

No allowable will be assigned to the well until all interests have been consolidated (by communitization, unitization, forced-pooling, or otherwise) or until a non-standard unit, eliminating such interests, has been approved by the Commission.

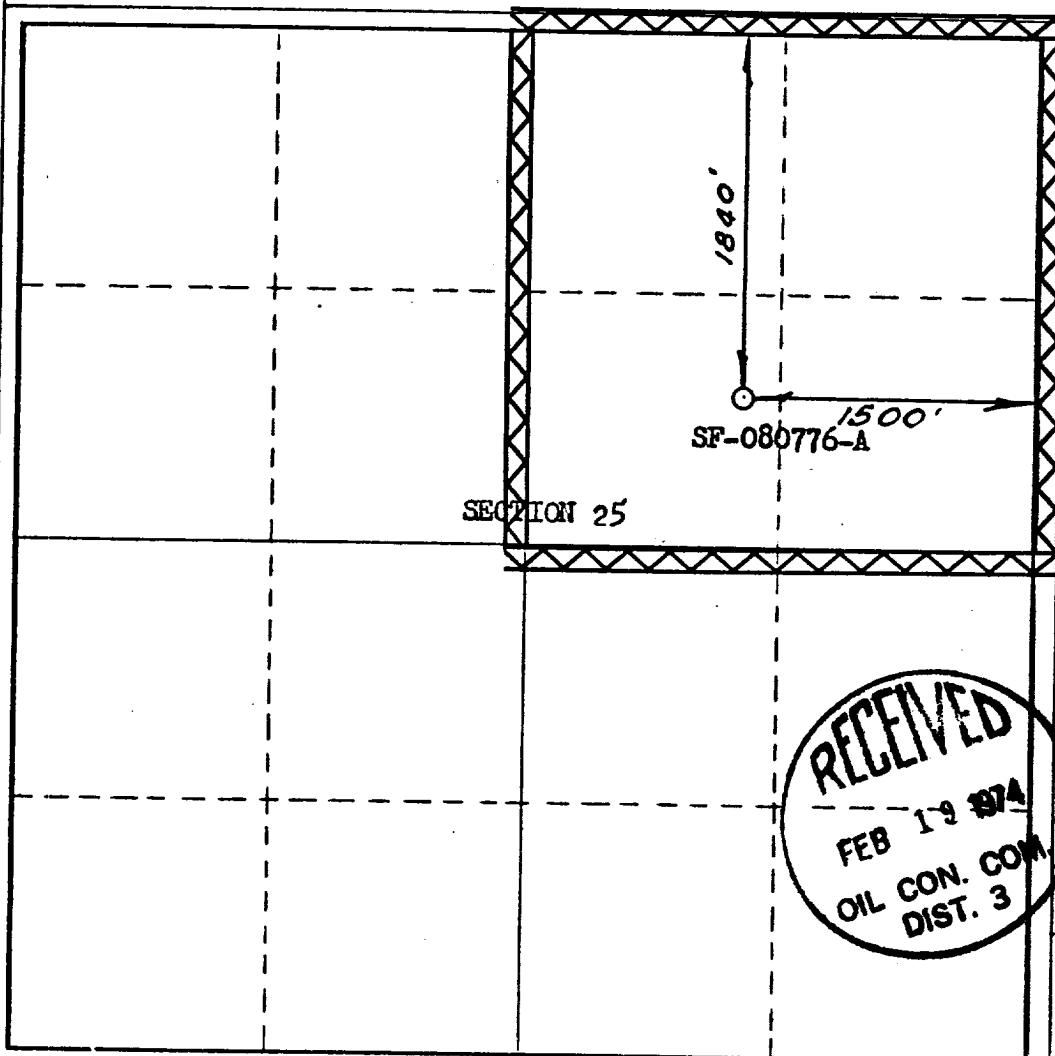

**CERTIFICATION**

I hereby certify that the information contained herein is true and complete to the best of my knowledge and belief.

**Original Signed by**

Name **D. G. Brisco**  
Position **Drilling Clerk**  
Company **El Paso Natural Gas Co.**  
Date **February 14, 1974**

I hereby certify that the well location shown on this plat was plotted from field notes of actual surveys made by me or under my supervision, and that the same is true and correct to the best of my knowledge and belief.

Date Surveyed  
**FEBRUARY 7, 1974**

Registered Professional Engineer and/or Land Surveyor

*[Signature]*  
Certificate No. **1760**

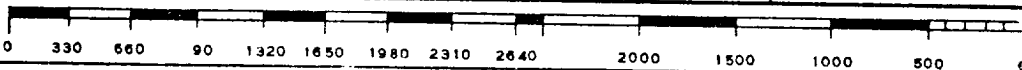
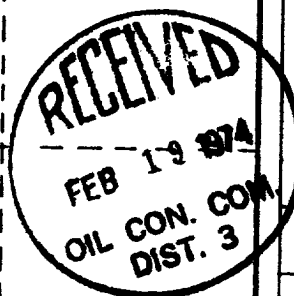

LOCATION AND EQUIPMENT LAY-OUT

FOOTAGE 1173

N

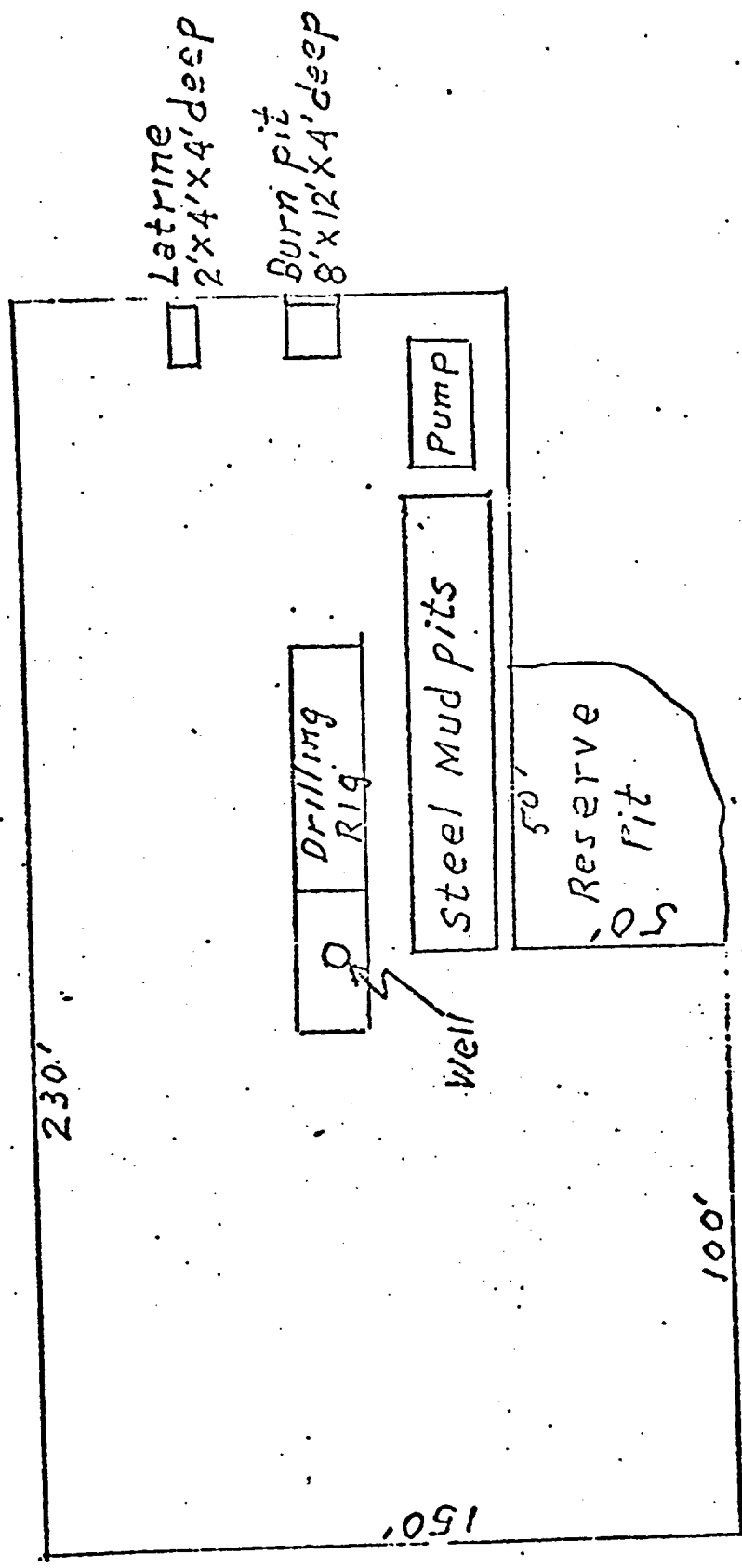

RECEIVED  
FEB 19 1974  
CAR. CON. COM.

Plot area A #3  
 L7N E/4 Sec 25, T-30-N, R-10-W

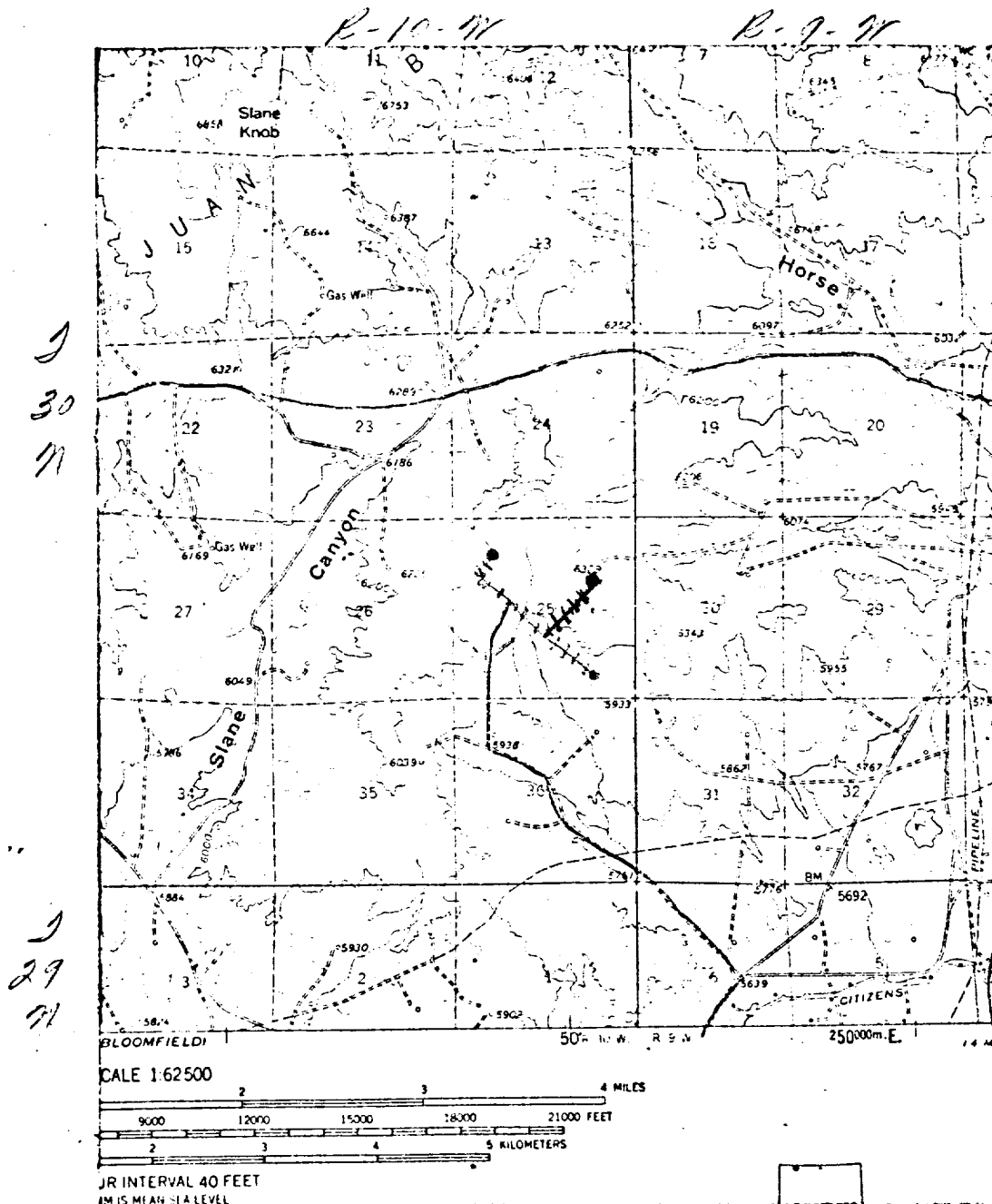

**RECEIVED**  
 FEB 19 1974  
 OIL CON. COM.  
 DIST. 3

**LEGEND OF RIGHT-OF-WAYS**

- EXISTING ROADS —————
- EXISTING PIPELINES — + — + — +
- EXISTING ROAD & PIPELINE — + — + — +
- PROPOSED ROADS —————
- PROPOSED PIPELINES — + + + +
- PROPOSED ROAD & PIPELINE — + — + — +