

|                        |   |
|------------------------|---|
| NO. OF COPIES RECEIVED |   |
| DISTRIBUTION           |   |
| SANTA FE               | 1 |
| FILE                   | 1 |
| U.S.G.S.               | 2 |
| LAND OFFICE            |   |
| OPERATOR               | 2 |

# NEW MEXICO OIL CONSERVATION COMMISSION

Form C-101  
Revised 1-1-65

30.045-21516

5A. Indicate Type of Lease

STATE ☐

FEE ☒

5. State Oil & Gas Lease No.

## APPLICATION FOR PERMIT TO DRILL, DEEPEN, OR PLUG BACK

|   |  |  |
|---|--|--|
| 1a. Type of Work<br>DRILL <input checked="" type="checkbox"/> DEEPEN <input type="checkbox"/> PLUG BACK <input type="checkbox"/>                |  | 7. Unit Agreement Name                           |
| b. Type of Well<br>OIL WELL <input type="checkbox"/> GAS WELL <input checked="" type="checkbox"/> OTHER <input type="checkbox"/>                |  | 8. Farm or Lease Name<br>Lawson                  |
| 2. Name of Operator<br>El Paso Natural Gas Company  |  | 9. Well No.<br>2                                 |
| 3. Address of Operator<br>PO Box 990, Farmington, NM 87401  |  | 10. Field and Pool, or Wildcat<br>Blanco PC Ext. |
| 4. Location of Well<br>UNIT LETTER B LOCATED 1050 FEET FROM THE North LINE<br>AND 1750 FEET FROM THE East LINE OF SEC. 25 TWP. 30N RGE. 9W NMPM |  | 12. County<br>San Juan                           |
| 19. Proposed Depth<br>2550'   |  | 19A. Formation<br>Pictured Cliffs                |
| 20. Rotary or C.T.<br>Rotary  |  |  |
| 21. Elevations (Show whether DF, RT, etc.)<br>5721' GL  | 21A. Kind & Status Plug. Bond<br>statewide | 21B. Drilling Contractor                         |
| 22. Approx. Date Work will start  |  |  |

23.

## PROPOSED CASING AND CEMENT PROGRAM

| SIZE OF HOLE | SIZE OF CASING | WEIGHT PER FOOT | SETTING DEPTH | SACKS OF CEMENT | EST. TOP     |
|--------------|----------------|-----------------|---------------|-----------------|--------------|
| 12 1/4"      | 8 5/8"         | 24.0#           | 120'          | 100 cu. ft.     | circulate    |
| 6 1/4"       | 2 7/8"         | 6.4#            | 2550'         | 323 cu. ft.     | to cover Ojo |
|              |                |                 |               |                 | Alamo        |

Selectively perforate and sandwater fracture the Pictured Cliffs formation.

The NE/4 of Section 25 is dedicated to this well.

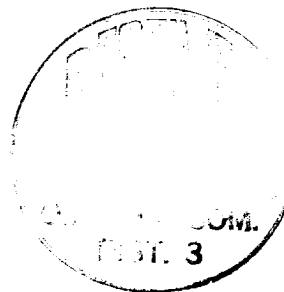

EXPIRES 8-29-74

IN ABOVE SPACE DESCRIBE PROPOSED PROGRAM: IF PROPOSAL IS TO DEEPEN OR PLUG BACK, GIVE DATA ON PRESENT PRODUCTIVE ZONE AND PROPOSED NEW PRODUCTIVE ZONE. GIVE BLOWOUT PREVENTER PROGRAM, IF ANY.

I hereby certify that the information above is true and complete to the best of my knowledge and belief.

Signed H. G. Duenes Title Drilling Clerk Date May 30, 1974

(This space for State Use)

APPROVED BY Ernest C. Cienfuegos TITLE SUPERVISOR DIST. #3 DATE 5-31-74

CONDITIONS OF APPROVAL, IF ANY:

NEW MEXICO OIL CONSERVATION COMMISSION  
WELL LOCATION AND ACREAGE DEDICATION PLAT

Form C-102  
Supersedes C-128  
Effective 1-1-65

All distances must be from the outer boundaries of the Section.

|  |   |                         |  |                           |  |                      |
|--|---|-------------------------|--|---------------------------|--|----------------------|
| Operator<br><b>EL PASO NATURAL GAS COMPANY</b>   |   | Lease<br><b>LAWSON</b>  |  | (FEE)                     |  | Well No.<br><b>2</b> |
| Unit Letter<br><b>B</b>  | Section<br><b>25</b>                          | Township<br><b>30-N</b> | Range<br><b>9-W</b>                        | County<br><b>SAN JUAN</b> |  |                      |
| Actual Footage Location of Well:<br><b>1050</b> feet from the <b>NORTH</b> line and <b>1750</b> feet from the <b>EAST</b> line |   |                         |  |                           |  |                      |
| Ground Level Elev.<br><b>5721</b>  | Producing Formation<br><b>PICTURED CLIFFS</b> |                         | Pool<br><b>BLANCO PICTURED CLIFFS EXT.</b> |                           | Dedicated Acreage<br><b>160.00</b> Acres |                      |

1. Outline the acreage dedicated to the subject well by colored pencil or hachure marks on the plat below.
2. If more than one lease is dedicated to the well, outline each and identify the ownership thereof (both as to working interest and royalty).
3. If more than one lease of different ownership is dedicated to the well, have the interests of all owners been consolidated by communitization, unitization, force-pooling, etc?

☒ Yes    ☐ No    If answer is "yes," type of consolidation **Communitization**

If answer is "no," list the owners and tract descriptions which have actually been consolidated. (Use reverse side of this form if necessary.) \_\_\_\_\_

No allowable will be assigned to the well until all interests have been consolidated (by communitization, unitization, forced-pooling, or otherwise) or until a non-standard unit, eliminating such interests, has been approved by the Commission.

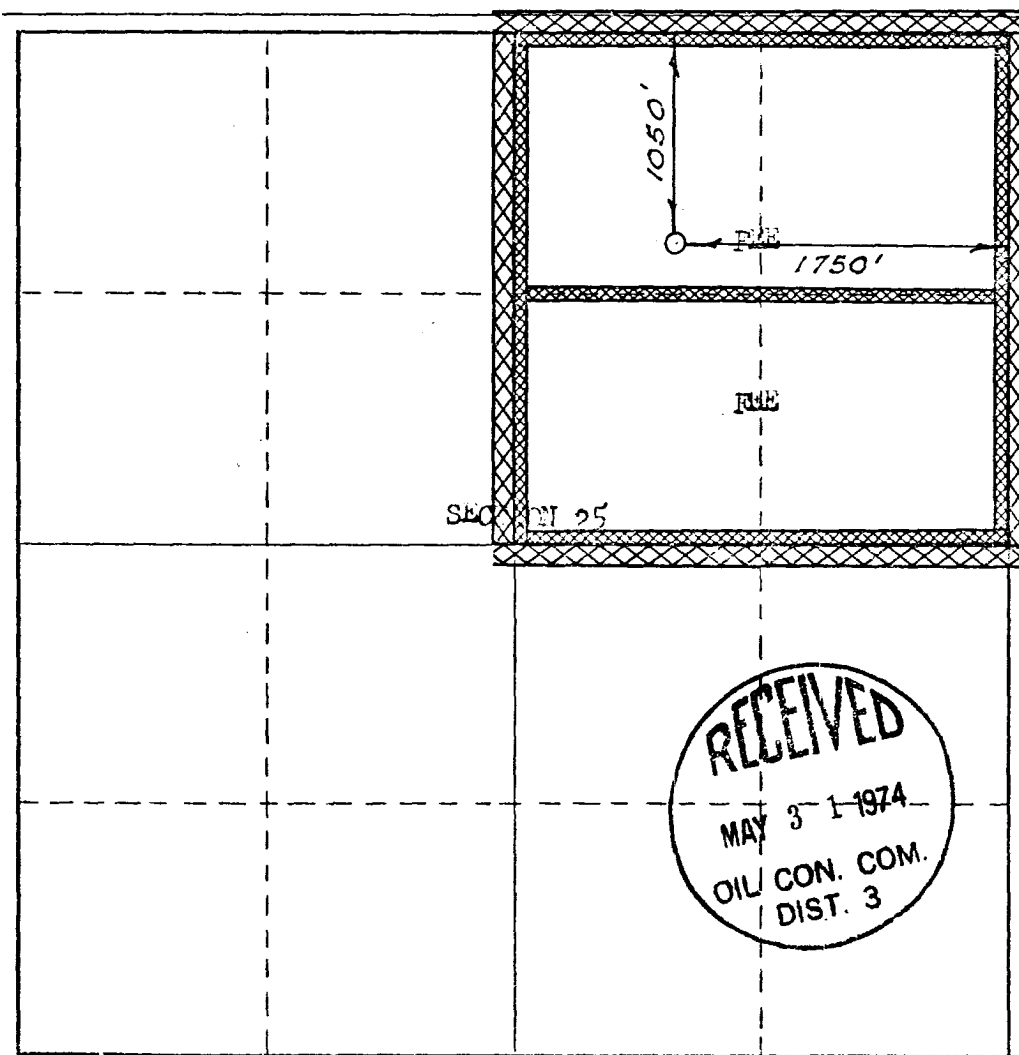

**CERTIFICATION**

*I hereby certify that the information contained herein is true and complete to the best of my knowledge and belief.*

**Original Signed by**

**D. G. Briscoe**

Name

**Drilling Clerk**

Position

**El Paso Natural Gas Co.**

Company

**May 30, 1974**

Date

*I hereby certify that the well location shown on this plat was plotted from field notes of actual surveys made by me or under my supervision, and that the same is true and correct to the best of my knowledge and belief.*

Date Surveyed

**FEBRUARY 13, 1973**

Registered Professional Engineer  
and/or Land Surveyor

*[Signature]*

Certificate No. **1760**

