

30-045-21615

UNITED STATES
DEPARTMENT OF THE INTERIOR
GEOLOGICAL SURVEY

APPLICATION FOR PERMIT TO DRILL, DEEPEN, OR PLUG BACK

1a. TYPE OF WORK DRILL <input checked="" type="checkbox"/> DEEPEN <input type="checkbox"/> PLUG BACK <input type="checkbox"/>			5. LEASE DESIGNATION AND SERIAL NO. 14-20-0603-639	
b. TYPE OF WELL OIL WELL <input checked="" type="checkbox"/> GAS WELL <input type="checkbox"/> OTHER <input type="checkbox"/> SINGLE ZONE <input type="checkbox"/> MULTIPLE ZONE <input type="checkbox"/>			6. IF INDIAN, ALLOTTEE OR TRIBE NAME Navajo	
2. NAME OF OPERATOR R. A. CRANE, JR.			7. UNIT AGREEMENT NAME	
3. ADDRESS OF OPERATOR 2802 E. 20th Farmington, New Mexico			8. FARM OR LEASE NAME King Kong	
4. LOCATION OF WELL (Report location clearly and in accordance with any State requirements.)* At surface At proposed prod. zone 2170' FNL and 2460' FWL			9. WELL NO. 12	
14. DISTANCE IN MILES AND DIRECTION FROM NEAREST TOWN OR POST OFFICE* four miles N. E. Shiprock, New Mexico			10. FIELD AND POOL, OR WILDCAT Salt Creek Dakota	
15. DISTANCE FROM PROPOSED* LOCATION TO NEAREST PROPERTY OR LEASE LINE, FT. (Also to nearest drlg. unit line, if any) 2170' FNL			11. SEC., T., R., M., OR BLK. AND SURVEY OR AREA 4- 30N-17	
16. NO. OF ACRES IN LEASE 640			12. COUNTY OR PARISH San Juan	
17. NO. OF ACRES ASSIGNED TO THIS WELL 40			13. STATE New Mex.	
18. DISTANCE FROM PROPOSED LOCATION* TO NEAREST WELL, DRILLING, COMPLETED, OR APPLIED FOR, ON THIS LEASE, FT. 560'			20. ROTARY OR CABLE TOOLS Rotary	
21. ELEVATIONS (Show whether DF, RT, GR, etc.) 5083' GR			22. APPROX. DATE WORK WILL START* 10/10/74	

PROPOSED CASING AND CEMENTING PROGRAM

SIZE OF HOLE	SIZE OF CASING	WEIGHT PER FOOT	SETTING DEPTH	QUANTITY OF CEMENT
7 7/8	5 1/2	14 lb.	30'	5 Sacks
4 3/4	2 7/8	6.5 lb.	4,045'	25 Sacks

Plan to air drill 4 3/4 inch hole to test the Dakota formation.

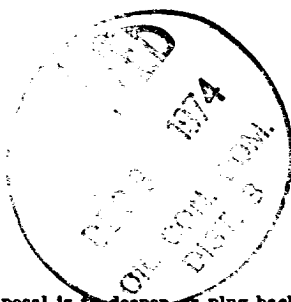
DEC 6 1974
U. S. GEOLOGICAL SURVEY
WASHINGTON, D. C.

IN ABOVE SPACE DESCRIBE PROPOSED PROGRAM: If proposal is to deepen or plug back, give data on present productive zone and proposed new productive zone. If proposal is to drill or deepen directionally, give pertinent data on subsurface locations and measured and true vertical depths. Give blowout preventer program, if any.

24. SIGNED GARY S. BRINK TITLE Accountant DATE 12/5/74

(This space for Federal or State office use)

PERMIT NO. _____ APPROVAL DATE _____

APPROVED BY _____ TITLE _____ DATE _____
CONDITIONS OF APPROVAL, IF ANY:

NEW MEXICO OIL CONSERVATION COMMISSION
WELL LOCATION AND ACREAGE DEDICATION PLAT

Form C-102
Supersedes C-128
Effective 1-1-65

All distances must be from the outer boundaries of the Section.

Operator Granada R.A. Crane Jr.			Lease KK		Well No. 12
Unit Letter F	Section 4	Township 30 North	Range 17 West	County San Juan	
Actual Footage Location of Well: 2170 feet from the North line and 2460 feet from the West line					
Ground Level Elev. 5083	Producing Formation Del Norte	Pool Full Creek	Dedicated Acreage: 40		Acres

1. Outline the acreage dedicated to the subject well by colored pencil or hachure marks on the plat below.
2. If more than one lease is dedicated to the well, outline each and identify the ownership thereof (both as to working interest and royalty).
3. If more than one lease of different ownership is dedicated to the well, have the interests of all owners been consolidated by communitization, unitization, force-pooling, etc?

☐ Yes ☐ No If answer is "yes," type of consolidation _____

If answer is "no," list the owners and tract descriptions which have actually been consolidated. (Use reverse side of this form if necessary.) _____

No allowable will be assigned to the well until all interests have been consolidated (by communitization, unitization, forced-pooling, or otherwise) or until a non-standard unit, eliminating such interests, has been approved by the Commission.

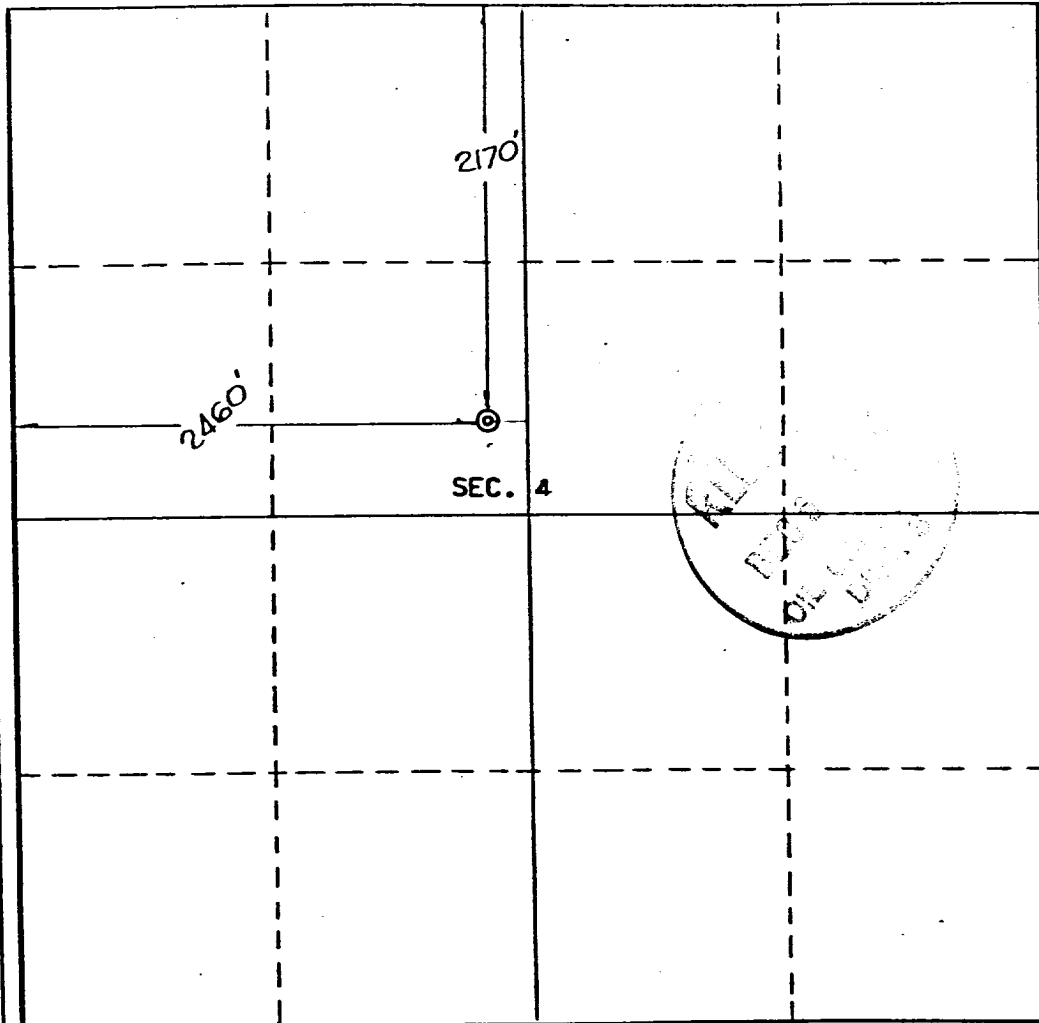

CERTIFICATION

I hereby certify that the information contained herein is true and complete to the best of my knowledge and belief.

Sandra M. Anderson
Name

Secretary
Position

R. A. Crane Jr.
Company

10-5-74
Date

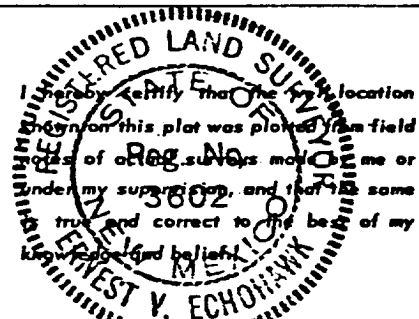

Date Surveyed
October 5, 1974
Registered Professional Engineer
and/or Land Surveyor

E.V. Echolaw
Certificate No. **3802**
E.V. Echolaw LS

0 330 660 990 1320 1650 1980 2310 2640 2000 1500 1000 500 0

SURFACE ENVIRONMENT RELATIVE TO DRILLING SITE

17

18

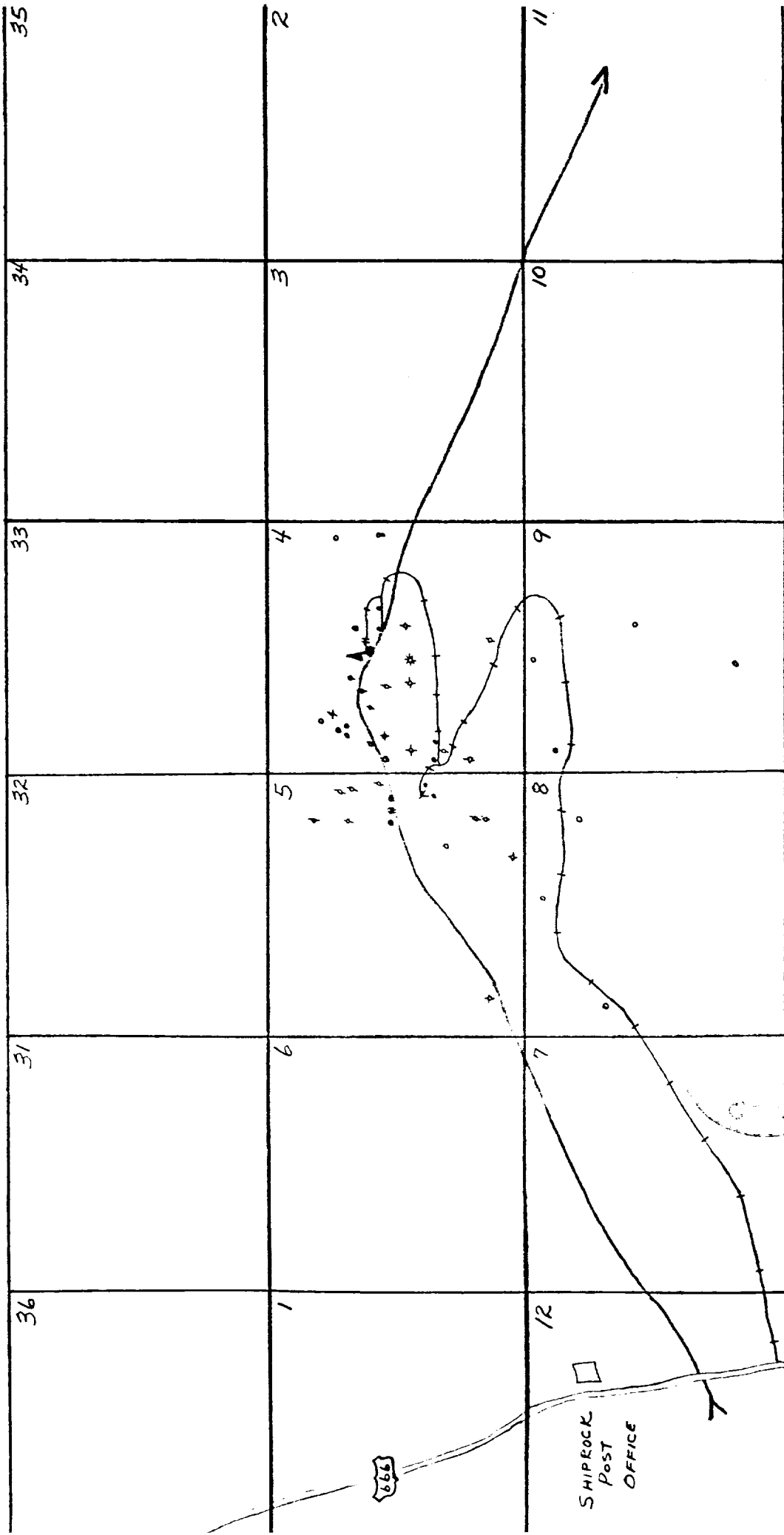

MAIN HWY.

REFERENCE POINT

--- EXISTING ACCESS ROAD

--- PLANNED ACCESS ROAD

• DRILLING LOCATION

→ DIRECTION

December 5, 1974

Mr. Robert A. Crane, Jr.
2802 E. 20th
Farmington, New Mexico 87401

Dear Sirs:

Drilling site for Well No. King Kong No. 12 (location 4-30N-17W, 2170 FNL and 2460 FWL) shall have all disposable wastes removed from location. Other types of waste material shall be properly buried near the drilling location.

Planned restoration of the surface will include leveling and reseeding. The drilling pad will be surfaced.

The Field Representative responsible for compliance of the development plan for service use is Jim Yeomans, General Delivery, Mancos, Colorado. Please refer to Farmington phone number 327-1313 for additional information.

Very truly yours,

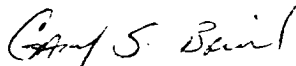

Gary S. Brink

GSB:da

