

30-045-21662

UNITED STATES
DEPARTMENT OF THE INTERIOR
GEOLOGICAL SURVEY

APPLICATION FOR PERMIT TO DRILL, DEEPEN, OR PLUG BACK

1a. TYPE OF WORK DRILL ☒ DEEPEN ☐ PLUG BACK ☐b. TYPE OF WELL
OIL WELL ☐ GAS WELL ☒ OTHER ☐ SINGLE ZONE ☒ MULTIPLE ZONE ☐2. NAME OF OPERATOR
El Paso Natural Gas Company3. ADDRESS OF OPERATOR
PO Box 990, Farmington, NM 874014. LOCATION OF WELL (Report location clearly and in accordance with any State requirements.*)
At surface 1140'N, 1040'E

At proposed prod. zone

14. DISTANCE IN MILES AND DIRECTION FROM NEAREST TOWN OR POST OFFICE*

15. DISTANCE FROM PROPOSED*
LOCATION TO NEAREST
PROPERTY OR LEASE LINE, FT.
(Also to nearest drlg. unit line, if any)

16. NO. OF ACRES IN LEASE

17. NO. OF ACRES ASSIGNED
TO THIS WELL
320.0018. DISTANCE FROM PROPOSED LOCATION*
TO NEAREST WELL, DRILLING, COMPLETED,
OR APPLIED FOR, ON THIS LEASE, FT.

19. PROPOSED DEPTH

5610'

20. ROTARY OR CABLE TOOLS

Rotary

21. ELEVATIONS (Show whether DF, RT, GR, etc.)

6310'GL

23. PROPOSED CASING AND CEMENTING PROGRAM

SIZE OF HOLE	SIZE OF CASING	WEIGHT PER FOOT	SETTING DEPTH	QUANTITY OF CEMENT
13 3/4"	9 5/8"	32.3#	200'	225 cu. ft. to circulate
8 3/4"	7"	20.0#	3300'	347 cu. ft. to cover Ojo Alamo
6 1/4"	4 1/2"	10.5#	3150-5610'	429 cu. ft. to circulate liner

Selectively perforate and sandwater fracture the Mesa Verde formation.

The N/2 of Section 17 is dedicated to this well.

JAN 9 1975

IN ABOVE SPACE DESCRIBE PROPOSED PROGRAM: If proposal is to deepen or plug back, give data on present productive zone and proposed new productive zone. If proposal is to drill or deepen directionally, give pertinent data on subsurface locations and measured and true vertical depths. Give blowout preventer program, if any.

24.

SIGNED

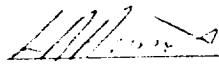

TITLE

Drilling Engineer

DATE January 9, 1975

(This space for Federal or State office use)

PERMIT NO.

APPROVAL DATE

APPROVED BY



TITLE

DATE

CONDITIONS OF APPROVAL, IF ANY:

*See Instructions On Reverse Side

**NEW MEXICO OIL CONSERVATION COMMISSION
WELL LOCATION AND ACREAGE DEDICATION PLAT**

Form C-132
Supersedes C-128
Effective 1-1-65

All distances must be from the outer boundaries of the Section.

Operator EL PASO NATURAL GAS COMPANY		Lease PIERCE (SF-078129)		Well No. 1A
Unit Letter A	Section 17	Township 30 NORTH	Range 9 WEST	County SAN JUAN
Actual Footage Location of Well: <div style="display: flex; justify-content: space-between;"> 1140 feet from the NORTH line and 1040 feet from the EAST line </div>				
Ground Level Elev. 6310.0	Producing Formation MESA VERDE	Pool BLANCO MESA VERDE	Dedicated Acreage: 320.00 Acres	

1. Outline the acreage dedicated to the subject well by colored pencil or hatchure marks on the plat below.
2. If more than one lease is dedicated to the well, outline each and identify the ownership thereof (both as to working interest and royalty).
3. If more than one lease of different ownership is dedicated to the well, have the interests of all owners been consolidated by communitization, unitization, force-pooling, etc?

☐ Yes ☐ No If answer is "yes," type of consolidation _____

If answer is "no," list the owners and tract descriptions which have actually been consolidated. (Use reverse side of this form if necessary.) _____

No allowable will be assigned to the well until all interests have been consolidated (by communitization, unitization, forced-pooling, or otherwise) or until a non-standard unit, eliminating such interests, has been approved by the Commission.

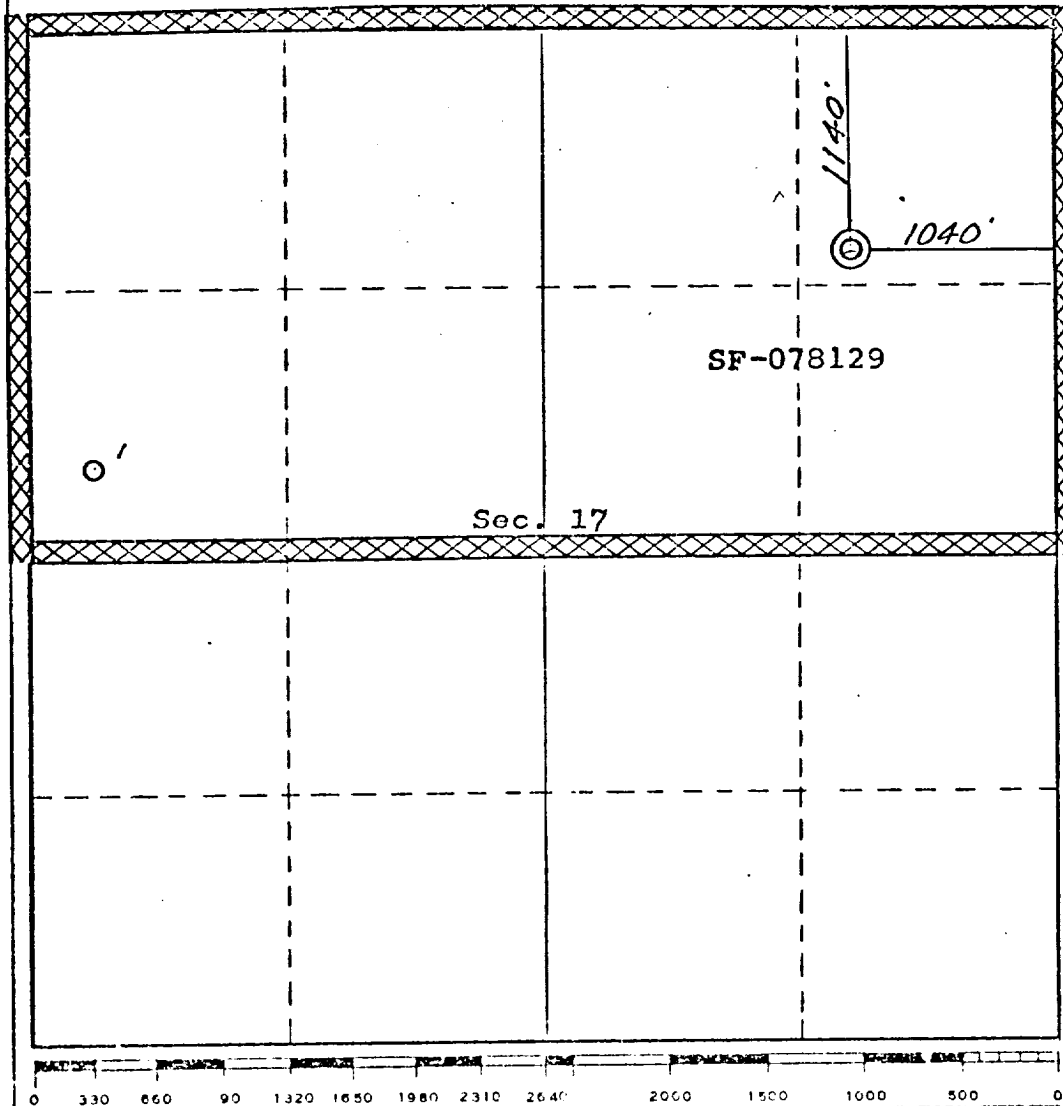

CERTIFICATION

I hereby certify that the information contained herein is true and complete to the best of my knowledge and belief.

[Signature]

Name

Drilling Engineer

Position

El Paso Natural Gas Co.

Company

January 9, 1975

Date

I hereby certify that the well location shown on this plat was plotted from field notes of actual surveys made by me or under my supervision, and that the same is true and correct to the best of my knowledge and belief.

18 December, 1974

Date Surveyed

JAMES P. LEESE

Registered Professional Engineer

[Signature]

1463

Certificate No.

PIERCE No 1A

N

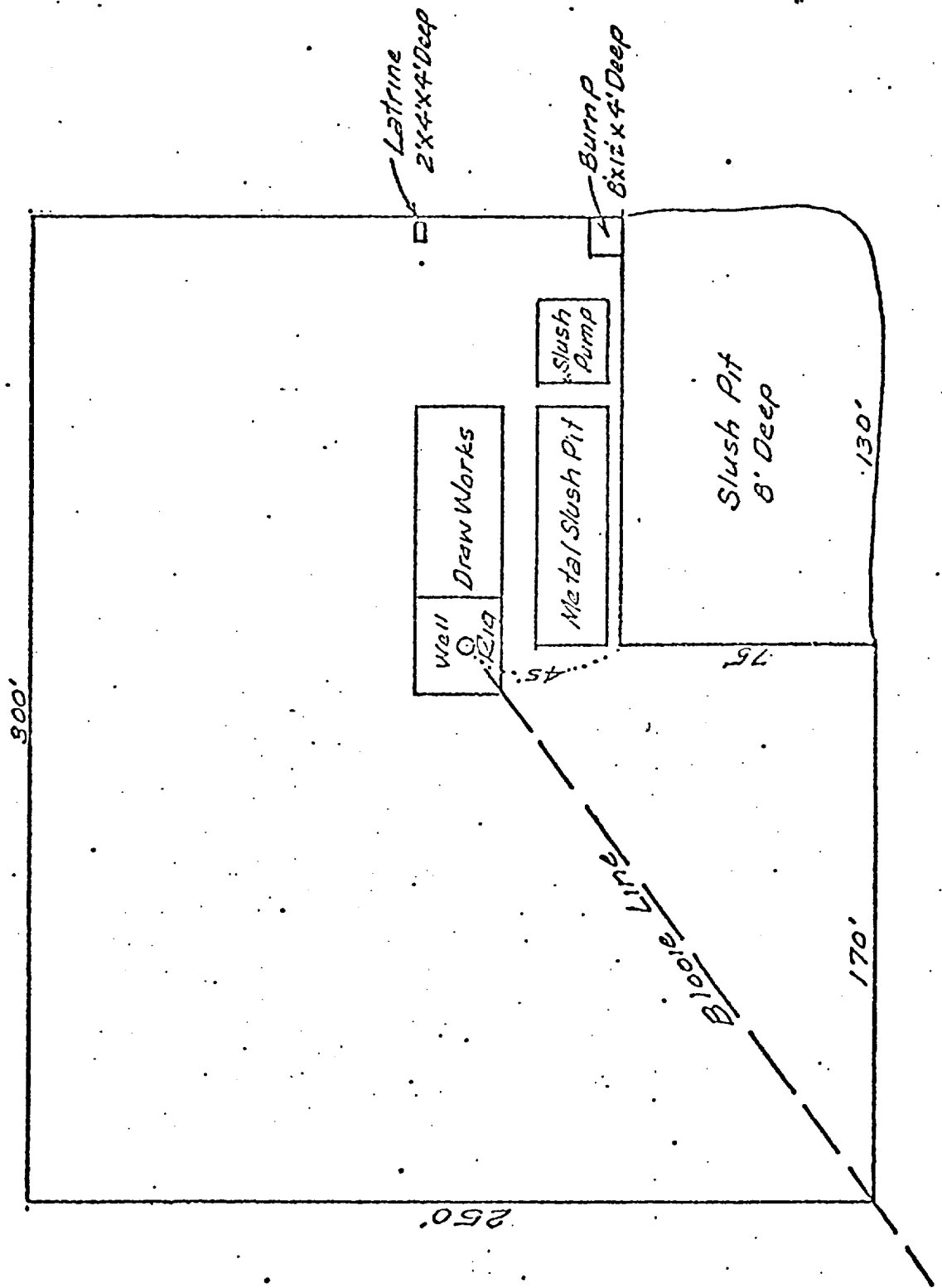

Pierce No 1 A
NE/4 Sec 17, T-30-N, R-9-W

T
30
N

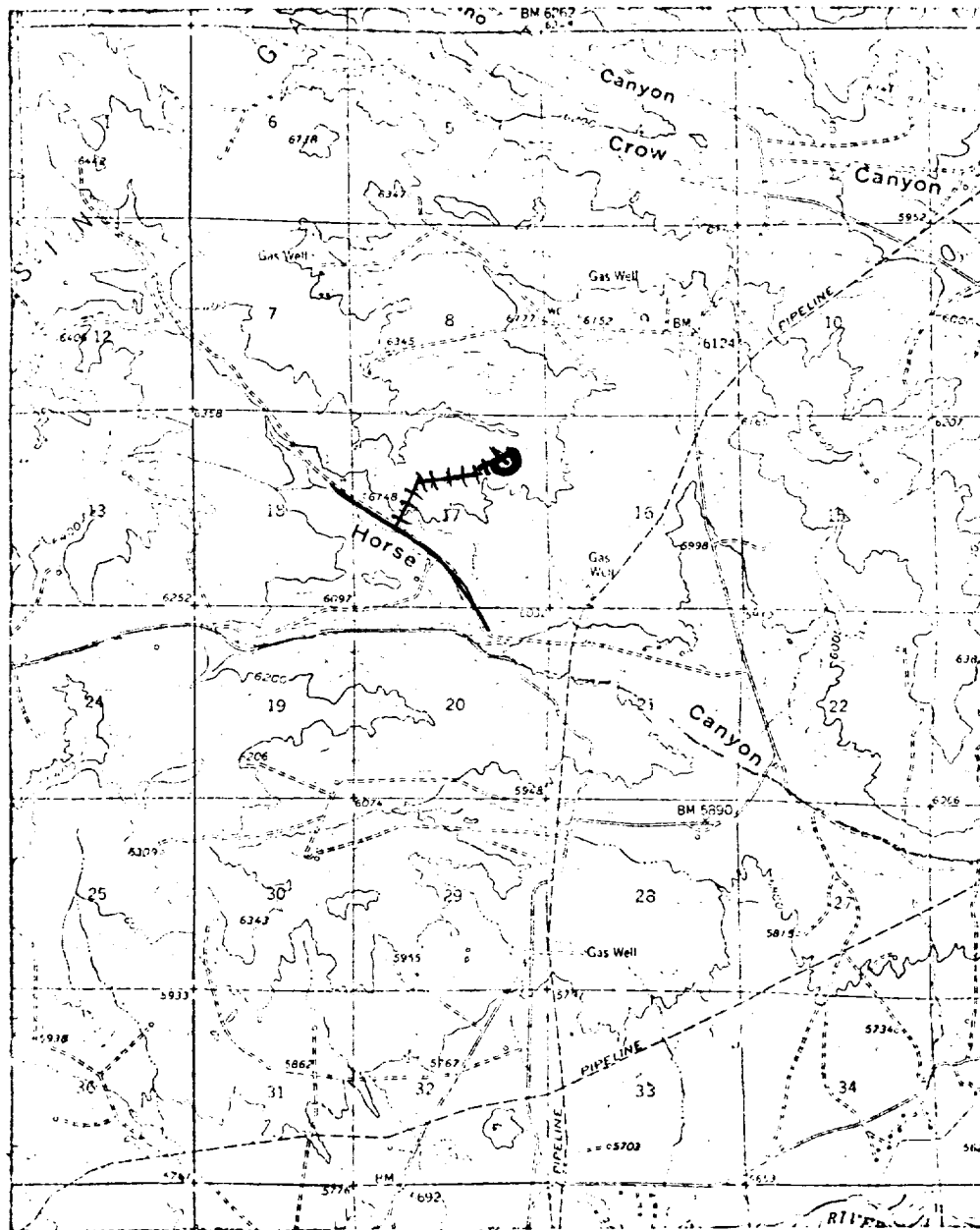

R-10-W

R-9-W

LEGEND OF RIGHT-OF-WAYS

EXISTING ROADS	—————
EXISTING PIPELINES	—+—+—+—
EXISTING ROAD & PIPELINE	—+—+—+—
PROPOSED ROADS	—————
PROPOSED PIPELINES	—+—+—+—
PROPOSED ROAD & PIPELINE	—+—+—+—

El Paso Natural Gas Company

El Paso, Texas 79978

January 9, 1975



ADDRESS REPLY TO
POST OFFICE BOX 959
FARMINGTON NEW MEXICO 87401

Mr. P. T. McGrath
U. S. Geological Survey
Post Office Box 959
Farmington, New Mexico 87401

JAN 9 1975

Re: Application for Permit to Drill
Pierce #1A
NE/4 Section 17, T-30-N, R-9-W
Blanco Mesa Verde

Dear Mr. McGrath:

Details regarding existing roads, pipelines, wells, etc. relative to the above well location are included on the previously submitted base maps, "Field Road Map" and "Composite Map No. 1".

The proposed new well location, new roads and new pipeline are shown on the attached plat along with connecting existing roads and pipelines in the vicinity of the proposed new well.

Water for drilling and completion operations will be obtained from the following location: Knickerbocker Butte Water Well #1, NESE 23-30-10.

Waste material will be disposed of by burial in the burn pit, latrine, or reserve pit as applicable. There will be no camp nor air strip associated with drilling this well. Upon completion or abandonment of this well, the location will be cleaned and leveled and a dry hole marker placed, if applicable.

Yours very truly,

A handwritten signature in cursive script that reads "D. G. Brisco".

D. G. Brisco
Drilling Clerk

pb