

UNITED STATES  
DEPARTMENT OF THE INTERIOR  
GEOLOGICAL SURVEY

30-045-21687

## APPLICATION FOR PERMIT TO DRILL, DEEPEN, OR PLUG BACK

1a. TYPE OF WORK DRILL <input checked="" type="checkbox"/> DEEPEN <input type="checkbox"/> PLUG BACK <input type="checkbox"/>		5. LEASE DESIGNATION AND SERIAL NO. 14 20 0603 742
b. TYPE OF WELL OIL WELL <input checked="" type="checkbox"/> GAS WELL <input type="checkbox"/> OTHER <input type="checkbox"/> SINGLE ZONE <input type="checkbox"/> MULTIPLE ZONE <input type="checkbox"/>		6. IF INDIAN, ALLOTTEE OR TRIBE NAME Navajo
2. NAME OF OPERATOR Rijan Oil Company, Inc.		7. UNIT AGREEMENT NAME None
3. ADDRESS OF OPERATOR 900 Bank of New Mexico Building, Albuquerque, New Mexico 87102		8. FARM OR LEASE NAME Rijan
4. LOCATION OF WELL (Report location clearly and in accordance with any State requirements.) At surface 2145' fml, 990' fwl At proposed prod. zone 2145' fml, 990' fwl		9. WELL NO. 18
14. DISTANCE IN MILES AND DIRECTION FROM NEAREST TOWN OR POST OFFICE* 7 miles east of Shiprock, New Mexico		10. FIELD AND POOL, OR WILDCAT Slick Rock Dakota Pool
15. DISTANCE FROM PROPOSED* LOCATION TO NEAREST PROPERTY OR LEASE LINE, FT. (Also to nearest drilg. unit line, if any) 990'	16. NO. OF ACRES IN LEASE 640	11. SEC., T., E., M., OR BLK. AND SURVEY OR AREA Sec 31, T30N, R16W, NMPM
18. DISTANCE FROM PROPOSED LOCATION* TO NEAREST WELL, DRILLING, COMPLETED, OR APPLIED FOR, ON THIS LEASE, FT. 250'	19. PROPOSED DEPTH 950'	12. COUNTY OR PARISH San Juan
21. ELEVATIONS (Show whether DF, RT, GR, etc.) 5109' GR		13. STATE New Mexico
22. APPROX. DATE WORK WILL START* February 1, 1975		

## 23. PROPOSED CASING AND CEMENTING PROGRAM

SIZE OF HOLE	SIZE OF CASING	WEIGHT PER FOOT	SETTING DEPTH	QUANTITY OF CEMENT
9-5/8"	7-5/8"	17.5#	20'	10 sx
6-1/4"	4-1/2"	9#	950'	50 sx, circulated

Plan to drill with rotary tools to approximately 950' in depth to the top of the Dakota formation. If production is obtained, plan to complete by setting 4 1/2" casing in the top of the Dakota formation. Location is not in known high pressure area. Will drill in with control head after setting 4 1/2" casing.

JAN 16 1975

IN ABOVE SPACE DESCRIBE PROPOSED PROGRAM: If proposal is to deepen or plug back, give data on present productive zone and proposed new productive zone. If proposal is to drill or deepen directionally, give pertinent data on subsurface locations and measured and true vertical depths. Give blowout preventer program, if any.

24. SIGNED V. P. R. R. TITLE Consulting Geologist DATE 1-13-75

(This space for Federal or State office use)

PERMIT NO. 27 APPROVAL DATE JAN 16 1975

APPROVED BY CE TITLE U. S. GEOLOGICAL SURVEY DATE JAN 16 1975

CONDITIONS OF APPROVAL, IF ANY:

\*See Instructions On Reverse Side

## Instructions

**General:** This form is designed for submitting proposals to perform certain well operations, as indicated, on all types of lands and leases for appropriate action by either a Federal or a State agency, or both, pursuant to applicable Federal and/or State laws and regulations. Any necessary special instructions concerning the use of this form and the number of copies to be submitted, particularly with regard to local, area, or regional procedures and practices, either are shown below or will be issued by, or may be obtained from, the local Federal and/or State office.

**Item 1:** If the proposal is to redrill to the same reservoir at a different subsurface location or to a new reservoir, use this form with appropriate notations. Consult applicable State or Federal regulations concerning subsequent work proposals or reports on the well.

**Item 4:** If there are no applicable State requirements, locations on Federal or Indian land should be described in accordance with Federal requirements. Consult local State or Federal office for specific instructions.

**Item 14:** Needed only when location of well cannot readily be found by road from the land or lease description. A plat, or plats, separate or on this reverse side, showing the roads to, and the surveyed location of, the well, and any other required information, should be furnished when required by Federal or State agency offices.

**Items 15 and 18:** If well is to be, or has been directionally drilled, give distances for subsurface location of hole in any present or objective production zone.

**Item 22:** Consult applicable Federal or State regulations, or appropriate officials, concerning approval of the proposal before operations are started.

NEW MEXICO OIL CONSERVATION COMMISSION  
WELL LOCATION AND ACREAGE DEDICATION PLAT

Form C-102  
Supersedes C-128  
Effective 1-1-65

All distances must be from the outer boundaries of the Section.

Operator <b>Rijan Oil Company</b>			Lease <b><del>Nevada Tract 11-20-0603-742</del></b>		Well No. <b>18</b>
Unit Letter <b>E</b>	Section <b>31</b>	Township <b>30 North</b>	Range <b>16 West</b>	County <b>San Juan</b>	
Actual Footage Location of Well: <b>2145</b> feet from the <b>North</b> line and <b>990</b> feet from the <b>West</b> line					
Ground Level Elev. <b>5109</b>	Producing Formation <b>Dakota</b>		Pool <b>Slick Rock</b>	Dedicated Acreage: <b>40</b> Acres	

1. Outline the acreage dedicated to the subject well by colored pencil or hachure marks on the plat below.
2. If more than one lease is dedicated to the well, outline each and identify the ownership thereof (both as to working interest and royalty).  
**NO LEASE ONLY**
3. If more than one lease of different ownership is dedicated to the well, have the interests of all owners been consolidated by communitization, unitization, force-pooling, etc?  
**ONE LEASE ONLY**

☐ Yes ☐ No If answer is "yes," type of consolidation \_\_\_\_\_

If answer is "no," list the owners and tract descriptions which have actually been consolidated. (Use reverse side of this form if necessary.) \_\_\_\_\_

No allowable will be assigned to the well until all interests have been consolidated (by communitization, unitization, forced-pooling, or otherwise) or until a non-standard unit, eliminating such interests, has been approved by the Commission.

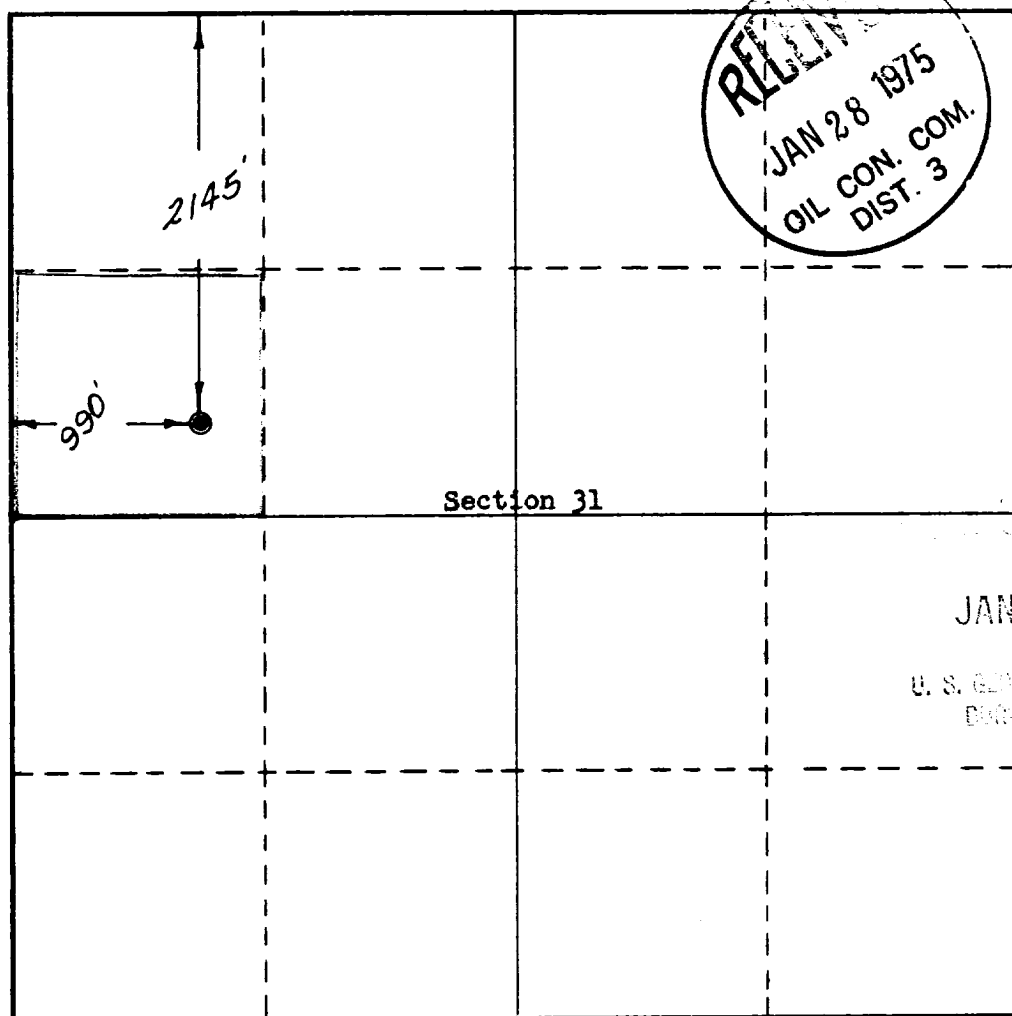

CERTIFICATION

I hereby certify that the information contained herein is true and complete to the best of my knowledge and belief.

*Val R. Rees*

Name  
**Val R. Rees**

Position  
**Consulting Geologist**

Company  
**Rijan Oil Company, Inc.**

Date  
**January 13, 1975**

I hereby certify that the well location shown on this plat was plotted from field notes of actual surveys made by me or under my supervision, and that the same is true and correct to the best of my knowledge and belief.

Date Surveyed  
**January 4, 1975**

Registered Professional Engineer and  
**Land Surveyor**

Certificate No. **308**

