

UNITED STATES
DEPARTMENT OF THE INTERIOR
GEOLOGICAL SURVEY

APPLICATION FOR PERMIT TO DRILL, DEEPEN, OR PLUG BACK

1a. TYPE OF WORK

DRILL ☒DEEPEN ☐PLUG BACK ☐

b. TYPE OF WELL

OIL
WELL ☒GAS
WELL ☐

OTHER

SINGLE
ZONE ☐MULTIPLE
ZONE ☐

2. NAME OF OPERATOR

R. A. Crane, Jr.

3. ADDRESS OF OPERATOR

2802 E. 20th Farmington, New Mexico 87401

4. LOCATION OF WELL (Report location clearly and in accordance with any State requirements.*)

At surface

2110' FNL 1980' FEL

At proposed prod. zone

14. DISTANCE IN MILES AND DIRECTION FROM NEAREST TOWN OR POST OFFICE*

FOUR MILES Northeast of SHIPROCK, NEW MEXICO

15. DISTANCE FROM PROPOSED*

LOCATION TO NEAREST
PROPERTY OR LEASE LINE, FT.
(Also to nearest grid. unit line, if any)

1980'

16. NO. OF ACRES IN LEASE

640 acres

18. DISTANCE FROM PROPOSED LOCATION*

TO NEAREST WELL, DRILLING, COMPLETED,
OR APPLIED FOR, ON THIS LEASE, FT.

200'

19. PROPOSED DEPTH

1050'

17. NO. OF ACRES ASSIGNED
TO THIS WELL

40 acres

20. ROTARY OR CABLE TOOLS

Rotary

21. ELEVATIONS (Show whether DF, RT, GR, etc.)

5102' GR.

22. APPROX. DATE WORK WILL START*

7/2/75

23.

PROPOSED CASING AND CEMENTING PROGRAM

SIZE OF HOLE	SIZE OF CASING	WEIGHT PER FOOT	SETTING	QUANTITY OF CEMENT
7 7/8"	5 1/2"	14#	30'	5 sacks
4 3/4"	2 7/8"	6.5#	17'	20 sacks

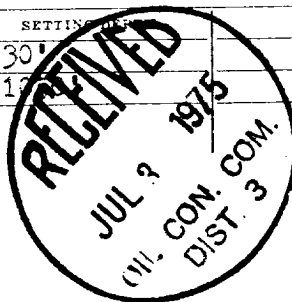

Plan to air drill 4 3/4" hole to test the Dakota formation.

RECEIVED

JUL 2 1975

U. S. GEOLOGICAL SURVEY
FARMINGTON, N. M.

IN ABOVE SPACE DESCRIBE PROPOSED PROGRAM: If proposal is to deepen or plug back, give data on present productive zone and proposed new productive zone. If proposal is to drill or deepen directionally, give pertinent data on subsurface locations and measured and true vertical depths. Give blowout prevention program, if any.

24.

SIGNED

Suzanne M. Anderson
Suzanne M. Anderson

TITLE

Secretary

DATE

6/30/75

(This space for Federal or State office use)

PERMIT NO.

APPROVAL DATE

APPROVED BY

TITLE

DATE

CONDITIONS OF APPROVAL, IF ANY:

**NEW MEXICO OIL CONSERVATION COMMISSION
WELL LOCATION AND ACREAGE DEDICATION PLAT**

Form O-101
Supersedes O-108
Effective 1-1-81

All distances must be from the outer boundaries of the Section.

Owner Craneeco			Lease King Kong Lease #14-20-0603-639			Well No. 14		
Plot Letter G	Section 4	Township 30 North	Range 17 West	County San Juan				
Approx. Feature Location of Well: 2110 feet from the North line and 1980 feet from the East line								
Ground Level Elev. 5102	Producing Formation Dakota		Pool Salt Creek			Dedicated Acreage: 40 Acres		

1. Outline the acreage dedicated to the subject well by colored pencil or hatchure marks on the plat below.
2. If more than one lease is dedicated to the well, outline each and identify the ownership thereof (both as to working interest and royalty).
3. If more than one lease of different ownership is dedicated to the well, have the interests of all owners been consolidated by communization, unitization, force-pooling, etc?

☐ Yes ☐ No If answer is "yes:" type of consolidation _____

If answer is "no:" list the owners and tract descriptions which have actually been consolidated. (Use reverse side of this form if necessary.) _____

No allowable will be assigned to the well until all interests have been consolidated (by communization, unitization, force-pooling, or otherwise) or until a non-standard unit, eliminating such interests, has been approved by the Commission.

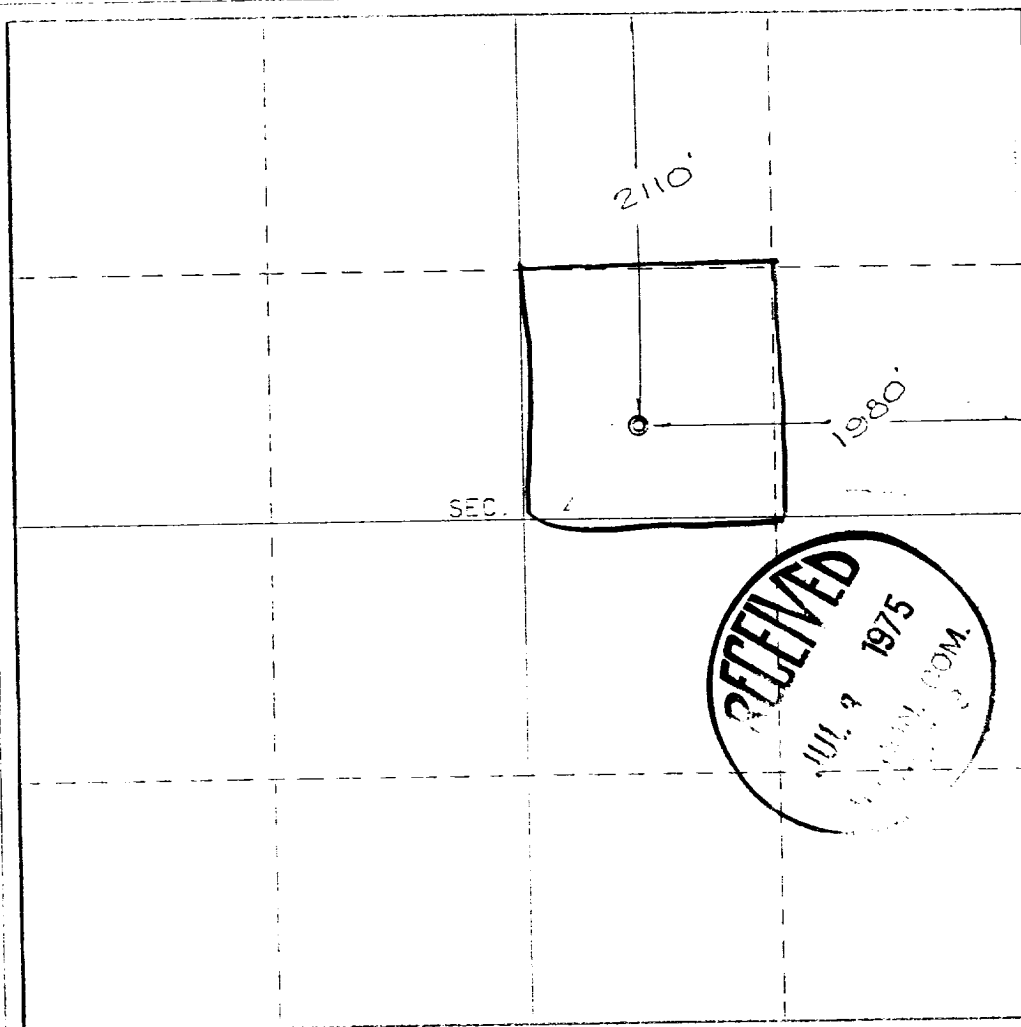

CERTIFICATION

I hereby certify that the information contained herein is true and complete to the best of my knowledge and belief.

Serena M. Anderson

Name

Serena M. Anderson

Position

Secretary

Company

Craneeco (R.A. Crane, Jr.)

Date

6/30/75

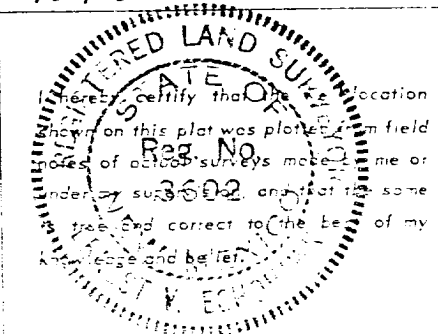

Date Surveyed

June 26, 1975

Registered Professional Engineer
and or Land Surveyor

E.V. Echotauk

Certificate No. **504**
E.V. Echotauk LS

0 500 1000 1500 2000 2500 3000 3500 4000 4500 5000 5500 6000 6500 7000 7500 8000 8500 9000 9500 10000