

UNITED STATES
DEPARTMENT OF THE INTERIOR
GEOLOGICAL SURVEY

APPLICATION FOR PERMIT TO DRILL, DEEPEN, OR PLUG BACK

1a. TYPE OF WORK DRILL <input checked="" type="checkbox"/> DEEPEN <input type="checkbox"/> PLUG BACK <input type="checkbox"/>		5. LEASE DESIGNATION AND SERIAL NO. 14-20-0603-639
b. TYPE OF WELL OIL WELL <input checked="" type="checkbox"/> GAS WELL <input type="checkbox"/> OTHER <input type="checkbox"/> SINGLE ZONE <input type="checkbox"/> MULTIPLE ZONE <input type="checkbox"/>		6. IF INDIAN, ALLOTTEE OR TRIBE NAME Navajo
2. NAME OF OPERATOR R. A. Crane, Jr.		7. UNIT AGREEMENT NAME
3. ADDRESS OF OPERATOR 2802 E. 20th Farmington, New Mexico 87401		8. FARM OR LEASE NAME King Kong
4. LOCATION OF WELL (Report location clearly and in accordance with any State requirements.*) At surface 2310 FNL 1580 FEL At proposed prod. zone		9. WELL NO. King Kong #17
14. DISTANCE IN MILES AND DIRECTION FROM NEAREST TOWN OR POST OFFICE* 4 miles Northeast of Shiprock, New Mexico		10. FIELD AND POOL, OR WILDCAT Salt Creek
15. DISTANCE FROM PROPOSED* LOCATION TO NEAREST PROPERTY OR LEASE LINE, FT. (Also to nearest drlg. unit line, if any) 1580'		11. SEC., T., R., M., OR BLK. AND SURVEY OR AREA Sec. 4-T30N-R17W
16. NO. OF ACRES IN LEASE 640		12. COUNTY OR PARISH San Juan
17. NO. OF ACRES ASSIGNED TO THIS WELL 40		13. STATE New Mexico
18. DISTANCE FROM PROPOSED LOCATION* TO NEAREST WELL, DRILLING, COMPLETED, OR APPLIED FOR, ON THIS LEASE, FT. 200'		20. ROTARY OR CABLE TOOLS Rotary
21. ELEVATIONS (Show whether DF, RT, GR, etc.) 5106' Gr.		22. APPROX. DATE WORK WILL START* 7/10/75

23. PROPOSED CASING AND CEMENTING PROGRAM

SIZE OF HOLE	SIZE OF CASING	WEIGHT PER FOOT	SETTING DEPTH	QUANTITY OF CEMENT
7 7/8"	5 1/2"	14#	30'	5 sacks
4 3/4"	2 7/8"	6.5#	1050"	20 sacks

Plan to air drill 4 3/4" hole to test the Dakota formation.

RECEIVED

JUL 10 1975

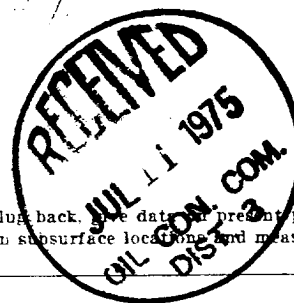
U. S. GEOLOGICAL SURVEY
FARMINGTON, N. M.

IN ABOVE SPACE DESCRIBE PROPOSED PROGRAM: If proposal is to deepen or plug back, give data on present productive zone and proposed new productive zone. If proposal is to drill or deepen directionally, give pertinent data on subsurface location and measured and true vertical depths. Give blowout preventer program, if any.

24. SIGNED Sandra M. Anderson TITLE Secretary DATE 7/8/75

(This space for Federal or State office use)

PERMIT NO. _____ APPROVAL DATE _____

APPROVED BY _____ TITLE _____ DATE _____

CONDITIONS OF APPROVAL, IF ANY:

Form C-102
Supersedes C-128
Effective 1-1-65

Operator: Craneco		Lease King Kong #14-20-0603-639		Well No. 17
Unit Letter G	Section 4	Township 30 North	Range 17 West	County Sar Juan
Actual Footage Location of Well:				
2310 feet from the North line and 1580 feet from the East line				
Ground Level Elev. 5106	Producing Formation Dakota		Pool Salt Creek	Dedicated Acreage: 40 Acres

- ☐ Yes ☐ No If answer is "yes," type of consolidation _____

No allowable will be assigned to the well until all interests have been consolidated (by communitization, unitization, forced-pooling, or otherwise) or until a non-standard unit, eliminating such interests, has been approved by the Commission.

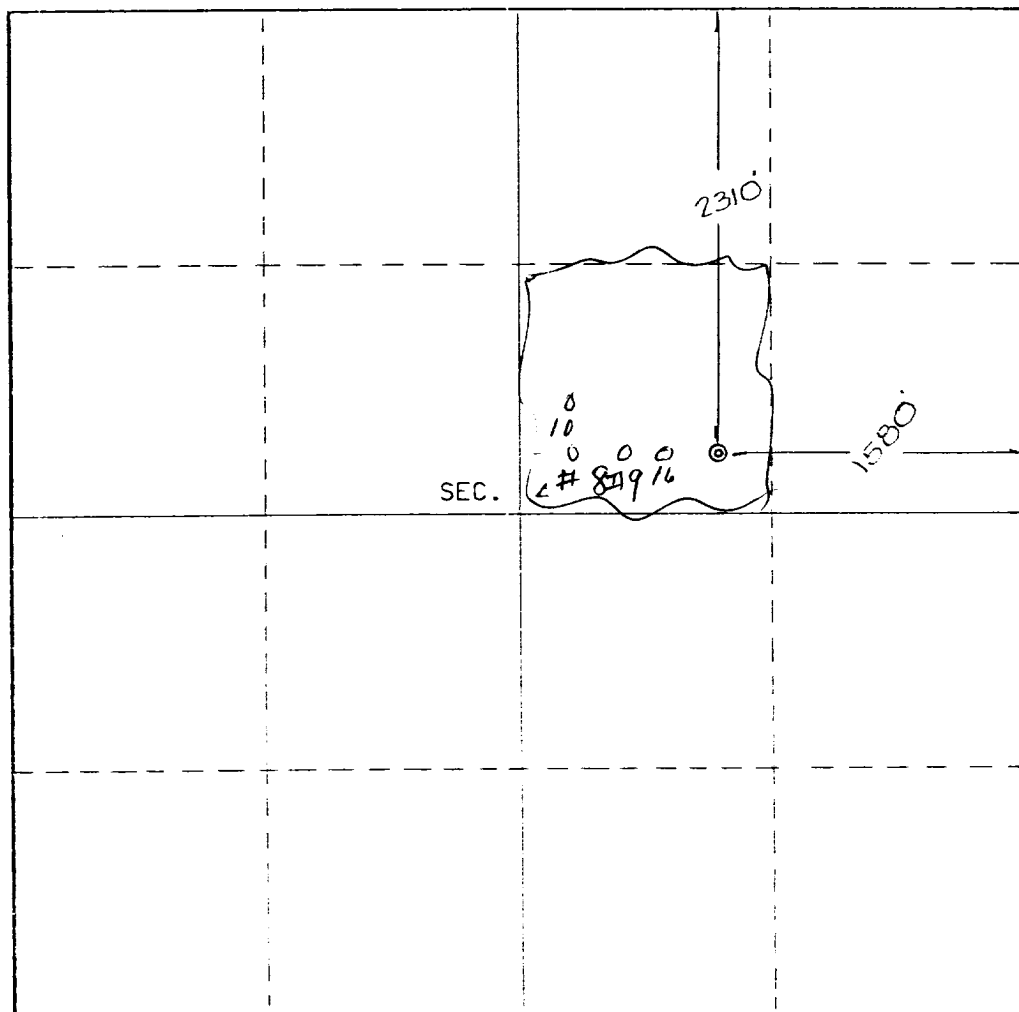

I hereby certify that the information contained herein is true and complete to the best of my knowledge and belief.

Name	Sirina M. Anderson
Position	Secretary

Company: Craneco; R. A. Crane, Jr.

Date
7/8/75

 I hereby certify that the location
 shown on this plat was platted from field
 notes of actual surveys made by me or
 under my supervision, and that the same
 are true and correct to the best of my
 knowledge and belief.

Date Surveyed
June 26, 1975

Registered Professional Engineer
and/or Land Surveyor

Certificate No. 2002
E.V. Echobaw Ls

