

UNITED STATES  
DEPARTMENT OF THE INTERIOR

GEOLOGICAL SURVEY **API 30-045-21990**

APPLICATION FOR PERMIT TO DRILL, DEEPEN, OR PLUG BACK

1a. KIND OF WORK  
DRILL  DEEPEN  PLUG BACK

b. TYPE OF WELL  
OIL WELL  GAS WELL  OTHER   
SINGLE ZONE  MULTIPLE ZONE

2. NAME OF OPERATOR  
El Paso Natural Gas Company

3. ADDRESS OF OPERATOR  
PO Box 990, Farmington, NM 87401

4. LOCATION OF WELL (Report location clearly and in accordance with any State requirements.)\*  
At surface 890'N, 1460'W  
At proposed prod. zone

14. DISTANCE IN MILES AND DIRECTION FROM NEAREST TOWN OR POST OFFICE\*  
U. S. GEOLOGICAL SURVEY

15. DISTANCE FROM PROPOSED\* LOCATION TO NEAREST PROPERTY OR LEASE LINE, FT. (Also to nearest drlg. unit line, if any)

16. NO. OF ACRES IN LEASE

17. NO. OF ACRES ASSIGNED TO THIS WELL  
W 322.86

18. DISTANCE FROM PROPOSED LOCATION\* TO NEAREST WELL, DRILLING, COMPLETED, OR APPLIED FOR, ON THIS LEASE, FT.

19. PROPOSED DEPTH  
5570'

20. ROTARY OR CABLE TOOLS  
Rotary

21. ELEVATIONS (Show whether DF, RT, GR, etc.)  
6151'DF

22. APPROX. DATE WORK WILL START\*

23. PROPOSED CASING AND CEMENTING PROGRAM

| SIZE OF HOLE | SIZE OF CASING | WEIGHT PER FOOT | SETTING DEPTH | QUANTITY OF CEMENT                      |
|--------------|----------------|-----------------|---------------|---|
| 13 3/4"      | 9 5/8"         | 32.3#           | 200'          | 224 cu.ft. to circulate                 |
| 8 3/4"       | 7"             | 20#             | 3220'         | 320 cu.ft. to cover Ojo Alamo           |
| 6 1/4"       | 4 1/2"         | 10.5#           | 3070-5570'    | 437 cu.ft. to fill to line top at 3070' |

Selectively perforate and sandwater fracture the Mesa Verde formation.

A 3000 psi WP and 6000 psi test double gate preventer equipped with blind and pipe rams will be used for blow out prevention on this well.

The W/2 of Section 3 is dedicated to this well.

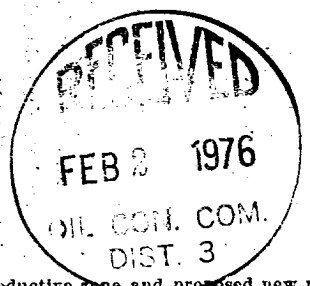

IN ABOVE SPACE DESCRIBE PROPOSED PROGRAM: If proposal is to deepen or plug back, give data on present productive zone and proposed new productive zone. If proposal is to drill or deepen directionally, give pertinent data on subsurface locations and measured and true vertical depths. Give blowout preventer program, if any.

24. SIGNED A. G. Davis TITLE Drilling Clerk DATE Jan. 28, 1976

(This space for Federal or State office use)

PERMIT NO. \_\_\_\_\_ APPROVAL DATE \_\_\_\_\_

APPROVED BY \_\_\_\_\_ TITLE \_\_\_\_\_ DATE \_\_\_\_\_

CONDITIONS OF APPROVAL, IF ANY:

*Okal*

NEW MEXICO OIL CONSERVATION COMMISSION  
 WELL LOCATION AND ACREAGE DEDICATION PLAT

Form C-102  
 Supersedes C-128  
 Effective 1-1-65

All distances must be from the outer boundaries of the Section.

|  |  |                                    |   |                           |
|--|--|------------------------------------|---|---------------------------|
| Operator<br><b>EL PASO NATURAL GAS COMPANY</b>   |  | Lease<br><b>RIDDLE (SF-081098)</b> |   | Well No.<br><b>2A</b>     |
| Unit Letter<br><b>C</b>  | Section<br><b>3</b>                      | Township<br><b>30-N</b>            | Range<br><b>9-W</b>                       | County<br><b>SAN JUAN</b> |
| Actual Footage Location of Well:<br><b>890.</b> feet from the <b>NORTH</b> line and <b>1460</b> feet from the <b>WEST</b> line |  |                                    |   |                           |
| Ground Level Elev.<br><b>6141</b>  | Producing Formation<br><b>MESA VERDE</b> | Pool<br><b>BLANCO MESA VERDE</b>   | Dedicated Acreage:<br><b>322.86</b> Acres |                           |

1. Outline the acreage dedicated to the subject well by colored pencil or hachure marks on the plat below.
2. If more than one lease is dedicated to the well, outline each and identify the ownership thereof (both as to working interest and royalty).
3. If more than one lease of different ownership is dedicated to the well, have the interests of all owners been consolidated by communitization, unitization, force-pooling, etc?

Yes  No If answer is "yes," type of consolidation \_\_\_\_\_

If answer is "no," list the owners and tract descriptions which have actually been consolidated. (Use reverse side of this form if necessary.) \_\_\_\_\_

No allowable will be assigned to the well until all interests have been consolidated (by communitization, unitization, forced-pooling, or otherwise) or until a non-standard unit, eliminating such interests, has been approved by the Commission.

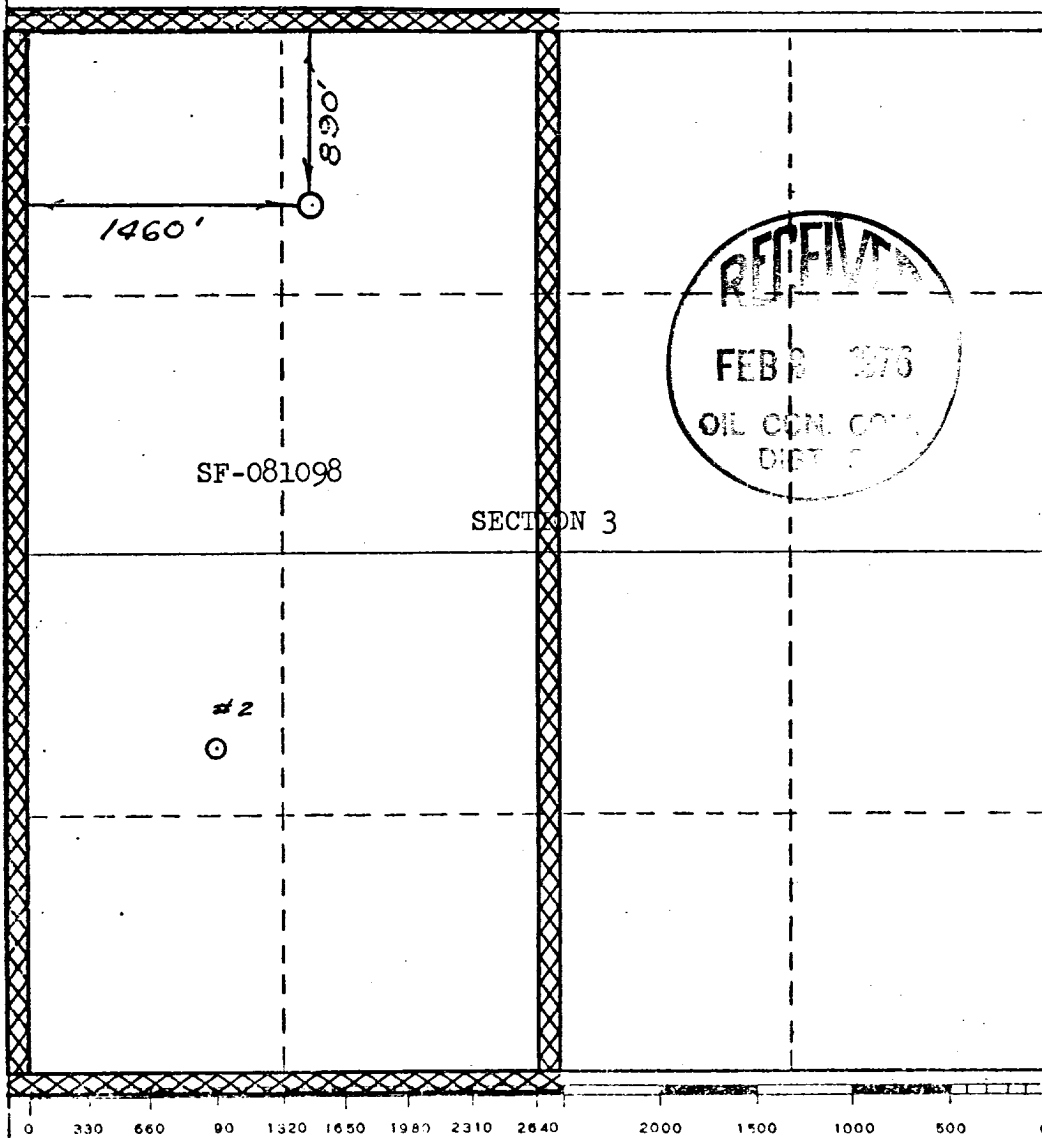

|   |                               |
|---|-------------------------------|
| <b>CERTIFICATION</b>  |                               |
| I hereby certify that the information contained herein is true and complete to the best of my knowledge and belief.<br><i>D. G. Brisco</i><br>D. G. Brisco  |                               |
| Name  | <b>Drilling Clerk</b>         |
| Position  | <b>El Paso Natural Gas Co</b> |
| Company   | <b>January 28, 1976</b>       |
| Date  |                               |
| I hereby certify that the well location shown on this plat was plotted from field notes of actual surveys made by me or under my supervision, and that the same is true and correct to the best of my knowledge and belief. |                               |
| Date Surveyed   | <b>MARCH 18, 1975</b>         |
| Registered Professional Engineer and/or Land Surveyor   | <i>David W. [Signature]</i>   |
| Certificate No.   | <b>1760</b>                   |

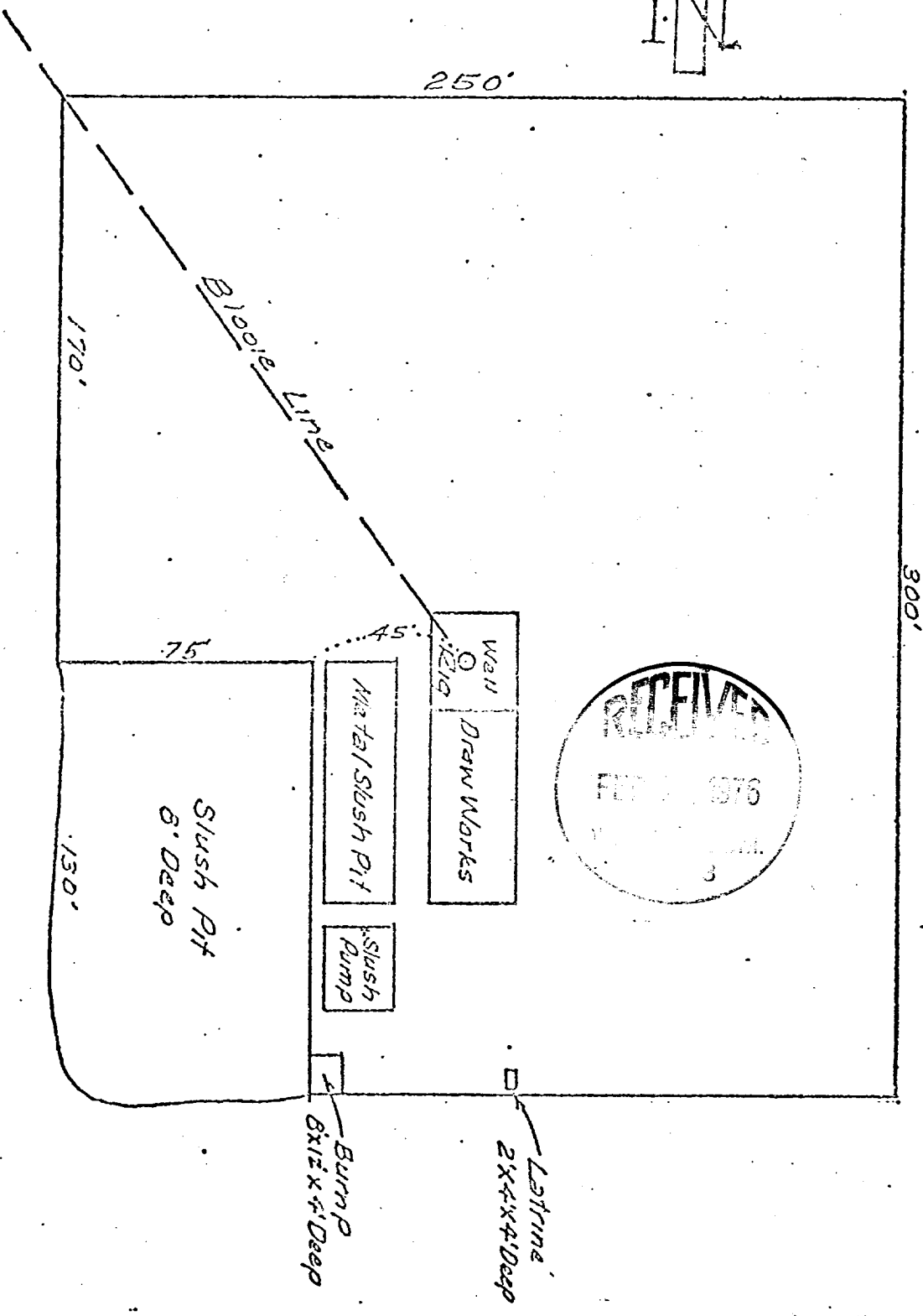

12:44 PM 2A  
3-30-9

# RIDDLE #2A

NE, NW/4, Sec 3, T-30-N, R-9-W

R-9-W

T  
31  
N

T  
30  
N

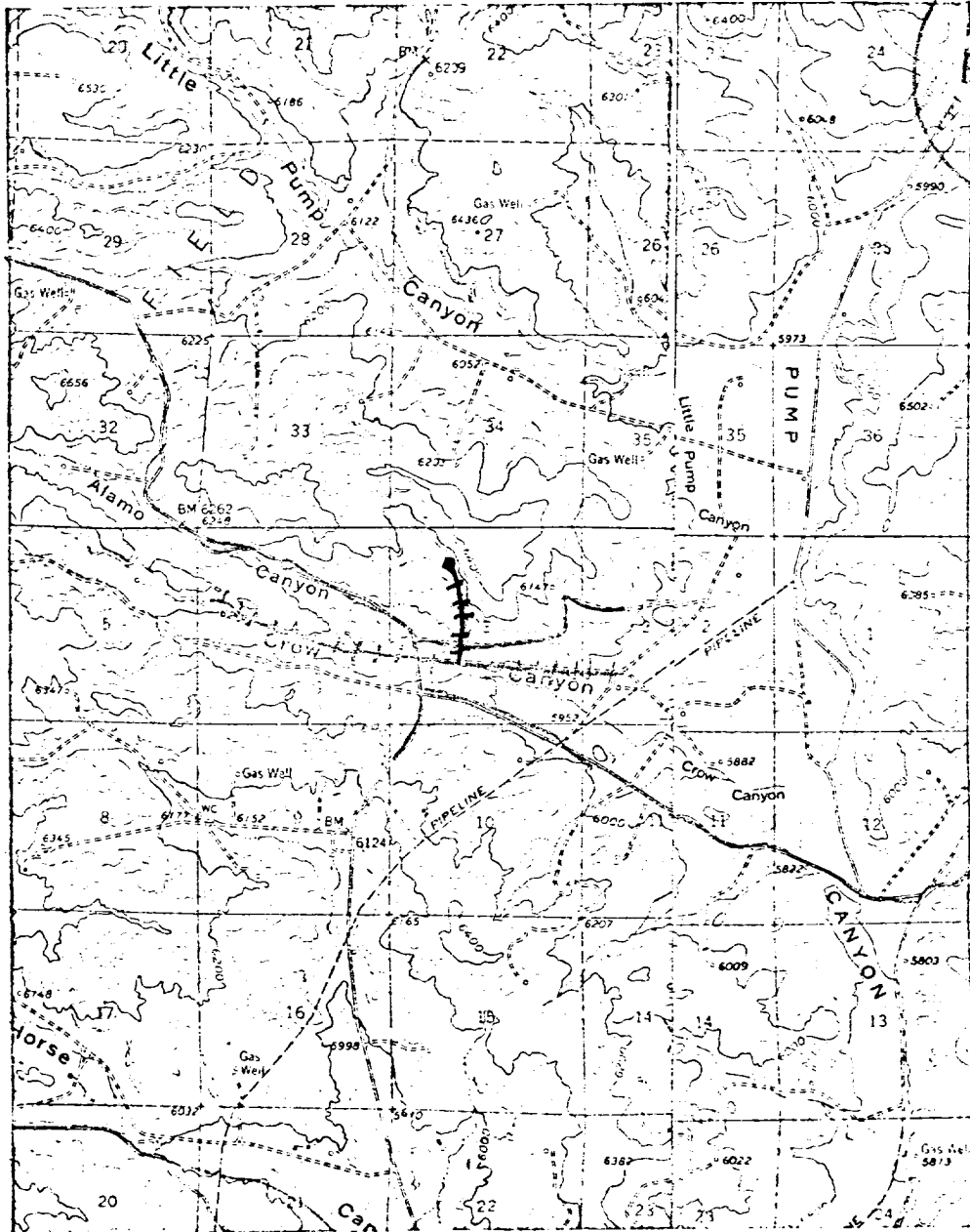

R-9-W

LEGEND OF RIGHT-OF-WAYS

- EXISTING ROADS —————
- EXISTING PIPELINES - - - - -
- EXISTING ROAD & PIPELINE - - - - -
- PROPOSED ROADS —————
- PROPOSED PIPELINES + + + + +
- PROPOSED ROAD & PIPELINE + + + + +

 NATURAL GAS  
COMPANY

P. O. BOX 990  
FARMINGTON, NEW MEXICO 87401  
PHONE: 505-325-2841

January 28, 1976

RECEIVED

JAN 30 1976

U. S. GEOLOGICAL SURVEY  
FARMINGTON, N. M.



Mr. P. T. McGrath  
U. S. Geological Survey  
Post Office Box 959  
Farmington, New Mexico 87401

Re: Application for Permit to Drill  
Riddle #2A  
NW/4 Section 3, T-30-N, R-9-W  
Blanco Mesa Verde

Dear Mr. McGrath:

Details regarding existing roads, pipelines, wells, etc. relative to the above well location are included on the previously submitted base maps, "Field Road Map" and "Composite Map No. 1".

The proposed new well location, new roads and new pipeline are shown on the attached plat along with connecting existing roads and pipelines in the vicinity of the proposed new well.

Water for drilling and completion operations will be obtained from the following location: Knickerbocker Butte Water Well 23-30-10

Waste material will be disposed of by burial in the burn pit, latrine, or reserve pit as applicable. There will be no camp nor air strip associated with drilling this well. Upon completion or abandonment of this well, the location will be cleaned and leveled and a dry hole marker placed, if applicable.

Yours very truly,

*D. G. Brisco*

D. G. Brisco  
Drilling Clerk

pb