

UNITED STATES
DEPARTMENT OF THE INTERIORGEOLOGICAL SURVEY **API 30-045-21991**

APPLICATION FOR PERMIT TO DRILL, DEEPEN, OR PLUG BACK

1a. TYPE OF WORK DRILL <input checked="" type="checkbox"/> DEEPEN <input type="checkbox"/> PLUG BACK <input type="checkbox"/>		5. LEASE DESIGNATION AND SERIAL NO. SF 080244
b. TYPE OF WELL OIL WELL <input type="checkbox"/> GAS WELL <input checked="" type="checkbox"/> OTHER <input type="checkbox"/> SINGLE ZONE <input checked="" type="checkbox"/> MULTIPLE ZONE <input type="checkbox"/>		6. IF INDIAN, ALLOTTEE OR TRIBE NAME
2. NAME OF OPERATOR El Paso Natural Gas Company		7. UNIT AGREEMENT NAME
3. ADDRESS OF OPERATOR PO Box 990, Farmington, NM 87401		8. FARM OR LEASE NAME Pierce
4. LOCATION OF WELL (Report location clearly and in accordance with any State requirements.) At surface 1140'S, 825'E At proposed prod. zone		9. WELL NO. 3A
10. FIELD AND POOL, OR WILDCAT Blanco Mesa Verde ✓		11. SEC., T., R., N., OR BLK. AND SURVEY OR AREA Sec. 7, T-30-N, R-9-W NMPM
12. DISTANCE IN MILES AND DIRECTION FROM NEAREST TOWN OR POST OFFICE*		12. COUNTY OR PARISH 13. STATE San Juan NM
15. DISTANCE FROM PROPOSED* LOCATION TO NEAREST PROPERTY OR LEASE LINE, FT. (Also to nearest city, well line, if any)	16. NO. OF ACRES IN LEASE	17. NO. OF ACRES ASSIGNED TO THIS WELL E 320 ✓
18. DISTANCE FROM PROPOSED LOCATION* TO NEAREST WELL, DRILLING COMPLETED, OR APPLIED FOR, ON THIS LEASE, FT.	19. PROPOSED DEPTH 5745'	20. ROTARY OR CABLE TOOLS Rotary
21. ELEVATIONS (Show whether BP, RL, GR, etc.) 6450' GR		22. APPROX. DATE WORK WILL START*

23. PROPOSED CASING AND CEMENTING PROGRAM

SIZE OF HOLES	SIZE OF CASING	WEIGHT PER FOOT	SETTING DEPTH	QUANTITY OF CEMENT
13 3/4"	9 5/8"	32.3#	200'	224 cu. ft. to circ. to surface
8 1/2"	7"	20#	3530'	376 cu. ft. cover Ojo Alamo
6 1/2"	4 1/2"	10.5#	3380-5745'	413 cu. ft. to fill to liner top at 3380'

Selectively perforate and sandwater fracture the Mesa Verde formation.

A 3000 psi WP and 6000 psi test double gate preventer equipped with blind and pipe rams will be used for blow out prevention on this well.

The E/2 of Section 7 is dedicated to this well.

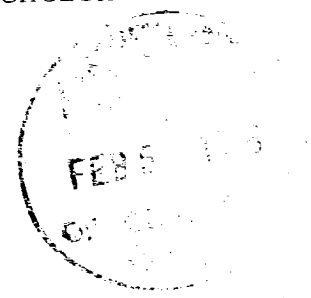

IN ABOVE SPACE DESCRIBE PROPOSED PROGRAM: If proposal is to deepen or plug back, give data on present productive zone and proposed new productive zone. If proposal is to drill or deepen directionally, give pertinent data on subsurface locations and measured and true vertical depths. Give blowout preventer program, if any.

24. SIGNED A. D. Buices TITLE Drilling Clerk DATE February 2, 1976
(This space for Federal or State office use)

PERMIT NO. _____ APPROVAL DATE _____

APPROVED BY _____ TITLE _____ DATE _____
CONDITIONS OF APPROVAL, IF ANY:

OK

*See Instructions On Reverse Side

NEW MEXICO OIL CONSERVATION COMMISSION
WE. LOCATION AND ACREAGE DEDICATION PLAT

Form C-102
Supersedes C-128
Effective 1-1-65

All distances must be from the outer boundaries of the Section.

Operator EL PASO NATURAL GAS COMPANY		Lease PIERCE		(SF-080244)		Well No. 3A
Unit Letter P	Section 7	Township 30-N	Range 9-W	County SAN JUAN		
Actual Footage Location of Well: 1140 feet from the SOUTH line and 825 feet from the EAST line						
Ground Level Elev. 6459	Producing Formation MESA VERDE		Pool BLANCO MESA VERDE		Dedicated Acreage 320.00 Acres	

1. Outline the acreage dedicated to the subject well by colored pencil or hatchure marks on the plat below.
2. If more than one lease is dedicated to the well, outline each and identify the ownership thereof (both as to working interest and royalty).
3. If more than one lease of different ownership is dedicated to the well, have the interests of all owners been consolidated by communitization, unitization, force-pooling, etc?

☐ Yes ☐ No If answer is "yes," type of consolidation _____

If answer is "no," list the owners and tract descriptions which have actually been consolidated. (Use reverse side of this form if necessary.) _____

No allowable will be assigned to the well until all interests have been consolidated (by communitization, unitization, forced-pooling, or otherwise) or until a non-standard unit, eliminating such interests, has been approved by the Commission.

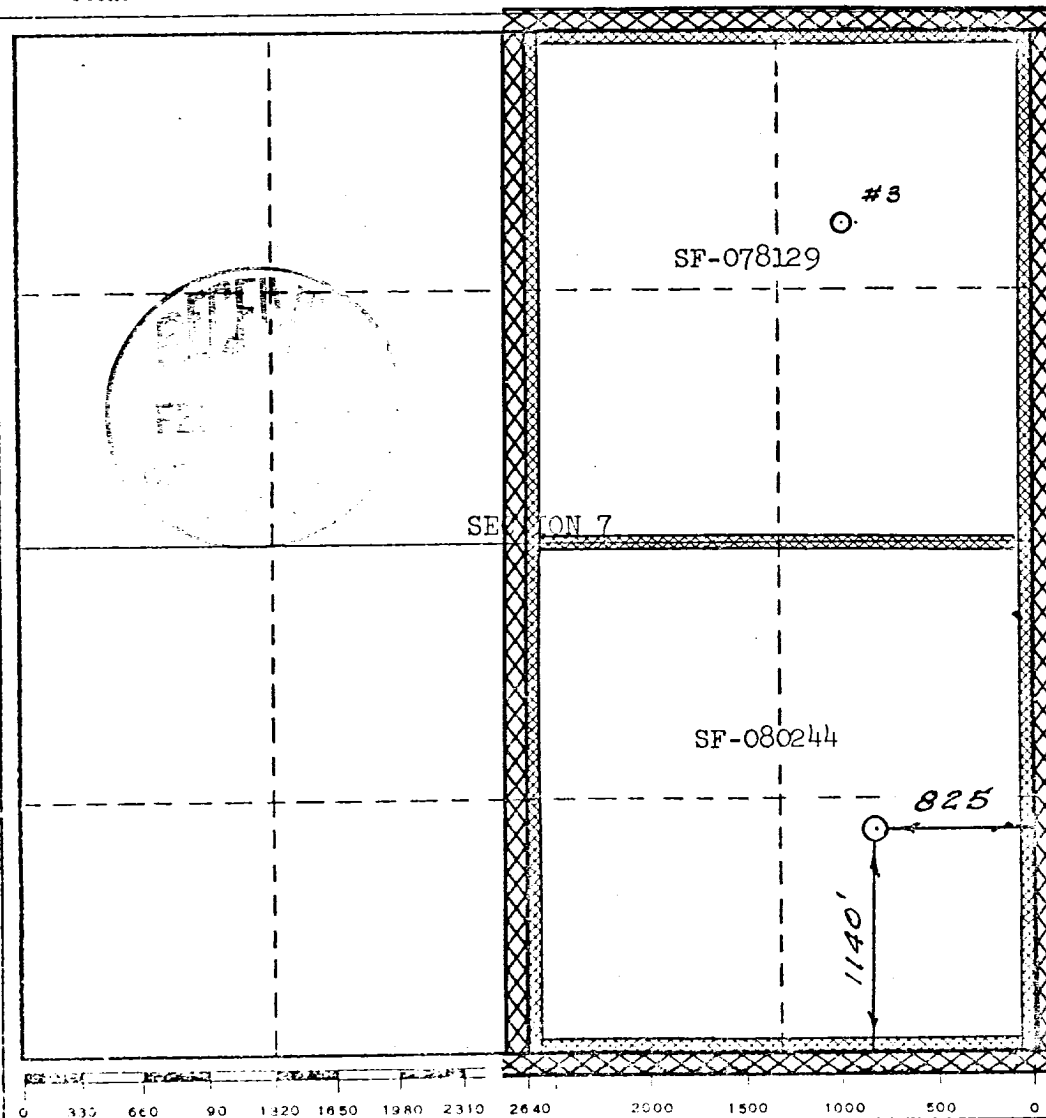

CERTIFICATION

I hereby certify that the information contained herein is true and complete to the best of my knowledge and belief.

Original Signed by
D. G. Brisco

Name

Drilling Clerk
Position

El Paso Natural Gas Co.
Company

February 2, 1976
Date

I hereby certify that the well location shown on this plat was plotted from field notes of actual surveys made by me or under my supervision, and that the same is true and correct to the best of my knowledge and belief.

Date Surveyed

MARCH 17, 1975

Registered Professional Engineer
and/or Land Surveyor

Certificate No. **1760**

Figure # 34

17-33-72

LOCATION AND EQUIPMENT LAY-OUT

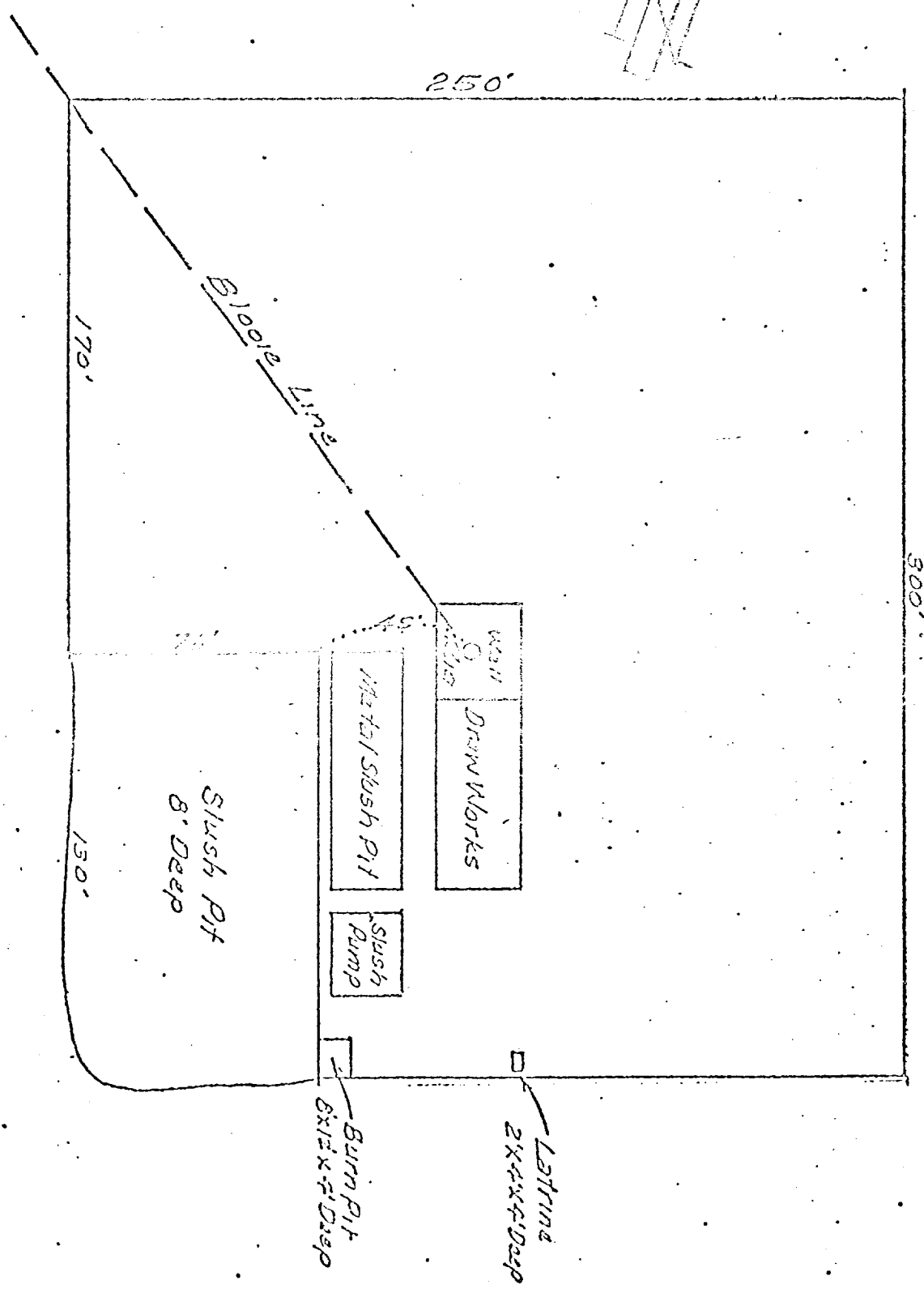

PIERCE #3A
SE, SE14, SEC 7, T-30-N, R-9-W

R-10-W

R-9-W

T
31
N

T
30
N

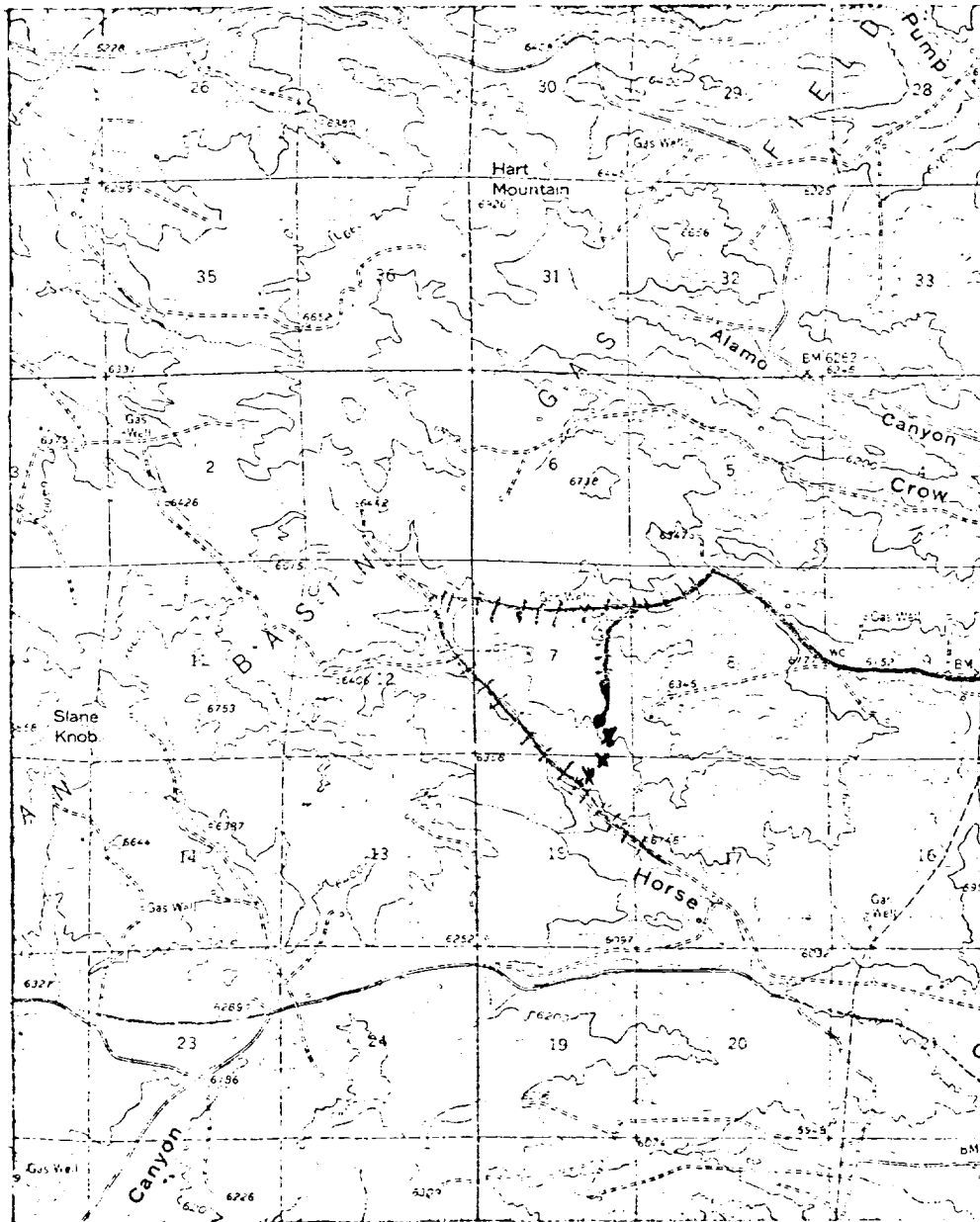

LEGEND OF RIGHT-OF-WAYS

EXISTING ROADS	—————
EXISTING PIPELINES	- - - - -
EXISTING ROAD & PIPELINE	- - - - -
PROPOSED ROADS	—————
PROPOSED PIPELINES	+ + + + +
PROPOSED ROAD & PIPELINE	+ + + + +

El Paso NATURAL GAS
COMPANY

P.O. BOX 990
FARMINGTON, NEW MEXICO 87401
PHONE: 505-325-2841

February 2, 1976

FEB 4 1976

Mr. P. T. McGrath
U. S. Geological Survey
Post Office Box 959
Farmington, New Mexico 87401

Re: Application for Permit to Drill
Pierce #3A
SE Section 7, T-30-N, R-9-W
Blanco Mesa Verde

Dear Mr. McGrath:

Details regarding existing roads, pipelines, wells, etc. relative to the above well location are included on the previously submitted base maps, "Field Road Map" and "Composite Map No. 1".

The proposed well location, new roads and new pipeline are shown on the attached plat along with connecting existing roads and pipelines in the vicinity of the proposed new well.

Water for drilling and completion operations will be obtained from the following location: Knickerbocker Butte Water Well, Section 23, T-30-N, R-10-W.

Waste material will be disposed of by burial in the burn pit, latrine, or reserve pit as applicable. There will be no camp nor air strip associated with drilling this well. Upon completion or abandonment of this well, the location will be cleaned and leveled and a dry hole marker placed, if applicable.

Yours very truly,

D. G. Brisco

D. G. Brisco
Drilling Clerk

pb