

UNITED STATES  
DEPARTMENT OF THE INTERIORGEOLOGICAL SURVEY *APL 30-095-21998*

## APPLICATION FOR PERMIT TO DRILL, DEEPEN, OR PLUG BACK

## 1a. TYPE OF WORK

DRILL ☒DEEPEN ☐PLUG BACK ☐

## b. TYPE OF WELL

OIL  
WELL ☒GAS  
WELL ☐OTHER ☐SINGLE  
ZONE ☐MULTIPLE  
ZONE ☐

## 2. NAME OF OPERATOR

C.S.T. ENTERPRISES INC..

## 3. ADDRESS OF OPERATOR

P.O. Box 1200, Farmington, New Mexico 87401

## 4. LOCATION OF WELL (Report location clearly and in accordance with any State requirements.)\*

At surface

408 ft from North Line & 353 ft from East line.  
At proposed prod. zone

## 14. DISTANCE IN MILES AND DIRECTION FROM NEAREST TOWN OR POST OFFICE\*

7 Miles East of Shiprock, New Mexico.

10. DISTANCE FROM PROPOSED\*  
LOCATION TO NEAREST  
PROPERTY OR LEASE LINE, FT.  
(Also to nearest drig. unit line, if any)

353'

## 16. NO. OF ACRES IN LEASE

640'

## 18. DISTANCE FROM PROPOSED LOCATION\*

TO NEAREST WELL, DRILLING, COMPLETED,  
OR APPLIED FOR, ON THIS LEASE, FT.

4,620 ft.

## 19. PROPOSED DEPTH

1,050 ft.

17. NO. OF ACRES ASSIGNED  
TO THIS WELL

2+

40

## 20. ROTARY OR CABLE TOOLS

Rotary

## 21. ELEVATIONS (Show whether DF, RT, GR, etc.)

Ground level 5,202.0 ft.

## 22. APPROX. DATE WORK WILL START\*

February 15, 76

## 23.

## PROPOSED CASING AND CEMENTING PROGRAM

SIZE OF HOLE	SIZE OF CASING	WEIGHT PER FOOT	SETTING DEPTH	QUANTITY OF CEMENT
7"	5½"	9½ lbs.	30'	15 sks.
4 3/4"	2"	4 lbs.	1050	none- set with packer

We plan to drill well after setting and cementing 5½" casing at 30', using Rotary Air dry method.. We plan to core and test the Gallup, then drill on to top of Dakota. We plan to slim hole complete this well if oil is found.

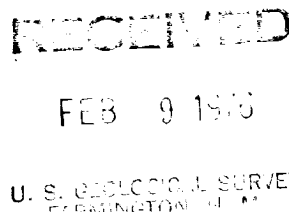

IN ABOVE SPACE DESCRIBE PROPOSED PROGRAM: If proposal is to deepen or plug back, give data on present productive zone and proposed new productive zone. If proposal is to drill or deepen directionally, give pertinent data on subsurface locations and measured and true vertical depths. Give blowout preventer program, if any.

## 24.

SIGNED

*John R. Toler*

TITLE

Secretary &amp; Treasurer

DATE

*2/6/76*

(This space for Federal or State office use)

PERMIT NO. \_\_\_\_\_

APPROVAL DATE \_\_\_\_\_

APPROVED BY \_\_\_\_\_

TITLE \_\_\_\_\_

DATE \_\_\_\_\_

CONDITIONS OF APPROVAL, IF ANY:

*OK*

\*See Instructions On Reverse Side

**NEW MEXICO OIL CONSERVATION COMMISSION  
WELL LOCATION AND ACREAGE DEDICATION PLAT**

Form O-122  
Supersedes C-128  
Effective 1-1-65

All distances must be from the outer boundaries of the Section.

Operator <b>C. S. T. ENTERPRISES</b>			Lease <b>NAVAJO TRIBAL</b>		Well No. <b>19</b>
Unit Letter <b>A</b>	Section <b>31</b>	Township <b>30 NORTH</b>	Range <b>16 WEST</b>	County <b>SAN JUAN</b>	
Actual Footage Location of Well: <b>408</b> feet from the <b>NORTH</b> line and <b>353</b> feet from the <b>EAST</b> line					
Ground Level Elev. <b>5202.0</b>	Producing Formation <b>DAKOTA</b>	Pool <b>SLICK ROCK, DAKOTA EXT</b>	Dedicated Acreage: <b>40</b> Acres		

1. Outline the acreage dedicated to the subject well by colored pencil or hatchure marks on the plat below.
2. If more than one lease is dedicated to the well, outline each and identify the ownership thereof (both as to working interest and royalty).
3. If more than one lease of different ownership is dedicated to the well, have the interests of all owners been consolidated by communitization, unitization, force-pooling, etc?

☐ Yes ☒ No If answer is "yes," type of consolidation \_\_\_\_\_

If answer is "no," list the owners and tract descriptions which have actually been consolidated. (Use reverse side of this form if necessary.) \_\_\_\_\_

No allowable will be assigned to the well until all interests have been consolidated (by communitization, unitization, forced-pooling, or otherwise) or until a non-standard unit, eliminating such interests, has been approved by the Commission.

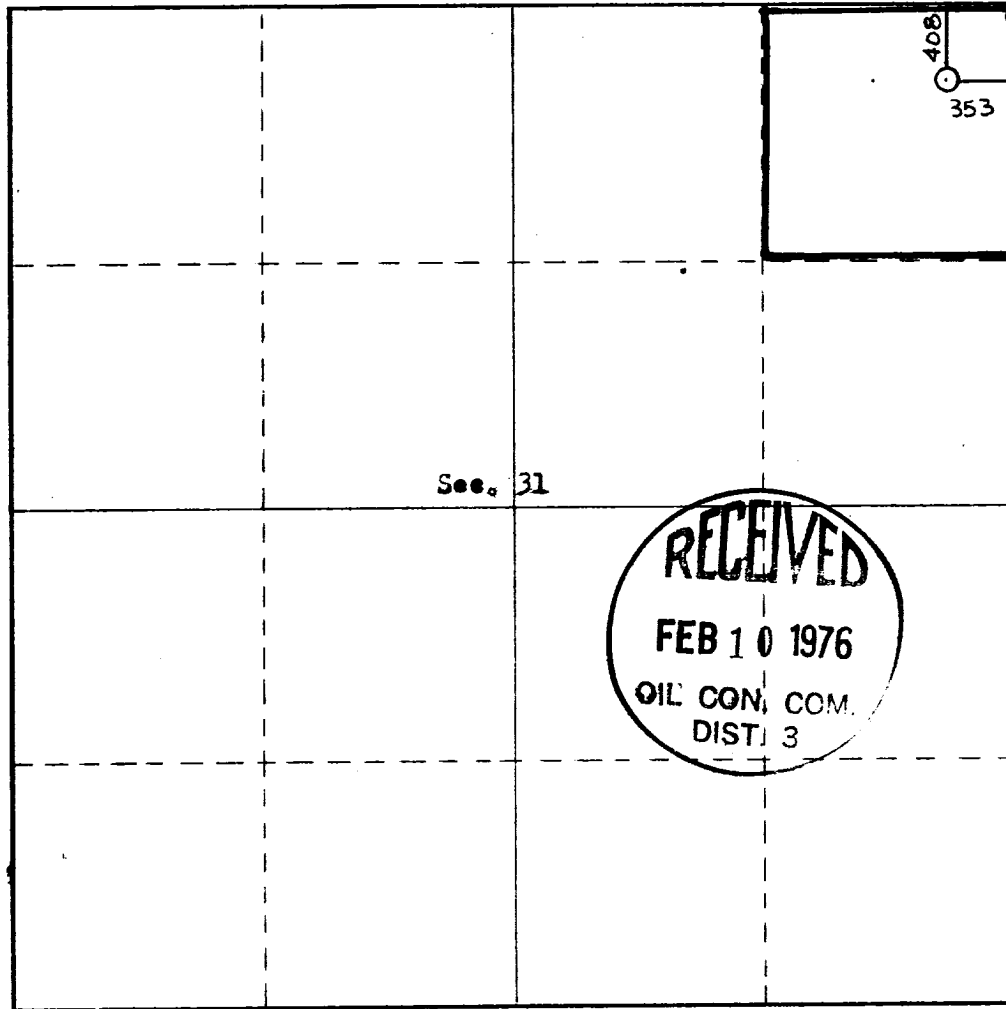

**CERTIFICATION**

I hereby certify that the information contained herein is true and complete to the best of my knowledge and belief.

Name John P. Tolson  
 Position Secretary Treasurer  
 Company C.S.T. Enterprises  
 Date 2/6/1974

I hereby certify that the well location shown on this plat was plotted from field notes of actual surveys made by me or under my supervision, and that the same is true and correct to the best of my knowledge and belief.

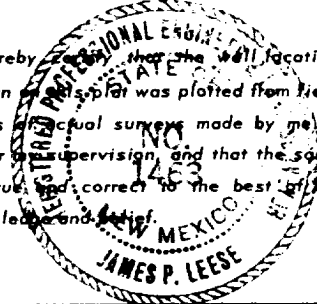

Date Surveyed  
**3 February, 1976**  
 Registered Professional Engineer and/or Land Surveyor  
James P. Leese  
**James P. Leese**

Certificate No.

**1463**

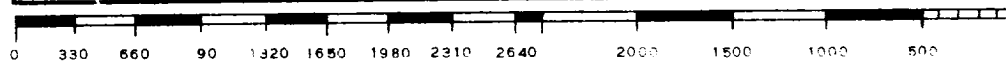

Tank Battery



Flow  
line

RIG

Pipe Rack

Mud Pit

408'

Road



Toilet

353

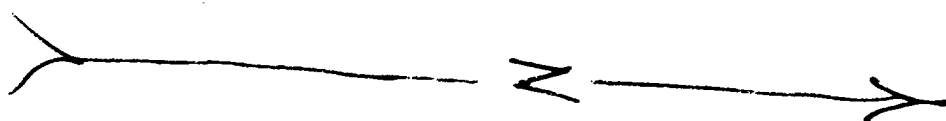
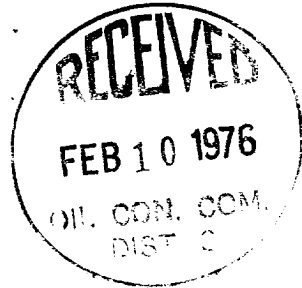

C.S.T. Enterprises INC.  
P. O. Box 1200  
Farmington, New Mexico 87401  
Feburary 6, 1976

U. S. Dept. of the Interior  
Geological Survey  
Farmington, New Mexico 87401  
Attn: Mr. P. T. McGrath

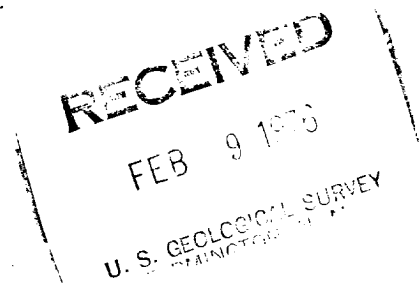

Dear Sir:

Please find enclosed the 12 Point Plan we intend to follow in drilling the proposed well #19.

There are several existing roads in the area, we plan to drill. We will be able to move to the location using one of these roads. The ground where the well site is, is flat enough to rig up on without any Dozer work. We will use steel pits. No earthen pits will be dug. We will be drilling with Rotary Rig using Air to circulate with. Any excess dust or cuttings will be deposited in any low spot to help stop errosion. We will not need water to drill with. The ground disturbed during drilling will be leveled back and reseeded where necessary. All garabage and trash will be taken to a land fill site. There is no grass or brush on immediate location. So, no grass, brush or trees will be disturbed during this operation.

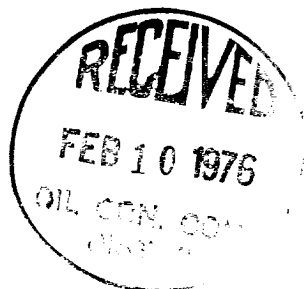

Submitted by C.S.T. Enterprises INC

  
-----  
John R. Toles, Secretary & Treasurer

Found 1912 AC  
 R17W  

25	30	150N
36	31	

 Plun

R17W  
 R16W

2640'

Set 31  
 640' AC  
 Navajo Tribal Lease No. 14-20-0673-742

Set 1/4 Cor

Set Center Sec

Set 1/4 Cor

1 Tank  
 Battery

Cave #19

Found 2" Gas  
 Vsd.  

30.12	170N
31.35	4.00N

T30N  
 T20W

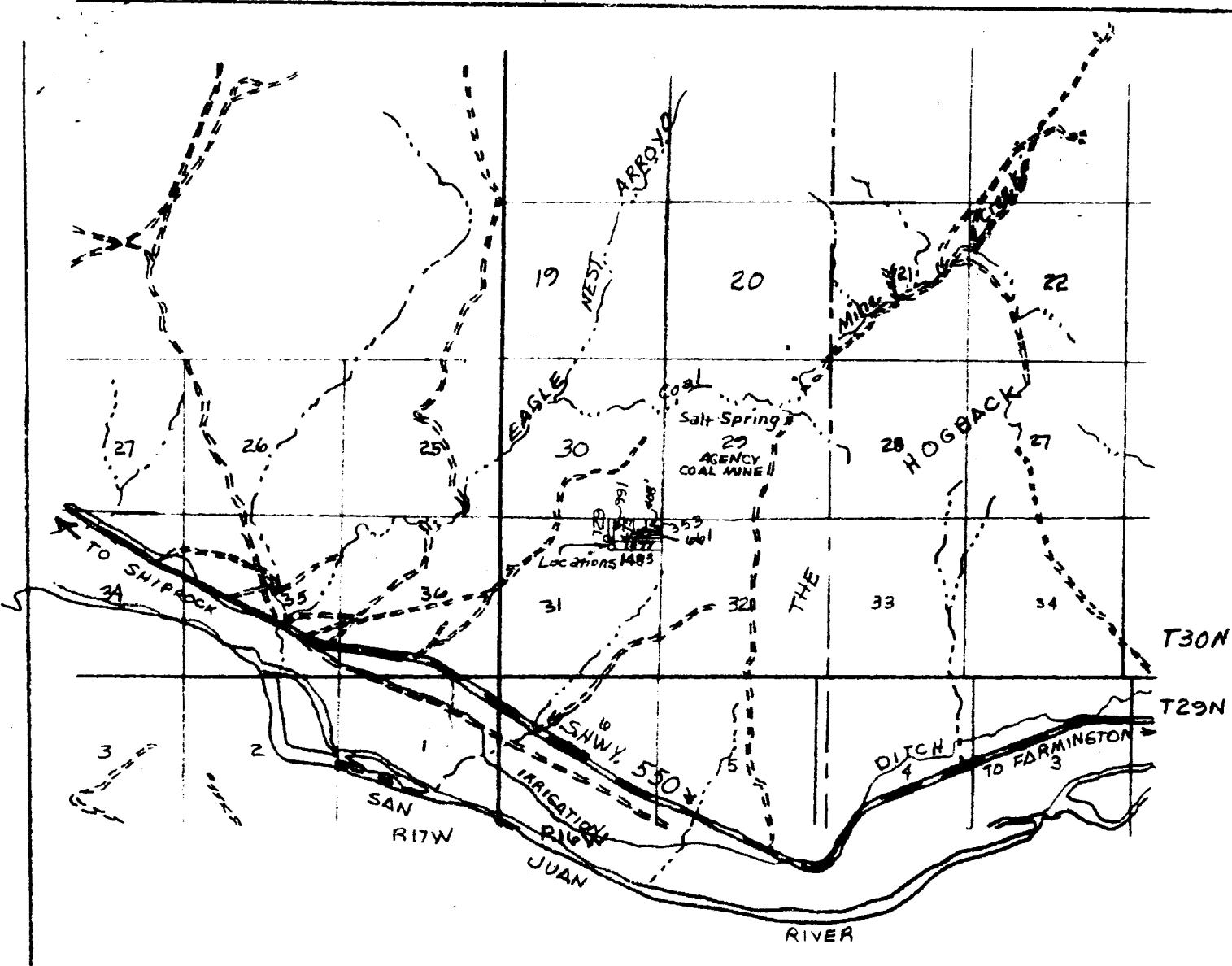

**RECEIVED**  
**FEB 10 1976**  
**OIL CON. COM.**  
**INST. 3**

VICINITY MAP FOR  
**C.S.T. ENTERPRISES**  
 SHOWING  
 WELL LOCATIONS IN THE NW 1/4  
 SECTION 31, T30N, R16W,  
 N.M.P.M., SAN JUAN COUNTY,  
 NEW MEXICO.  
 DATE: 4 February, 1976 SCALE: 1"=1 MILE  
 SAN JUAN ENGINEERING CO.