

UNITED STATES  
DEPARTMENT OF THE INTERIOR  
GEOLOGICAL SURVEY

API 30-045-22021

## APPLICATION FOR PERMIT TO DRILL, DEEPEN, OR PLUG BACK

1a. TYPE OF WORK DRILL <input checked="" type="checkbox"/> DEEPEN <input type="checkbox"/> PLUG BACK <input type="checkbox"/>		5. LEASE DESIGNATION AND SERIAL NO. SF 078316	
b. TYPE OF WELL OIL WELL <input type="checkbox"/> GAS WELL <input checked="" type="checkbox"/> OTHER <input type="checkbox"/>		6. IF INDIAN, ALLIOTTEE OR TRIBE NAME	
2. NAME OF OPERATOR Tenneco Oil Company		7. UNIT AGREEMENT NAME	
3. ADDRESS OF OPERATOR 1860 Lincoln St., Suite 1200, Denver, Colorado 80203		8. FARM OR LEASE NAME Florance	
4. LOCATION OF WELL (Report location clearly and in accordance with any State requirements.) At surface 1505' FSL and 1820' FEL		9. WELL NO. #47A	
14. DISTANCE IN MILES AND DIRECTION FROM NEAREST PORT OFFICE*		10. FIELD AND POOL, OR WILDCAT Blanco Mesa Verde	
10. DISTANCE FROM PROPOSED* LOCATION TO NEAREST PROPERTY OR LEASE LINE, FT. (Also to nearest drlg. unit line, if any)		11. SEC., T., R., M., OR BLK. AND SURVEY OR AREA Sec. 5, T30N, R9W	
18. DISTANCE FROM PROPOSED LOCATION TO NEAREST WELL, DRILLING, COMPLETED, OR APPLIED FOR, ON THIS LEASE, FT.		12. COUNTY OR PARISH San Juan	
16. NO. OF ACRES IN LEASE 321.80		13. STATE New Mexico	
19. PROPOSED DEPTH 5515		17. NO. OF ACRES ASSIGNED TO THIS E/321.80	
20. ROTARY OR CABLE TOOLS Rotary		21. APPROX. DATE WORK WILL START* upon approval	
21. ELEVATIONS (Show whether DF, RT, GR, etc.) 6295' GL			

RECEIVED  
MAR 26 1976OIL CON. COM.  
DIST. 3

## PROPOSED CASING AND CEMENTING PROGRAM

SIZE OF HOLE	SIZE OF CASING	WEIGHT PER FOOT	SETTING DEPTH	QUANTITY OF CEMENT
12 1/4"	9 5/8"	36#	200' +	Suff. to circulate to surface.
8 3/4"	7"	23#	3475' +	Suff. to cement back to surface
6 1/8"	4 1/2"	10.5#	3225' - 5515'	Suff. to cement back to 7" csg.

Plan to drill well as follows:

1. MIRURT, drill 12 1/4" hole to +200'.
2. Set and cement 9 5/8" casing to + 200' & cement with suff. cement to circ. to surface.
3. Drill out with 8 3/4" bit to + 3475 feet.
4. Run 7" casing and cement back to surface casing.
5. Drill out of 7" using gas as the circulating fluid, do not drill more than 10' below the 7" casing shoe until the hole has dried up completely and is dusting.
6. Drill the hole to T.D., log the hole dry as requested by drillsite geologist.
7. Run 4 1/2" liner to T.D., load hole with mud and cement liner back to top of 4 1/2". Set liner hanger and POH w/drill pipe.
8. This well will be completed through casing perforations and stimulated as necessary to establish commercial production.
9. Clean up area.

IN ABOVE SPACE DESCRIBE PROPOSED PROGRAM: If proposal is to deepen or plug back, give data on present productive zone and proposed new productive zone. If proposal is to drill or deepen directionally, give pertinent data on subsurface locations and measured and true vertical depths. Give blowout preventer program, if any.

24. SIGNED <u>R. Z. Parish</u> TITLE <u>Div. General Manager</u> DATE <u>3-24-76</u>	
(This space for Federal or State office use)	
PERMIT NO. _____	APPROVAL DATE _____
APPROVED BY _____	TITLE _____
CONDITIONS OF APPROVAL, IF ANY:	

*Okal*

DATE MAR 25 1976

U.S. GEOLOGICAL SURVEY

\*See Instructions On Reverse Side

**NEW MEXICO OIL CONSERVATION COMMISSION  
WELL LOCATION AND ACERAGE DEDICATION PLAT**

*All distances must be from the outer boundaries of the Section*

Operator <b>TENNECO OIL COMPANY</b>			Lease <b>FLORANCE</b>		Well No. <b>47A</b>
Unit Letter <b>J</b>	Section <b>5</b>	Township <b>30 NORTH</b>	Range <b>9 WEST</b>	County <b>SAN JUAN</b>	
Actual Footage Location of Well: <b>1505</b> feet from the <b>SOUTH</b> line and <b>1820</b> feet from the <b>EAST</b> line Ground Level Elev. <b>6295</b> Producing Formation <b>Blanco Mesaverte</b> Pool <b>Blanco Mesaverte</b> De <b>321.00</b> Acres <b>E72</b>					

1. Outline the acreage dedicated to the subject well by colored pencil or hachure marks on the plat below.
2. If more than one lease is dedicated to the well, outline each and identify the ownership thereof (both as to working interest and royalty),
3. If more than one lease of different ownership is dedicated to the well, have the interests of all owners been consolidated by communitization, unitization, force-pooling, etc?

( ) Yes (X) No If answer is "yes," type of consolidation .....

If answer is "no," list the owners and tract descriptions which have actually consolidated. (Use reverse side of this form if necessary.) .....

No allowable will be assigned to the well until all interests have been consolidated (by communitization, unitization, forced-pooling, or otherwise) or until a non standard unit, eliminating such interests, has been approved by the Commission.

**CERTIFICATION**

I hereby certify that the information contained herein is true and complete to the best of my knowledge and belief.

Name Ed J. Decker

Position Production Clerk

Company Tenneco Oil Co.

Date 3/23/76

I hereby certify that the well location shown on this plat was plotted from all copies of original surveys made by me or under my supervision, and that the same is true and correct to the best of my knowledge and belief.

11 March, 1976  
Date Surveyed

James P. Leese  
Registered Professional Engineer  
and/or Land Surveyor

**James P. Leese**

1463  
Certificate No.

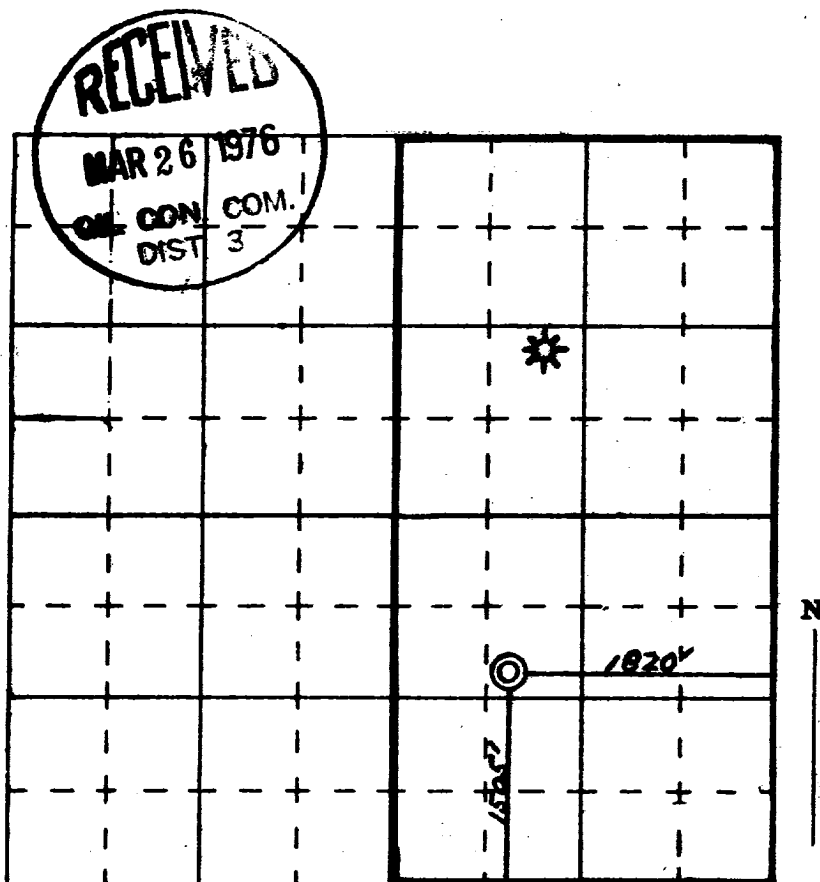

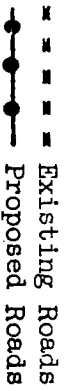

1" = 1 mile

Tenneco Oil Company  
Showing

Well locations in SE 1/4 of Sec 1,  
and SE 1/4 of Sec 8: NE 1/4 Sec 9,  
T30N, R9W, N14MP. San Juan  
County, New Mexico  
Scale: 1"=1 mile  
Date: 13 March 1976

San Juan Engineering Company  
Farmington, New Mexico

RIG LAYOUT - FLORENCE 47-A

Existing Lease Road

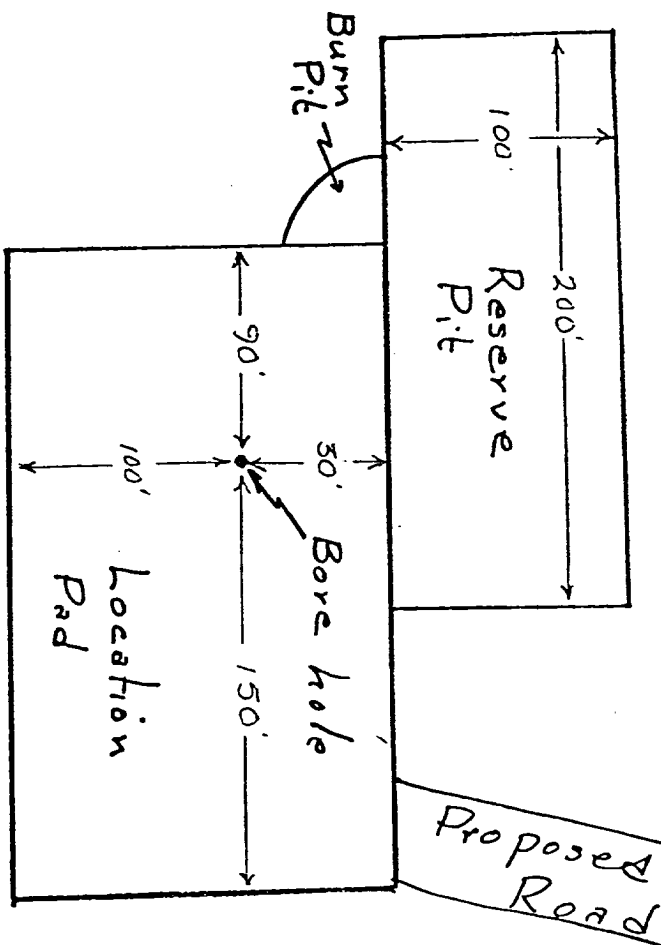

RECEIVED  
MAR 26 1976  
OIL CON. COM.  
PAGE 2

Florance #47A  
SURFACE USE PLAN

1. Shown on attached map.
2. Shown on attached map. Approximately 125' of 14' wide road will be required.
3. Shown on attached map.
4. Shown on attached map.
5. This is expected to be a dry gas well, therefore, a tank battery will not be required.
6. Water will be hauled from the San Juan River or nearest wash.
7. All waste material will be buried in reserve pit at time of location clean up.
8. No camps will be associated with this operation.
9. No airstrip will be built for this operation.
10. Shown on attached diagram.
11. Upon completion or abandonment of this well, the location will be cleaned and levelled and a dry hole marker placed, if applicable.
12. The location is sandy, typical for the area. Vegetation is sage brush.

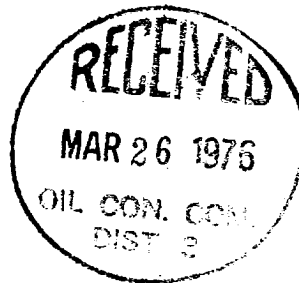

7 POINT WELL CONTROL PLAN

1. Surface casing: 9 5/8", 24#, approximately 200, grade K-55, new condition.
2. Casinghead will be 10", 900 Series, 3,000 psi rating.
3. Intermediate casing - 7", 20#, K-55, will be set at  $\pm$  3475' and cemented to surface casing.
4. Blowout preventors: Hydraulic, double ram, 10". One set of rams will be provided for each size drill pipe in the hole. One set of blind rams at all times. Fill line will be 2", kill line will be 2", choke relief line will be 2" with variable choke.
5. Auxiliary equipment:
  - (1) Kelly cock will be in use at all times.
  - (2) Stabbing valve to fit drill pipe will be present on floor at all times.
  - (3) Mud monitoring will be visual, no abnormal pressures are anticipated in this area.
  - (4) Rotating head will be used when drilling with gas.
6. Anticipated bottom-hole pressure:

This is an area of known pressure. Maximum anticipated pressure at 5700' T.D. is 1200 psi.
7. Drilling Fluids:

0 - 200' Spud mud

200- 3475' Gel water - low solids as needed to maintain good conditions.

3475' - T.D. Compressed gas

