

NO. OF COPIES RECEIVED	5
DISTRIBUTION	
SANTA FE	
FILE	
U.S.G.S.	
LAND OFFICE	
OPERATOR	

NEW MEXICO OIL CONSERVATION COMMISSION

30-045-22298

Form C-101

Revised 1-1-65

3A. Indicate Type of Lease	
STATE <input type="checkbox"/>	FEE <input checked="" type="checkbox"/>
5. State Oil & Gas Lease No.	

APPLICATION FOR PERMIT TO DRILL, DEEPEN, OR PLUG BACK

1a. Type of Work b. Type of Well OIL WELL <input type="checkbox"/> GAS WELL <input checked="" type="checkbox"/> OTHER <input type="checkbox"/>		DRILL <input checked="" type="checkbox"/> DEEPEN <input type="checkbox"/> PLUG BACK <input type="checkbox"/>		7. Unit Agreement Name	
2. Name of Operator Manana Gas, Inc.		3. Address of Operator 1301 Sigma Chi NE, Albuquerque, NM 87108		8. Farm or Lease Name Mary Wheeler	
4. Location of Well UNIT LETTER D LOCATED 1095 FEET FROM THE North LINE AND 875 FEET FROM THE West LINE OF SEC. 23 TWP. 30N RGE. 12W NMPM		5. State Oil & Gas Lease No.		9. Well No. 1	
12. County San Juan		10. Field and Pool, or Wildcat Basin Dakota		11. Proposed Depth 6450'	
19A. Formation Dakota		20. Rotary or C.T. Rotary		21. Elevations (Show whether DF, RT, etc.) 5518 Gr	
21A. Kind & Status Plug. Bond Blanket Bond		21B. Drilling Contractor Four Corners Drilg. Co.		22. Approx. Date Work will start 12-23-76	

PROPOSED CASING AND CEMENT PROGRAM

SIZE OF HOLE	SIZE OF CASING	WEIGHT PER FOOT	SETTING DEPTH	SACKS OF CEMENT	EST. TOP
12 1/4"	8 5/8"	24#	200	150	Surface
7 7/8"	4 1/2"	10.5#	6460	575	1600'

Manana Gas, Inc. will drill a 6500 ft. Dakota test with rotary tools.

Mechanical logs will be run at TD. The Dakota formation will be selectively perforated and hydro fractured. 10" 3000 psi BOP with blind and pipe rams will be operational at all times while drilling. 6" 3000 psi double gate manual BOP will be utilized for completion.

Gas is dedicated to El Paso Natural Gas Co. to 1-1-78.

DV cementing tools will be set at the base of the Point Lookout sandstone and at the base of the Pictured Cliffs sandstone for a 3 stage cement job as follows:

TD - 5350 w/250 sx
4400 - 3200 w/260 sx
1900 - 1600 w/65 sx

APPROVAL VALID

FOR 90 DAYS UNLESS
DRILLING COMMENCED,

EXPIRES 3-22-77

IN ABOVE SPACE DESCRIBE PROPOSED PROGRAM: IF PROPOSAL IS TO DEEPEN OR PLUG BACK, GIVE DATA ON PRESENT PRODUCTIVE ZONE AND PROPOSED NEW PRODUCTION ZONE. GIVE BLOWOUT PREVENTER PROGRAM, IF ANY.

hereby certify that the information above is true and complete to the best of my knowledge and belief.

Signed Ed Hartman Title President Date 12/20/76
(This space for State Use)

APPROVED BY Al Kendrick TITLE SUPERVISOR DIST. #3 DATE DEC 21 1976
CONDITIONS OF APPROVAL, IF ANY:

**NEW MEXICO OIL CONSERVATION COMMISSION
WELL LOCATION AND ACERAGE DEDICATION PLAT**

All distances must be from the outer boundaries of the Section

Operator Manana Gas, Inc.		Lease Mary Wheeler		Well No 1	
Unit Letter D	Section 23	Township 30 NORTH	Range 12 WEST	County SAN JUAN	
Actual Footage Location of Well: 1095 feet from the NORTH line and 875 feet from the WEST line					
Ground Level Elev 5518	Producing Formation Dakota	Pool Basin	Dedicated Acreage 320		Acres

1. Outline the acreage dedicated to the subject well by colored pencil or hachure marks on the plat below.
2. If more than one lease is dedicated to the well, outline each and identify the ownership thereof (both as to working interest and royalty).
3. If more than one lease of different ownership is dedicated to the well, have the interests of all owners been consolidated by communitization, unitization, force-pooling, etc?
 (X) Yes () No If answer is "yes," type of consolidation Communitization (See Division Order)

If answer is "no," list the owners and tract descriptions which have actually consolidated. (Use reverse side of this form if necessary.) _____

No allowable will be assigned to the well until all interests have been consolidated (by communitization, unitization, forced-pooling, or otherwise) or until a non standard unit, eliminating such interests, has been approved by the Commission.

CERTIFICATION

I hereby certify that the information contained herein is true and complete to the best of my knowledge and belief.

Ed Hartman
 Name _____
 Position **Ed Hartman**
 President
 Company **Manana Gas, Inc.**
 Date **12-20-76**

I hereby certify that the well location shown on this plat was plotted from field notes of actual surveys made by me or under my supervision, and that the same is true and correct to the best of my knowledge and belief.

15 December 1976
 Date Surveyed _____
James P. Leese
 Registered Professional Engineer
 and/or Land Surveyor **James P. Leese**

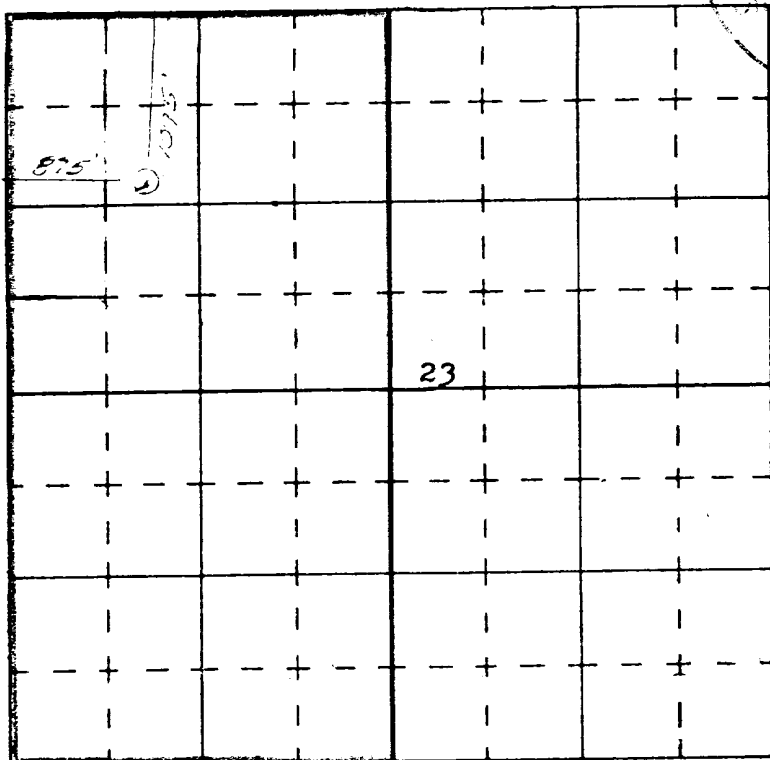

1463
 Certificate No.