

NO. OF COPIES RECEIVED	2
DISTRIBUTION	
SANTA FE	1
FILE	1
U.S.G.S.	2
LAND OFFICE	1
OPERATOR	1

# NEW MEXICO OIL CONSERVATION COMMISSION

30-045-22375

Form C-101  
Revised 1-1-65

5A. Indicate Type of Lease
STATE <input checked="" type="checkbox"/> FEE <input type="checkbox"/>
5. State Oil & Gas Lease No.
E-1641

## APPLICATION FOR PERMIT TO DRILL, DEEPEN, OR PLUG BACK

1a. Type of Work		7. Unit Agreement Name	
b. Type of Well DRILL <input checked="" type="checkbox"/> DEEPEN <input type="checkbox"/> PLUG BACK <input type="checkbox"/> OIL WELL <input type="checkbox"/> GAS WELL <input checked="" type="checkbox"/> OTHER <input type="checkbox"/> SINGLE ZONE <input checked="" type="checkbox"/> MULTIPLE ZONE <input type="checkbox"/>		8. Farm or Lease Name Turner B Com A	
2. Name of Operator El Paso Natural Gas Company		9. Well No. 2A	
3. Address of Operator PO Box 990, Farmington, NM 87401		10. Field and Pool, or Wildcat Blanco Mesa Verde	
4. Location of Well UNIT LETTER O LOCATED 1000 FEET FROM THE South LINE AND 1820 FEET FROM THE East LINE OF SEC. 2 TWP. 30N RGE. 9W NMPM		12. County San Juan	
19. Proposed Depth 5415'		19A. Formation Mesa Verde	
20. Rotary or C.T. Rotary		21. Elevations (Show whether DF, RT, etc.) 5951' DF	
21A. Kind & Status Plug. Bond statewide		21B. Drilling Contractor	
22. Approx. Date Work will start			

## PROPOSED CASING AND CEMENT PROGRAM

SIZE OF HOLE	SIZE OF CASING	WEIGHT PER FOOT	SETTING DEPTH	SACKS OF CEMENT	EST. TOP
13 3/4"	9 5/8"	32.3#	200'	224 cu.ft.	circulate
8 3/4"	7"	20.0#	3150'	370 cu.ft.	cover Ojo Alan
6 1/4"	4 1/2"	10.5#	3000-5415'	421 cu.ft.	fill to 3000'

Selectively perforate and sandwater fracture the Mesa Verde formation.

A 3000 psi WP and 6000 psi test double gate preventer equipped with blind and pipe rams will be used for blow out prevention on this well.

This gas is dedicated.

The E/2 of Section 2 is dedicated to this well.

APPROVAL FOR  
FOR 90 DAYS UNLESS  
DRILLING COMMENCES

EXPIRES 6/13/77

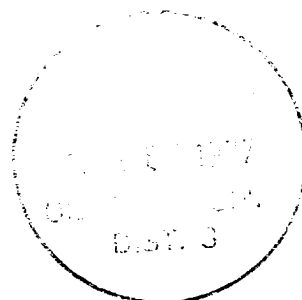

IN ABOVE SPACE DESCRIBE PROPOSED PROGRAM: IF PROPOSAL IS TO DEEPEN OR PLUG BACK, GIVE DATA ON PRESENT PRODUCTIVE ZONE AND PROPOSED NEW PRODUCTIVE ZONE. GIVE BLOWOUT PREVENTER PROGRAM, IF ANY.

I hereby certify that the information above is true and complete to the best of my knowledge and belief.

Signed D. G. Buico Title Drilling Clerk Date March 15, 1977

(This space for State Use)

APPROVED BY W. Kendrick TITLE STATE OIL & GAS COMMISSION DATE 6/13/77

CONDITIONS OF APPROVAL, IF ANY:

NEW MEXICO OIL CONSERVATION COMMISSION  
WELL LOCATION AND ACREAGE DEDICATION PLAT

Form C-102  
Supersedes C-128  
Effective 1-1-65

All distances must be from the outer boundaries of the Section.

Operator <b>EL PASO NATURAL GAS COMPANY</b>		Lease <b>TURNER B COM. A (E-1641)</b>		Well No. <b>2A</b>
Unit Letter <b>0</b>	Section <b>2</b>	Township <b>30-N</b>	Range <b>9-W</b>	County <b>SAN JUAN</b>
Actual Footage Location of Well: <b>1000</b> feet from the <b>SOUTH</b> line and <b>1820</b> feet from the <b>EAST</b> line				
Ground Level Elev. <b>5941</b>	Producing Formation <b>MESA VERDE</b>	Pool <b>BLANCO MESA VERDE</b>	Dedicated Acreage: <b>323.16</b> Acres	

1. Outline the acreage dedicated to the subject well by colored pencil or hatchure marks on the plat below.
2. If more than one lease is dedicated to the well, outline each and identify the ownership thereof (both as to working interest and royalty).
3. If more than one lease of different ownership is dedicated to the well, have the interests of all owners been consolidated by communitization, unitization, force-pooling, etc?

☒ Yes ☐ No If answer is "yes," type of consolidation Communitization

If answer is "no," list the owners and tract descriptions which have actually been consolidated. (Use reverse side of this form if necessary.)

No allowable will be assigned to the well until all interests have been consolidated (by communitization, unitization, forced-pooling, or otherwise) or until a non-standard unit, eliminating such interests, has been approved by the Commission. NOTE: THIS PLAT REISSUED TO SHOW CORRECTED ELEVATION. 3-3-77

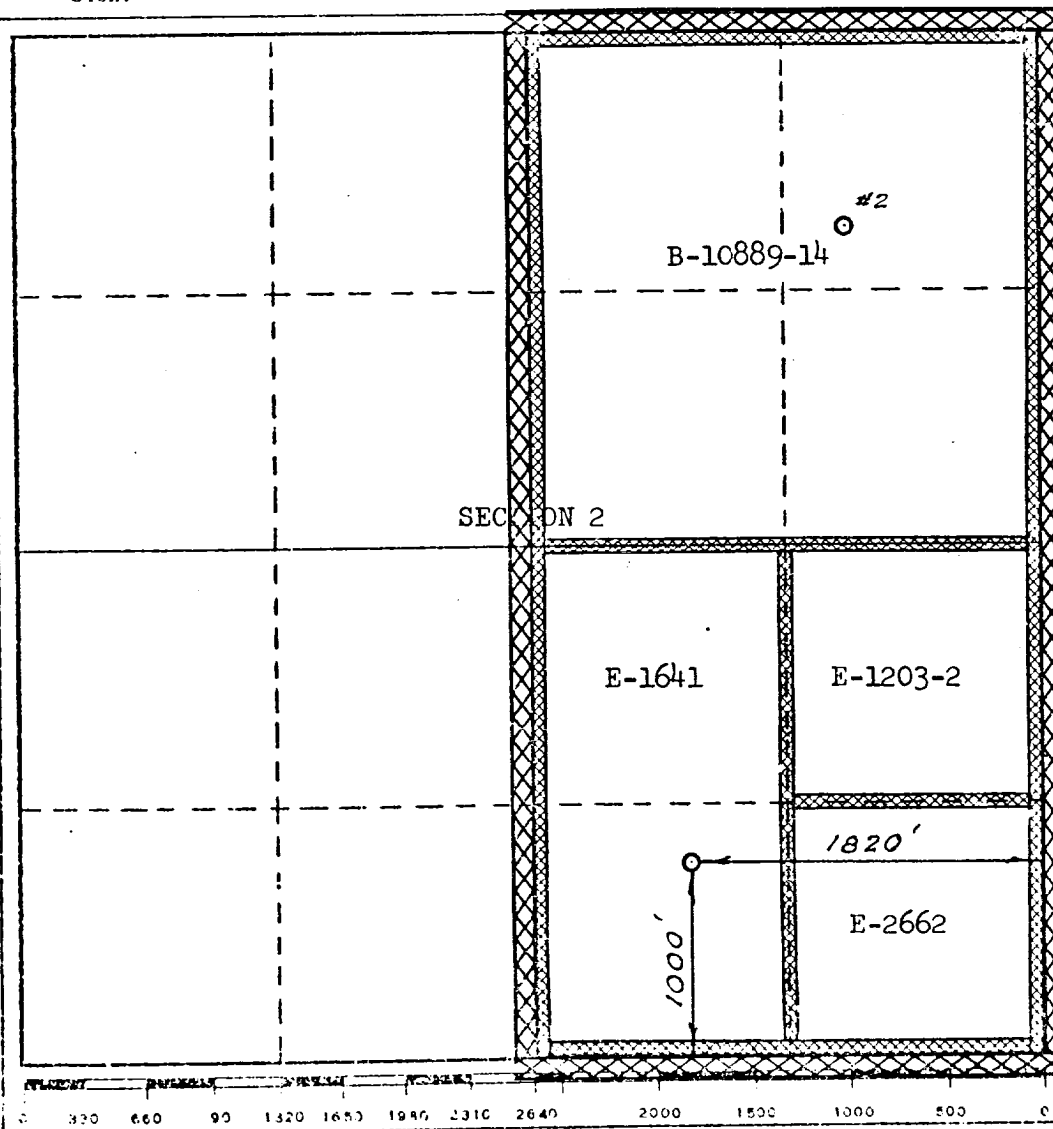

CERTIFICATION

I hereby certify that the information contained herein is true and complete to the best of my knowledge and belief.

Original Signed by  
**D. G. Brisco**

Name  
**Drilling Clerk**

Position  
**El Paso Natural Gas Co.**

Company  
**March 15, 1977**

Date

I hereby certify that the well location shown on this plat was plotted from field notes of actual surveys made by me or under my supervision, and that the same is true and correct to the best of my knowledge and belief.

Date Surveyed  
**FEBRUARY 24, 1977**

Registered Professional Engineer and/or Land Surveyor

Certificate No. **1760**