

UNITED STATES  
DEPARTMENT OF THE INTERIOR  
GEOLOGICAL SURVEY

SUBMIT IN TRIPLICATE\*  
(Other Instructions on reverse side)

Form approved  
Budget Bulletin No. 42-B-4224  
5. LEASE DESIGNATION AND SERIAL NO.

SF 080597

6. IF INDIAN, ALIEN, OR TRIBE NAME

SUNDRY NOTICES AND REPORTS ON WELLS

(Do not use this form for proposals to drill or to deepen or plug back to a different reservoir.  
Use "APPLICATION FOR PERMIT" for such proposals.)

1. OIL WELL <input type="checkbox"/> GAS WELL <input checked="" type="checkbox"/> OTHER		7. UNIT AGREEMENT NAME	
2. NAME OF OPERATOR El Paso Natural Gas Company		8. FARM OR LEASE NAME Gartner	
3. ADDRESS OF OPERATOR Box 990, Farmington, New Mexico 87401		9. WELL NO. 3A	
4. LOCATION OF WELL (Report location clearly and in accordance with any State requirements. See also space 17 below.) At surface  1140'N, 1040'W		10. FIELD AND POOL, OR WILDCAT Blanco PC Ext. & Blanco MV	
14. PERMIT NO.		15. ELEVATIONS (Show whether DF, RT, GR, etc.) 6338' GL	
		11. SEC., T., R., M., OR BLK. AND SURVEY OR AREA Sec. 33, T-30-N, R-8-W N. M. P. M.	12. COUNTY OR PARISH San Juan
		13. STATE New Mexico	

16. Check Appropriate Box To Indicate Nature of Notice, Report, or Other Data

NOTICE OF INTENTION TO:		SUBSEQUENT REPORT OF:	
TEST WATER SHUT-OFF <input type="checkbox"/>	PULL OR ALTER CASING <input type="checkbox"/>	WATER SHUT-OFF <input type="checkbox"/>	REPAIRING WELL <input type="checkbox"/>
FRACTURE TREAT <input type="checkbox"/>	MULTIPLE COMPLETE <input type="checkbox"/>	FRACTURE TREATMENT <input type="checkbox"/>	ALTERING CASING <input type="checkbox"/>
SHOOT OR ACIDIZE <input type="checkbox"/>	ABANDON* <input type="checkbox"/>	SHOOTING OR ACIDIZING <input type="checkbox"/>	ABANDONMENT* <input type="checkbox"/>
REPAIR WELL <input type="checkbox"/>	CHANGE PLANS <input checked="" type="checkbox"/>	(Other) <input type="checkbox"/>	

(NOTE: Report results of multiple completion on Well Completion or Recompletion Report and Log form.)

17. DESCRIBE PROPOSED OR COMPLETED OPERATIONS (Clearly state all pertinent details, and give pertinent dates, including estimated date of starting any proposed work. If well is directionally drilled, give subsurface locations and measured and true vertical depths for all markers and zones pertinent to this work.)\*

This well was originally planned as a single Mesa Verde completion. It is now planned to dually complete this well in the Pictured Cliffs & Mesa Verde formations. The casing and cementing will remain the same.

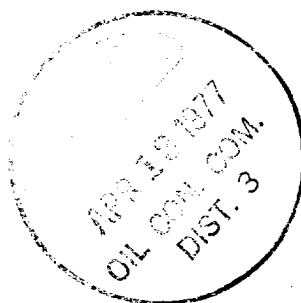

RECEIVED

APR 11 1977

U. S. GEOLOGICAL SURVEY

18. I hereby certify that the foregoing is true and correct

SIGNED A. B. Swiss TITLE Drilling Clerk DATE April 5, 1977

(This space for Federal or State office use)

APPROVED BY \_\_\_\_\_ TITLE \_\_\_\_\_ DATE \_\_\_\_\_

CONDITIONS OF APPROVAL, IF ANY:

*atlas*

\*See Instructions on Reverse Side

NEW MEXICO OIL CONSERVATION COMMISSION  
WELL LOCATION AND ACREAGE DEDICATION PLAT

Form G-102  
Supersedes G-128  
Effective 1-1-65

All distances must be from the outer boundaries of the Section.

Operator <b>El Paso Natural Gas Company</b>			Lease <b>Gartner (SF-080597)</b>		Well No. <b>3A</b>
Unit Letter <b>D</b>	Section <b>33</b>	Township <b>30N</b>	Range <b>8W</b>	County <b>San Juan</b>	
Actual Footage Location of Well: <b>1140</b> feet from the <b>North</b> line and <b>1040</b> feet from the <b>West</b> line					
Ground Level Elev. <b>6338</b>	Producing Formation <b>PICTURED CLIFFS &amp; MESA VERDE</b>	Pool <b>BLANCO PICTURED CLIFFS EXT. BLANCO MESA VERDE</b>		Dedicated Acreage: <b>160.0 &amp; 320.0</b> Acres	

1. Outline the acreage dedicated to the subject well by colored pencil or hachure marks on the plat below.
2. If more than one lease is dedicated to the well, outline each and identify the ownership thereof (both as to working interest and royalty).
3. If more than one lease of different ownership is dedicated to the well, have the interests of all owners been consolidated by communitization, unitization, force-pooling, etc?

☐ Yes ☐ No If answer is "yes," type of consolidation \_\_\_\_\_

If answer is "no," list the owners and tract descriptions which have actually been consolidated. (Use reverse side of this form if necessary.) \_\_\_\_\_

No allowable will be assigned to the well until all interests have been consolidated (by communitization, unitization, forced-pooling, or otherwise) or until a non-standard unit, eliminating such interests, has been approved by the Commission.  
NOTE: THIS PLAT IS REISSUED TO SHOW DUAL COMPLETION. 4-6-77

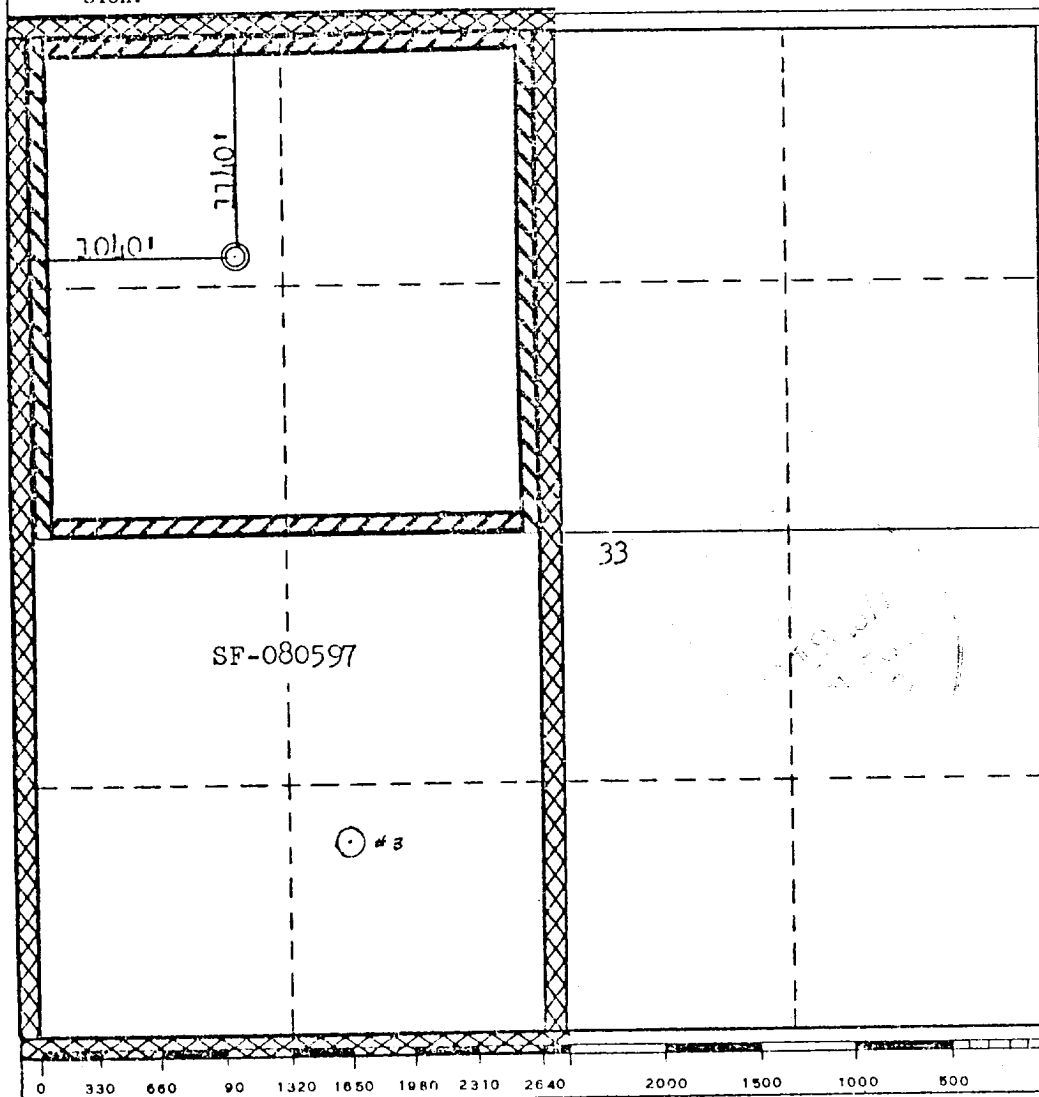

CERTIFICATION

I hereby certify that the information contained herein is true and complete to the best of my knowledge and belief.

*M. D. Dices*

Name  
**Drilling Clerk**  
Position  
**El Paso Natural Gas Company**  
Company  
**April 11, 1977**  
Date

I hereby certify that the well location shown on this plat was plotted from field notes of actual surveys made by me or under my supervision, and that the same is true and correct to the best of my knowledge and belief.

Date Surveyed  
**March 1, 1977**  
Registered Professional Engineer and/or Land Surveyor  
*Fred B. Fair Jr.*  
Certificate No.  
**3950**