



Southern

Rockies

Business

Unit

May 14, 1996

Mr. William J. LeMay, Director
New Mexico Oil Conservation Division
2040 S. Pacheco Street
P. O. Box 6429
Santa Fe, NM 87505

RECEIVED
MAY 20 1996

OIL CON. DIV.
DIST. 3

Application for Exception to Rule 303-C - Downhole Commingling
Gartner A#4A Well
Unit I Section 33-T30N-R8W
Blanco Pictured Cliffs and Blanco Mesaverde Pools
San Juan County, New Mexico

I recently sent to you an administrative application and form C-107-A for the Gartner A#4A. The cover letter incorrectly identified the well name as the Johnston LS #8. Enclosed please find a corrected cover letter and another copy of our administrative application form (C-107-A) and attachments for downhole commingling for the captioned well. All of the other information contained in the application was correct. Please replace the previous application with this one. I apologize for any inconvenience that this may have caused you.

Should there be questions concerning this matter, please contact me at (303) 830-5344.

Sincerely,

Pamela W. Staley

Enclosures

cc: Hiep Vu
Patty Haefele
Wellfile
Proration File
Frank Chavez, Supervisor
NMOCD District III
1000 Rio Brazos Road
Aztec, NM 87410

Duane Spencer
Bureau of Land Management
1235 La Plata Hwy.
Farmington, NM 87401



Southern
Rockies
Business
Unit

May 9, 1996

Mr. William J. LeMay, Director
New Mexico Oil Conservation Division
2040 S. Pacheco Street
P. O. Box 6429
Santa Fe, NM 87505

RECEIVED
MAY 20 1996
OIL CON. DIV.
DIST. 3

Corrected Application for Exception to Rule 303-C - Downhole Commingling
Gartner A#4A Well
Unit I Section 33-T30N-R8W
Blanco Pictured Cliffs and Blanco Mesaverde Pools
San Juan County, New Mexico

Enclosed please find an administrative application form (C-107-A) and attachments for downhole commingling for the captioned well. By copy of this application by certified mail, return receipt requested, Amoco is notifying all offset operators in the formations captioned above as well as all affected interest owners if the ownership of those formations is not common. The Division Director may approve the proposed downhole commingling in the absence of a valid objection from any offset operator or any interest owner in those instances where ownership is not common in the zones to be commingled within 20 days after the receipt of the application if, in his opinion, waste will not result thereby, and correlative rights will not be violated.

Should there be questions concerning this matter, please contact me at (303) 830-5344.

Sincerely,

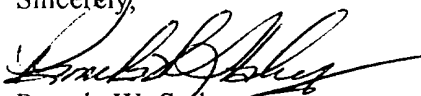
Pamela W. Staley

Enclosures

cc: Hiep Vu
Patty Haeefe
Wellfile
Proration File
Frank Chavez, Supervisor
NMOCD District III
1000 Rio Brazos Road
Aztec, NM 87410

Duane Spencer
Bureau of Land Management
1235 La Plata Hwy.
Farmington, NM 87401

DISTRICT I
P.O. Box 1980, Hobbs NM 88241-1980

State of New Mexico
Energy, Minerals and Natural Resources Department

Form C-107-A
New 3-12-96

OIL CONSERVATION DIVISION

APPROVAL PROCESS:

DISTRICT II
811 South First St., Artesia, NM 88210-2835

2040 S. Pacheco
Santa Fe, New Mexico 87505-6429

Administrative Hearing

DISTRICT III
1000 Rio Brazos Rd. Aztec, NM 87410-1693

APPLICATION FOR DOWNHOLE COMMINGLING

EXISTING WELLBORE
X YES NO

Amoco Production Company		P.O. Box 800	Denver, CO 80201
Operator	Address	County	
Gartner A	I-33-30N-8W	San Juan	
Lease	Well No.	Unit Ltr. - Sec Twp - Rge	
	#4A		

OGRID NO. 000778 Property Code 000589 API NO. 30-045-22418 Spacing Unit Lease Types: (check 1 or more)
Federal X State (and/or) Fee

The following facts are submitted in support of downhole commingling:	Upper Zone	Intermediate Zone	Lower Zone
1. Pool Name and Pool Code	Blanco Pictured Cliffs		Blanco Mesaverde
2. Top and Bottom of Pay Section (Perforations)	3114'-3176'	RECEIVED MAY 20 1996	4705'-5698'
3. Type of production (Oil or Gas)	gas		gas
4. Method of Production (Flowing or Artificial Lift)	flowing	OIL CON. DIV. DIST. 3	flowing
5. Bottomhole Pressure Oil Zones - Artificial Lift: Gas & Oil - Flowing: All Gas Zones: Estimated Current Measured Current Estimated or Measured Original	(Current) a. 255 PSI (est) (Original) b. 964 PSI	a. b.	a. 266 PSI (est) b. 1280 PSI
6. Oil Gravity (" API) or Gas BTU Content	1135 BTU/mmcf		1191 BTU/mmcf 57.8 API
7. Producing or Shut-In?	producing		producing
Production Marginal? (yes or no)	no		yes
• If Shut-In, give date and oil/gas/water rates of last production Note: For new zones with no production history, applicant shall be required to attach production estimates and supporting data	Date: Rates:	Date: Rates:	Date: Rates:
• If Producing, give date and oil/gas/water rates of recent test (within 60 days)	Date: 04/96 Rates: 150 mcf/d 0 bopd 0 bwpd	Date: Rates:	Date: 04/96 Rates: 100 mcf/d 0.5 bopd 0.014 bwpd
8. Fixed Percentage Allocation Formula -% for each zone	Oil: 0 % Gas 60 %	Oil: % Gas %	Oil: 100 % Gas 40 %

9. If allocation formula is based upon something other than current or past production, or is based upon some other method, submit attachments with supporting data and/or explaining method and providing rate projections or other required data.
10. Are all working, overriding, and royalty interests identical in all commingled zones? ☒ Yes ☐ No
If not, have all working, overriding, and royalty interests been notified by certified mail? ☐ Yes ☐ No
Have all offset operators been given written notice of the proposed downhole commingling? ☒ Yes ☐ No
11. Will cross-flow occur? ☐ Yes ☒ No If yes, are fluids compatible, will the formations not be damaged, will any cross-flowed production be recovered, and will the allocation formula be reliable. ☐ Yes ☐ No (If No, attach explanation)
12. Are all produced fluids from all commingled zones compatible with each other? ☒ Yes ☐ No
13. Will the value of production be decreased by commingling? ☐ Yes ☒ No (If Yes, attach explanation)
14. If this well is on, or communitized with, state or federal lands, either the Commissioner of Public Lands or the United States Bureau of Land Management has been notified in writing of this application. ☒ Yes ☐ No SF-080597
15. NMOCD Reference Cases for Rule 303(D) Exceptions: ORDER NO(S) _____
16. ATTACHMENTS:
- C-102 for each zone to be commingled showing its spacing unit and acreage dedication.
 - Production curve for each zone for at least one year. (If not available, attach explanation.)
 - For zones with no production history, estimated production rates and supporting data.
 - Data to support allocation method or formula.
 - Notification list of all offset operators.
 - Notification list of working, overriding, and royalty interests for uncommon interest cases.
 - Any additional statements, data, or documents required to support commingling.

I hereby certify that the information above is true and complete to the best of my knowledge and belief.

SIGNATURE Pamela W. Staley TITLE REGULATORY AFFAIRS REP DATE 5/9/96
TYPE OR PRINT NAME Pamela W. Staley TELEPHONE NO. (303) 830-5344

MEXICO OIL CONSERVATION COMMISSION
WELL LOCATION AND ACREAGE DEDICATION PLAT

Form C-107
Supersedes C-120
Effective 1-1-65

All distances must be from the outer boundaries of the Section.

Operator El Paso Natural Gas Company			Lease Garliner (SF-080597)		Well No. 11A
Unit Letter T	Section 33	Township 30N	Range 8W	County San Juan	
Actual Well Location of Well: 1150 feet from the South line and 800 feet from the East line.					
Ground Level Elev. 6365	Producing Formation PICTURED CLIFFS & MESA VERDE		Pool BLANCO PICTURED CLIFFS EXT. BLANCO MESA VERDE		Dedicated Acreage 160.0 & 320.0 Acres

1. Outline the acreage dedicated to the subject well by colored pencil or machine marks on the plat below.
2. If more than one lease is dedicated to the well, outline each and identify the ownership thereof (both as to working interest and royalty).
3. If more than one lease of different ownership is dedicated to the well, have the interests of all owners been consolidated by communitization, unitization, force-pooling, etc?

☐ Yes ☐ No If answer is "yes," type of consolidation _____

If answer is "no," list the owners and tract descriptions which have actually been consolidated. (Use reverse side of this form if necessary.) _____

No allowable will be assigned to the well until all interests have been consolidated (by communitization, unitization, forced-pooling, or otherwise) or until a non-standard unit, eliminating such interests, has been approved by the Commission.
NOTE: THIS PLAT IS REISSUED TO SHOW DUAL COMPLETION. 4-6-77

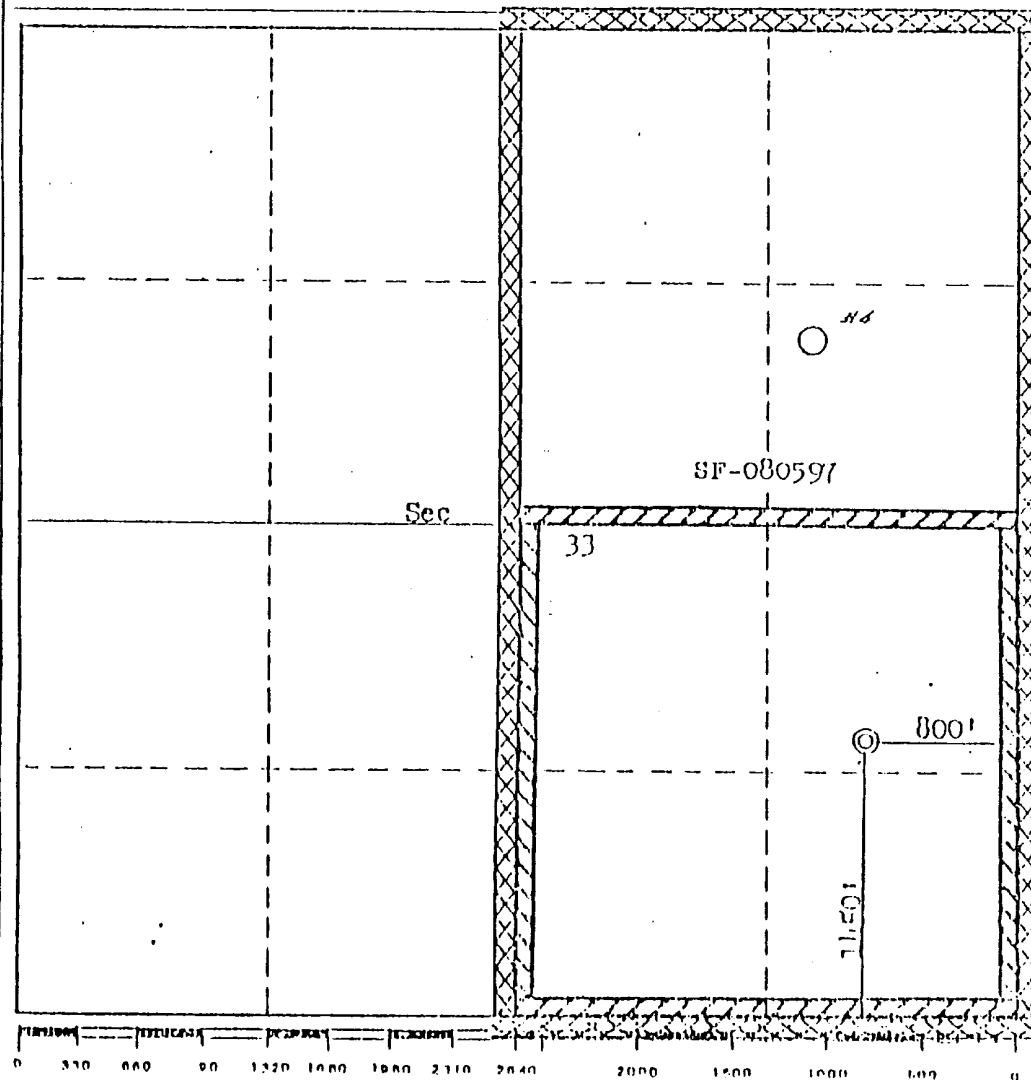

CERTIFICATION

I hereby certify that the information contained herein is true and complete to the best of my knowledge and belief.

P. G. Suarez

Name

Petroleum Engineer

Position

El Paso Natural Gas Company

Company

April 11, 1977

Date

I hereby certify that the well location shown on this plat was plotted from field notes of actual surveys made by me or under my supervision, and that the same is true and correct to the best of my knowledge and belief.

Date Surveyed

February 26, 1977

Registered Professional Engineer and/or Land Surveyor

Fred B. Karr, Jr.

Fred B. Karr, Jr.

Certification No.

3950

NEW MEXICO OIL CONSERVATION COMMISSION
WELL LOCATION AND ACREAGE DEDICATION PLAT

Form C-102
Supersedes C-128.
Effective 1-1-65

All distances must be from the outer boundaries of the Section.

Operator El Paso Natural Gas Company			Lease Gartner (SF-080597)		Well No. 11A
Unit Letter I	Section 33	Township 30N	Range 8W	County San Juan	
Actual Postage Location of Well: 1150 feet from the South line and 800 feet from the East line					
Ground Level Elev. 6365	Producing Formation Mesa Verde		Pool Blanco Mesa Verde		Dedicated Acreage 320.00 Acres

1. Outline the acreage dedicated to the subject well by colored pencil or hatchure marks on the plat below.
2. If more than one lease is dedicated to the well, outline each and identify the ownership thereof (both as to working interest and royalty).
3. If more than one lease of different ownership is dedicated to the well, have the interests of all owners been consolidated by communitization, unitization, force-pooling, etc?

☐ Yes ☐ No If answer is "yes," type of consolidation _____

If answer is "no," list the owners and tract descriptions which have actually been consolidated. (Use reverse side of this form if necessary.) _____

No allowable will be assigned to the well until all interests have been consolidated (by communitization, unitization, forced-pooling, or otherwise) or until a non-standard unit, eliminating such interests, has been approved by the Commission.

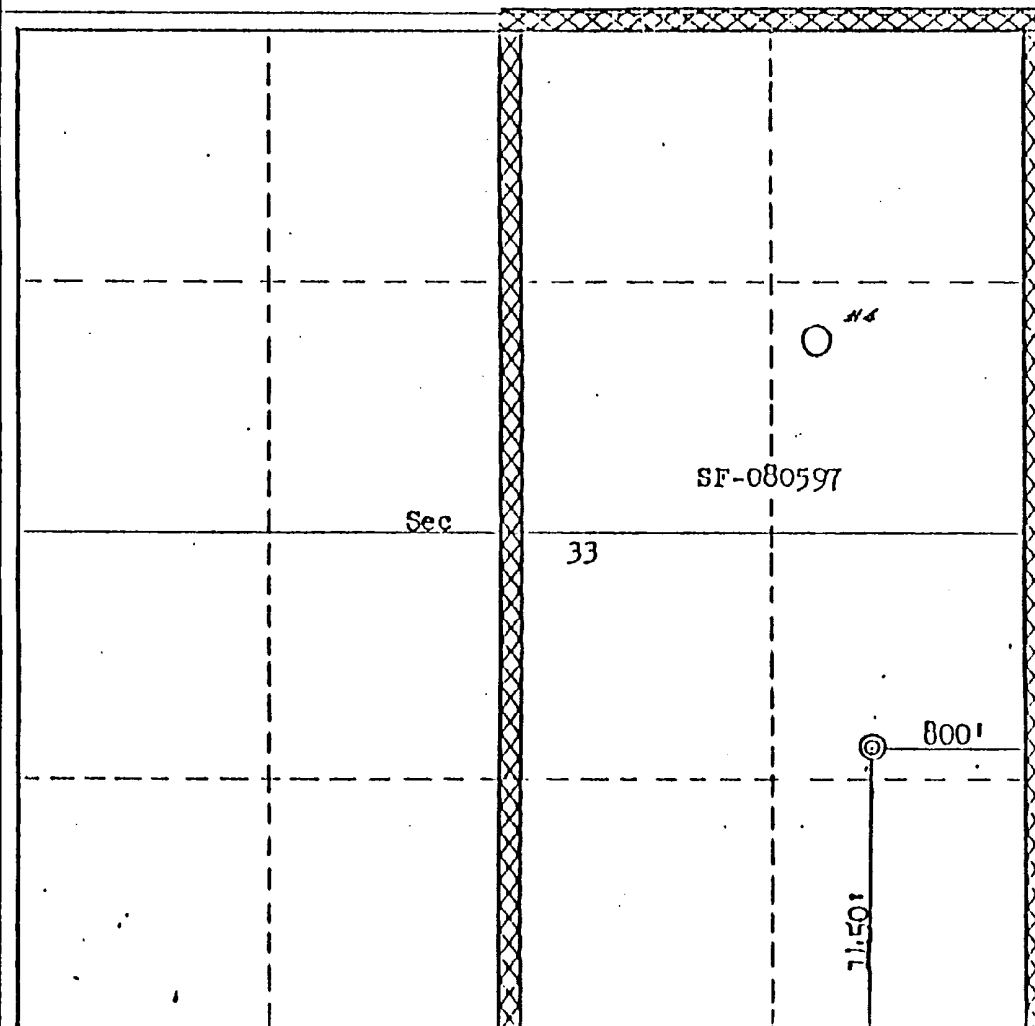

CERTIFICATION

I hereby certify that the information contained herein is true and complete to the best of my knowledge and belief.

A. B. Duico

Name

Drilling Clerk

Position

El Paso Natural Gas Co.

Company

March 23, 1977

Date

I hereby certify that the well location shown on this plat was plotted from field notes of actual surveys made by me or under my supervision, and that the same is true and correct to the best of my knowledge and belief.

Date Surveyed

February 26, 1977

Registered Professional Engineer and/or Land Surveyor

Frank R. Kott, Jr.

Certificate No.

3250

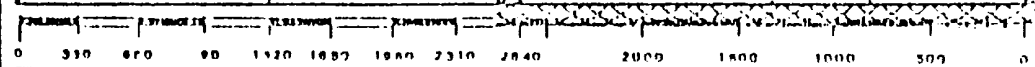

1000 Lease: GARTNER A 00004A Dights Retrieval Code: 251. 045. 30N08W33T00MV 100000

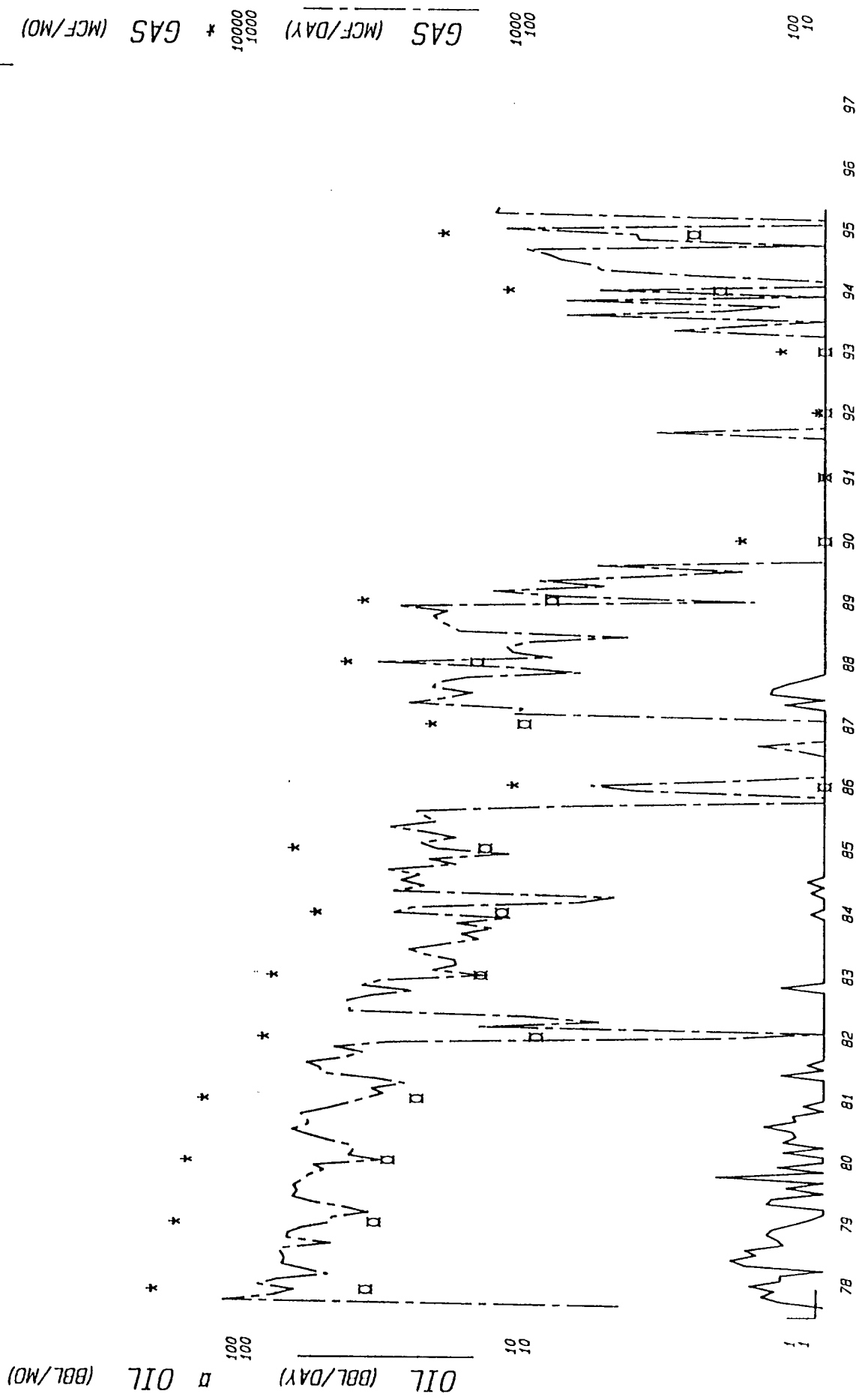

County: SAN JUAN
 Field: BLANCO (MESAVEDE) MV
 Reservoir: MESAVEDE
 Operator: AMOCO PRODUCTION CO
 Oil Cum: 2848
 Gas Cum: 1483704
 Location: 331 30N 8W
 State: NM

Date: 02-14-95

F.P. Date 02-78

1000 Lease: GARTNER A 000044 Retrieval Code: 251.045.30N08W33I00PC

Dwights

000044

1000

1000

1000

1000

1000

1000

1000

1000

1000

1000

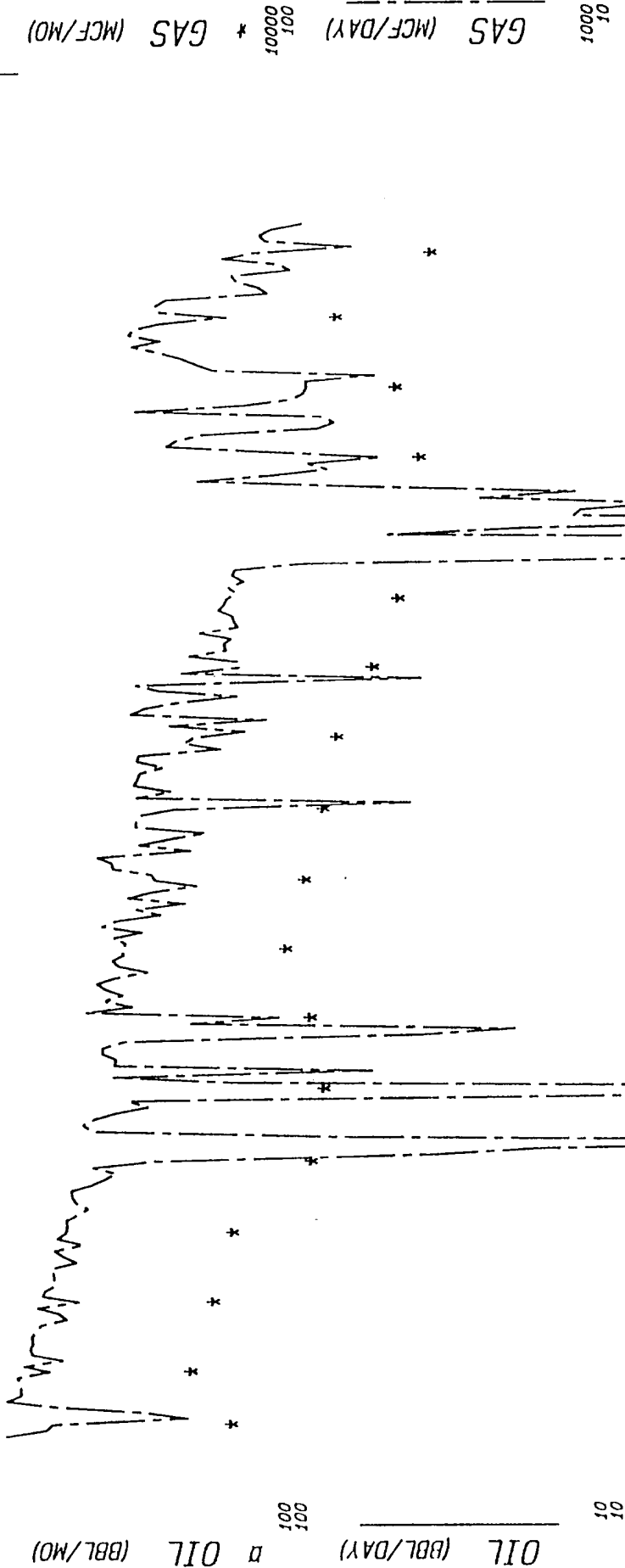

100

10

100

10

100

10

100

10

100

10

100

10

100

10

100

10

100

10

100

10

100

10

100

10

100

10

100

10

100

10

100

10

100

10

100

10

100

10

100

10

100

10

100

10

100

10

100

10

100

10

100

10

100

10

100

10

100

10

100

10

100

10

100

10

100

10

100

10

100

10

100

10

100

10

County: SAN JUAN State: NM
Field: BLANCO (PICTURED CLIFFS) PC
Reservoir: PICTURED CLIFFS
Operator: AMOCO PRODUCTION CO
Oil Cum: 132 Gas Cum: 2055803
Location: 33I 30N 8W

Date: 02-14-96

F.P. Date 07-78

OFFSET OPERATORS

Gartner A #4A

Meridian Oil, Inc.
P.O. Box 4289
Farmington, NM 87499