

NO. OF COPIES RECEIVED	5
DISTRIBUTION	
SANTA FE	1
FILE	1
U.S.G.S.	2
LAND OFFICE	
OPERATOR	1

NEW MEXICO OIL CONSERVATION COMMISSION

30-045-22442
Form C-101
Revised 1-1-65

5A. Indicate Type of Lease	
STATE <input type="checkbox"/>	FEE <input checked="" type="checkbox"/>

5. State Oil & Gas Lease No.

APPLICATION FOR PERMIT TO DRILL, DEEPEN, OR PLUG BACK

1a. Type of Work		7. Unit Agreement Name	
b. Type of Well DRILL <input checked="" type="checkbox"/> DEEPEN <input type="checkbox"/> PLUG BACK <input type="checkbox"/> OIL WELL <input type="checkbox"/> GAS WELL <input checked="" type="checkbox"/> OTHER <input type="checkbox"/> SINGLE ZONE <input type="checkbox"/> MULTIPLE ZONE <input type="checkbox"/>		8. Farm or Lease Name	
2. Name of Operator		9. Well No.	
Palmer Oil & Gas Company		No. 1A	
3. Address of Operator		10. Field and Pool, or Wildcat	
P. O. Box 2564, Billings, Montana 59103		Blanco-Mesaverde	
4. Location of Well		12. County	
UNIT LETTER _____ LOCATED 800 FEET FROM THE South LINE AND 1850 FEET FROM THE West LINE OF SEC. 3 TWP. 31N RGE. 7W NMPM		San Juan	
19. Proposed Depth		19A. Formation	
6000'		Mesa Verde	
20. Rotary or C.T.		Rotary	
21. Elevations (Show whether DF, RT, etc.)		22. Approx. Date Work will start	
Blanket		June 1, 1977	

23.

PROPOSED CASING AND CEMENT PROGRAM

SIZE OF HOLE	SIZE OF CASING	WEIGHT PER FOOT	SETTING DEPTH	SACKS OF CEMENT	EST. TOP
13 3/4"	9 5/8"	32#	200'	200	Surface
8 3/4"	7 "	20#	3800'	200	2800'
6 1/4"	4 1/2"	10.5#	6000'	225	3600'

- Palmer will drill a 6,000' Mesa Verde test in the SE $\frac{1}{4}$ SW $\frac{1}{4}$ Section 3, Township 31 North, Range 7 West.
- Well to be drilled by rotary tools. Set 200' of 9 5/8" casing and cement to surface; drill 8 3/4" hole to approximately 3800' and set 7" casing. Drill 6 1/4" hole with gas to T.D. and set 4 1/2" liner.
- IES and Porosity Logs will be run at T.D. All potential zones will be analyzed from surface to T.D.
- After perforating, the productive zones will be fractured, if necessary.
- The gas is not dedicated.
- A Shaffer 8" - 3000 psi BOP with blind and pipe rams to be used.
- See Commission Order No. R-5364 for approval of unorthodox location.
- Spacing unit comprises the W $\frac{1}{2}$ SE and E $\frac{1}{2}$ SW of Section 3, and the NW $\frac{1}{4}$ of Section 10.
- Palmer Oil & Gas Company is in process of communitizing to conform with above spacing unit.

IN ABOVE SPACE DESCRIBE PROPOSED PROGRAM: IF PROPOSAL IS TO DEEPEN OR PLUG BACK, GIVE DATA ON PRESENT PRODUCTIVE ZONE AND PROPOSED NEW PRODUCTIVE ZONE. GIVE BLOWOUT PREVENTER PROGRAM, IF ANY.

I hereby certify that the information above is true and complete to the best of my knowledge and belief.

Signed Robert D. Ballantyne Title Drilling Superintendent Date March 18, 1977
 (This space for State Use)

EXPIRES 6-26-77

APPROVED BY AP Kendrick TITLE _____ DATE _____
 CONDITIONS OF APPROVAL, IF ANY:

NEW MEXICO OIL CONSERVATION COMMISSION
WELL LOCATION AND ACREAGE DEDICATION PLAT

Form C-102
Supersedes C-128
Effective 1-1-65

All distances must be from the outer boundaries of the Section.

Operator Palmer Oil Company			Lease Yager		Well No. 1A
Unit Letter N	Section 3	Township 31N	Range 7W	County San Juan	
Actual Footage Location of Well: 800 feet from the South line and 1850 feet from the West line					
Ground Level Elev. 6586	Producing Formation Mesaverde		Pool Blanco-Mesaverde	Dedicated Acreage: 320 Acres	

1. Outline the acreage dedicated to the subject well by colored pencil or hachure marks on the plat below.
2. If more than one lease is dedicated to the well, outline each and identify the ownership thereof (both as to working interest and royalty).
3. If more than one lease of different ownership is dedicated to the well, have the interests of all owners been consolidated by communitization, unitization, force-pooling, etc?

☐ Yes ☒ No If answer is "yes," type of consolidation _____

If answer is "no," list the owners and tract descriptions which have actually been consolidated. (Use reverse side of this form if necessary.) _____

No allowable will be assigned to the well until all interests have been consolidated (by communitization, unitization, forced-pooling, or otherwise) or until a non-standard unit, eliminating such interests, has been approved by the Commission.

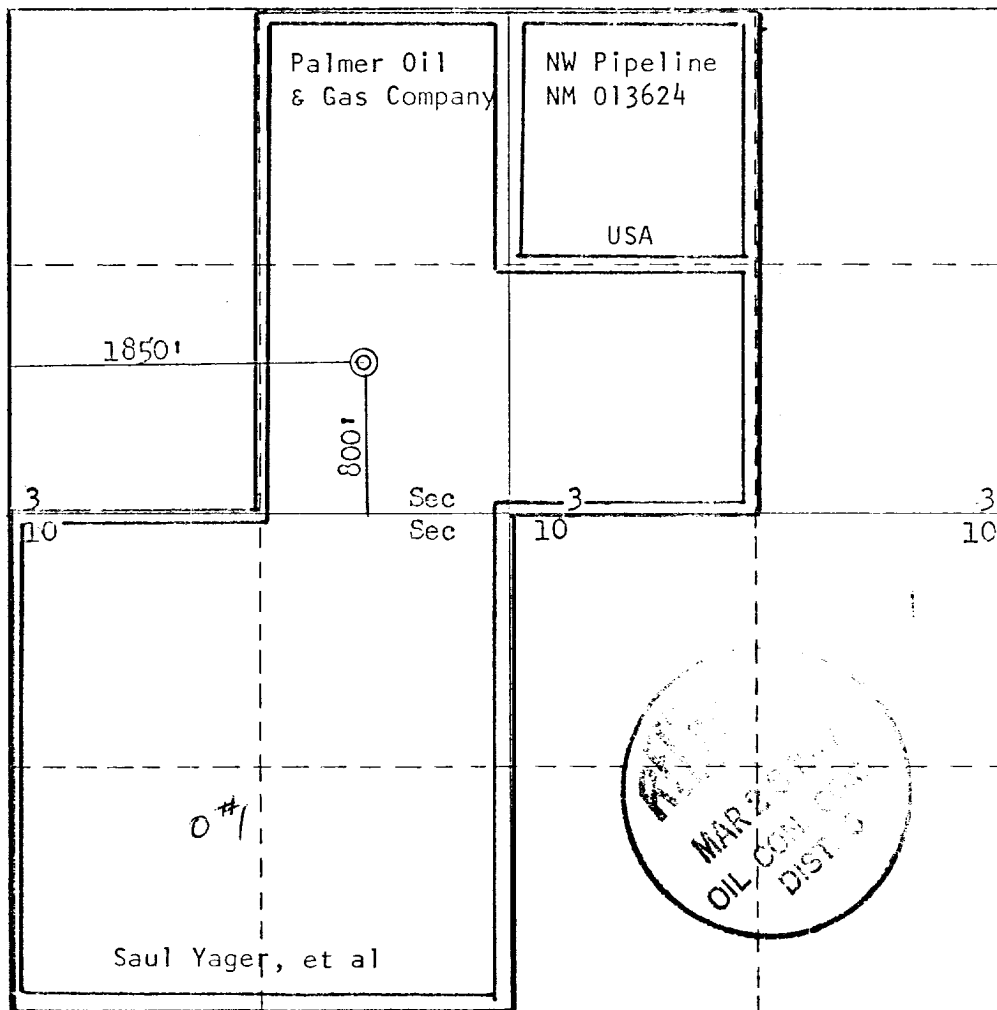

CERTIFICATION

I hereby certify that the information contained herein is true and complete to the best of my knowledge and belief.

Name
L. C. Campbell

Position
Land Manager

Company
Palmer Oil & Gas Company

Date
3/22/77

I hereby certify that the well location shown on this plat was plotted from field notes of actual surveys made by me or under my supervision, and that the same is true and correct to the best of my knowledge and belief.

Date Surveyed
March 16, 1977

Registered Professional Engineer and/or Land Surveyor

Fred B. Felt Jr.

Certificate No.
3950

0 330 660 990 1320 1650 1980 2310 2640 2970 3300 3630 3960 4290 4620 4950 5280 5610 5940 6270 6600

