

NO. OF COPIES RECEIVED	5
DISTRIBUTION	
SANTA FE	1
FILE	1
U.S.G.S.	2
LAND OFFICE	
OPERATOR	1

NEW MEXICO OIL CONSERVATION COMMISSION

30-046-32448
Form C-101
Revised 1-1-65

6-30-77

5A. Indicate Type of Lease
STATE ☐ FEE ☒

5. State Oil & Gas Lease No.

APPLICATION FOR PERMIT TO DRILL, DEEPEN, OR PLUG BACK

1a. Type of Work DRILL <input checked="" type="checkbox"/> DEEPEN <input type="checkbox"/> PLUG BACK <input type="checkbox"/>		7. Unit Agreement Name
b. Type of Well OIL WELL <input type="checkbox"/> GAS WELL <input checked="" type="checkbox"/> OTHER <input type="checkbox"/> SINGLE ZONE <input type="checkbox"/> MULTIPLE ZONE <input type="checkbox"/>		8. Farm or Lease Name Yager-Federal
2. Name of Operator Palmer Oil & Gas Company		9. Well No. No. 2A
3. Address of Operator P. O. Box 2564, Billings, Montana 59103		10. Field and Pool, or Wildcat Blanco-Mesaverde
4. Location of Well UNIT LETTER <u>P</u> LOCATED <u>1190</u> FEET FROM THE <u>South</u> LINE AND <u>800</u> FEET FROM THE <u>East</u> LINE OF SEC. <u>3</u> TWP. <u>31N</u> RGE. <u>7W</u> NMPM		12. County San Juan
19. Proposed Depth 6,200'		19A. Formation Mesa Verde
20. Rotary or C.T. Rotary		21. Elevations (Show whether DF, RT, etc.)
21A. Kind & Status Plug. Bond Blanket		21B. Drilling Contractor
22. Approx. Date Work will start June 1, 1977		

23.

PROPOSED CASING AND CEMENT PROGRAM

SIZE OF HOLE	SIZE OF CASING	WEIGHT PER FOOT	SETTING DEPTH	SACKS OF CEMENT	EST. TOP
13-3/4"	9-5/8"	32#	200'	225	Surface
8-3/4"	7"	20#	3800'	225	2800'
6-1/4"	4-1/2"	10.5#	6200'	325	3600'

- Palmer will drill a 6,200' Mesa Verde test in the SE $\frac{1}{4}$ SE $\frac{1}{4}$ Section 3, T31N-R7W.
- Well to be drilled by rotary tools. Set 200' of 9-5/8" casing and cement to surface; drill 8-3/4" hole to approximately 3800' and set 7" casing. Drill 6-1/4" hole with gas to T.D. and set 4-1/2" liner.
- IES and Porosity Logs will be run at T.D. All potential zones will be analyzed from surface to T.D.
- After perforating, the productive zones will be fractured, if necessary.
- The gas is not dedicated.
- A Shaffer 8" - 3000 psi BOP with blind and pipe rams to be used.
- See Commission Order No. R-5364 for approval of unorthodox location.
- Spacing unit comprises the W $\frac{1}{2}$ SW $\frac{1}{4}$ Sec. 2, E $\frac{1}{2}$ SE $\frac{1}{4}$ Sec. 3, and NE $\frac{1}{4}$ Section 10.
- Palmer Oil & Gas Company is in process of communitizing to conform with above spacing unit.

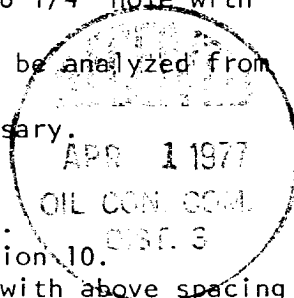

IN ABOVE SPACE DESCRIBE PROPOSED PROGRAM: IF PROPOSAL IS TO DEEPEN OR PLUG BACK, GIVE DATA ON PRESENT PRODUCTIVE ZONE AND PROPOSED NEW PRODUCTIVE ZONE. GIVE BLOWOUT PREVENTER PROGRAM, IF ANY.

I hereby certify that the information above is true and complete to the best of my knowledge and belief.

Signed [Signature] Title Land Manager Date March 29, 1977
(This space for State Use)

APPROVED BY [Signature] TITLE DATE APR 1 1977
CONDITIONS OF APPROVAL, IF ANY:

NEW MEXICO OIL CONSERVATION COMMISSION
WELL LOCATION AND ACREAGE DEDICATION PLAT

Form C-102
Supersedes C-128
Effective 1-1-65

All distances must be from the outer boundaries of the Section.

Operator Palmer Oil Company			Lease Yager-Federal		Well No. 2A
Unit Letter P	Section 3	Township 31N	Range 7W	County San Juan	
Actual Footage Location of Well: 1190 feet from the South line and 800 feet from the East line					
Ground Level Elev. 6586	Producing Formation McGrawville	Pool Blanco	Dedicated Acreage: 320 Acres		

1. Outline the acreage dedicated to the subject well by colored pencil or hachure marks on the plat below.
2. If more than one lease is dedicated to the well, outline each and identify the ownership thereof (both as to working interest and royalty).
3. If more than one lease of different ownership is dedicated to the well, have the interests of all owners been consolidated by communitization, unitization, force-pooling, etc?

☐ Yes ☒ No If answer is "yes," type of consolidation _____

If answer is "no," list the owners and tract descriptions which have actually been consolidated. (Use reverse side of this form if necessary.) _____

No allowable will be assigned to the well until all interests have been consolidated (by communitization, unitization, forced-pooling, or otherwise) or until a non-standard unit, eliminating such interests, has been approved by the Commission.

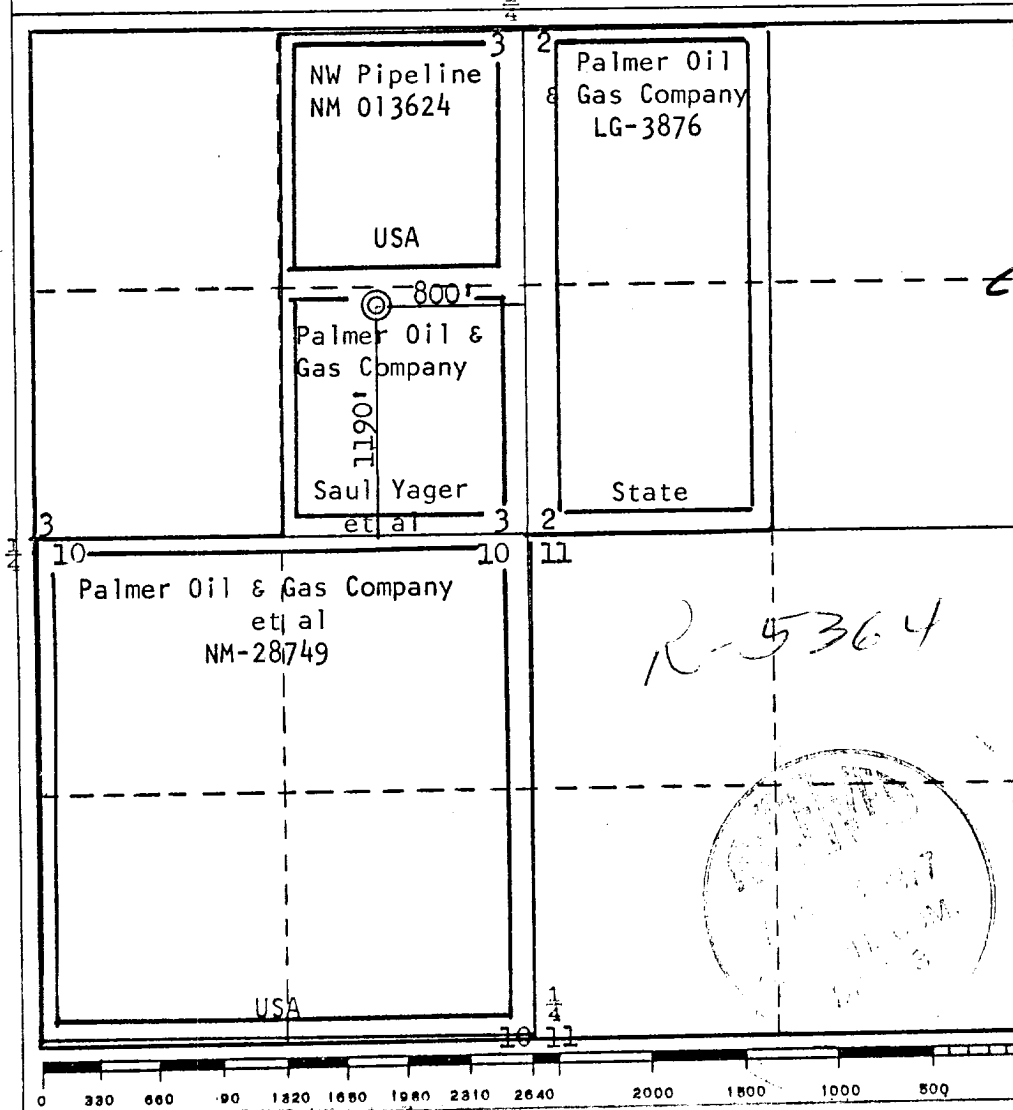

CERTIFICATION

I hereby certify that the information contained herein is true and complete to the best of my knowledge and belief.

Name
E. C. Campbell
Position
Land Manager
Company
Palmer Oil & Gas Company
Date
April 1, 1977

I hereby certify that the well location shown on this plat was plotted from field notes of actual surveys made by me or under my supervision, and that the same is true and correct to the best of my knowledge and belief.

Date Surveyed
March 24, 1977
Registered Professional Engineer and/or Land Surveyor
Fred B. Kerr Jr.
Certificate No.
3950